

NEW MEXICO OIL CONSERVATION COMMISSION

Well Location and Acreage Dedication Plat

Date Oct. 7, 1957

Section A.

Operator MAGNOLIA PETROLEUM COMPANY Lease WERNTZ-FEDERAL
Well No. 1 Unit Letter Section 21 Township 24N Range 10W NMP#
Located 1650 Feet From North Line, 1650 Feet From East Line
County Rio Arriba G. L. Elevation 7253 Dedicated Acreage 160 Acres
Name of Producing Formation Pictured Cliffs Pool Undesignated Pictured Cliffs

1. Is the Operator the only owner* in the dedicated acreage outlined on the plat below?
Yes No
2. If the answer to question one is "no," have the interests of all the owners been consolidated by communitization agreement or otherwise? Yes No . If answer is "yes," Type of Consolidation
3. If the answer to question two is "no," list all the owners and their respective interests below:

Owner

Land Description

Section B. S89°42'W (call) 79.93 ch.

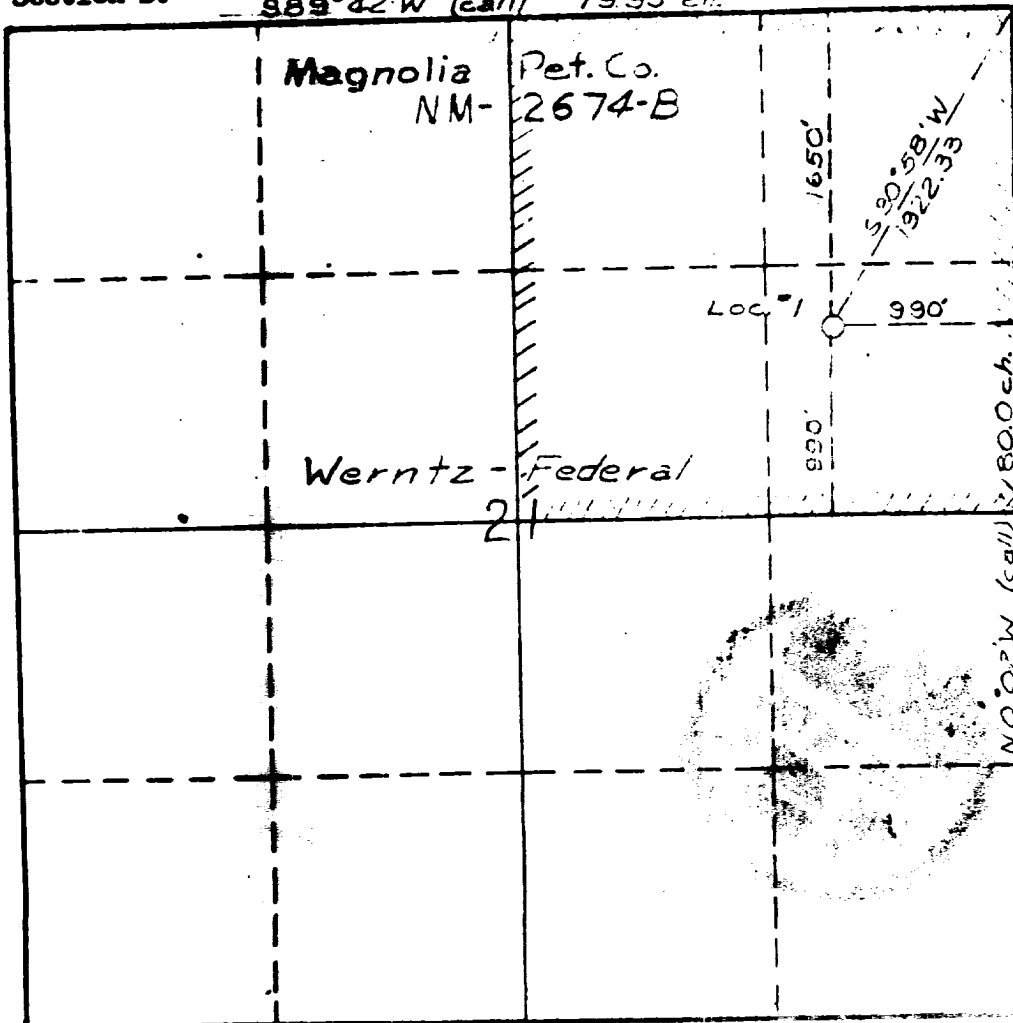

This is to certify that the information in Section A above is true and complete to the best of my knowledge and belief.

Magnolia petroleum Company

(Operator)

(Representative)

Box 633 Midland, Texas

Address

This is to certify that the well location shown on the plat in Section B was plotted from field notes of actual surveys made by me or under my supervision and that the same is true and correct to the best of my knowledge and belief.

Date Surveyed Oct. 7, 1957

Carl E. Turner

Registered Professional Engineer and/or Land Surveyor