

Form 9-331a

(Feb. 1961)

Section 21

(SUBMIT IN TRIPLICATE)

UNITED STATES
DEPARTMENT OF THE INTERIOR
GEOLOGICAL SURVEY

Land Office New Mexico

Lease No. SE 078924-1

Unit 2

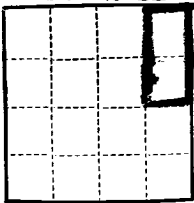

1850 NL, 790 EL

SUNDRY NOTICES AND REPORTS ON WELLS

NOTICE OF INTENTION TO DRILL.....	<input checked="" type="checkbox"/>	SUBSEQUENT REPORT OF WATER SHUT-OFF.....
NOTICE OF INTENTION TO CHANGE PLANS.....		SUBSEQUENT REPORT OF SHOOTING OR ACIDIZING.....
NOTICE OF INTENTION TO TEST WATER SHUT-OFF.....		SUBSEQUENT REPORT OF ALTERING CASING.....
NOTICE OF INTENTION TO RE-DRILL OR REPAIR WELL.....		SUBSEQUENT REPORT OF RE-DRILLING OR REPAIR.....
NOTICE OF INTENTION TO SHOOT OR ACIDIZE.....		SUBSEQUENT REPORT OF ABANDONMENT.....
NOTICE OF INTENTION TO PULL OR ALTER CASING.....		SUPPLEMENTARY WELL HISTORY.....
NOTICE OF INTENTION TO ABANDON WELL.....		

(INDICATE ABOVE BY CHECK MARK NATURE OF REPORT, NOTICE, OR OTHER DATA)

July 14, 1961

Federal 3-21

Well No. 2 is located 1850 ft. from N line and 790 ft. from E line of sec. 21

SE 1/4, NE 1/4 Section 21
(1/4 Sec. and Sec. No.)

24N
(Twp.)

7W
(Range)

(Meridian)

Esorito-Gallup
(Field)

Elis Arriba County
(County or Subdivision)

New Mexico
(State or Territory)

The elevation of the derrick floor above sea level is will report when available. ft.

DETAILS OF WORK

(State names of and expected depths to objective sands; show sizes, weights, and lengths of proposed casings; indicate mudding jobs, cementing points, and all other important proposed work)

Drill 11" hole to approximately 200'. Land and cement 8-5/8", 24#, J-55 new casing at approximately 200' using sufficient cement to obtain returns to surface. After 200 18 hrs., test casing with 1000 PSI. Drill ahead in 7-7/8" or smaller hole utilizing oil-emulsion mud to total depth of approximately 6200', where 4-1/2", 9.5# J-55 casing will be cemented with estimated 250 sacks. After 200 18 hrs., test casing with 1500 PSI. Proposed completion in Marye sand of Gallup formation in approximate interval 6000'-6200'. Completion to be through perforations with fracture treatment for stimulation.

I understand that this plan of work must receive approval in writing by the Geological Survey before operations may be commenced.

Company Standard Oil Company of Texas, A Division of California Oil Company

Address Drawer #3

Monahans, Texas

By

J. L. Rowland

Title District Engineer

NUMBER OF COPIES RECEIVED	
DISTRIBUTION	
SANTA FE	
FILE	
U.S.S.	
LAND OFFICE	
TRANSPORTER	OIL GAS
PRODUCTION OFFICE	
OPERATOR	

NEW MEXICO OIL CONSERVATION COMMISSION
WELL LOCATION AND ACREAGE DEDICATION PLAT
 SEE INSTRUCTIONS FOR COMPLETING THIS FORM ON THE REVERSE SIDE

FORM C-128
 Revised 5/1/57

SECTION A

Operator STANDARD OIL COMPANY OF TEXAS		Lease FEDERAL 3 - 21		Well No. 2
Unit Letter H	Section 21	Township 24 NORTH	Range 7 WEST	County RIO ARriba
Actual Footage Location of Well: 1850 feet from the NORTH line and 790 feet from the EAST line				
Ground Level Elev. 7105.6	Producing Formation alluv	Pool acrite-alluv	Dedicated Acreage: 80 Acres	

Ref: GLO plat dated 4 November 1882

1. Is the Operator the only owner in the dedicated acreage outlined on the plat below? YES ☒ NO ☐ . ("Owner" means the person who has the right to drill into and to produce from any pool and to appropriate the production either for himself or for himself and another. (65-3-29 (e) NMSA 1935 Comp.)
2. If the answer to question one is "no," have the interests of all the owners been consolidated by communitization agreement or otherwise? YES ☐ NO ☐ . If answer is "yes," Type of Consolidation _____
3. If the answer to question two is "no," list all the owners and their respective interests below:

Owner	Land Description

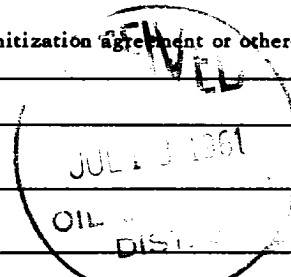

SECTION B

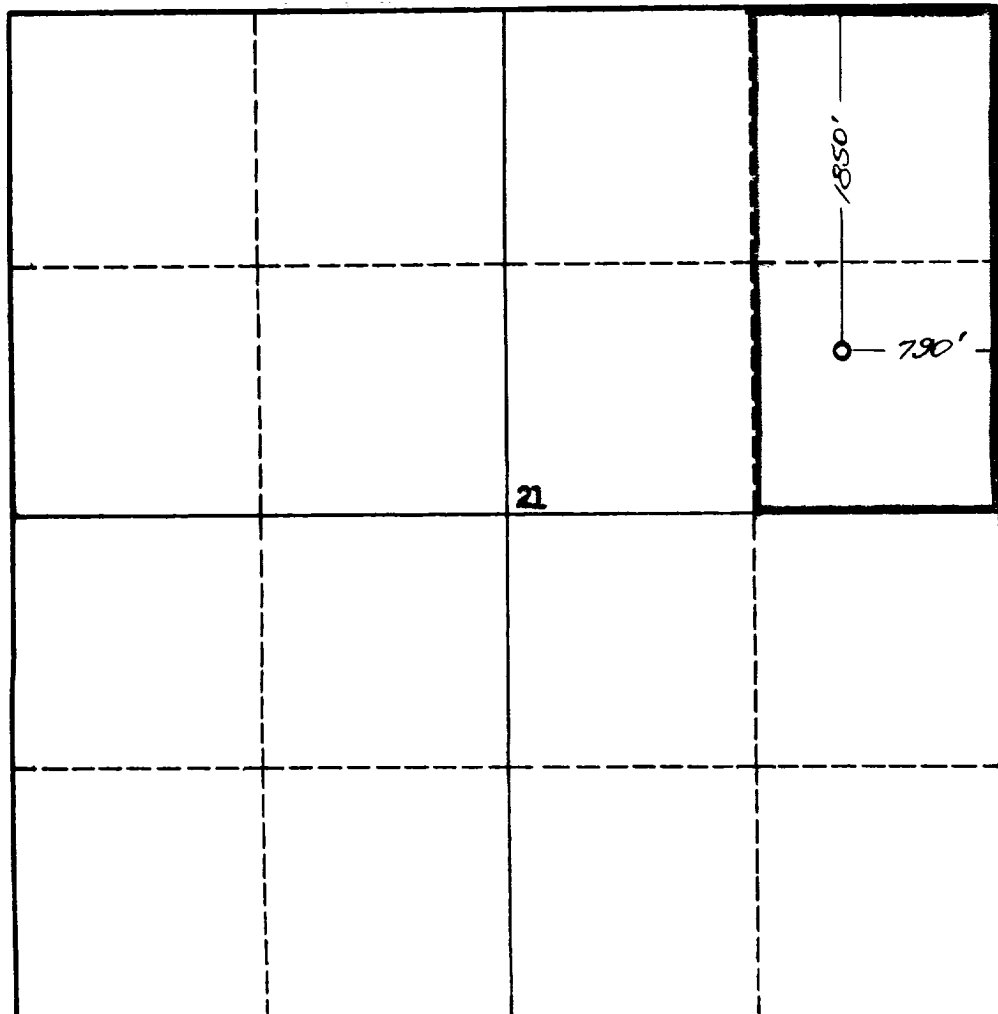

CERTIFICATION

I hereby certify that the information in SECTION A above is true and complete to the best of my knowledge and belief.

Name	<i>J. L. Howland</i>
Position	District Engineer
Company	Standard Oil Company, Texas, 14. 0 Calif. 511
Date	7-14-61

I hereby certify that the well location shown on the plat in SECTION B was plotted from field notes of actual surveys made by me or under my supervision, and that the same is true and correct to the best of my knowledge and belief.

Date Surveyed	12 May 1961
Registered Professional Engineer and/or Land Surveyor	<i>James P. Leese</i> James P. Leese
Certificate No.	1463

0 330 660 990 1320 1650 1980 2310 2640 2000 1500 1000 500 0

INSTRUCTIONS FOR COMPLETION OF FORM C-128

1. Operator shall furnish and certify to the information called for in Section A.
2. Operator shall outline the dedicated acreage for *both* oil and gas wells on the plat in Section B.
3. A registered professional engineer or land surveyor registered in the State of New Mexico or approved by the Commission shall show on the plat the location of the well and certify this information in the space provided.
4. All distances shown on the plat must be from the outer boundaries of the Section.
5. If additional space is needed for listing owners and their respective interests as required in question 3 of Section A, please use space below.