

X			

(SUBMIT IN TRIPLICATE)

UNITED STATES
DEPARTMENT OF THE INTERIOR
GEOLOGICAL SURVEY

Indian Agency _____
Jicarilla Apache
Allottee _____
Lease No. **36**

Sec. 21 **SUNDRY NOTICES AND REPORTS ON WELLS**

NOTICE OF INTENTION TO DRILL	<input checked="" type="checkbox"/>	SUBSEQUENT REPORT OF WATER SHUT-OFF	
NOTICE OF INTENTION TO CHANGE PLANS		SUBSEQUENT REPORT OF SHOOTING OR ACIDIZING	
NOTICE OF INTENTION TO TEST WATER SHUT-OFF		SUBSEQUENT REPORT OF ALTERING CASING	
NOTICE OF INTENTION TO REDRILL OR REPAIR WELL		SUBSEQUENT REPORT OF REDRILLING OR REPAIR	
NOTICE OF INTENTION TO SHOOT OR ACIDIZE		SUBSEQUENT REPORT OF ABANDONMENT	
NOTICE OF INTENTION TO PULL OR ALTER CASING		SUPPLEMENTARY WELL HISTORY	
NOTICE OF INTENTION TO ABANDON WELL			

(INDICATE ABOVE BY CHECK MARK NATURE OF REPORT, NOTICE, OR OTHER DATA)

May 1, 19**62**

N. E. Haynes
Well No. **4** is located **1650** ft. from **[N]** line and **1020** ft. from **[W]** line of sec. **21**
NW/4 **Sec. 21** **T24N** **R5W** **NMPM**
(1/4 Sec. and Sec. No.) (Twp.) (Range) (Meridian)
Basin Dakota **Rio Arriba County** **New Mexico**
(Field) (County or Subdivision) (State or Territory)

The elevation of the derrick floor above sea level is **6626** ft.

DETAILS OF WORK

(State names of and expected depths to objective sands; show sizes, weights, and lengths of proposed casings; indicate sanding jobs, cementing points, and all other important proposed work)

We propose to drill this well with rotary tools to an estimated depth of 6850' to test the Dakota formation. Approximately 300' of 8 5/8" surface casing will be run & cemented to surface. If commercial production is encountered, the well will be completed following running 5 1/2" production casing and cementing as follows: the Dakota & Gallup formation will be cemented through the casing shoe and the Mesa Verde & Pictured Cliffs formations will be cemented through a stage collar at approximately 4700'.

I understand that this plan of work must receive approval in writing by the Geological Survey before operations may be commenced.

Company **Continental Oil Company**
Address **Box 3312**
Durango, Colorado
By **R. E. JENSEN**
Title **Asst. District Supt.**

1. The first of these is the fact that the
2. "1941" is a very common name for the
3. "1941" is a very common name for the
4. "1941" is a very common name for the
5. "1941" is a very common name for the
6. "1941" is a very common name for the
7. "1941" is a very common name for the
8. "1941" is a very common name for the
9. "1941" is a very common name for the
10. "1941" is a very common name for the

NUMBER OF COPIES RECEIVED	
DISTRIBUTION	
SANTA FE	
FILE	
U.S.G.S.	
LAND OFFICE	
TRANSPORTER	OIL GAS
PRODUCTION OFFICE	
OPERATOR	

NEW MEXICO OIL CONSERVATION COMMISSION
WELL LOCATION AND ACREAGE DEDICATION PLAT
 SEE INSTRUCTIONS FOR COMPLETING THIS FORM ON THE REVERSE SIDE

FORM C-128
Revised 5/1/57

SECTION A

Operator Continental Oil Company		Lease N. E. Haynes Apache		Well No. 4
Unit Letter E	Section 21	Township 24N	Range 5W	County Rio Arriba
Actual Footage Location of Well: 1650 feet from the North line and 1020 feet from the West line				
Ground Level Elev. 6612 Ft.	Producing Formation Dakota	Pool Basin Dakota	Dedicated Acreage: 320 Acres	

1. Is the Operator the only owner in the dedicated acreage outlined on the plat below? YES ☒ NO _____. ("Owner" means the person who has the right to drill into and to produce from any pool and to appropriate the production either for himself or for himself and another. (65-3-29 (e) NMSA 1935 Comp.)
2. If the answer to question one is "no," have the interests of all the owners been consolidated by communitization agreement or otherwise? YES _____. If answer is "yes," Type of Consolidation _____
3. If the answer to question two is "no," list all the owners and their respective interests below:

Owner	Land Description

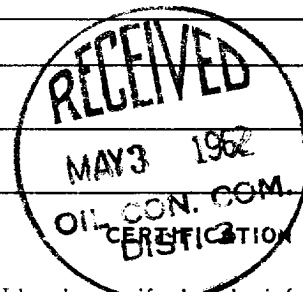

SECTION B

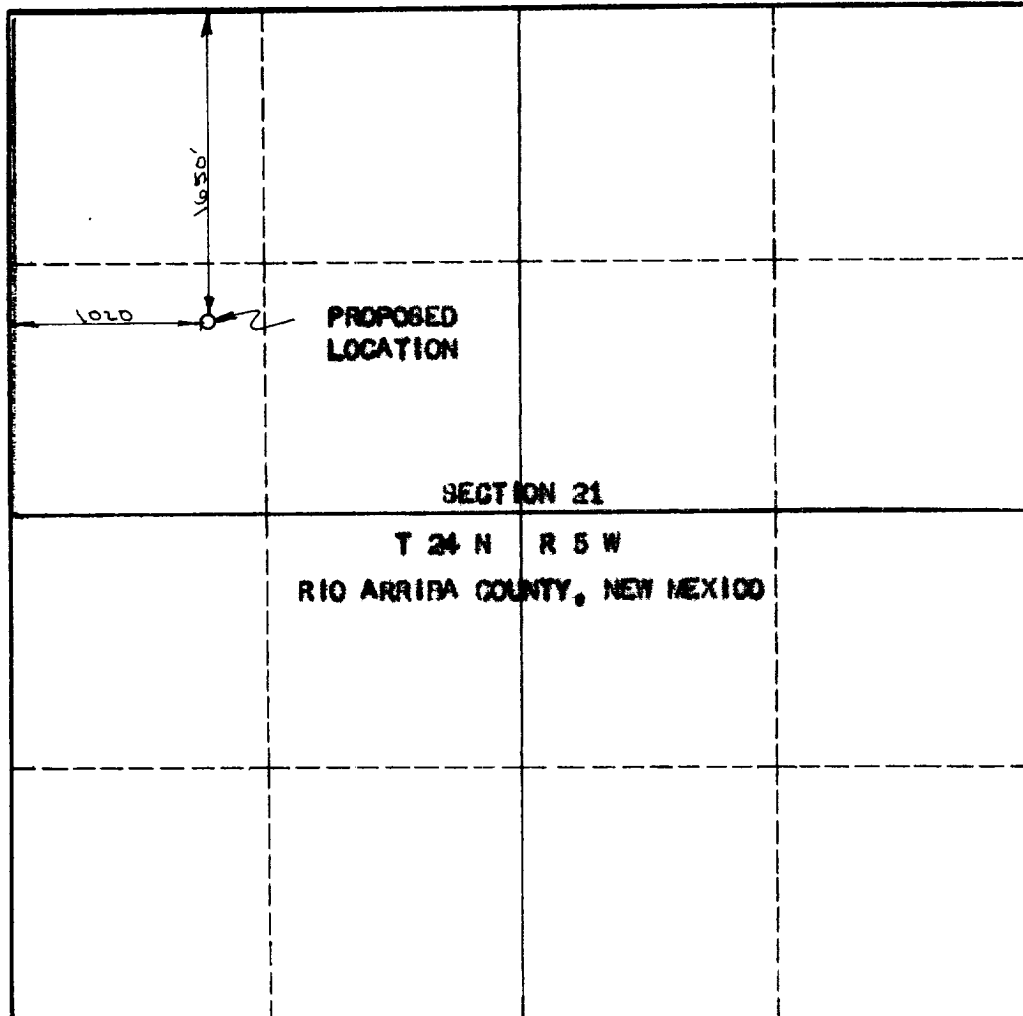

SECTION 21
T 24 N R 5 W
RIO ARRIBA COUNTY, NEW MEXICO

I hereby certify that the information in SECTION A above is true and complete to the best of my knowledge and belief.

Name	ORIGINAL SIGNED BY R. E. J. JENSEN
Position	Asst. District Supt.
Company	Continental Oil Company
Date	May 1, 1962

I hereby certify that the well location shown on the plat in SECTION B was plotted from field notes of actual surveys made by me or under my supervision, and that the same is true and correct to the best of my knowledge and belief.

Date Surveyed	4-23-62
Registered Professional Engineer and/or Land Surveyor	Edmund M. Clark

Certificate No. **73100**

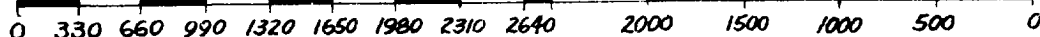

INSTRUCTIONS FOR COMPLETION OF FORM C-128

1. Operator shall furnish and certify to the information called for in Section A.
2. Operator shall outline the dedicated acreage for *both* oil and gas wells on the plat in Section B.
3. A registered professional engineer or land surveyor registered in the State of New Mexico or approved by the Commission shall show on the plat the location of the well and certify this information in the space provided.
4. All distances shown on the plat must be from the outer boundaries of the Section.
5. If additional space is needed for listing owners and their respective interests as required in question 3 of Section A, please use space below.