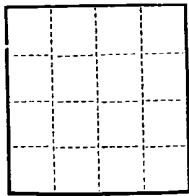

(SUBMIT IN TRIPLICATE)

UNITED STATES
DEPARTMENT OF THE INTERIOR
GEOLOGICAL SURVEYLand Office N. M. and S. F.
Lease No. Gilcrease NMO3754
Gardner SF081347
Unit _____

SUNDRY NOTICES AND REPORTS ON WELLS

NOTICE OF INTENTION TO DRILL.....	<input checked="" type="checkbox"/>	SUBSEQUENT REPORT OF WATER SHUT-OFF.....
NOTICE OF INTENTION TO CHANGE PLANS.....	<input type="checkbox"/>	SUBSEQUENT REPORT OF SHOOTING OR ACIDIZING.....
NOTICE OF INTENTION TO TEST WATER SHUT-OFF.....	<input type="checkbox"/>	SUBSEQUENT REPORT OF ALTERING CASING.....
NOTICE OF INTENTION TO RE-DRILL OR REPAIR WELL.....	<input type="checkbox"/>	SUBSEQUENT REPORT OF RE-DRILLING OR REPAIR.....
NOTICE OF INTENTION TO SHOOT OR ACIDIZE.....	<input type="checkbox"/>	SUBSEQUENT REPORT OF ABANDONMENT.....
NOTICE OF INTENTION TO PULL OR ALTER CASING.....	<input type="checkbox"/>	SUPPLEMENTARY WELL HISTORY.....
NOTICE OF INTENTION TO ABANDON WELL.....	<input type="checkbox"/>	

(INDICATE ABOVE BY CHECK MARK NATURE OF REPORT, NOTICE, OR OTHER DATA)

November 16, 1957

Gilcrease-Gardner
Well No. 1 is located 1710 ft. from ~~xxx~~ [S] line and 825 ft. from ~~xxx~~ [E] line of sec. 17
SE₄ of Sec. 17 T24N R3W NMPM
(1/4 Sec. and Sec. No.) (Twp.) (Range) (Meridian)
S. Blanco Rio Arriba New Mexico
(Field) (County or Subdivision) (State or Territory)

The elevation of the derrick floor above sea level is 7143 ft.

DETAILS OF WORK

(State names of and expected depths to objective sands; show sizes, weights, and lengths of proposed casings; indicate mudding jobs, cementing points, and all other important proposed work)

Set 8 5/8" surface casing @ 125' with 100 sx.
Drill to approximately 3200' and set 5 1/2" 15.5# casing with 100 sx.
Pictured Cliffs perforated, sand water fracture and run 2" tubing.

I understand that this plan of work must receive approval in writing by the Geological Survey before operations may be commenced.

Company Hugh McMillan
Address Post Office Box 1612
El Paso, Texas

By Jay J. Harris
Jay J. Harris
Title Geologist

1. The first step in the process is to identify the problem or issue that needs to be addressed. This involves gathering information and understanding the context of the problem.

... ..

NEW MEXICO OIL CONSERVATION COMMISSION

Well Location and Acreage Dedication Plat

Section A.

Date November 16, 1957

Operator Hugh McMillan Lease Oil Lease
 Well No. 1 Unit Letter I Section 17 Township 24 North Range 3 West NMPN
 Located 1710 Feet From South Line, 825 Feet From East Line
 County El Arriba G. L. Elevation 7133 Dedicated Acreage 1/40 Acres
 Name of Producing Formation Pictured Cliffs Pool S. Blanes P.C.

1. Is the Operator the only owner* in the dedicated acreage outlined on the plat below?
 Yes I No _____.
2. If the answer to question one is "no," have the interests of all the owners been consolidated by communitization agreement or otherwise? Yes _____ No _____. If answer is "yes,"
 Type of Consolidation _____
3. If the answer to question two is "no," list all the owners and their respective interests below:

OwnerLand Description

RECEIVED
 NOV 18 1957
 U. S. GEOLOGICAL SURVEY
 WASHINGTON, NEW MEXICO

Section B

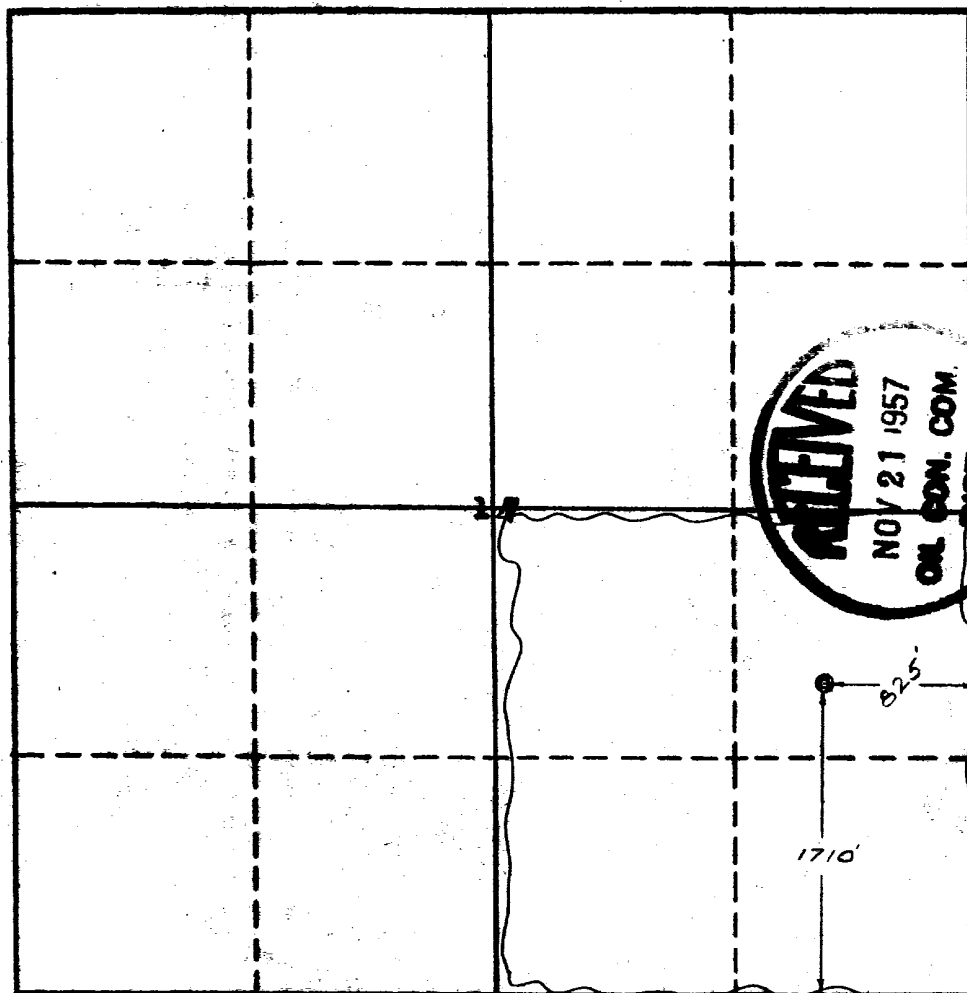

This is to certify that the information in Section A above is true and complete to the best of my knowledge and belief.

Hugh McMillan
 (Operator)

Jay J. Harris
 (Representative)

Box 1612, El Paso, Tex.
 Address

This is to certify that the well location shown on the plat in Section B was plotted from field notes of actual surveys made by me or under my supervision and that the same is true and correct to the best of my knowledge and belief.

Date Surveyed June 25, 1957

Ernest V. Echobawk
 Ernest V. Echobawk
 Registered Land Surveyor.

Certificate No. 1545

