

(SUBMIT IN TRIPLICATE)

UNITED STATES
DEPARTMENT OF THE INTERIOR
GEOLOGICAL SURVEY

Land Office **Santa Fe**
Lease No. **SF 079086**
Unit **Mexico-Ped #3**

SUNDRY NOTICES AND REPORTS ON WELLS

NOTICE OF INTENTION TO DRILL.....	<input checked="" type="checkbox"/>	SUBSEQUENT REPORT OF WATER SHUT-OFF.....	
NOTICE OF INTENTION TO CHANGE PLANS.....		SUBSEQUENT REPORT OF SHOOTING OR ACIDIZING.....	
NOTICE OF INTENTION TO TEST WATER SHUT-OFF.....		SUBSEQUENT REPORT OF ALTERING CASING.....	
NOTICE OF INTENTION TO RE-DRILL OR REPAIR WELL.....		SUBSEQUENT REPORT OF RE-DRILLING OR REPAIR.....	
NOTICE OF INTENTION TO SHOOT OR ACIDIZE.....		SUBSEQUENT REPORT OF ABANDONMENT.....	
NOTICE OF INTENTION TO PULL OR ALTER CASING.....		SUPPLEMENTARY WELL HISTORY.....	
NOTICE OF INTENTION TO ABANDON WELL.....			

(INDICATE ABOVE BY CHECK MARK NATURE OF REPORT, NOTICE, OR OTHER DATA)

Mexico-Ped #3 June 21, 1960

Well No. **1** is located **1490** ft. from **{N}** line and **1490** ft. from **{E}** line of sec. **18**

N/4 Section 18 **24N** **4W** **18PM**

(1/4 Sec. and Sec. No.) (Twp.) (Range) (Meridian)

Undesignated Dakota **Rio Arriba** **New Mexico**

(Field) (County or Subdivision) (State or Territory)

The elevation of the derrick floor above sea level is _____ ft.

DETAILS OF WORK

(State names of and expected depths to objective sands; show sizes, weights, and lengths of proposed casings; indicate mudding jobs, cement-
ing points, and all other important proposed work.)

It is our intention to drill well No. 1 to around 6690' to test the Dakota formation. The Gallup formation will be tested and if production is found to be of commercial value in both Dakota and Gallup formations, the well will be dual completed. Our casing program is as follows:

300' of 10-3/4" OD casing 32.75% B-40, with 300 sacks regular cement, to be circulated.

6690' of 7" OD casing, cemented with 600 sacks of regular cement, 2 - staged

The designated drilling unit is the N/4 of section 18-24N-4W, Rio Arriba County, New Mexico

I understand that this plan of work must receive approval in writing by the Geological Survey before operations may be commenced.

Company **Shelly Oil Company**
Address **Drawer 910**
Farmington, New Mexico

By **[Signed] P. E. Gosper**
Title **District Superintendent**

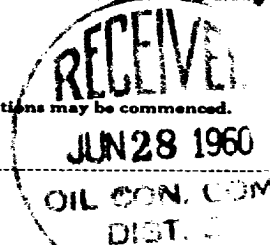

NEW MEXICO OIL CONSERVATION COMMISSION
WELL LOCATION AND ACREAGE DEDICATION PLAT

FORM C-128
 Revised 5/1/57

SEE INSTRUCTIONS FOR COMPLETING THIS FORM ON THE REVERSE SIDE

SECTION A

Operator SKELLY OIL COMPANY		Lease NEW MEXICO OIL COMPANY		Well No. 1
Unit Letter F	Section 18	Township 24 NORTH	Range 6 WEST	County RIO ARriba
Actual Footage Location of Well: 1650 feet from the NORTH line and 1850 feet from the WEST line				
Ground Level Elev.	Producing Formation Sabine	Pool Undesignated	Dedicated Acreage: 329.00 Acres	

Ref. GLO plat dated 4 November 1882

1. Is the Operator the only owner in the dedicated acreage outlined on the plat below? YES ☒ NO ☐ . ("Owner" means the person who has the right to drill into and to produce from any pool and to appropriate the production either for himself or for himself and another. (65-3-29 (e) NMSA 1935 Comp.)
2. If the answer to question one is "no," have the interests of all the owners been consolidated by communitization agreement or otherwise? YES ☐ NO ☐ . If answer is "yes," Type of Consolidation _____
3. If the answer to question two is "no," list all the owners and their respective interests below:

Owner	Land Description

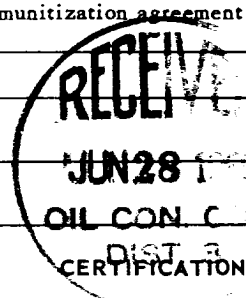

SECTION B

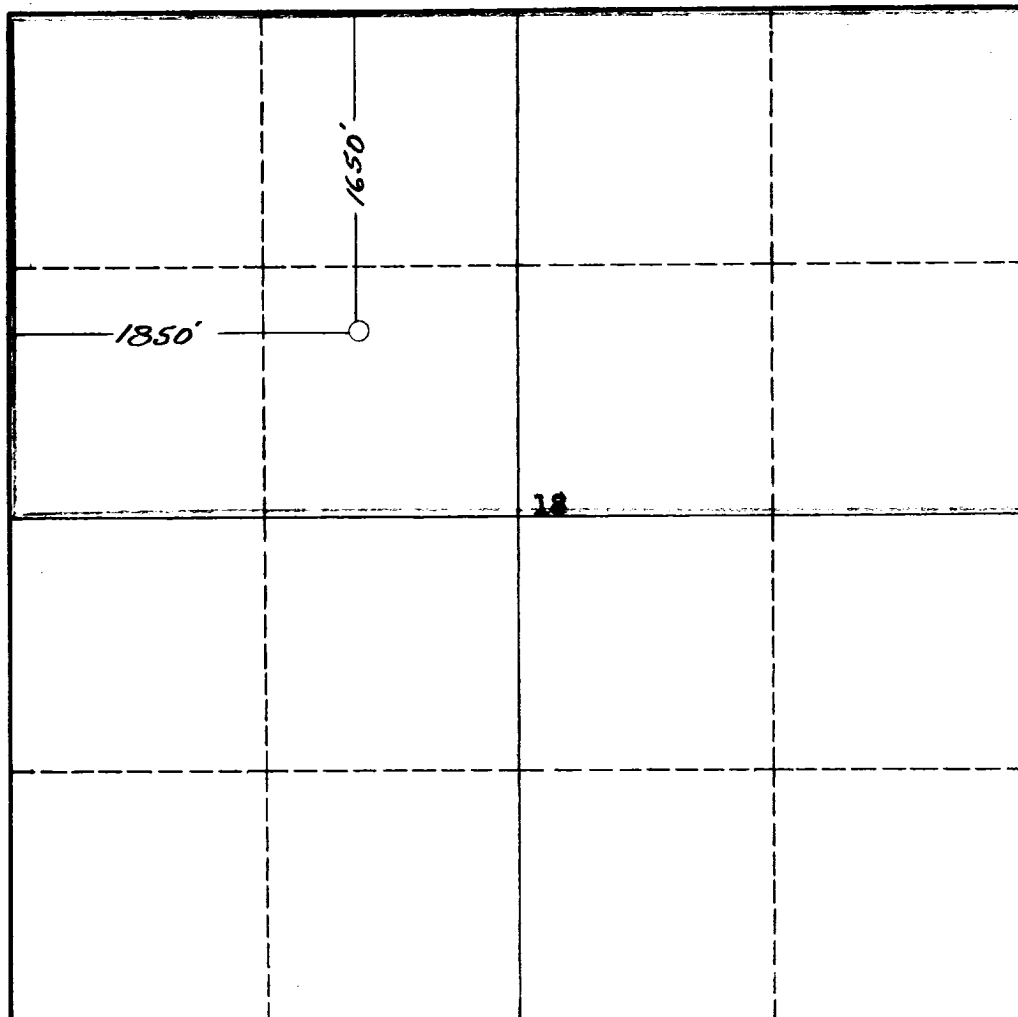

I hereby certify that the information in SECTION A above is true and complete to the best of my knowledge and belief.

Name (Signed) P. E. Cosper
Position District Superintendent
Company Skelly Oil Company
Date June 27, 1960

I hereby certify that the well location shown on the plat in SECTION B was plotted from field notes of actual surveys made by me or under my supervision, and that the same is true and correct to the best of my knowledge and belief.

Date Surveyed 20 June 1960
Registered Professional Engineer and/or Land Surveyor James P. Leone
Certificate No. 1463

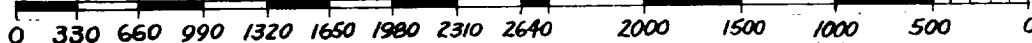

INSTRUCTIONS FOR COMPLETION OF FORM C-128

1. Operator shall furnish and certify to the information called for in Section A.
2. Operator shall outline the dedicated acreage for *both* oil and gas wells on the plat in Section B.
3. A registered professional engineer or land surveyor registered in the State of New Mexico or approved by the Commission shall show on the plat the location of the well and certify this information in the space provided.
4. All distances shown on the plat must be from the outer boundaries of the Section.
5. If additional space is needed for listing owners and their respective interests as required in question 3 of Section A, please use space below.