

(SUBMIT IN TRIPLICATE)

UNITED STATES
DEPARTMENT OF THE INTERIOR
GEOLOGICAL SURVEY

Land Office Santa Fe
Lease No. NE-C12500-A
Unit _____

SUNDRY NOTICES AND REPORTS ON WELLS

NOTICE OF INTENTION TO DRILL	<input checked="" type="checkbox"/>	SUBSEQUENT REPORT OF WATER SHUT-OFF	
NOTICE OF INTENTION TO CHANGE PLANS		SUBSEQUENT REPORT OF SHOOTING OR ACIDIZING	
NOTICE OF INTENTION TO TEST WATER SHUT-OFF		SUBSEQUENT REPORT OF ALTERING CASING	
NOTICE OF INTENTION TO RE-DRILL OR REPAIR WELL		SUBSEQUENT REPORT OF RE-DRILLING OR REPAIR	
NOTICE OF INTENTION TO SHOOT OR ACIDIZE		SUBSEQUENT REPORT OF ABANDONMENT	
NOTICE OF INTENTION TO PULL OR ALTER CASING		SUPPLEMENTARY WELL HISTORY	
NOTICE OF INTENTION TO ABANDON WELL			

(INDICATE ABOVE BY CHECK MARK NATURE OF REPORT, NOTICE, OR OTHER DATA)

RECEIVED
MAY 2 1956
U. S. GEOLOGICAL SURVEY
FARMINGTON, NEW MEXICO

_____ Nov 13, 1956 _____, 19____

Quocia
Well No. 1 is located 1650 ft. from [S] line and 1190 ft. from [W] line of sec. 14

SW - Sec. 14 24N 1W N.M.P.M.
(1/4 Sec. and Sec. No.) (Twp.) (Range) (Meridian)

Wilcox Rio Arriba Co. New Mexico
(Field) (County or Subdivision) (State or Territory)

The elevation of the ^{G/L}derrick floor above sea level is 7552 ft.

DETAILS OF WORK

(State names of and expected depths to objective sands; show sizes, weights, and lengths of proposed casings; indicate mudding jobs, cementing points, and all other important proposed work)

Drill 150' w/cable tools - run 8 5/8" surface pipe,
Cement 7/150 sks regular cement.

Drill w/rotary tools to Pictured Cliffs and test.
Run 5 1/2" casing - cement 7/150 sks reg. cement.
Complete by frac.

I understand that this plan of work must receive approval in writing by the Geological Survey before operations may be commenced.

Company H.B. Jackson

Address Box 891,

Farmington, New Mex.

By H.B. Jackson

Title Cover

NEW MEXICO
OIL CONSERVATION COMMISSION

Form C-128

Well Location and/or Gas Proration Plat

Date _____

Operator **R. E. Jackson**

Lease _____

Well No. **Cuccia #1** Section **14** Township **24 North** Range **1 West** NMPM

Located **1650** Feet From **South** Line, **1190** Feet From **West** Line,

Rio Arriba

County, New Mexico. G. L. Elevation **7152**

Name of Producing Formation

P.C.

Pool

W. cat

Dedicated Acreage **80**

(Note: All distances must be from outer boundaries of Section)

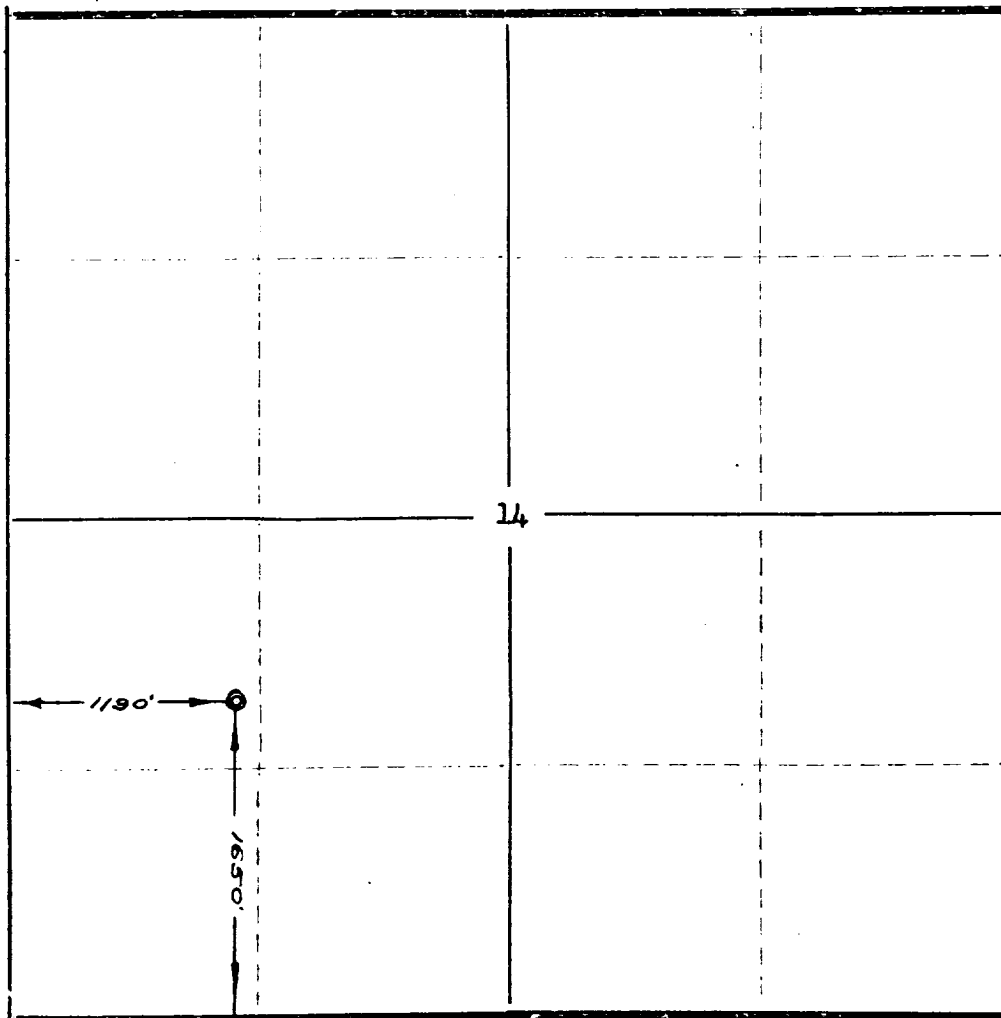

NOTE

This section of form is to be used for gas wells only.

SCALE: 1" = 1000'

1. Is this Well a Dual Comp. ? Yes ☒ No ☐
2. If the answer to Question 1 is yes, are there any other dually completed wells within the dedicated acreage?
Yes ☐ No ☐

Name **R. E. JACKSON**

Position **OWNER**

Representing

Address **Box 891 - Farmington, N. Mex.**

This is to certify that the above plat was prepared from field notes of actual surveys made by me or under my supervision and that the same are true and correct to the best of my knowledge and belief.

Date Surveyed **May 15, 1956**

Ernest V. Echhawk

Ernest V. Echhawk
Reg. Land Surveyor, N. Mex., Reg. No. 1545