

(SUBMIT IN TRIPLICATE)

UNITED STATES
DEPARTMENT OF THE INTERIOR
GEOLOGICAL SURVEY

Land Office Santa Fe
Lease No. 078913
Unit Lindrith Unit

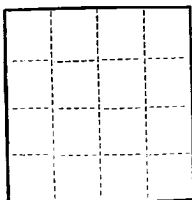

SUNDRY NOTICES AND REPORTS ON WELLS

NOTICE OF INTENTION TO DRILL	<input checked="" type="checkbox"/>	SUBSEQUENT REPORT OF WATER SHUT-OFF
NOTICE OF INTENTION TO CHANGE PLANS		SUBSEQUENT REPORT OF SHOOTING OR ACIDIZING
NOTICE OF INTENTION TO TEST WATER SHUT-OFF		SUBSEQUENT REPORT OF ALTERING CASING
NOTICE OF INTENTION TO RE-DRILL OR REPAIR WELL		SUBSEQUENT REPORT OF RE-DRILLING OR REPAIR
NOTICE OF INTENTION TO SHOOT OR ACIDIZE		SUBSEQUENT REPORT OF ABANDONMENT
NOTICE OF INTENTION TO PULL OR ALTER CASING		SUPPLEMENTARY WELL HISTORY
NOTICE OF INTENTION TO ABANDON WELL		

(INDICATE ABOVE BY CHECK MARK NATURE OF REPORT, NOTICE, OR OTHER DATA)

May 23, 19 61

Well No. 41 is located 1840 ft. from 100 line and 1460 ft. from 100 line of sec. 15

S.W. Section 15 24-N 3-W N.M.P.M.
($\frac{1}{4}$ Sec. and Sec. No.) (Twp.) (Range) (Meridian)

So. Blanco Pictured Cliffs Rio Arriba New Mexico
(Field) (County or Subdivision) (State or Territory)

The elevation of the derrick floor above sea level is 7015 ft.

DETAILS OF WORK

(State names of and expected depths to objective sands; show sizes, weights, and lengths of proposed casings; indicate mudding jobs, cementing points, and all other important proposed work)

It is Intended to drill a well with rotary tools thru the Pictured Cliffs formation, and to perforate and fracture possible productive zones. Estimated T.D. 3234'.

Casing Program:

9 5/8" set at 100' with 140 sacks of cement. Circulate to surface.
2 7/8" set at 3234' with 150 sacks of cement - 150% to cover Ojo Alamo

The SW/4 of Section 15 is dedicated to this well.

I understand that this plan of work must receive approval in writing by the Geological Survey before operations may be commenced.

Company El Paso Natural Gas Company

Address Box 990

Farmington, New Mexico

By Original Signed G. W. Maehan

Title Petroleum Engineer

NEW MEXICO OIL CONSERVATION COMMISSION

Well Location and Acreage Dedication Plat

Section A.

Date **May 11, 1961**

Operator **EL PASO NATURAL GAS COMPANY** Lease **LINDRITH UNIT** SF **078913**
 Well No. **41** Unit Letter **K** Section **15** Township **24-N** Range **3-W** NMPM
 Located **1840** Feet From **SOUTH** Line **1460** Feet From **WEST** Line
 County **RIO ARriba** G. L. Elevation **7005** Dedicated Acreage **160** Acres
 Name of Producing Formation **PICTURED CLIFFS** Pool **SO. BLANCO P.C.**

1. Is the Operator the only owner in the dedicated acreage outlined on the plat below?
 Yes ☒ No ☐
2. If the answer to question one is "no", have the interests of all the owners been consolidated by communization agreement or otherwise? Yes ☐ No ☐ If answer is "yes", Type of Consolidation.

3. If the answer to question two is "no", list all the owners and their respective interests below:

Owner	Land Description

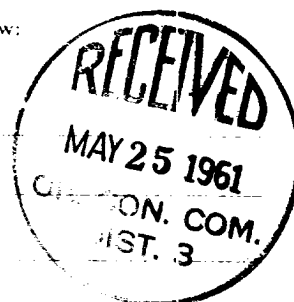

Section B.

Note: All distances must be from outer boundaries of section.

This is to certify that the information in Section A above is true and complete to the best of my knowledge and belief.

El Paso Natural Gas Company
 (Operator)

Original Signed **D. W. Meehan**
 (Representative)

Box 990
 (Address)

Farmington, New Mexico

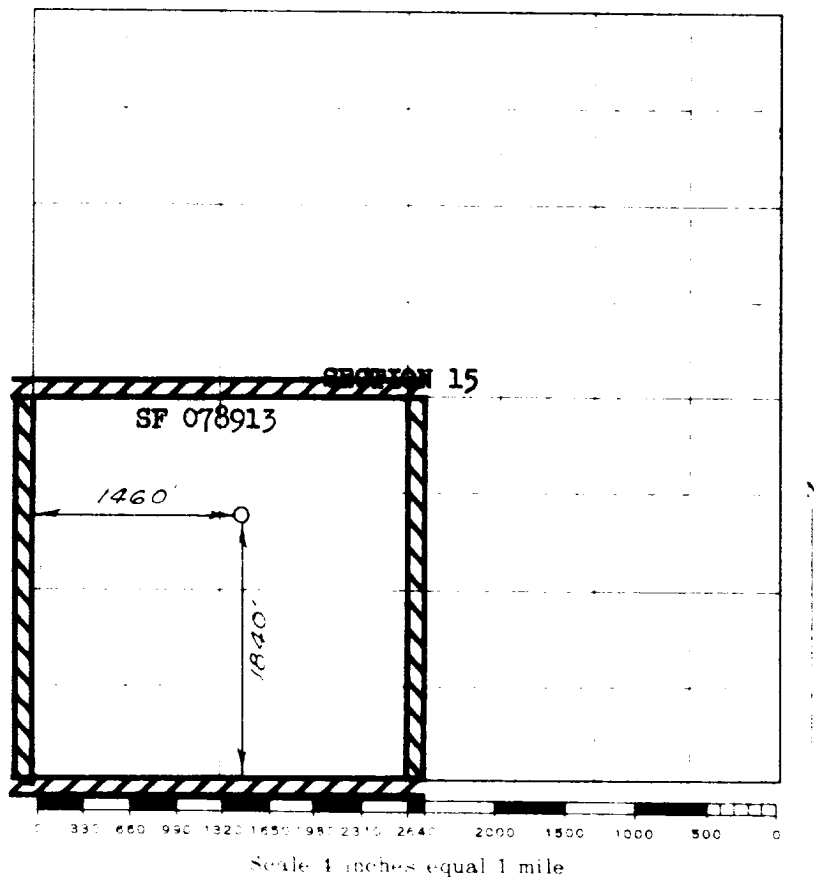

Scale 1 inch equals 1 mile

This is to certify that the above plat was prepared from field notes of actual surveys made by me or under my supervision and that the same are true and correct to the best of my knowledge and belief.

(Seal)

Date Surveyed **May 9, 1961**

David O. Vihlen
 Registered Professional Engineer and/or Land Surveyor

Farmington, New Mexico