

(SUBMIT IN TRIPLICATE)

UNITED STATES
DEPARTMENT OF THE INTERIOR
GEOLOGICAL SURVEY

Land Office
Lease No.
Unit 14-08-001-1059
Canyon Largo Unit

SUNDRY NOTICES AND REPORTS ON WELLS

NOTICE OF INTENTION TO DRILL	<input checked="" type="checkbox"/>	SUBSEQUENT REPORT OF WATER SHUT-OFF
NOTICE OF INTENTION TO CHANGE PLANS		SUBSEQUENT REPORT OF SHOOTING OR ACIDIZING
NOTICE OF INTENTION TO TEST WATER SHUT-OFF		SUBSEQUENT REPORT OF ALTERING CASING
NOTICE OF INTENTION TO RE-DRILL OR REPAIR WELL		SUBSEQUENT REPORT OF RE-DRILLING OR REPAIR
NOTICE OF INTENTION TO SHOOT OR ACIDIZE		SUBSEQUENT REPORT OF ABANDONMENT
NOTICE OF INTENTION TO PULL OR ALTER CASING		SUPPLEMENTARY WELL HISTORY
NOTICE OF INTENTION TO ABANDON WELL		

INDICATE ABOVE BY CHECK MARK NATURE OF REPORT, NOTICE, OR OTHER DATA.

March 1, 1963

Well No. 122 is located 1650 ft. from ~~NXX~~ S line and 835 ft. from ~~NXX~~ E line of sec. 17

NE/4 SE/4 Section 17
(1/4 Sec. and Sec. No.)

24N
(Twp.)

6W
(Range)

NMPM
(Meridian)

Devils Fork Gallup
(Field)

Rio Arriba
(County or Subdivision)

New Mexico
(State or Territory)

RECEIVED

The elevation of the derrick floor above sea level is 6606 ft.

MAR 5 1963

DETAILS OF WORK

(State names of and expected depths to objective sands; show sizes, weights, and lengths of proposed casings; indicate mudding jobs, cementing points, and all other important proposed work)

U. S. GEOLOGICAL SURVEY
DISTRICT NEW MEXICO

It is intended to drill a well thru the Gallup Formation using rotary tools and mud circulation. Possible productive intervals will be perforated and sandoil fractured. A two-stage collar will be set 100' below bottom of Picture Cliffs and this zone cemented off. Estimated Total Depth 5600'.

Casing Program:

8-5/8" at 160' with 150 sacks cement circulated to surface.

4-1/2" at 5600' with 150 sacks cement--first stage; 100 sacks cement--second stage. Estimated top of cement first stage 4600', second stage 1800'.

The E/2 SE/4 of Section 17 is dedicated to this well.

E/2 SE/4 Section 17 14-08-001-1059.

I understand that this plan of work must receive approval in writing by the Geological Survey before operations may be commenced.

Company El Paso Natural Gas Products Company

Address Post Office Box 1560

Farmington, New Mexico

By Original Signed EWELL N. WALSH

Title Division Petroleum Engineer

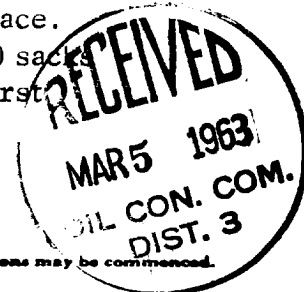

NEW MEXICO OIL CONSERVATION COMMISSION

Well Location and Acreage Dedication Plat

SECTION A.

Date **March 1, 1963**

Operator **El Paso Natural Gas Products Company** Lease **Largo Canyon Unit 14-03-001-1000**
Well No. **122** Unit Letter **I** Section **17** Township **24 North** Range **6 West** NMPM
Located **1650** Feet From **South** Line, **835** Feet From **East** Line
County **Rio Arriba** G. L. Elevation **6595** Dedicated Acreage **80** Acres
Name of Producing Formation **Gallup** Pool **Dartles Peak**

1. Is the Operator the only owner* in the dedicated acreage outlined on the plat below? Yes ☒ No ☐
2. If the answer to question One is "No," have the interests of all the owners been consolidated by communitization agreement or otherwise? Yes ☐ No ☐ If answer is "Yes," Type of Consolidation _____
3. If the answer to question Two is "No," list all the owners and their respective interests below:

OWNER

LAND DESCRIPTION

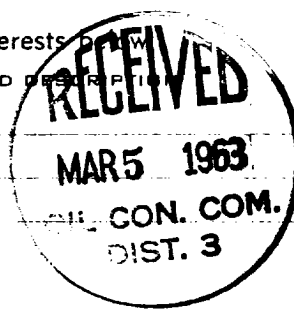

SECTION B.

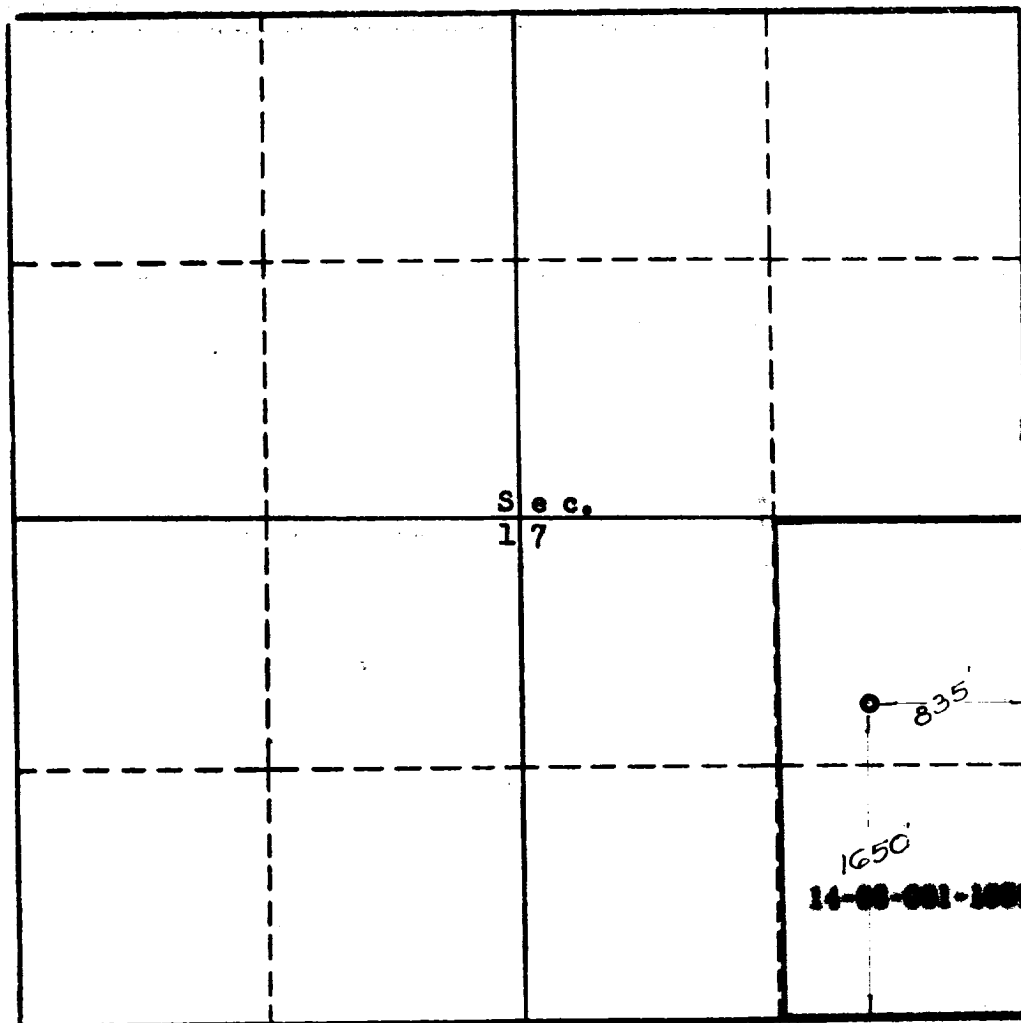

This is to certify that the information in Section A above is true and complete to the best of my knowledge and belief.

El Paso Natural Gas Products Co.

(OPERATOR)

Original Signed **EWELL N. WALSH**

(REPRESENTATIVE)

P. O. Box 1840, Farmington, N. M.

(ADDRESS)

This is to certify that the well location shown on the plat in Section B was plotted from field notes of actual surveys made by me or under my supervision and that the same is true and correct to the best of my knowledge and belief.

Date Surveyed **February 26, 1963**

Four States Engineering Co.
FARMINGTON, NEW MEXICO

Emmett V. Eckhardt
REGISTERED ENGINEER OR
LAND SURVEYOR

Certificate No. **3602**

