

1-5305
1-Redfern & Nord
1-File

Budget Bureau No. 42-R358.4.
Approval expires 12-31-60.

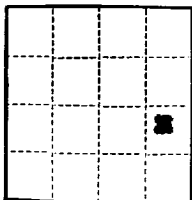

(SUBMIT IN TRIPLICATE)

UNITED STATES
DEPARTMENT OF THE INTERIOR
GEOLOGICAL SURVEY

Land Office **Santa Fe**
Lease No. **27 070342**
Unit _____

SUNDRY NOTICES AND REPORTS ON WELLS

NOTICE OF INTENTION TO DRILL	<input checked="" type="checkbox"/>	SUBSEQUENT REPORT OF WATER SHUT-OFF	
NOTICE OF INTENTION TO CHANGE PLANS		SUBSEQUENT REPORT OF SHOOTING OR ACIDIZING	
NOTICE OF INTENTION TO TEST WATER SHUT-OFF		SUBSEQUENT REPORT OF ALTERING CASING	
NOTICE OF INTENTION TO RE-DRILL OR REPAIR WELL		SUBSEQUENT REPORT OF RE-DRILLING OR REPAIR	
NOTICE OF INTENTION TO SHOOT OR ACIDIZE		SUBSEQUENT REPORT OF ABANDONMENT	
NOTICE OF INTENTION TO PULL OR ALTER CASING		SUPPLEMENTARY WELL HISTORY	
NOTICE OF INTENTION TO ABANDON WELL			

(INDICATE ABOVE BY CHECK MARK NATURE OF REPORT, NOTICE, OR OTHER DATA)

RECEIVED
DEC 15 1959

December 7

U. S. GEOLOGICAL SURVEY
FARMINGTON, NEW MEXICO

Well No. **2** is located **1830** ft. from **14N** line and **790** ft. from **7E** line of sec. **13**
NE 21 Sec 13 **24N** **7W** **14PM**
(1/4 Sec. and Sec. No.) (Twp.) (Range) (Meridian)
Undesignated **Rio Arriba** **New Mexico**
(Field) (County or Subdivision) (State or Territory)

The elevation of the derrick floor above sea level is **6609** ft.

DETAILS OF WORK

(State names of and expected depths to objective sands; show sizes, weights, and lengths of proposed casings; indicate mudding jobs, cementing points, and all other important proposed work)

Propose to drill 12 1/2" hole to 220'. Set 7-5/8" 32.30# csg and cement w/125
sx reg cement. Drill 7-7/8" hole to approximately 6700' to test Gallup and
Bakota fm - If either formation found commercially producing set 9" 15.5#
csg. Cement w/300 sx cement.

Verbal approval 12-4-59 - Bill Shager.

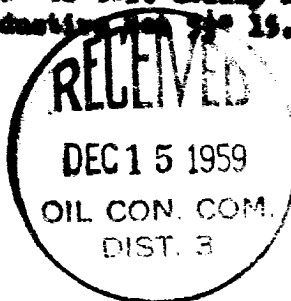

I understand that this plan of work must receive approval in writing by the Geological Survey before operations may be commenced.

Company **Redfern & Nord**
Address **Box 1747**
Midland, Texas

Original signed by T. A. Dugan

By _____
Title **Consulting Engineer**

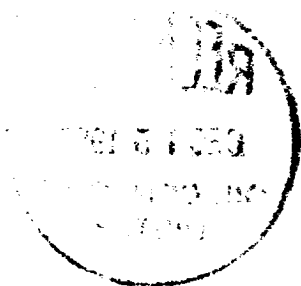

NEW MEXICO OIL CONSERVATION COMMISSION

Well Location and Acreage Dedication Plat

Section A.

Date 12-4-59

Operator Redfern and Hord Lease Large Spur
Well No. 2 Unit Letter X Section 13 Township 24 North Range 7 West NMPM
Located 1850 Feet From South Line, 790 Feet From East Line
County Rio Arriba G. L. Elevation 6599 Dedicated Acreage 130 Acres
Name of Producing Formation San Juan Pool Undesignated

1. Is the Operator the only owner* in the dedicated acreage outlined on the plat below?
Yes X No
2. If the answer to question one is "no," have the interests of all the owners been consolidated by communitization agreement or otherwise? Yes No . If answer is "yes,"
Type of Consolidation
3. If the answer to question two is "no," list all the owners and their respective interests below:

Owner

Land Description

RECEIVED
DEC 15 1959

OIL
DIST

Section B.

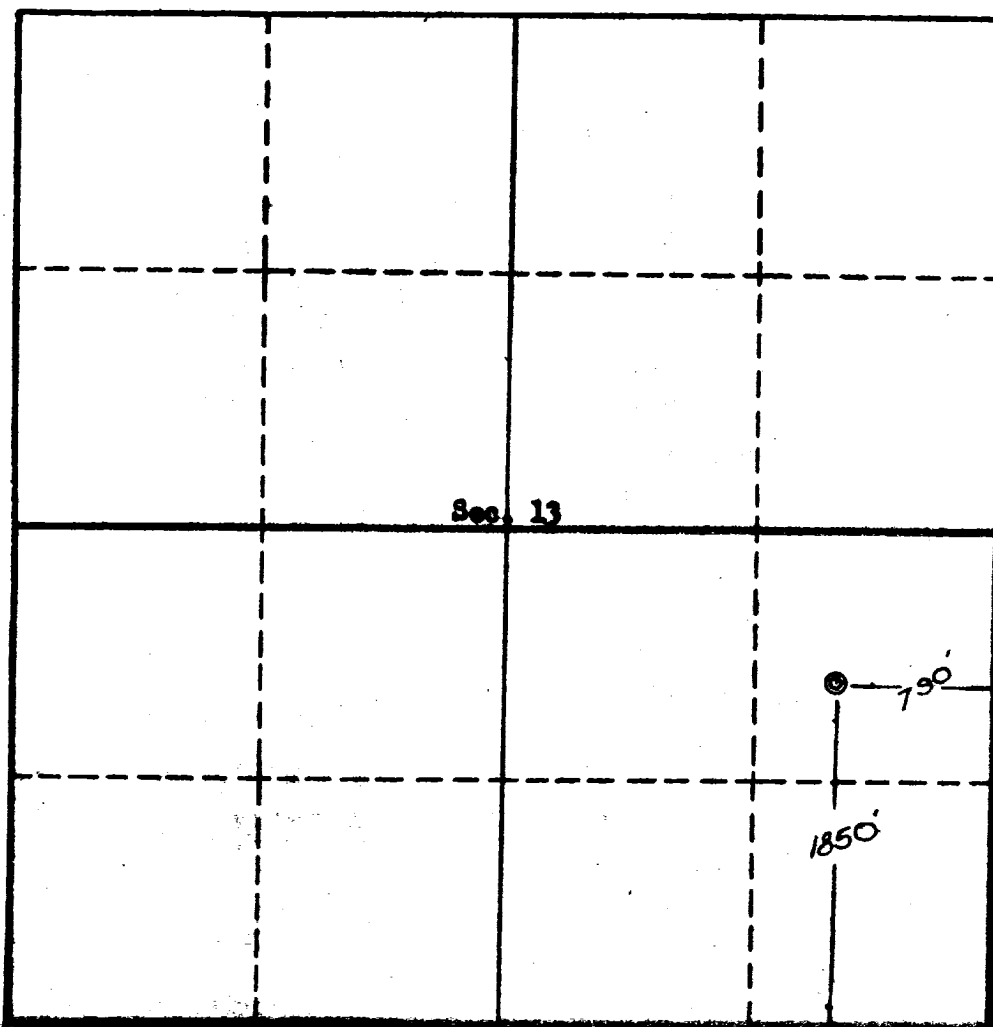

This is to certify that the information in Section A above is true and complete to the best of my knowledge and belief.

Redfern & Hord

(Operator)

Original signed by T. A. Dugan
(Representative)

Box 1747, Midland, Texas

Address

This is to certify that the well location shown on the plat in Section B was located from field notes of a survey made by me or under my supervision and the same is true to the best of my knowledge and belief.

Date Surveyed Nov. 24, 1959

Ernest V. Echobawk
Ernest V. Echobawk
Registered Land Surveyor.

Certificate No. 1545

1

1

110