

(SUBMIT IN TRIPLICATE)

UNITED STATES
DEPARTMENT OF THE INTERIOR
GEOLOGICAL SURVEY

Land Office Santa Fe
Lease No. NM-03595-A
Unit Colean Federal

SUNDRY NOTICES AND REPORTS ON WELLS

NOTICE OF INTENTION TO DRILL	<input checked="" type="checkbox"/>	SUBSEQUENT REPORT OF WATER SHUT-OFF	<div style="text-align: right;"> RECEIVED APR 11 1960 U. S. GEOLOGICAL SURVEY FARMINGTON, NEW MEXICO </div>
NOTICE OF INTENTION TO CHANGE PLANS	<input type="checkbox"/>	SUBSEQUENT REPORT OF SHOOTING OR ACIDIZING	
NOTICE OF INTENTION TO TEST WATER SHUT-OFF	<input type="checkbox"/>	SUBSEQUENT REPORT OF ALTERING CASING	
NOTICE OF INTENTION TO RE-DRILL OR REPAIR WELL	<input type="checkbox"/>	SUBSEQUENT REPORT OF RE-DRILLING OR REPAIR	
NOTICE OF INTENTION TO SHOOT OR ACIDIZE	<input type="checkbox"/>	SUBSEQUENT REPORT OF ABANDONMENT	
NOTICE OF INTENTION TO PULL OR ALTER CASING	<input type="checkbox"/>	SUPPLEMENTARY WELL HISTORY	
NOTICE OF INTENTION TO ABANDON WELL	<input type="checkbox"/>		

(INDICATE ABOVE BY CHECK MARK NATURE OF REPORT, NOTICE, OR OTHER DATA)

April 7, 1960

Well No. 1 is located 1980 ft. from N line and 1990 ft. from E line of sec. 17

38 1/4 of Sec. 17 24 N 7 W N.M.P.M.
(1/4 Sec. and Sec. No.) (Twp.) (Range) (Meridian)
Escrito (Gallup) Bio Arriba New Mexico
(Field) (County or Subdivision) (State or Territory)

The elevation of the derrick floor above sea level is 7308 ft.

DETAILS OF WORK

(State names of and expected depths to objective sands; show sizes, weights, and lengths of proposed casings; indicate cementing points, and all other important proposed work)

Objective sand - Gallup (6150')

Proposed Total Depth - 6250'

Surface Casing - 200' of 8-5/8" 24 lb casing - circulate cement to top.

Production Casing - 4-1/2" O.D. 9.5 lb and 11 lb cemented 400' above productive horizon.

Completion of Gallup Zone - Perforate and fracture with heavy sand frac treatment. Propose to commence drilling on or about April 25, 1960.

I understand that this plan of work must receive approval in writing by the Geological Survey before operations may be commenced.

Company Dorffman Production Company

Address 836 Mercantile Dallas Building

Dallas 1, Texas

By L. L. Horstman

Title General Manager

NEW MEXICO OIL CONSERVATION COMMISSION
WELL LOCATION AND ACREAGE DEDICATION PLAT

FORM C-128
Revised 5/1/57

SEE INSTRUCTIONS FOR COMPLETING THIS FORM ON THE REVERSE SIDE

SECTION A

Operator DORFMAN PRODUCTION COMPANY		Lease COLERN FEDERAL		Well No. 1
Unit Letter J	Section 17	Township 24 NORTH	Range 7 WEST	County RIO ARRIBA
Actual Footage Location of Well: 1980 feet from the SOUTH line and 1980 feet from the EAST line				
Ground Level Elev. 7296.0	Producing Formation GALLUP	Pool ESCRITO (GALLUP)	Dedicated Acreage: 40 Acres	

Ref: GLO plat dated 4 November 1882

1. Is the Operator the only owner in the dedicated acreage outlined on the plat below? YES ☐ NO ☒ ("Owner" means the person who has the right to drill into and to produce from any pool and to appropriate the production either for himself or for himself and another. (65-3-29 (e) NMSA 1935 Comp.)
2. If the answer to question one is "no," have the interests of all the owners been consolidated by communization agreement or otherwise? YES ☒ NO ☐ If answer is "yes," Type of Consolidation **Farmout agreement**
3. If the answer to question two is "no," list all the owners and their respective interests below:

Owner Standard Oil Company of Texas	Land Description NW 1/4 of SE 1/4 of Sec. 17, Twn 24 N, R. 7 W Rio Arriba County, New Mexico
---	--

SECTION B

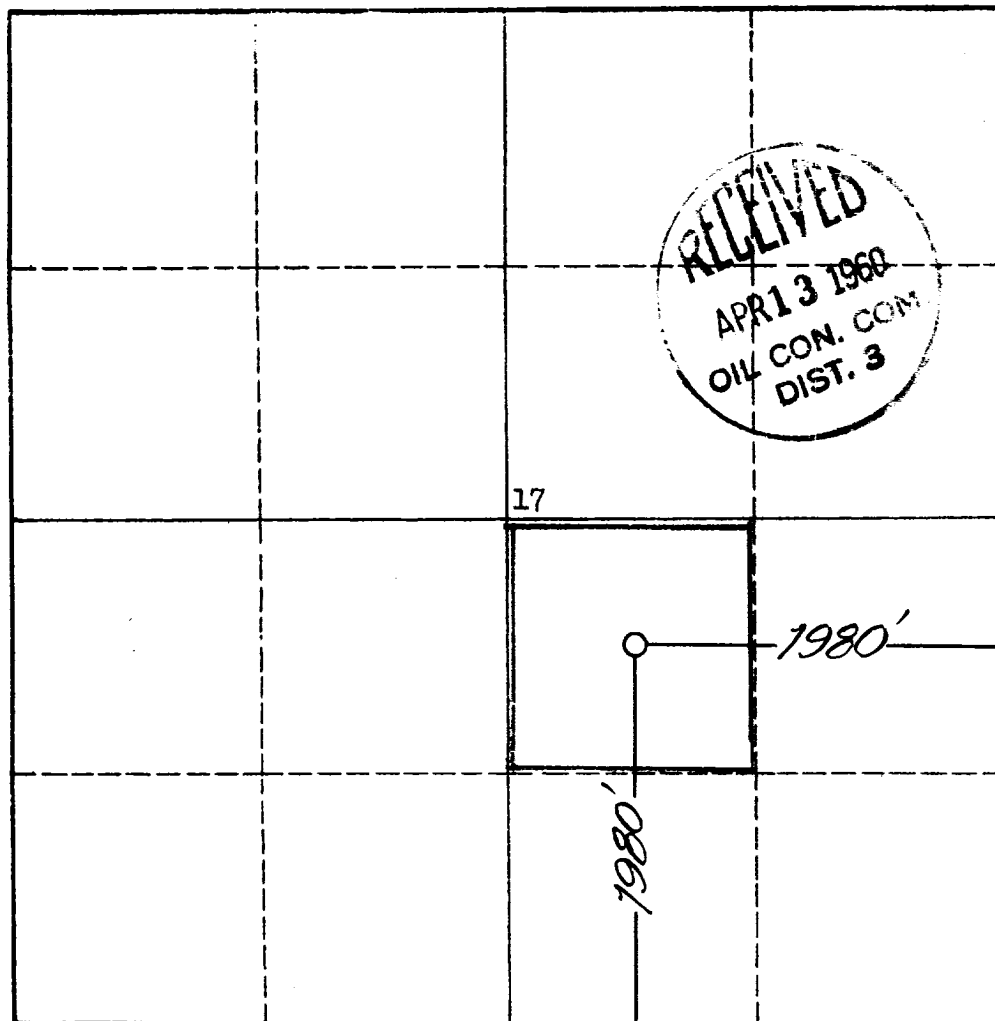

CERTIFICATION

I hereby certify that the information in SECTION A above is true and complete to the best of my knowledge and belief.

Name <i>A. L. Florsheim</i>
Position General Manager
Company Dorfman Production Company
Date April 7, 1960

I hereby certify that the well location shown on the plat in SECTION B was plotted from field notes of actual surveys made by me or under my supervision, and that the same is true and correct to the best of my knowledge and belief.

Date Surveyed 5 April 1960
Registered Professional Engineer and/or Land Surveyor <i>James P. Leese</i> James P. Leese
Certificate No. 1463

0 330 660 990 1320 1650 1980 2310 2640 2000 1500 1000 500 0

INSTRUCTIONS FOR COMPLETION OF FORM C-128

1. Operator shall furnish and certify to the information called for in Section A.
2. Operator shall outline the dedicated acreage for *both* oil and gas wells on the plat in Section B.
3. A registered professional engineer or land surveyor registered in the State of New Mexico or approved by the Commission shall show on the plat the location of the well and certify this information in the space provided.
4. All distances shown on the plat must be from the outer boundaries of the Section.
5. If additional space is needed for listing owners and their respective interests as required in question 3 of Section A, please use space below.