

(SUBMIT IN TRIPLICATE)

Indian Agency Alamogordo

UNITED STATES
DEPARTMENT OF THE INTERIOR
GEOLOGICAL SURVEY

Allottee Alamogordo Tribal

Lease No. Contract 111

SUNDRY NOTICES AND REPORTS ON WELLS

NOTICE OF INTENTION TO DRILL	<input checked="" type="checkbox"/>	SUBSEQUENT REPORT OF WATER SHUT-OFF	
NOTICE OF INTENTION TO CHANGE PLANS		SUBSEQUENT REPORT OF SHOOTING OR ACIDIZING	
NOTICE OF INTENTION TO TEST WATER SHUT-OFF		SUBSEQUENT REPORT OF ALTERING CASING	
NOTICE OF INTENTION TO REDRILL OR REPAIR WELL		SUBSEQUENT REPORT OF REDRILLING OR REPAIR	
NOTICE OF INTENTION TO SHOOT OR ACIDIZE		SUBSEQUENT REPORT OF ABANDONMENT	
NOTICE OF INTENTION TO PULL OR ALTER CASING		SUPPLEMENTARY WELL HISTORY	
NOTICE OF INTENTION TO ABANDON WELL			

(INDICATE ABOVE BY CHECK MARK NATURE OF REPORT, NOTICE, OR OTHER DATA)

August 8th, 1957

Well No. 10-H is located 800 ft. from N line and 800 ft. from W line of sec. 7

SW/4 SW/4 Sec. 7 24N 4W N.E.P.M.
(1/4 Sec. and Sec. No.) (Twp.) (Range) (Meridian)

J. Blanco PC Ext. Rio Arriba New Mexico
(Field) (County or Subdivision) (State or Territory)

The elevation of the derrick floor above sea level is 6804 ft.

DETAILS OF WORK

(State names of and expected depths to objective sands; show sizes, weights, and lengths of proposed casings; indicate mudding jobs, cementing points, and all other important proposed work)

Pictured Cliffs Sand test. Estimated total depth 3100'.

Surface Casing: 30' of 8-5/8" OD 24# J-55 cemented to surface.
Production " : Approximately 3100' of 5-1/2" OD 15.5# J-55 cemented with 100 sacks.

If commercial production is indicated, the 5-1/2" casing will be perforated and the producing section sand-water fractured.

I understand that this plan of work must receive approval in writing by the Geological Survey before operations may be commenced.

Company EL PASO NATURAL GAS COMPANY

Address Box 997

Farmington, New Mexico

By [Signature]

Title Senior Petroleum Engineer

NEW MEXICO OIL CONSERVATION COMMISSION

Well Location and Acreage Dedication Plat

Section A.

Date _____

Operator **EL PASO NATURAL GAS COMPANY** Lease **JICARILLA APACHE**
 Well No. **10 - H** Unit Letter **H** Section **7** Township **24 NORTH** Range **4 WEST** NMPM
 Located **800** Feet From **the NORTH** Line, **800** Feet From **the WEST** Line
 County **RIO ARriba** G. L. Elevation **6796.0 Meters** Dedicated Acreage **122.10** Acres
 Name of Producing Formation **Pictured Cliffs** Pool **S. Blance 20 Ext.**

1. Is the Operator the only owner in the dedicated acreage outlined on the plat below?
 Yes ☒ No ☐
2. If the answer to question one is "no", have the interests of all the owners been consolidated by communitization agreement or otherwise? Yes ☐ No ☐ If answer is "yes", Type of Consolidation _____

3. If the answer to question two is "no", list all the owners and their respective interests below:

Owner

Land Description

Section B.

This is to certify that the information in Section A above is true and complete to the best of my knowledge and belief.

EL PASO NATURAL GAS COMPANY

(Signature)

(Representative)

Box 807

(Address)

Farmington, New Mexico

RECEIVED

AUG 15 1957

OIL CON. COM.
DIST. 3**ILLEGIBLE**

(Seal)

Farmington, New Mexico

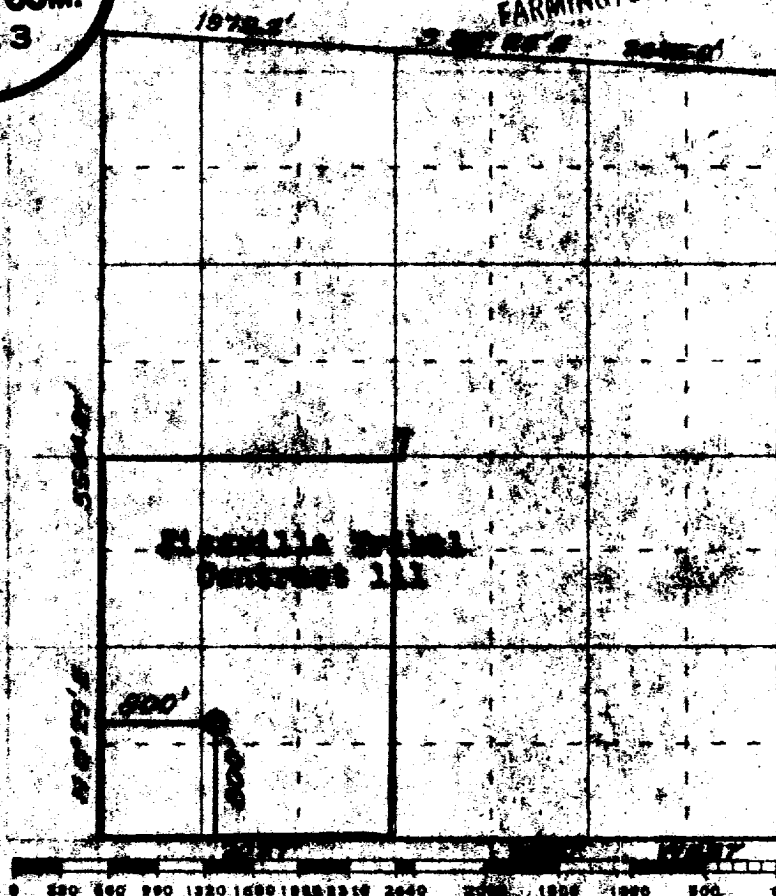

Scale 4 inches equal 1 mile

The above plat was prepared from field notes of actual surveys under my supervision and that the same are true and correct to the best of my knowledge and belief.

Date Surveyed **10 AUG 1957**

Registered Professional Engineer and/or Land Surveyor
John F. Lane **E. No. 122, No. 140**