

NEW MEXICO OIL CONSERVATION COMMISSION
Santa Fe, New Mexico

Form C-101
Revised (12/1/55)

NOTICE OF INTENTION TO DRILL

Notice must be given to the District Office of the Oil Conservation Commission and approval obtained before drilling or recompletion begins. If changes in the proposed plan are considered advisable, a copy of this notice showing such changes will be returned to the sender. Submit this notice in QUINTUPPLICATE. One copy will be returned following approval. See additional instructions in Rules and Regulations of the Commission. If State Land submit 6 Copies Attach Form C- 128 in triplicate to first 3 copies of form C-101

(Place) (Date)

OIL CONSERVATION COMMISSION
SANTA FE, NEW MEXICO

Gentlemen:

You are hereby notified that it is our intention to commence the Drilling of a well to be known as
Magnolia Petroleum Company

(Company or Operator)

W. O. Hughes

(Lease)

Well No. **4 "A"**, in **0** (Unit) The well is

located **990** feet from the **South** line and **1640** feet from the

East

line of Section **7**, T. **24 N**, R. **3 W**, NMPM.

(GIVE LOCATION FROM SECTION LINE) **Undesignated** Pool, **Rio Arriba** County

If State Land the Oil and Gas Lease is No.

W. O. Hughes

If patented land the owner is

Address **620 Charles St., Truth-or-Consequences, New Mexico**

Rotary only

We propose to drill well with drilling equipment as follows:

On File

The status of plugging bond is

Drilling Contractor **George W. Riley, Inc.**

P. O. Box 826

Odessa, Texas

We intend to complete this well in the **Pictured Cliffs**

formation at an approximate depth of **3250** feet.

CASING PROGRAM

We propose to use the following strings of Casing and to cement them as indicated:

Size of Hole	Size of Casing	Weight per Foot	New or Second Hand	Depth	Sacks Cement
12 1/4"	8 5/8"	29#	Second Hand	300	300
7 7/8"	5 1/2"	14#	New	3250	250

If changes in the above plans become advisable we will notify you immediately.

ADDITIONAL INFORMATION (If recompletion give full details of proposed plan of work.)

To junk W. O. Hughes #4 and skid rig 10' and drill above well.

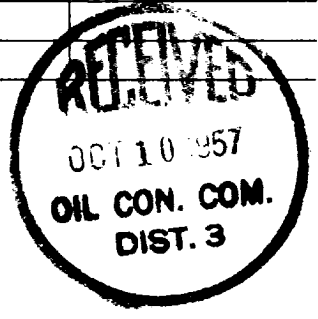

Approved 10-10, 1957
Except as follows:

Sincerely yours,

Magnolia Petroleum Company

(Company or Operator)

By **McDougherty**
District Superintendent

Position **Magnolia Petroleum Company**

Name **Box 2406, Hobbs, New Mexico**
Address

OIL CONSERVATION COMMISSION

By [Signature]

NEW MEXICO OIL CONSERVATION COMMISSION

Well Location and Acreage Dedication Plat

Section A.

Date Sept. 25, 1957

Operator MAGNOLIA PETROLEUM COMPANY Lease H. C. Hughes
Well No. 14 Unit Letter Section 7 Township 24N Range 3W NMPN
Located 1400 Feet From East Line, 990 Feet From South Line
County Rio Arriba G. L. Elevation 6838 Dedicated Acreage 160 Acres
Name of Producing Formation Pictured Cliffs Pool Undesignated

1. Is the Operator the only owner* in the dedicated acreage outlined on the plat below?
Yes x No .
2. If the answer to question one is "no," have the interests of all the owners been consolidated by communitization agreement or otherwise? Yes No . If answer is "yes," Type of Consolidation
3. If the answer to question two is "no," list all the owners and their respective interests below:

Owner

Land Description

Section B.

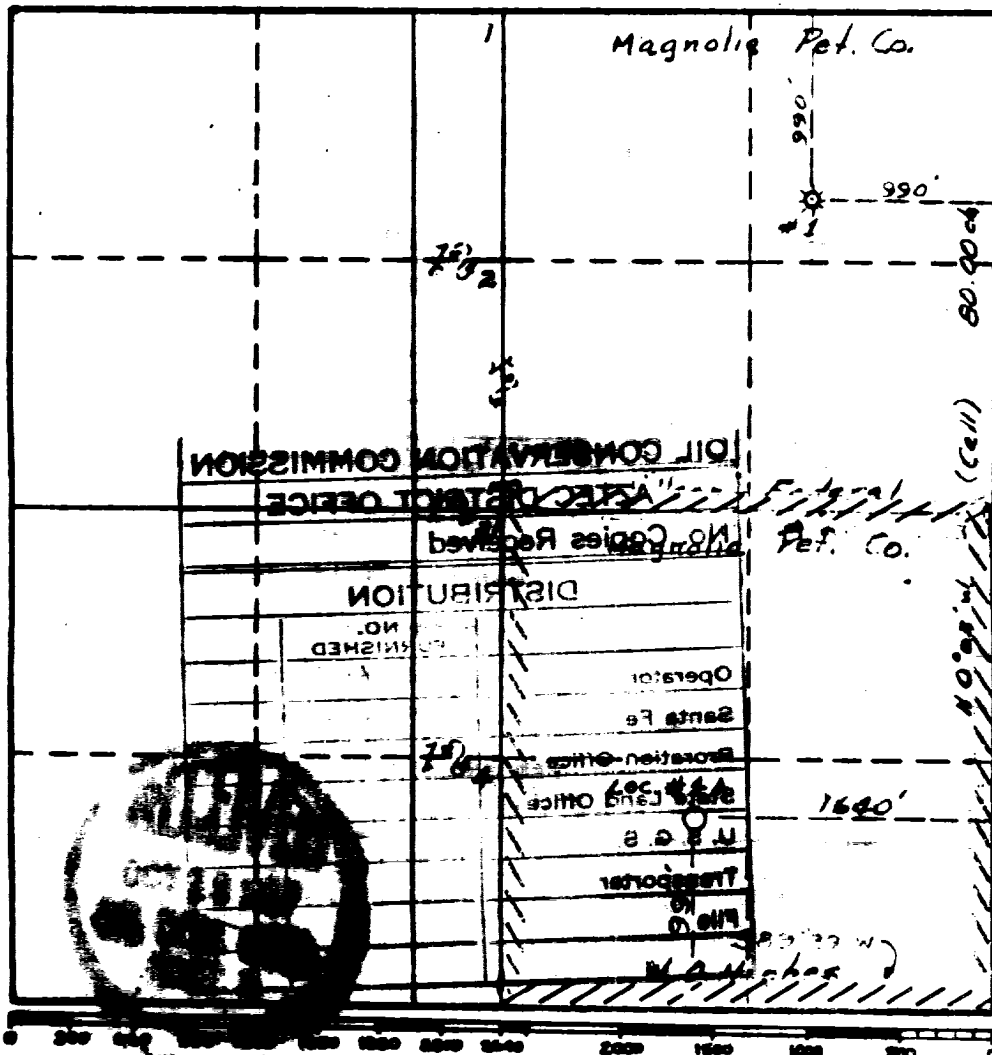

This is to certify that the information in Section A above is true and complete to the best of my knowledge and belief.

Magnolia Petroleum Company
(Operator)
H. C. Hughes
(Representative)

Box 2106, Hobbs, New Mexico
Address

This is to certify that the well location shown on the plat in Section B was plotted from field notes of actual surveys made by me or under my supervision and that the same is true and correct to the best of my knowledge and belief.

Date Surveyed May 14, 1956

Carl E. Turner
Registered Professional
Engineer and/or Land Surveyor

Certificate No. 2106

OIL CONSERVATION COMMISSION		
AZTEC DISTRICT OFFICE		
No. Copies Received		
DISTRIBUTION		
	NO. FURNISHED	
Operator	11	
Santa Fe	1	
Proration Office		
State Land Office		
U. S. G. S	2	
Transporter		
File	1	✓