

(SUBMIT IN TRIPLICATE)

UNITED STATES  
DEPARTMENT OF THE INTERIOR  
GEOLOGICAL SURVEY

Land Office **Santa Fe**  
Lease No. **078912**  
Unit **Lindrith Unit**  
**I-Sec. 713**

SUNDRY NOTICES AND REPORTS ON WELLS

|  |                                     |  |  |
|--|-------------------------------------|--|--|
| NOTICE OF INTENTION TO DRILL                   | <input checked="" type="checkbox"/> | SUBSEQUENT REPORT OF WATER SHUT-OFF        |  |
| NOTICE OF INTENTION TO CHANGE PLANS            |                                     | SUBSEQUENT REPORT OF SHOOTING OR ACIDIZING |  |
| NOTICE OF INTENTION TO TEST WATER SHUT-OFF     |                                     | SUBSEQUENT REPORT OF ALTERING CASING       |  |
| NOTICE OF INTENTION TO RE-DRILL OR REPAIR WELL |                                     | SUBSEQUENT REPORT OF RE-DRILLING OR REPAIR |  |
| NOTICE OF INTENTION TO SHOOT OR ACIDIZE        |                                     | SUBSEQUENT REPORT OF ABANDONMENT           |  |
| NOTICE OF INTENTION TO PULL OR ALTER CASING    |                                     | SUPPLEMENTARY WELL HISTORY                 |  |
| NOTICE OF INTENTION TO ABANDON WELL            |                                     |  |  |

(INDICATE ABOVE BY CHECK MARK NATURE OF REPORT, NOTICE, OR OTHER DATA)

February 20, 19 57

Well No. **19** is located **990** ft. from **S** line and **990** ft. from **E** line of sec. **12**  
**SE Section 12** **24N** **3W** **NMSP**  
 (1/4 Sec. and Sec. No.) (Twp.) (Range) (Meridian)  
**Wildcat** **Rio Arriba** **New Mexico**  
 (Field) (County or Subdivision) (State or Territory)

The elevation of the derrick floor above sea level is **7131** ft.

DETAILS OF WORK

(State names of and expected depths to objective sands; show sizes, weights, and lengths of proposed casings; indicate mudlogging jobs, cementing points, and all other important proposed work)

It is intended to drill a well thru the **Pictured Cliff** formation using rotary tools and to perforate and water fracture possible producing zones. Estimated T.D. **3340'**.

Casing Program:

**9 5/8" at 120' with 125 sacks regular cement circulated to surface**  
**5 1/2" at 3340' with 75 sacks regular cement, 75 sacks Plug**

The **SE 1/4** of Section 12 is dedicated to this well.

**SE 1/4 SW 078912 (W 2 SE 1/4, SESE), Horace F. McKay et ux (NMSE).**

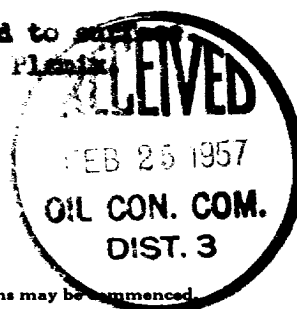

I understand that this plan of work must receive approval in writing by the Geological Survey before operations may be commenced.

Company **El Paso Natural Gas Company**

Address **Box 997**

**Farmington, New Mexico**

Original Signed **EWELL N. WALSH**

By \_\_\_\_\_  
 Title **Petroleum Engineer**

NEW MEXICO  
OIL CONSERVATION COMMISSION

WELL LOCATION AND/OR GAS PRODUCTION PLAT

DATE FEBRUARY 14, 1957

OPERATOR EL PASO NATURAL GAS COMPANY LEASE LINDRITH UNIT SF 078912

ACRES 19 SECTION 12 TOWNSHIP 24-N RANGE 3-W

DEGREE 990 BEARING SOUTH DISTANCE 990 BEARING EAST

RIO ARRIBA COUNTY, NEW MEXICO ELEVATION 7123

NAME OF WELL OR PRODUCTION PLAT PICTURED CLIFF WILDCAT PLAT 160 ACRES  
(1917 PLAT)

Note: All distances must be from outer boundaries of section.

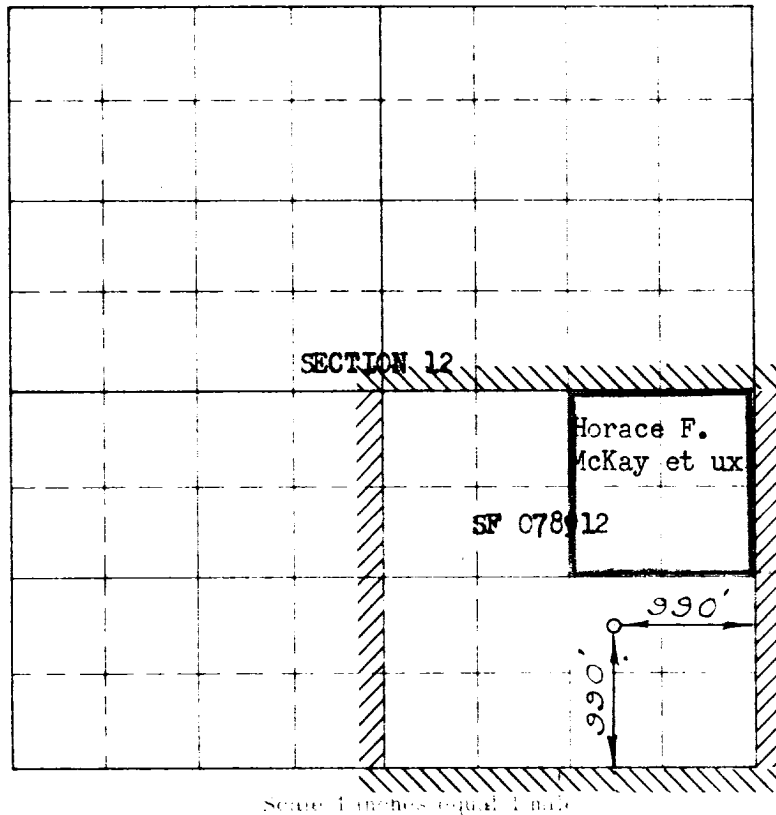

NOTE

This section of  
form is to be used  
for the purpose of

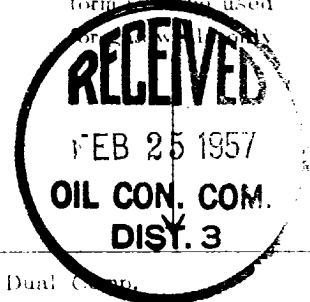

This is to certify that the above plat was prepared from  
field notes of actual surveys made by me or under my  
supervision and that the same are true and correct to the  
best of my knowledge and belief.

Date Surveyed DECEMBER 28, 1956

E. O. Walker  
Registered Professional Engineer and/or Land Surveyor

1. Is this well a Dual Completion?  
Yes \_\_\_\_\_ No X
2. If the answer to Question 1  
is yes, are there any other dually  
completed wells within the  
dedicated acreage?  
Yes \_\_\_\_\_ No \_\_\_\_\_

Name Original Signed EWELL N. WALSH

Position Petroleum Engineer

Representing El Paso Natural Gas Co.

Address Box 997, Farmington, N.M.

Seal

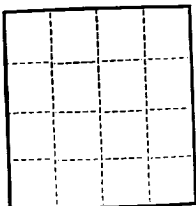

(SUBMIT IN TRIPLICATE)

UNITED STATES  
DEPARTMENT OF THE INTERIOR  
GEOLOGICAL SURVEY

Budget Bureau No. 42-R358.4.  
Approval expires 12-31-60.

Land Office Santa Fe  
Lease No. 078912  
Unit Lindrith Unit  
I-Sec. 713

## SUNDRY NOTICES AND REPORTS ON WELLS

|  |  |   |
|--|--|---|
| NOTICE OF INTENTION TO DRILL                   | SUBSEQUENT REPORT OF WATER SHUT-OFF        | X |
| NOTICE OF INTENTION TO CHANGE PLANS            | SUBSEQUENT REPORT OF SHOOTING OR ACIDIZING |   |
| NOTICE OF INTENTION TO TEST WATER SHUT-OFF     | SUBSEQUENT REPORT OF ALTERING CASING       |   |
| NOTICE OF INTENTION TO RE-DRILL OR REPAIR WELL | SUBSEQUENT REPORT OF RE-DRILLING OR REPAIR |   |
| NOTICE OF INTENTION TO SHOOT OR ACIDIZE        | SUBSEQUENT REPORT OF ABANDONMENT           |   |
| NOTICE OF INTENTION TO PULL OR ALTER CASING    | SUPPLEMENTARY WELL HISTORY                 |   |
| NOTICE OF INTENTION TO ABANDON WELL            |  |   |

(INDICATE ABOVE BY CHECK MARK NATURE OF REPORT, NOTICE, OR OTHER DATA)

April 11, 19 57

Well No. 19 is located 290 ft. from S line and 990 ft. from E line of sec. 12

SE Section 12 24N 3W N.M.P.M.  
(1/4 Sec. and Sec. No.) (Twp.) (Range) (Meridian)  
Wildcat Rio Arriba New Mexico  
(Field) (County or Subdivision) (State or Territory)

The elevation of the derrick floor above sea level is 7133 ft.

### DETAILS OF WORK

(State names of and expected depths to objective sands; show sizes, weights, and lengths of proposed casings; indicate mudding jobs, cementing points, and all other important proposed work)

Spud date 3-22-57.  
On 3-23-57. Total Depth 140'.  
Ran 3 joints, 9-5/8", 25.4#, Armaco S.W. casing (121')  
set at 132 with 100 sacks regular cement circulated to surface.  
Held 500# 30 minutes.

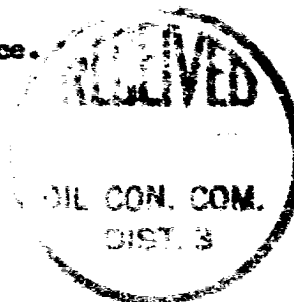

I understand that this plan of work must receive approval in writing by the Geological Survey before operations may be commenced.

Company El Paso Natural Gas Company

Address Box 997

Farmington, New Mexico

By W. F. Corbett

Title Petroleum Engineer

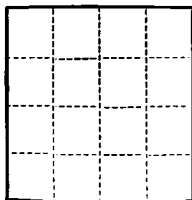

(SUBMIT IN TRIPLICATE)

UNITED STATES  
DEPARTMENT OF THE INTERIOR  
GEOLOGICAL SURVEY

Budget Bureau No. 42-R358.4.  
Approval expires 12-31-60.

Land Office **Santa Fe**  
Lease No. **078912**  
Unit **Lindrieth Unit**

SUNDRY NOTICES AND REPORTS ON WELLS

|  |  |          |
|--|--|----------|
| NOTICE OF INTENTION TO DRILL                   | SUBSEQUENT REPORT OF WATER SHUT-OFF        |          |
| NOTICE OF INTENTION TO CHANGE PLANS            | SUBSEQUENT REPORT OF SHOOTING OR ACIDIZING |          |
| NOTICE OF INTENTION TO TEST WATER SHUT-OFF     | SUBSEQUENT REPORT OF ALTERING CASING       |          |
| NOTICE OF INTENTION TO RE-DRILL OR REPAIR WELL | SUBSEQUENT REPORT OF RE-DRILLING OR REPAIR |          |
| NOTICE OF INTENTION TO SHOOT OR ACIDIZE        | SUBSEQUENT REPORT OF ABANDONMENT           |          |
| NOTICE OF INTENTION TO PULL OR ALTER CASING    | SUPPLEMENTARY WELL HISTORY                 |          |
| NOTICE OF INTENTION TO ABANDON WELL            | <b>Water Frac</b>                          | <b>X</b> |

(INDICATE ABOVE BY CHECK MARK NATURE OF REPORT, NOTICE, OR OTHER DATA)

April 11, 1957

Well No. **19** is located **990** ft. from **N** line and **990** ft. from **E** line of sec. **12**  
**SE Section 12** **24N** **3W** **N.M.P.M.**  
(Sec. and Sec. No.) (Twp.) (Range) (Meridian)  
**Wildcat** **Rio Arriba** **New Mexico**  
(Field) (County or Subdivision) (State or Territory)

The elevation of the derrick floor above sea level is **7133** ft.

DETAILS OF WORK

(State names of and expected depths to objective sands; show sizes, weights, and lengths of proposed casings; indicate mudlogging jobs, cementing points, and all other important proposed work)

4-10-57. Total Depth 3356'. Plug back T.D. 3352'. Water fractured Pictured Cliffs perforated intervals 3280-90; 3308-20 and 3332-46' with 45,000 gallons water and 40,000# sand. Breakdown pressure 1500#, maximum pressure 3000#, average treating pressure 1650#. Injection rate 49 bbls/min. Flush 4000 gallons.



I understand that this plan of work must receive approval in writing by the Geological Survey before operations may be commenced.

Company **El Paso Natural Gas Company**

Address **Box 997**

**Farmington, New Mexico**

By **D. F. [Signature]**

Title **Petroleum Engineer**

