

(SUBMIT IN TRIPLICATE)

UNITED STATES  
DEPARTMENT OF THE INTERIOR  
GEOLOGICAL SURVEYLand Office SF  
Lease No. 078877  
Unit  
Canyon Largo Unit  
14-08-001-1059

## SUNDRY NOTICES AND REPORTS ON WELLS

NOTICE OF INTENTION TO DRILL	<input checked="" type="checkbox"/> SUBSEQUENT REPORT OF WATER SHUT OFF
NOTICE OF INTENTION TO CHANGE PLANS	SUBSEQUENT REPORT OF SHOOTING OR ACIDIZING
NOTICE OF INTENTION TO TEST WELL SHUT-OFF	SUBSEQUENT REPORT OF ALTERING CASING
NOTICE OF INTENTION TO RE-DRILL OR REPAIR WELL	SUBSEQUENT REPORT OF RE-DRILLING OR REPAIR
NOTICE OF INTENTION TO SHOOT OR ACIDIZE	SUBSEQUENT REPORT OF ABANDONMENT
NOTICE OF INTENTION TO PULL OR ALTER CASING	SUPPLEMENTARY WELL HISTORY
NOTICE OF INTENTION TO ABANDON WELL	

NOTE: ABOVE BY CHECK MARK NATURE OF REPORT, NOTICE, OR OTHER DATA

INTENTION REVISED TO SHOW CHANGE IN  
WELL NUMBER.

March 12, 1963

Well No. 122 is located 790 ft. from ~~XXX~~ line and 1650 ft. from ~~XXX~~ line of sec. 8  
SW/4 SE/4 Section 8 24N 6W NMPM  
(1/4 Sec. and 1/4 Sec. N) (Twp) (Range) (Meridian)  
Devils Fork Gallup Rio Arriba New Mexico  
(Post Office) (County) (Supervision) (State or Territory)

The elevation of the derrick floor above sea level is 6507 ft.

## DETAILS OF WORK

State names of and expected depths to objective sands; show sizes, weights, and lengths of proposed casings; indicate mudding jobs, cementing points, and all other important proposed work.

It is intended to drill a well thru the Gallup Formation using rotary tools and mud circulation. Possible productive intervals will be perforated and sandoil fractured. A two-stage collar will be set 100' below bottom of Picture Cliffs and this zone cemented off. Estimated Total Depth 5530'.

## Casing Program:

8-5/8" at 160' with 150 sacks cement circulated to surface.  
4-1/2" at 5530' with 150 sacks cement--first stage; 100 sacks  
cement--second stage. Estimated top of cement  
stage 4530', second stage 1800'.

The W/2 SE/4 of Section 8 is dedicated to this well.

W/2 SE/4 Section 8 SF-078877

I understand that this plan of work must receive approval in writing by the Geological Survey before operations may be commenced.

Company El Paso Natural Gas Products Company

Address Post Office Box 1560

Farmington, New Mexico

By Original Signed EWELL N. WALSH

Title Division Petroleum Engineer

# NEW MEXICO OIL CONSERVATION COMMISSION

## Well Location and Acreage Dedication Plat

### SECTION A.

Date **March 12, 1963**  
Operator **El Paso Natural Gas Products Company** Lease **Canyon Largo Unit** **SP-878877**  
Well No. **123** Unit Letter **0** Section **8** Township **24 North** Range **6 West** NMPM  
Located **790** Feet From **South** Line, **1650** Feet From **East** Line  
County **Rio Arriba** G. L. Elevation **6496** Dedicated Acreage **80** Acres  
Name of Producing Formation **Gallop** Pool **Devils Fork**

1. Is the Operator the only owner\* in the dedicated acreage outlined on the plat below? Yes ☒ No ☐
2. If the answer to question One is "No," have the interests of all the owners been consolidated by communitization agreement or otherwise? Yes ☐ No ☐ If answer is "Yes," Type of Consolidation
3. If the answer to question Two is "No," list all the owners and their respective interests below:

OWNER

LAND DESCRIPTION

### SECTION B.

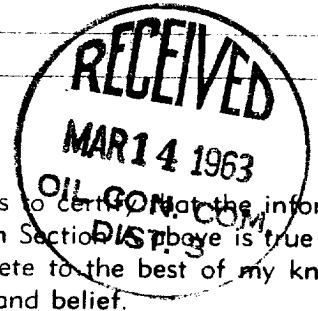
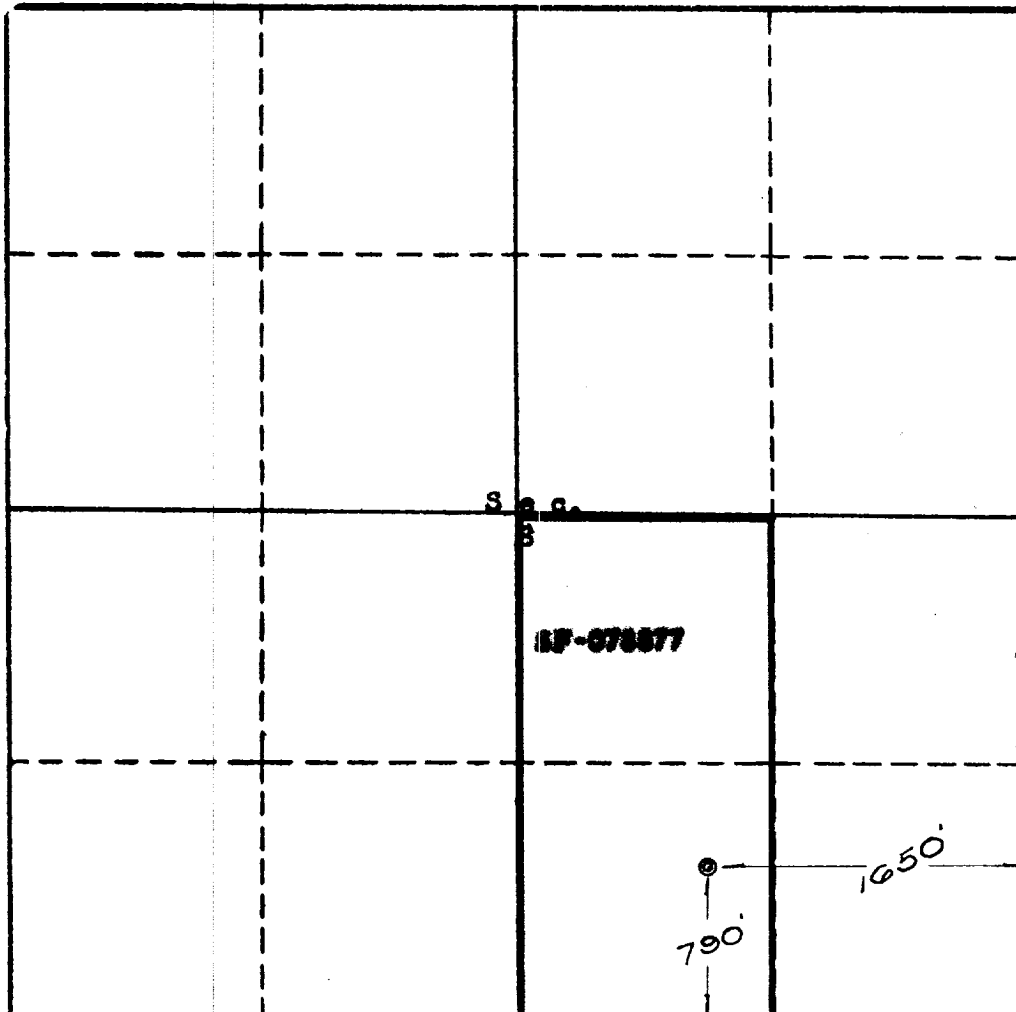

This is to certify that the information in Section A above is true and complete to the best of my knowledge and belief.

**El Paso Natural Gas Products Co.**

(OPERATOR)

Original Signed **EWELL N. WALSH**

(REPRESENTATIVE)

**P. O. Box 1340, Farmington, N. M.**

(ADDRESS)

This is to certify that the well location shown on the plat in Section B was plotted from field notes of actual surveys made by me or under my supervision and that the same is true and correct to the best of my knowledge and belief.

Date Surveyed **February 26, 1963**

**Four States Engineering Co.**  
FARMINGTON, NEW MEXICO

*Emmet A. Eells Hawk*  
REGISTERED ENGINEER OR  
LAND SURVEYOR

Certificate No. **3602**

