

(SUBMIT IN TRIPLICATE)

UNITED STATES  
DEPARTMENT OF THE INTERIOR  
GEOLOGICAL SURVEY

Land Office \_\_\_\_\_

Lease No. \_\_\_\_\_

Unit 14-08-001-1059  
Canyon Largo Unit

## SUNDRY NOTICES AND REPORTS ON WELLS

NOTICE OF INTENTION TO DRILL	<input checked="" type="checkbox"/>	SUBSEQUENT REPORT OF WATER SHUT-OFF	<b>RECEIVED</b> <b>MAR 4 1963</b> U. S. GEOLOGICAL SURVEY FARMINGTON, NEW MEXICO
NOTICE OF INTENTION TO CHANGE PLANS		SUBSEQUENT REPORT OF SHOOTING OR ACIDIZING	
NOTICE OF INTENTION TO TEST WATER SHUT-OFF		SUBSEQUENT REPORT OF ALTERING CASING	
NOTICE OF INTENTION TO RE-DRILL OR REPAIR WELL		SUBSEQUENT REPORT OF RE-DRILLING OR REPAIR	
NOTICE OF INTENTION TO SHOOT OR ACIDIZE		SURSEQUENT REPORT OF ABANDONMENT	
NOTICE OF INTENTION TO PILL OR ALTER LACING		SUPPLEMENTARY WELL HISTORY	
NOTICE OF INTENTION TO ABANDON WELL			

INDICATE ABOVE BY CHECK MARK NATURE OF REPORT, NOTICE, OR OTHER DATA.

March 1, 1963

Well No. 123 is located 790 ft. from ~~SW~~ line and 1650 ft. from ~~SW~~ line of sec. 8  
 SW/4 SE/4 Section 8 24N 6W NMPM  
 (1/4 Sec. and 1/4 Sec. No.) (Twp.) (Range) (Meridian)  
 Devils Fork Gallup Rio Arriba New Mexico  
 (County or Subdivision) (State or Territory)

The elevation of the derrick floor above sea level is 6507 ft.

## DETAILS OF WORK

(State names of and expected depths to objective sands; show sizes, weights, and lengths of proposed casings; indicate mudding jobs, cementing points, and all other important proposed work)

It is intended to drill a well thru the Gallup Formation using rotary tools and mud circulation. Possible productive intervals will be perforated and sandoil fractured. A two-stage collar will be set 100' below bottom of Picture Cliffs and this zone cemented off. Estimated Total Depth 5530'.

## Casing Program:

8-5/8" at 160' with 150 sacks cement circulated to surface.  
 4-1/2" at 5530' with 150 sacks cement--first stage; 100 sacks  
 cement--second stage. Estimated top of cement first  
 stage 4530', second stage 1800'.

The W/2 SE/4 of Section 8 is dedicated to this well.

W/2 SE/4 Section 8 14-08-001-1059.

Understand that this plan of work must receive approval in writing by the Geological Survey before operations may be commenced.

Company El Paso Natural Gas Products Company

Address Post Office Box 1560

Farmington, New Mexico

Original Signed EWELL N. WALSH

By

Title Division Petroleum Engineer

NEW MEXICO OIL CONSERVATION COMMISSION  
Well Location and Acreage Dedication Plat

## SECTION A.

Date **March 1, 1963**

Operator **El Paso Natural Gas Products Company** Lease **Largo Canyon Unit 14-00-001-1009**  
 Well No. **123** Unit Letter **0** Section **8** Township **24 North** Range **6 West** NMPM  
 Located **790** Feet From **South** Line, **1650** Feet From **East** Line  
 County **Rio Arriba** G. L. Elevation **6496** Dedicated Acreage **80** Acres  
 Name of Producing Formation **Gallego** Pool **Devils Fork**

1. Is the Operator the only owner\* in the dedicated acreage outlined on the plat belcw? Yes ☒ No ☐
2. If the answer to question One is "No," have the interests of all the owners been consolidated by communitization agreement or otherwise? Yes ☐ No ☐ If answer is "Yes," Type of Consolidation \_\_\_\_\_
3. If the answer to question Two is "No," list all the owners and their respective interests below:

OWNER

LAND DESCRIPTION

## SECTION B.

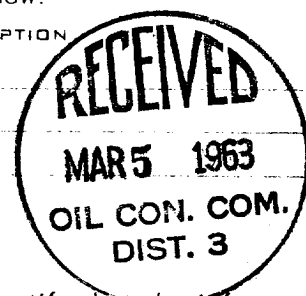
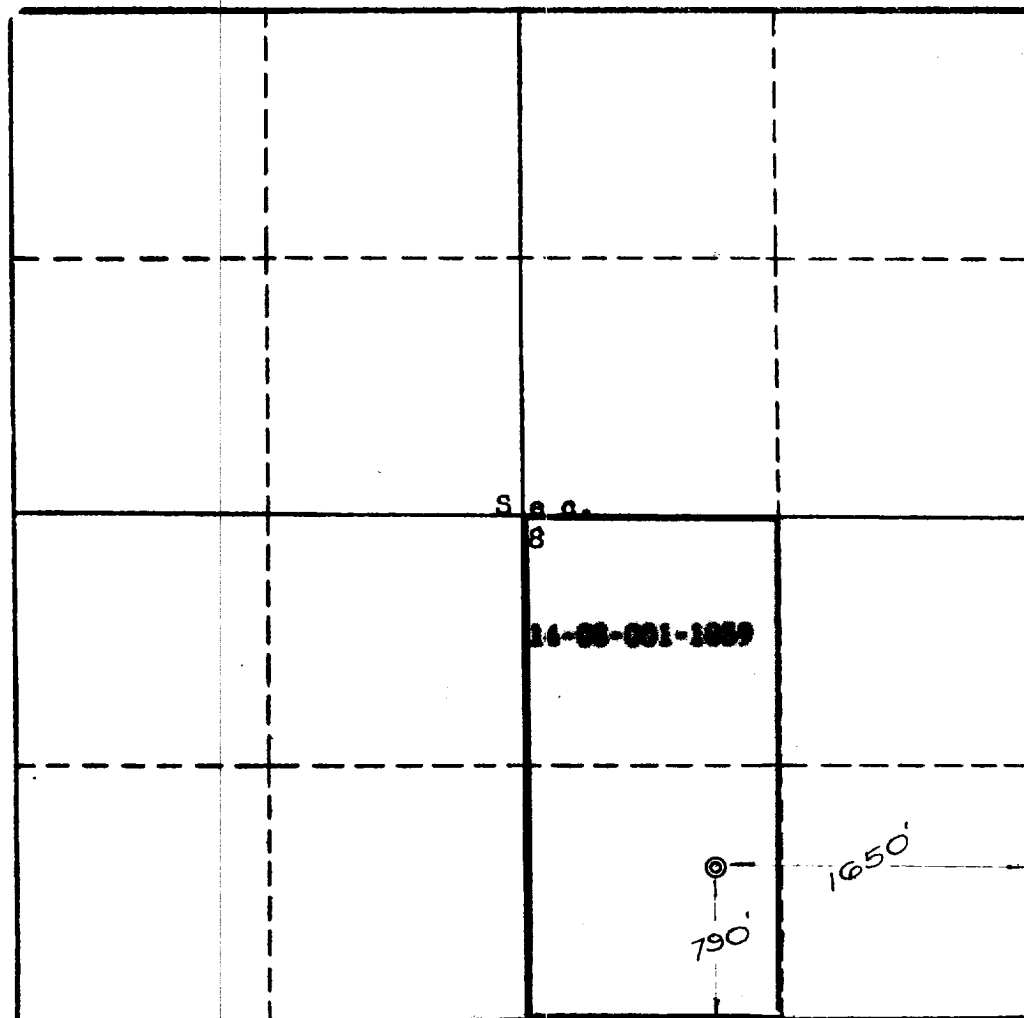

This is to certify that the information in Section A above is true and complete to the best of my knowledge and belief.

**El Paso Natural Gas Products Co.**

(OPERATOR)

Original Signed **EWELL N. WALSH**  
(REPRESENTATIVE)**P.O. Box 1540, Farmington, N.M.**

This is to certify that the well location shown on the plat in Section B was plotted from field notes of actual surveys made by me or under my supervision and that the same is true and correct to the best of my knowledge and belief.

Date Surveyed **February 26, 1963****Four States Engineering Co.**  
FARMINGTON, NEW MEXICO

*Edward J. Cech*  
REGISTERED ENGINEER OR  
LAND SURVEYOR

Certificate No. **3602**