

Santa Fe

(SUBMIT IN TRIPLICATE)

Land Office

078959

Lease No.

Unit

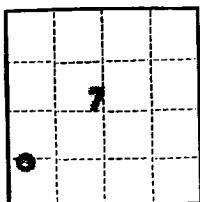

UNITED STATES
DEPARTMENT OF THE INTERIOR
GEOLOGICAL SURVEY

SUNDRY NOTICES AND REPORTS ON WELLS

NOTICE OF INTENTION TO DRILL		SUBSEQUENT REPORT OF WATER SHUT-OFF	
NOTICE OF INTENTION TO CHANGE PLANS		SUBSEQUENT REPORT OF SHOOTING OR ACIDIZING	
NOTICE OF INTENTION TO TEST WATER SHUT-OFF		SUBSEQUENT REPORT OF ALTERING CASING	
NOTICE OF INTENTION TO RE-DRILL OR REPAIR WELL		SUBSEQUENT REPORT OF RE-DRILLING OR REPAIR	
NOTICE OF INTENTION TO SHOOT OR ACIDIZE		SUBSEQUENT REPORT OF ABANDONMENT	
NOTICE OF INTENTION TO PULL OR ALTER CASING		SUPPLEMENTARY WELL HISTORY	
NOTICE OF INTENTION TO ABANDON WELL			

(INDICATE ABOVE BY CHECK MARK NATURE OF REPORT, NOTICE, OR OTHER DATA)

January 12

1961

Well No. **Federal 2-7** is located **790** ft. from **TS** line and **890** ft. from **ETW** line of sec. **7**
SV SW Sec. 7 **24 N** **7 W** **NMPM**
(1/4 Sec. and Sec. No.) (Twp.) (Range) (Meridian)
Escrito-Gallup **Rio Arriba County** **New Mexico**
(Field) (County or Subdivision) (State or Territory)

The elevation of the derrick floor above sea level is **7163** ft.

DETAILS OF WORK

(State names of and expected depths to objective sands; show sizes, weights, and lengths of proposed casings; indicate mudding jobs, cementing points, and all other important proposed work)

Operator proposes to drill a 6300' test, to test the oil and gas possibilities of Gallup formation. The following drilling procedure will be followed:

- 1.) 8 1/8" surface casing will be set @ 250' with sufficient cement to circulate.
- 2.) 7 7/8" hole will be drilled from under surface to 6300'.
- 3.) 4 1/2" production string will be set @ 6300' and cemented with approximately 250 sms.

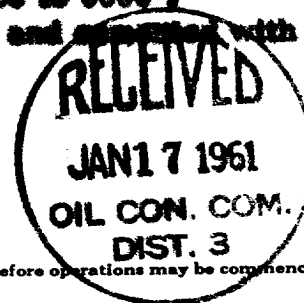

I understand that this plan of work must receive approval in writing by the Geological Survey before operations may be commenced.

Company **Compass Exploration, Inc.**

Address **1645 Court Place**

Denver 2, Colorado

By *R. J. Farrell*

Title **Chief Geologist**

OKaf

NEW MEXICO OIL CONSERVATION COMMISSION

Well Location and Acreage Dedication Plat

January 13, 1961

Date

SECTION A.

Operator COMPASS EXPLORATION COMPANY, Inc. Lease Federal
Well No. 2-7 Unit Letter M Section 7 Township 2-North Range 7-West NMPM
Located 790 Feet From South Line, 990 Feet From West Line
County El Arriba Gallup G. L. Elevation 7363' Dedicated Acreage Escrito-Gallup Acres
Name of Producing Formation _____ Pool X

1. Is the Operator the only owner* in the dedicated acreage outlined on the plat below? Yes _____ No _____
2. If the answer to question One is "No," have the interests of all the owners been consolidated by communitization agreement or otherwise? Yes _____ No _____ If answer is "Yes," Type of Consolidation _____
3. If the answer to question Two is "No," list all the owners and their respective interests below:

OWNER

LAND DESCRIPTION

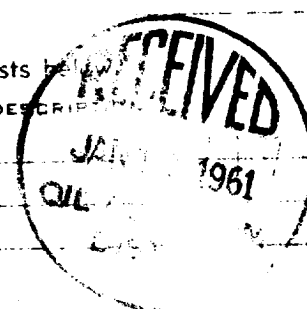

SECTION B.

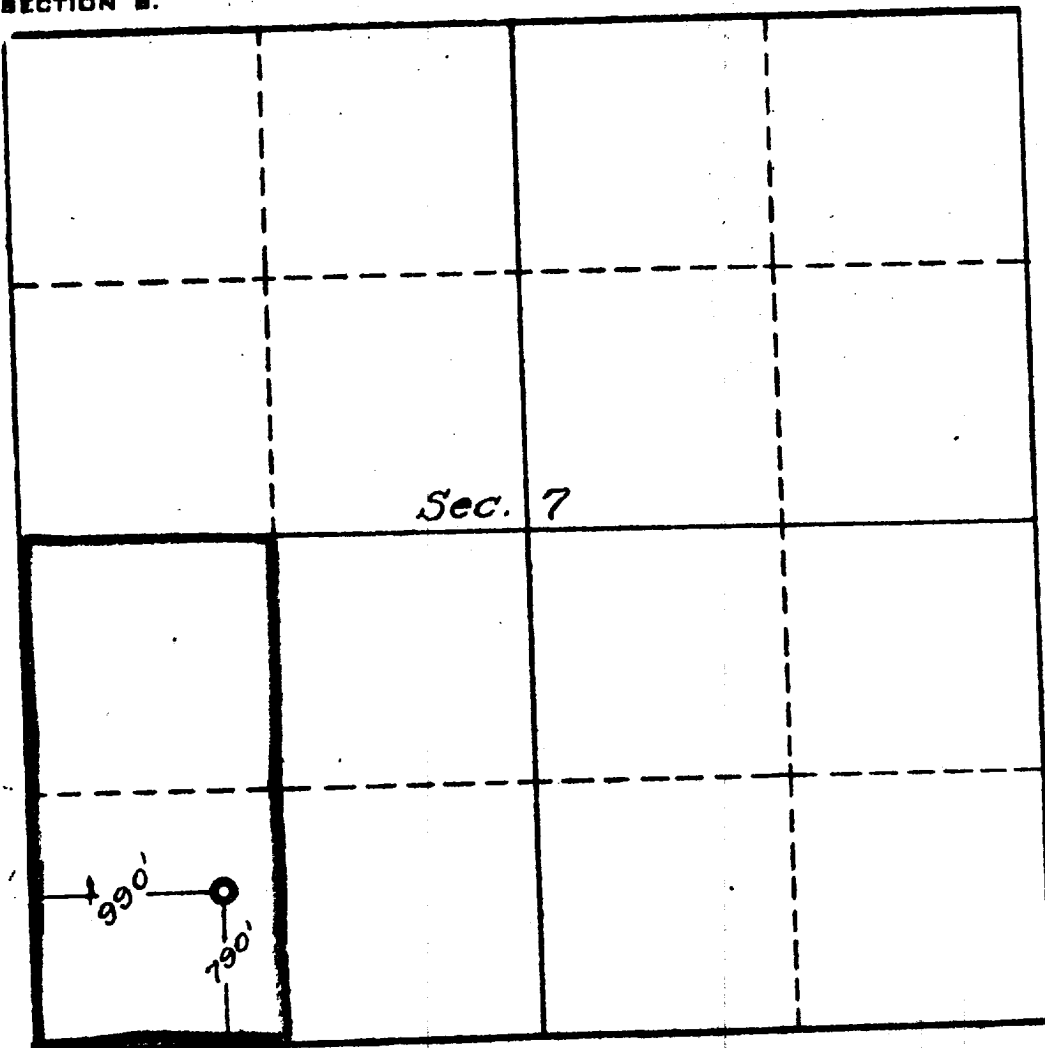

This is to certify that the information in Section A above is true and complete to the best of my knowledge and belief.

Compass Exploration, Inc.

(OPERATOR)

R. J. Farrelly

1845 Court Place
Denver 2, Colorado

(ADDRESS)

This is to certify that the well location shown on the plat in Section B was plotted from field notes of actual survey made by me or under my supervision and that the same is true and correct to the best of my knowledge and belief.

Date Surveyed 1-5-61

Four States Engineering Co.
FARMINGTON, NEW MEXICO

E. J. Cochran
REGISTERED ENGINEER OR
LAND SURVEYOR

Certificate No 1545

