

X			

(SUBMIT IN TRIPLICATE)

UNITED STATES  
DEPARTMENT OF THE INTERIOR  
GEOLOGICAL SURVEY

Land Office **Santa Fe**  
Lease No. **87-078184**  
Unit \_\_\_\_\_

SUNDRY NOTICES AND REPORTS ON WELLS

NOTICE OF INTENTION TO DRILL	X	SUBSEQUENT REPORT OF WATER SHUT-OFF	
NOTICE OF INTENTION TO CHANGE PLANS		SUBSEQUENT REPORT OF SHOOTING OR ACIDIZING	
NOTICE OF INTENTION TO TEST WATER SHUT-OFF		SUBSEQUENT REPORT OF ALTERING CASING	
NOTICE OF INTENTION TO RE-DRILL OR REPAIR WELL		SUBSEQUENT REPORT OF RE-DRILLING OR REPAIR	
NOTICE OF INTENTION TO SHOOT OR ACIDIZE		SUBSEQUENT REPORT OF ABANDONMENT	
NOTICE OF INTENTION TO PULL OR ALTER CASING		SUPPLEMENTARY WELL HISTORY	
NOTICE OF INTENTION TO ABANDON WELL			

(INDICATE ABOVE BY CHECK MARK NATURE OF REPORT, NOTICE, OR OTHER DATA)

June 17, 1960

Well No. **2-B Miller** is located **1090** ft. from **XX** line and **990** ft. from **XX** line of sec. **12**  
**SW/4** **12** **24-N** **7-W** **N.M.P.M.**  
(1/4 Sec. and Sec. No.) (Twp.) (Range) (Meridian)  
**Devil's Fork Gallup** **Rio Arriba County** **New Mexico**  
(Field) (County or Subdivision) (State or Territory)

The elevation of the **G. L.** ~~surface~~ above sea level is **6908** ft.

DETAILS OF WORK

(State names of and expected depths to objective sands; show sizes, weights, and lengths of proposed casings; indicate mudding jobs, cementing points, and all other important proposed work)

It is intended to drill through and test the Gallup Formation for oil production. Rotary tools will be used and the possible producing sand perforated and sand-oil fractured. If the Gallup is indicated to be commercial, 4 1/2" casing would be set and the well completed with a string of 2" tubing. Estimated total depth **6000** feet.

200 ft. of 8 5/8" casing with 125 sacks  
6000 ft. of 4 1/2" casing with 425 sacks  
6000 ft. of 2" tubing

The Pictured Cliffs Formation will be protected by covering it with cement.

I understand that this plan of work must receive approval in writing by the Geological Survey before operations may be commenced.

~~XXXXXX~~ **T. M. McELVAIN**  
Company

Address **220 Shelby Street**  
**Santa Fe, New Mexico**

By *T. M. McElvain*  
Title **Operator**

RECEIVED

1944

1944

RECEIVED

RECEIVED

RECEIVED

RECEIVED

RECEIVED

RECEIVED

RECEIVED

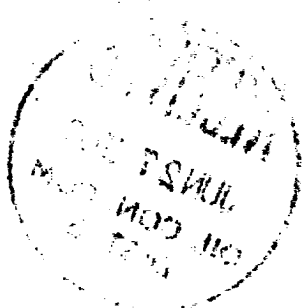

NEW MEXICO OIL CONSERVATION COMMISSION

Well Location and Acreage Dedication Plat

Section A.

Date June 17, 1960

Operator T. A. McElvain Lease Federal SF-078584  
Well No. 218 Unit Letter L Section 12 Township 24 North Range 7 West NMPM  
Located 1490 Feet From South Line, 990 Feet From West Line  
County Elia Arriba G. L. Elevation 6908 Dedicated Acreage 40 Acres  
Name of Producing Formation Gallup Pool Devil's Fork Gallup

1. Is the Operator the only owner\* in the dedicated acreage outlined on the plat below?  
Yes No X
2. If the answer to question one is "no," have the interests of all the owners been consolidated by communitization agreement or otherwise? Yes X No     . If answer is "yes,"  
Type of Consolidation Designation of Operator
3. If the answer to question two is "no," list all the owners and their respective interests below:

Owner

Land Description

Section. B

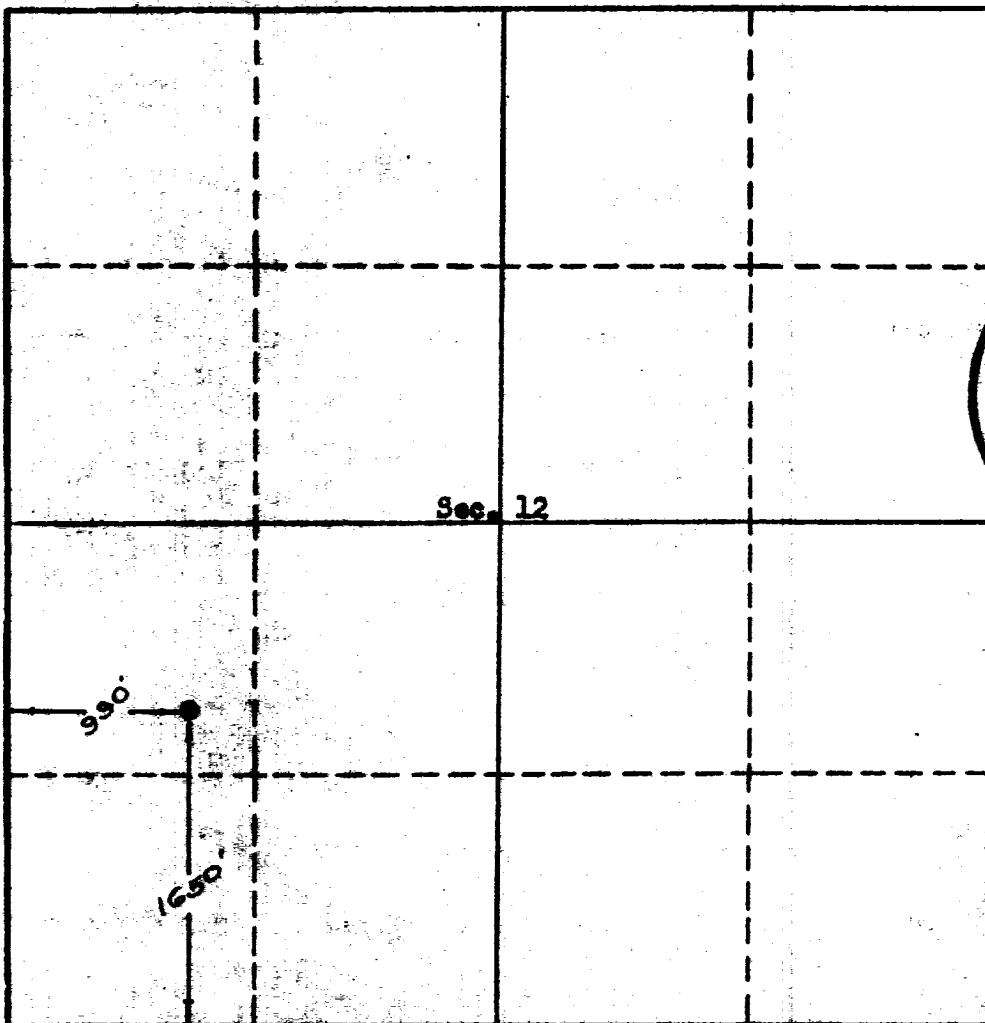

This is to certify that the information in Section A above is true and complete to the best of my knowledge and belief.

*T. A. McElvain*  
(Operator)  
**RECEIVED**  
**JUN 21 1960**  
(Representative)  
220 Shelby Street  
Socorro, N. M.  
Address

This is to certify that the well location shown on the plat in Section A was taken from field notes of actual surveys made by me or under my supervision and that the same is true to the best of my knowledge and belief.

Date Surveyed June 15, 1960

*Ernest V. Echoshawk*  
Ernest V. Echoshawk  
Registered Land Surveyor.

Certificate No. 1545

