

Well Location and Acreage Dedication Plat

Section A.

Date JULY 27, 1965

Operator PAN AMERICAN PETROLEUM CORPORATION Lease JICARILLA NO. 35-B GAS COM
 Well No. 1 Unit Letter H Section 11 Township 24 NORTH Range 5 WEST NMPM
 Located 1850 Feet From THE NORTH Line, 990 Feet From THE EAST Line
 County RIO ARriba G. L. Elevation REPORT LATER Dedicated Acreage 160 Acres
 Name of Producing Formation DAKOTA Pool West Lindrith-Gallup-Dakota

1. Is the Operator the only owner in the dedicated acreage outlined on the plat below?
 Yes X No
2. If the answer to question one is "no", have the interests of all the owners been consolidated by communitization agreement or otherwise? Yes No . If answer is "yes", Type of Consolidation.

3. If the answer to question two is "no", list all the owners and their respective interests below:

Owner

Land Description

Section B.

Note: All distances must be from outer boundaries of section.

This is to certify that the information in Section A above is true and complete to the best of my knowledge and belief.

PAN AMERICAN PETROLEUM CORP.

H. Hollingsworth (Operator)

F. H. Hollingsworth
(Representative)

P. O. Box 480

(Address)

Farmington, New Mexico

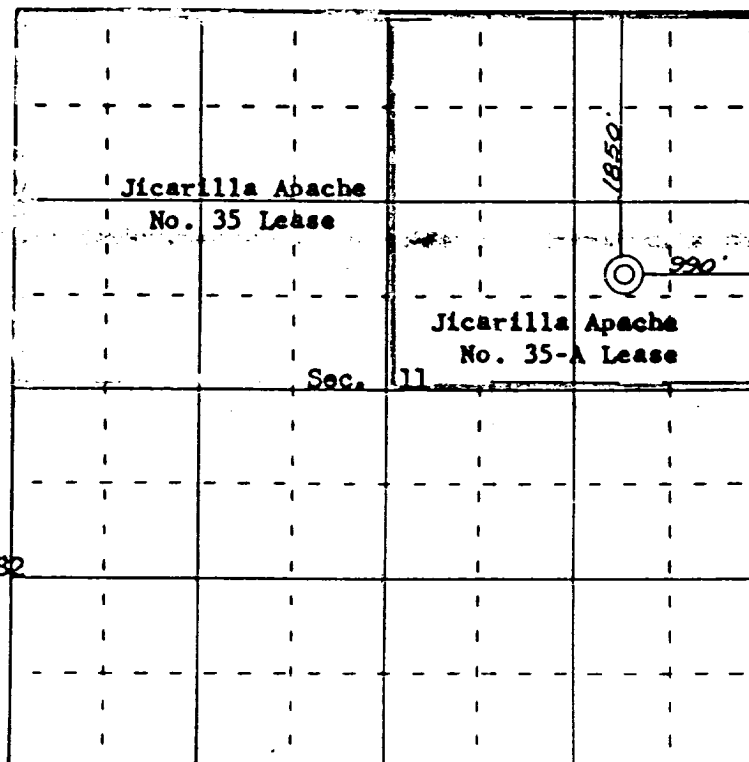

Scale 4 inches equal 1 mile

Ref. GEO plat dated November 4, 1882

This is to certify that the above plat was prepared from field notes of actual surveys made by me or under my supervision and that the same are true and correct to the best of my knowledge and belief.

(Seal)

SKB
Farmington, New Mexico

Date Surveyed July 23, 1965

[Signature]
Registered Professional Engineer and/or Land Surveyor