

Copy

(SUBMIT IN TRIPLICATE)

UNITED STATES
DEPARTMENT OF THE INTERIOR
GEOLOGICAL SURVEY

Land Office Santa Fe

Lease No. NM 03414

Unit _____

SUNDRY NOTICES AND REPORTS ON WELLS

NOTICE OF INTENTION TO DRILL	XX	SUBSEQUENT REPORT OF WATER SHUT-OFF	
NOTICE OF INTENTION TO CHANGE PLANS		SUBSEQUENT REPORT OF SHOOTING OR ACIDIZING	
NOTICE OF INTENTION TO TEST WATER SHUT-OFF		SUBSEQUENT REPORT OF ALTERING CASING	
NOTICE OF INTENTION TO RE-DRILL OR REPAIR WELL		SUBSEQUENT REPORT OF RE-DRILLING OR REPAIR	
NOTICE OF INTENTION TO SHOOT OR ACIDIZE		SUBSEQUENT REPORT OF ABANDONMENT	
NOTICE OF INTENTION TO PULL OR ALTER CASING		SUPPLEMENTARY WELL HISTORY	
NOTICE OF INTENTION TO ABANDON WELL			

(INDICATE ABOVE BY CHECK MARK NATURE OF REPORT, NOTICE, OR OTHER DATA)

August 15, 1960

Well No. 1-8 is located 1930 ft. from N line and 1930 ft. from W line of sec. 8

SE NW Sec. 8 24 North, 7 West NMPM
($\frac{1}{4}$ Sec. and Sec. No.) (Twp.) (Range) (Meridian)

Wildcat Rio Arriba County New Mexico
(Field) (County or Subdivision) (State or Territory)

The elevation of the derrick floor above sea level is 7326 ft. 7312 GL

DETAILS OF WORK

(State names of and expected depths to objective sands; show sizes, weights, and lengths of proposed casings; indicate mudding jobs, cementing points, and all other important proposed work)

Propose to drill a 7350' test for oil and/or gas to the base of the Dakota formation.
Propose to set 270' of 8-5/8" surface casing and cement with 200 sx.
If production is encountered, propose to set 5-1/2" production string with approximately 250 sx.

Estimated tops:

Pictured Cliffs 2685'
Lewis 2845'
Mesaverde Transition 3535'
Mancos 5245'
Gallup 5985'

Lower Mancos 6315'
Dakota 7075'
T.D. 7350'

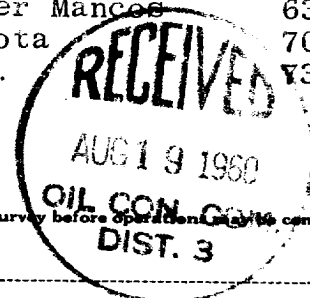

I understand that this plan of work must receive approval in writing by the Geological Survey before operations may be commenced.

Company COMPASS EXPLORATION, INC.

Address 1645 Court Place

Denver 2, Colorado

AM 6-1939

By R. J. Farrelly

Title Chief Geologist

NEW MEXICO OIL CONSERVATION COMMISSION
Well Location and Acreage Dedication Plat

Section A.

Date August 15, 1960

Operator COMPASS EXPLORATION INC. Lease FEDERAL
Well No. 1-9 Unit Letter Section 8 Township 24 N Range 7 W
Located 1980 Feet From north Line, 1980 Feet From west Line
County Rio Arriba G. L. Elevation 7312 Dedicated Acreage 320 Acres
Name of Producing Formation Dakota Pool

1. Is the Operator the only owner* in the dedicated acreage outlined on the plat below?
Yes xx No .
2. If the answer to question one is "no," have the interests of all the owners been consolidated by communitization agreement or otherwise? Yes No . If answer is "yes," Type of Consolidation
3. If the answer to question two is "no," list all the owners and their respective interests below:

Owner

Land Description

Section B

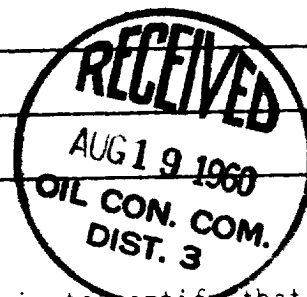
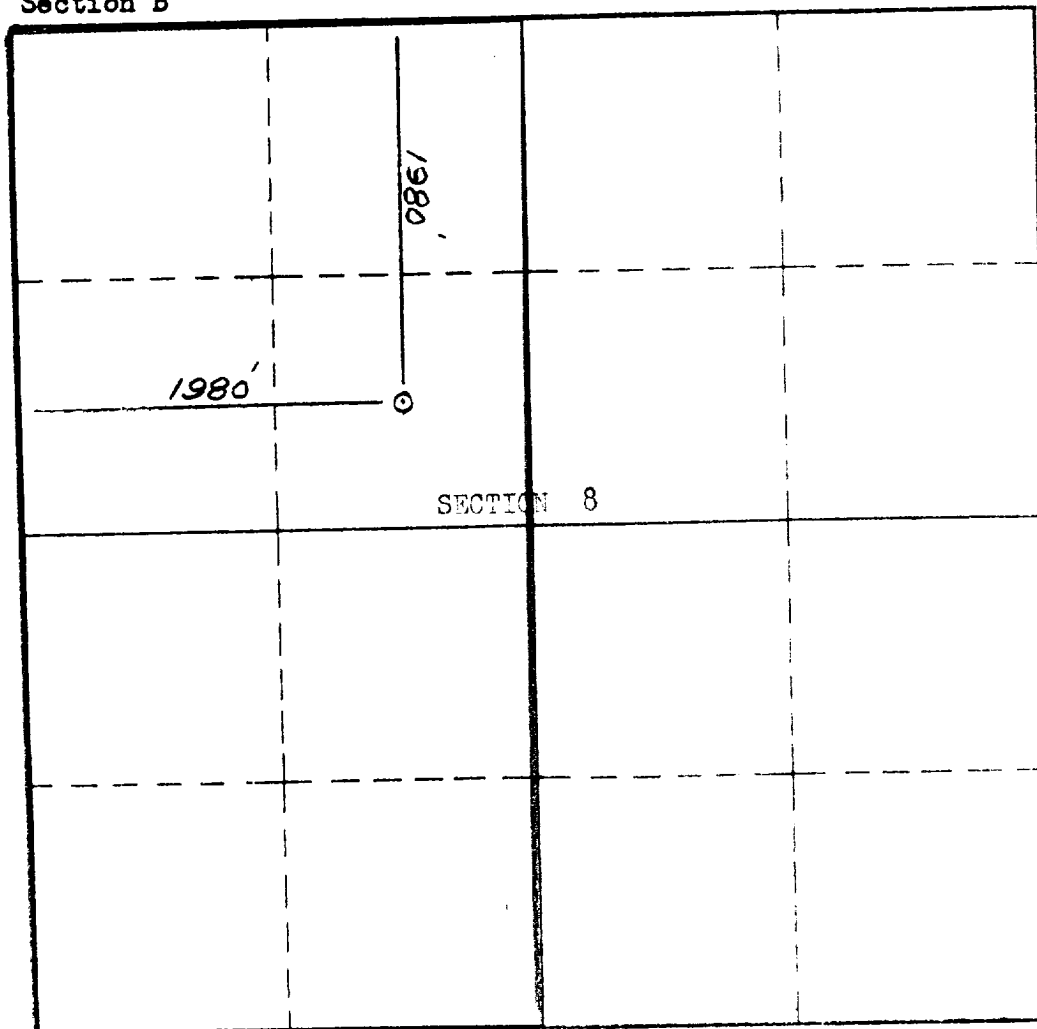

This is to certify that the information in Section A above is true and complete to the best of my knowledge and belief.

COMPASS EXPLORATION, INC
(Operator)

(Representative)
1645 Court Place
Denver 2, Colorado
Address

This is to certify that the well location shown on the plat in Section B was plotted from field notes of actual surveys made by me or under my supervision and that the same is true and correct to the best of my knowledge and belief.

Date Surveyed Aug. 12, 1960

Stephen H. Kinney
STEPHEN H. KINNEY
Registered Professional
Engineer and/or Land Surveyor.

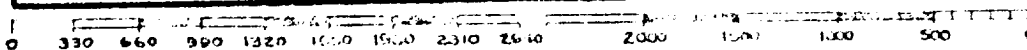

Certificate No. 803