

NEW MEXICO OIL CONSERVATION COMMISSION

Well Location and Acreage Dedication Plat

Section A.

Date July 19, 1957

Operator NAGANOL PETROLEUM COMPANY Lease W. O. HUGHES
Well No. 3 Unit Letter Section 8 Township 24N Range 3E NMPN
Located 920 Feet From North Line, 990 Feet From East Line
County Blanco G. L. Elevation 6937 Dedicated Acreage 160 Acres
Name of Producing Formation Pictured Cliffs Pool Undesignated

1. Is the Operator the only owner* in the dedicated acreage outlined on the plat below?
Yes X No .
2. If the answer to question one is "no," have the interests of all the owners been consolidated by communitization agreement or otherwise? Yes No . If answer is "yes," Type of Consolidation
3. If the answer to question two is "no," list all the owners and their respective interests below:

Owner

Land Description



Section B.

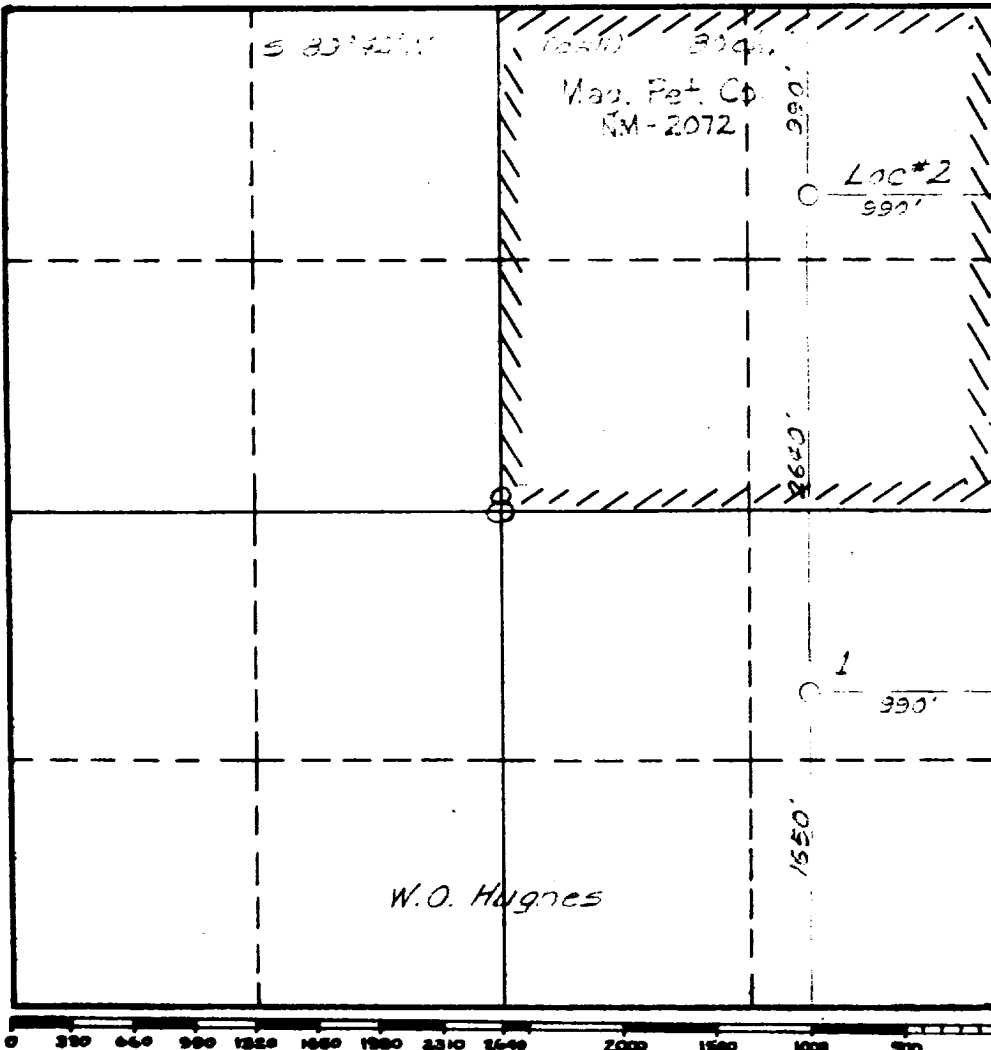

This is to certify that the information in Section A above is true and complete to the best of my knowledge and belief.

Naganol Petroleum Company

(Operator)

(Representative)

Box 2104, Santa Fe, New Mexico

Address

This is to certify that the well location shown on the plat in Section B was plotted from field notes of actual surveys made by me or under my supervision and that the same is true and correct to the best of my knowledge and belief.

Date Surveyed July 17, 1957

Carl E. Turner
Registered Professional
Engineer and/or Land Surveyor.

Certificate No. 2490

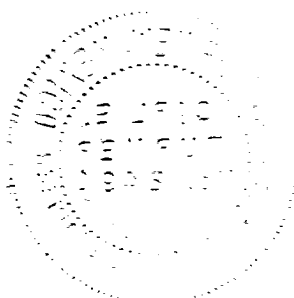

OIL CONSERVATION COMMISSION		
AZTEC DISTRICT OFFICE		
No. Copies Received <i>3</i>		
DISTRIBUTION		
	NO. FURNISHED	
Operator	<i>/</i>	
Santa Fe	<i>/</i>	
Proration Office		
State Land Office		
U. S. G. S.		
Transporter		
File	<i>/</i>	<input checked="" type="checkbox"/>