

NEW MEXICO OIL CONSERVATION COMMISSION

NOTICE OF INTENTION TO DRILL

See Rules 101 and 1104.

If changes in the proposed plan are considered advisable, a copy of this notice showing such changes will be returned to the sender. Submit this notice in triplicate. One copy will be returned following approval.

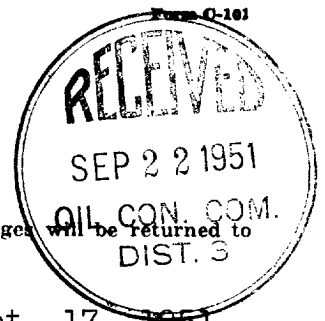

Durango, Colorado

Sept. 17, 1951

Place

Date

Notice hereby is given that it is our intention to commence the drilling of a well to be known as Greenbrier -

Palmer, Greenbrier Oil Co. Palmer well No. 1 in S. E. 1/4
Company or Operator Lease

of Sec. 1, T. 24 N., R. 2 W., N. M., P. M., Wildcat Pool, Rio Arriba County.

The well is 990' feet from (X) (S.) line and 1650 feet from

(E.) ~~XX~~ line of the above section.

(Give location from section lines. Cross out wrong directions.)

If state land the oil and gas lease is No. _____ Assignment No. _____

If patented land the owner is Rodger J. Palmer

Address Lindrith, New Mexico

If government land the permittee is _____

Address _____

The lessee is _____

Address _____

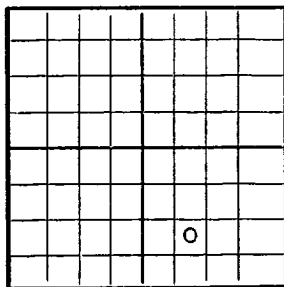

AREA 640 ACRES

LOCATE WELL CORRECTLY

We propose to drill well with drilling equipment as follows: Rotary tools to
top Mesa Verde approximately 5200' and drill in with dry gas or cable-
tools.

The status of a bond for this well in conformance with Rule 101 of the General Rules and Regulations of the Commission is as follows: \$10,000 blanket bond now on file with Conservation Commission.

We propose to use the following strings of casing and to land or cement them as indicated:

Size of Hole	Size of Casing	Weight Per Foot	New or Second Hand	Depth	Landed or Cemented	Sacks Cement
15"	10-3/4"	32.75	New	Approx. 150'	Cemented	150
9"	7"	20 & 23	New	Approx. 5200'	Cemented	350

If changes in the above plans become advisable we will notify you before cementing or landing casing. We estimate that the first productive oil or gas sand should occur at a depth of about _____ feet.

Additional information:

10-3/4" casing will be set at approximately 150' and cemented to top.
7" 20 & 23# casing will be set on top of Mesa Verde approximately 5200',
it will be cemented with 150 sacks and 200 sacks additional spotted in
the Picture Cliff formation. An attempt will be made to drill well in
with dry gas, and all concerned to be notified. Well will be shot with
Approved _____, 19____ approximately 1000 quarts of solidified
except as follows: nitro gly.

Greenbrier Oil Company
Company or Operator

By [Signature]

Position Supt. Prod. - 250

Send communications regarding well to:

Name Harry J. Miller

Address 1710 Main Ave, Durango, Colo.

OIL CONSERVATION COMMISSION,

By Al Gus

Title Oil and Gas Inspector Dist. #3.

SEP 22 1951

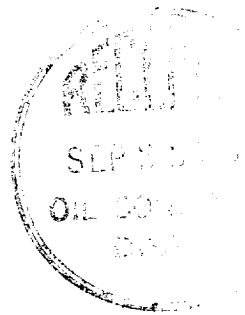

Company Greenbrier Oil Company

Lease Greenbrier-Palmer Well No. 1

Sec. 1 T. 24 N., R. 2 W., N.E.P.M.

Location 990' from the South line and 1650'
from the East line.

Rio Arriba County

New Mexico

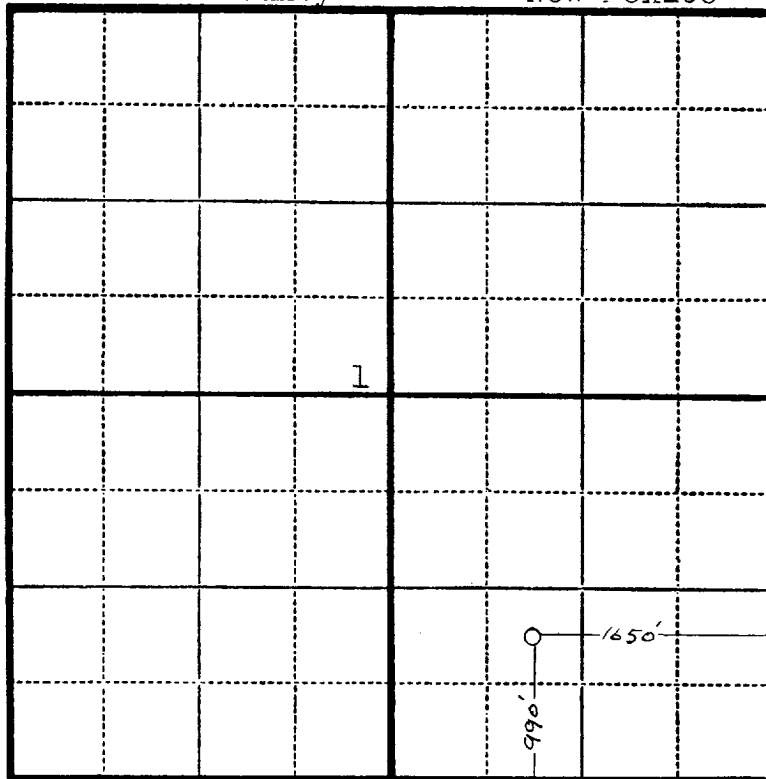

Scale—4 inches equals 1 mile.

This is to certify that the above plat was prepared from field notes of actual surveys made by me or under my supervision and that the same are true and correct to the best of my knowledge and belief.

Charles J. Finklea

Seal:

Registered Professional Charles J. Finklea
Engineer and Land Surveyor. N. Mex. Reg. No. 1302

Surveyed September 10, 1951

Elevation Survey

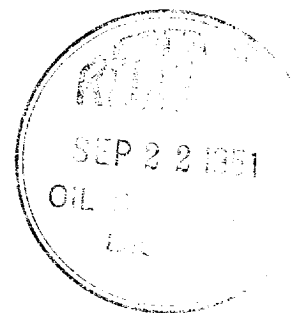

Company Greenbrier Oil Company

Lease Greenbrier-Palmer Well No. 1

Sec. 1 T. 24 N., R. 2 W., N.M.P.M.

Location 990' from the South line and 1650'
from the East line.

~~SAN JUAN COUNTY~~ New Mexico
Rio Arriba County

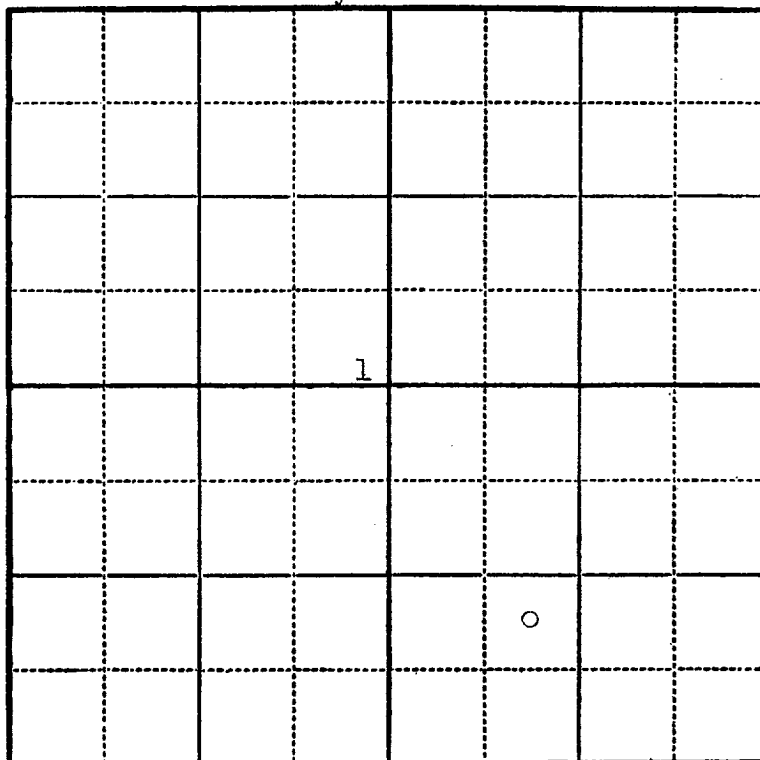

N

Scale—4 inches equals 1 mile.

Ungraded ground elevation 7317.85

Graded ground elevation _____

Derrick floor elevation _____

Temporary bench mark elevation _____

Remarks: Starting elevation datum was taken
from the Denman-Palmer #1, in Sec. 1;

T 24N. R 2W. Given elevation of Denman-Palmer #1,
7326.0.

SAN JUAN ENGINEERING CO.
Farmington, New Mexico

Date Surveyed September 10 19 51