

(SUBMIT IN TRIPLICATE)

UNITED STATES
DEPARTMENT OF THE INTERIOR
GEOLOGICAL SURVEY

Land Office _____

Lease No. **SF 080394-A**

Unit _____

SUNDRY NOTICES AND REPORTS ON WELLS

NOTICE OF INTENTION TO DRILL	<input checked="" type="checkbox"/>	SUBSEQUENT REPORT OF WATER SHUT-OFF	
NOTICE OF INTENTION TO CHANGE PLANS		SUBSEQUENT REPORT OF SHOOTING OR ACIDIZING	
NOTICE OF INTENTION TO TEST WATER SHUT-OFF		SUBSEQUENT REPORT OF ALTERING CASING	
NOTICE OF INTENTION TO RE-DRILL OR REPAIR WELL		SUBSEQUENT REPORT OF RE-DRILLING OR REPAIR	
NOTICE OF INTENTION TO SHOOT OR ACIDIZE		SUBSEQUENT REPORT OF ABANDONMENT	
NOTICE OF INTENTION TO PULL OR ALTER CASING		SUPPLEMENTARY WELL HISTORY	
NOTICE OF INTENTION TO ABANDON WELL			

(INDICATE ABOVE BY CHECK MARK NATURE OF REPORT, NOTICE, OR OTHER DATA)

May 24, 19 57

Isolack "B"
Well No. **2** is located **1673** ft. from **S** line and **1840** ft. from **W** line of sec. **1**
SW/4 Section 1
(1/4 Sec. and Sec. No.)
South Blanco
(Field)
24N
(Twp.)
6W
(Range)
18SPM
(Meridian)
Rio Arriba
(County or Subdivision)
New Mexico
(State or Territory)

The elevation of the derrick floor above sea level is **6604** ft.

DETAILS OF WORK

(State names of and expected depths to objective sands; show sizes, weights, and lengths of proposed casings; indicate mudding jobs, cementing points, and all other important proposed work)

Objective Horizons: Pictured Cliffs Sand, expected at about 2450'.
Surface Strings: 8-5/8", 24#, J-55 at 90' with 70 sacks.
Production Strings: 3-1/2", 15.5#, J-55 at 2550' with 100 sacks.
Mud Programs: Wt. 9.5, Visc. 50-60, Filt. 10 (Begin at 500').
Cementing Intervals: 0' to 90', Estimate 1875' to 2550'.

I understand that this plan of work must receive approval in writing by the Geological Survey before operations may be commenced.

Company **The El Dorado Refining Company**

Address **1030 Central Building**

Wichita, Kansas

By **Max S. Houston**
Title **Manager of Exploration**

5-20-57

EL DORADO REFINING COMPANY

BOLACK-B SF 080594

2

1

24N

6W

1673

SOUTH

1840

WEST

RIO ARRIBA

6604

P.C.

WILDCAT

160 ACRES

(1882 PLAT)

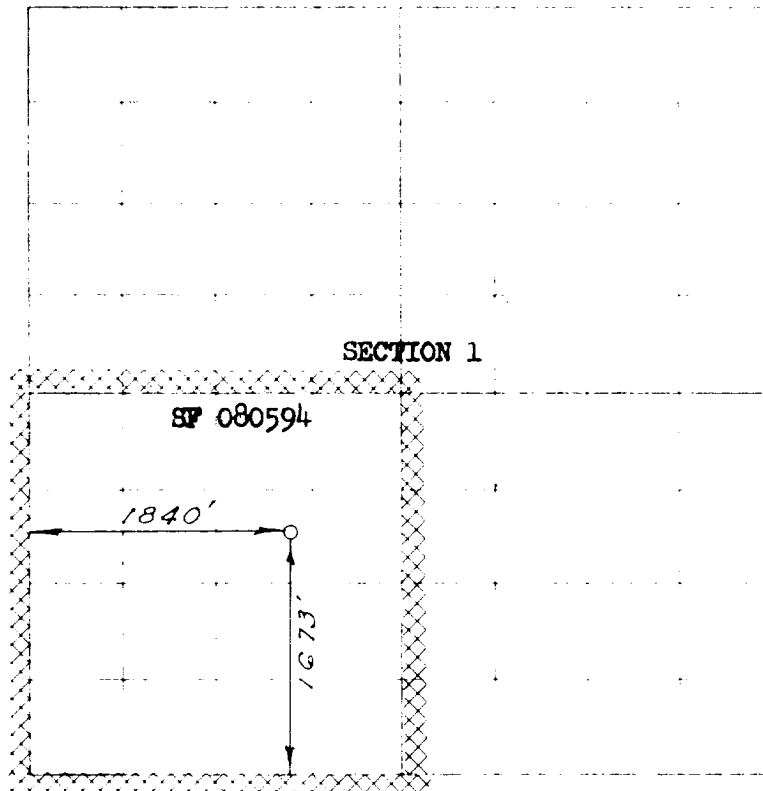

SECTION 1

SF 080594

1840'

1673'

MAY

NOTE

1. This plat is a true and correct copy of the original plat on file in the office of the County Clerk, Pima County, Arizona.



I, the undersigned, being a duly qualified and licensed Professional Engineer and a Licensed Surveyor, do hereby certify that the above is a true and correct copy of the original plat on file in the office of the County Clerk, Pima County, Arizona.

Date Surveyed: **OCTOBER 5, 1956**

E. O. Walker

Registered Professional Engineer and Licensed Surveyor

1. Is this well located within the boundaries of the tract?
2. If the well is located within the boundaries of the tract, is it located within the boundaries of the tract as shown on the plat?
3. If the well is located within the boundaries of the tract, is it located within the boundaries of the tract as shown on the plat?
4. If the well is located within the boundaries of the tract, is it located within the boundaries of the tract as shown on the plat?
5. If the well is located within the boundaries of the tract, is it located within the boundaries of the tract as shown on the plat?
6. If the well is located within the boundaries of the tract, is it located within the boundaries of the tract as shown on the plat?
7. If the well is located within the boundaries of the tract, is it located within the boundaries of the tract as shown on the plat?
8. If the well is located within the boundaries of the tract, is it located within the boundaries of the tract as shown on the plat?
9. If the well is located within the boundaries of the tract, is it located within the boundaries of the tract as shown on the plat?
10. If the well is located within the boundaries of the tract, is it located within the boundaries of the tract as shown on the plat?