

NEW MEXICO
OIL CONSERVATION COMMISSION

Form C-128

Well Location and/or Gas Proration Plat

Date _____

Operator J. Felix Hickman Lease _____

Well No. 6 Section 5 Township 24 North Range 3 West NMPM

Located 1820 Feet From North Line, 1800 Feet From East Line,

Rio Arriba County, New Mexico. G. L. Elevation 7200

Name of Producing Formation _____ Pool _____ Dedicated Acreage 173.4

(Note: All distances must be from outer boundaries of Section)

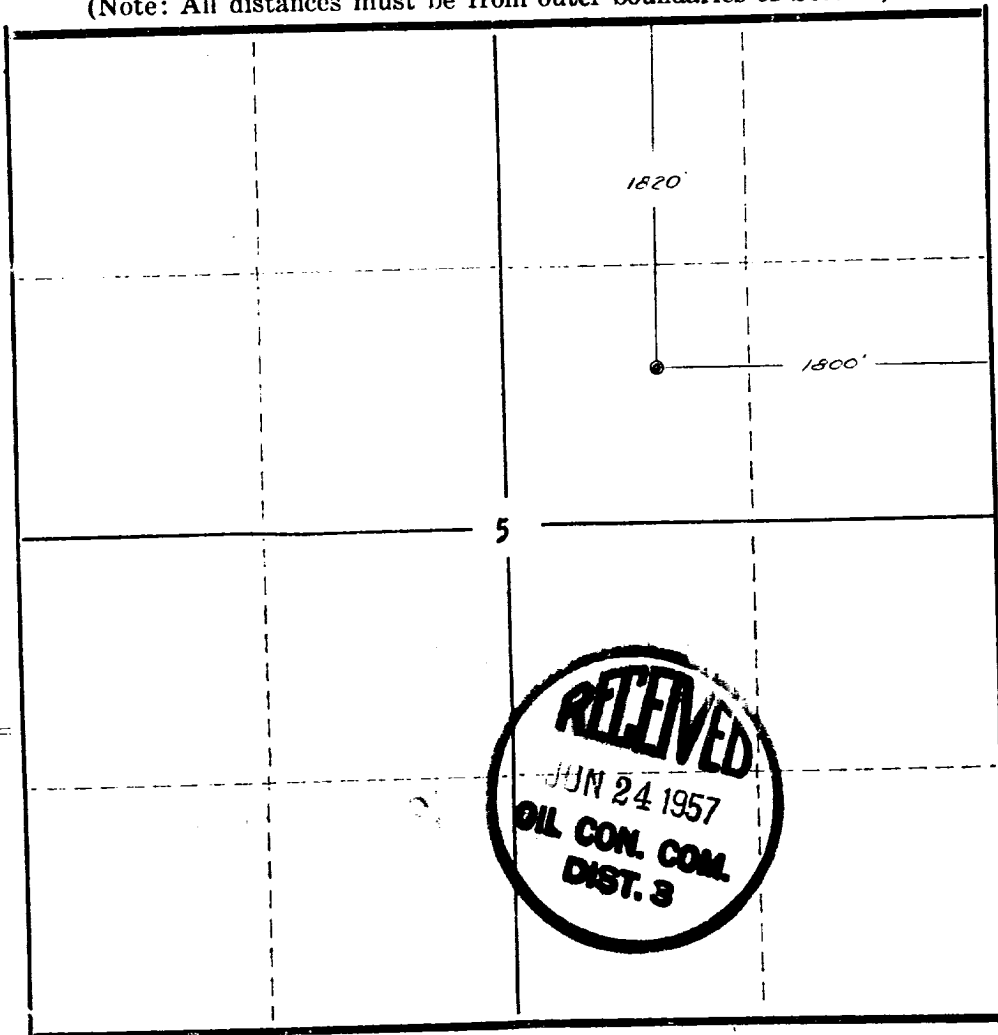

NOTE

This section of
form is to be
used for gas
wells only.

SCALE: 1"=1000'

1. Is this Well a Dual Comp. ? Yes ___ No ___
2. If the answer to Question 1 is yes, are there any other
dually completed wells within the dedicated acreage?
Yes ___ No ___

Name _____
Position _____
Representing _____
Address _____

This is to certify that the above plat was prepared
from field notes of actual surveys made by me
under my supervision and that the same are true
correct to the best of my knowledge

Date Surveyed May 16, 1957

Ernest V. Echohawk
Ernest V. Echohawk
Reg. Land Surveyor, N. Mex., Reg. No. 1545

OIL CONSERVATION COMMISSION		
AZTEC DISTRICT OFFICE		
No. Copies Received		
DISTRIBUTION		
	NO. FURNISHED	
Operator		
Santa Fe		
Proration Office		
State Land Office		
U. S. G. S.		
Transporter		
File		

NEW MEXICO OIL CONSERVATION COMMISSION
Well Location and Acreage Dedication Plat

Section A:

Date June 13, 1957

Operator J. Felix Hickman Lease Clark
Well No. 6 Unit Letter Section 5 Township 24 N. Range 3 W. NMPM
Located 1820 Feet From North Line, 1800 Feet From East Line
County Rio Arriba G. L. Elevation 7200' Dedicated Acreage 173.11 Acres
Name of Producing Formation Pictured Cliff Pool Undesignated

1. Is the Operator the only owner* in the dedicated acreage outlined on the plat below?
Yes Yes No .
2. If the answer to question one is "no," have the interests of all the owners been consolidated by communitization agreement or otherwise? Yes No . If answer is "yes," Type of Consolidation
3. If the answer to question two is "no," list all the owners and their respective interests below:

<u>Owner</u>	<u>Land Description</u>
<u>J. Felix Hickman</u>	<u> </u>
<u> </u>	<u> </u>
<u> </u>	<u> </u>

Section B

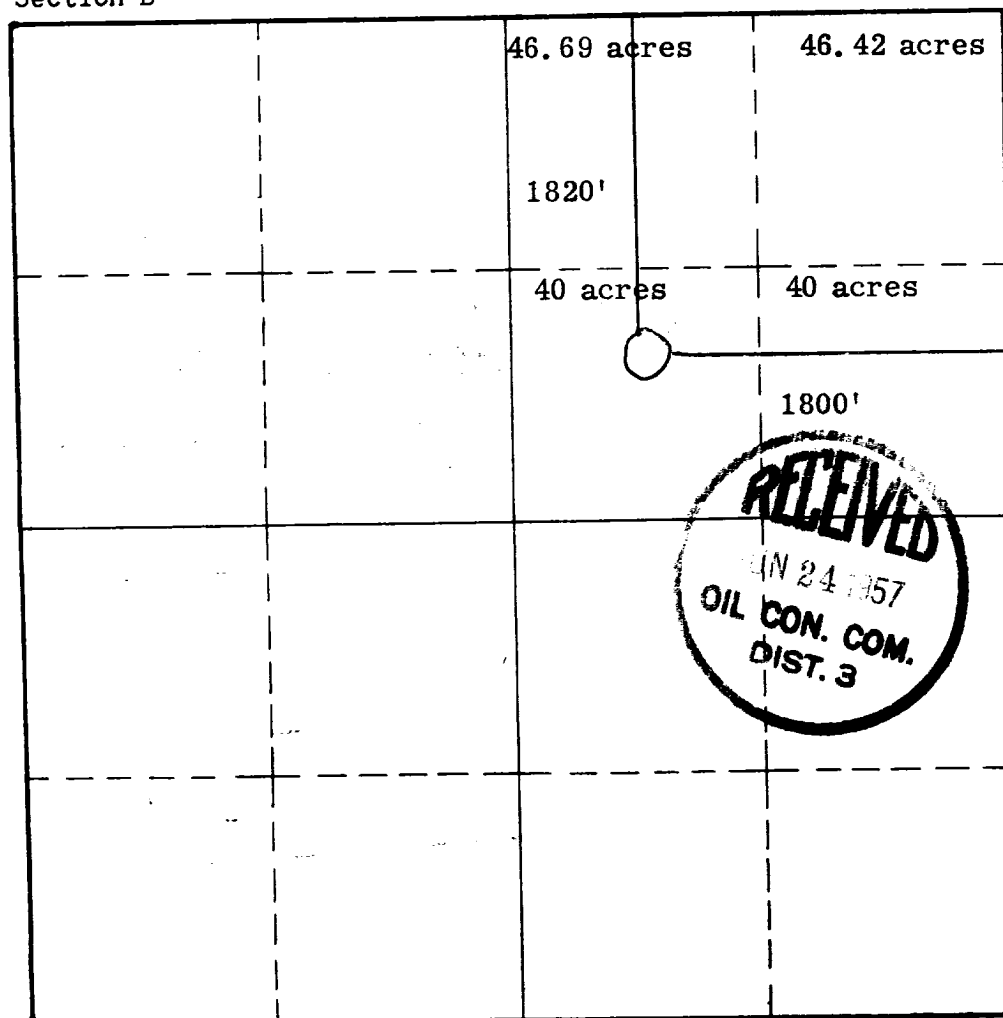

This is to certify that the information in Section A above is true and complete to the best of my knowledge and belief.

J. Felix Hickman
(Operator)

(Representative)
4115 Avenida La Resolana, NE
Albuquerque, New Mexico
Address

This is to certify that the well location shown on the plat in Section B was plotted from field notes of actual surveys made by me or under my supervision and that the same is true and correct to the best of my knowledge and belief.

Date Surveyed

Registered Professional
Engineer and/or Land Surveyor.

Certificate No.

INSTRUCTIONS FOR COMPLETION:

1. Operator shall furnish and certify to the information called for in Section A.
2. Operator shall outline the dedicated acreage for both oil and gas wells on the plat in Section B.
3. A registered professional engineer or land surveyor registered in the State of New Mexico or approved by the Commission shall show on the plat the location of the well and certify this information in the space provided.
4. All distances shown on the plat must be from the outer boundaries of Section.
5. If additional space is needed for listing owners and their respective interests as required in question 3, Section A, please use space below

OIL CONSERVATION COMMISSION		
AZTEC DISTRICT OFFICE		
No. Copies Received		4
DISTRIBUTION		
	NO. FURNISHED	
Operator	1	
Santa Fe	1	
Proration Office		
State Land Office		
U. S. G. S.	1	
Transporter		
File	1	✓

* "Owner" means the person who has the right to drill into and to produce from any pool and to appropriate the production either for himself or for himself and another. (65-3-29 (e) NMSA 1953 Comp.)