

NEW MEXICO
OIL CONSERVATION COMMISSION

Form C-128

Well Location and/or Gas Proration Plat

Operator **J. Felix Hickman**

Lease

CLARK

Date

4-11-56
W.M. 03011

Well No. **3** Section **5** Township **24 North** Range **3 West** NMPM

Located **1730** Feet From **North** Line, **1550** Feet From **West** Line,

Rio Arriba

County, New Mexico.

G. L. Elevation **7030**

Name of Producing Formation

P.C.

Pool

Wildcat

Dedicated Acreage

174.21
160

(Note: All distances must be from outer boundaries of Section)

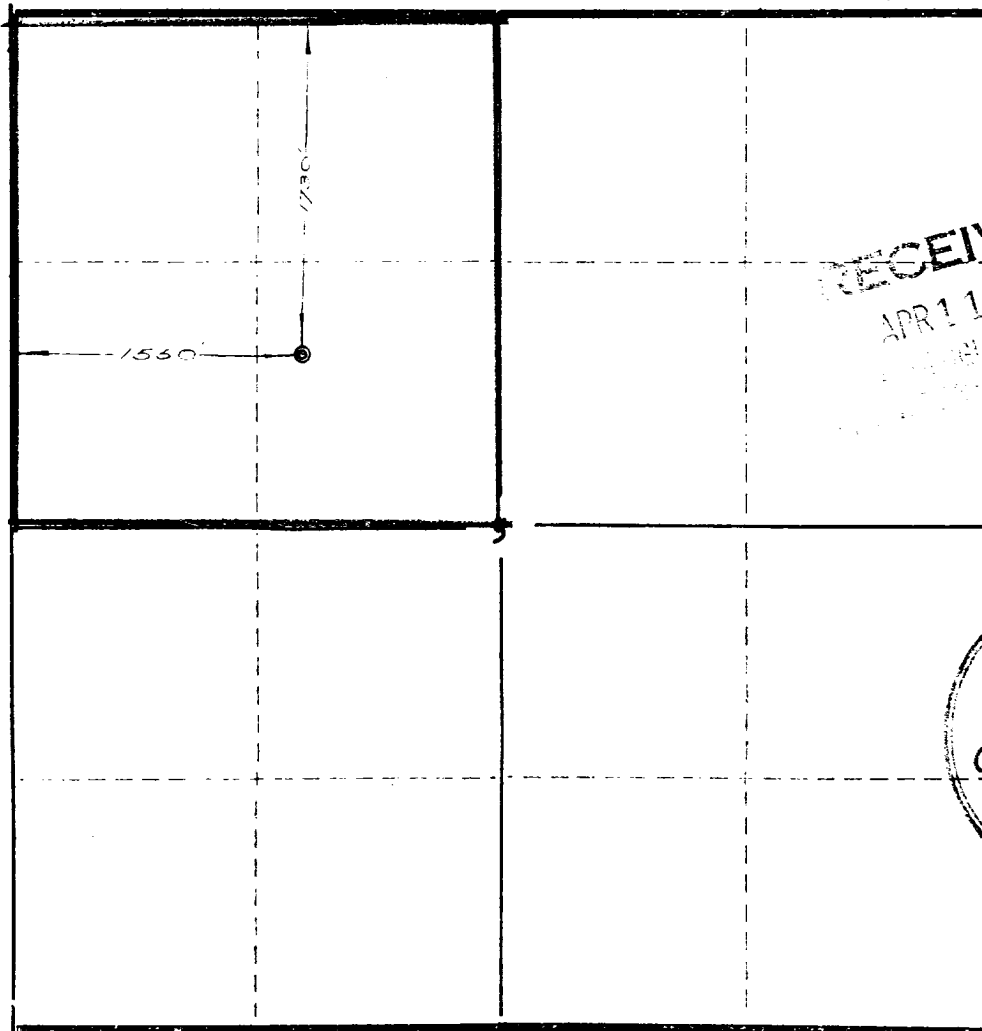

RECEIVED
APR 11 1956
OIL CONSERVATION SURVEY
NEW MEXICO

RECEIVED
APR 11 1956
OIL CON. COM.
DIST. 3

NOTE

This section of form is to be used for gas wells only.

SCALE: 1"=1000'

1. Is this Well a Dual Comp. ? Yes ☒ No ☐
2. If the answer to Question 1 is yes, are there any other dually completed wells within the dedicated acreage?

Yes ☐ No ☒

Name **E. E. Jackson**
Position **Agent**
Representing **J. Felix Hickman**
Address **Box 891 Farmington**

This is to certify that the above plat was prepared from field notes of actual surveys made by me or under my supervision and that the same are true and correct to the best of my knowledge and belief.

Date Surveyed **April 6, 1956**

Ernest V. Echohawk
Reg. Land Surveyor, N. Mex., Reg. No. 1545

