

(SUBMIT IN TRIPLICATE)

UNITED STATES
DEPARTMENT OF THE INTERIOR
GEOLOGICAL SURVEY

Land Office Santa Fe
Lease No. 078874
Unit Canyon Largo Unit

SUNDRY NOTICES AND REPORTS ON WELLS

NOTICE OF INTENTION TO DRILL.....	<input checked="" type="checkbox"/>	SUBSEQUENT REPORT OF WATER SHUT-OFF.....
NOTICE OF INTENTION TO CHANGE PLANS.....	<input type="checkbox"/>	SUBSEQUENT REPORT OF SHOOTING OR ACIDIZING.....
NOTICE OF INTENTION TO TEST WATER SHUT-OFF.....	<input type="checkbox"/>	SUBSEQUENT REPORT OF ALTERING CASING.....
NOTICE OF INTENTION TO RE-DRILL OR REPAIR WELL.....	<input type="checkbox"/>	SUBSEQUENT REPORT OF RE-DRILLING OR REPAIR.....
NOTICE OF INTENTION TO SHOOT OR ACIDIZE.....	<input type="checkbox"/>	SUBSEQUENT REPORT OF ABANDONMENT.....
NOTICE OF INTENTION TO PULL OR ALTER CASING.....	<input type="checkbox"/>	SUPPLEMENTARY WELL HISTORY.....
NOTICE OF INTENTION TO ABANDON WELL.....	<input type="checkbox"/>	

(INDICATE ABOVE BY CHECK MARK NATURE OF REPORT, NOTICE, OR OTHER DATA)

March 25, 19 58

Well No. 2 is located 1672 ft. from N line and 1750 ft. from E line of sec. 4
SW Sec. 4 24N 6W N.M.P.M.
(1/4 Sec. and Sec. No.) (Twp.) (Range) (Meridian)
Largo Canyon P.C. Ect. Bio Arriba New Mexico
(Field) (County or Subdivision) (State or Territory)

The elevation of the derrick floor above sea level is 6670 ft.

DETAILS OF WORK

(State names of and expected depths to objective sands; show sizes, weights, and lengths of proposed casings; indicate mudding jobs, cementing points, and all other important proposed work)

It is intended to drill a well thru the Pictured Cliff formation using rotary tools and to perforate and water fracture possible producing zones. Est. T.D. 2539'.

Casing Program:

8 5/8" at 120' with 125 sacks regular cement circulated to surface.
5 1/2" at 2539' with 75 sacks regular cement, 75 sacks Pozz.

The NW/4 of Section 4 is dedicated to this well.

NW/4: S.F. 078874

I understand that this plan of work must receive approval in writing by the Geological Survey before operations may be commenced.

Company El Paso Natural Gas Company

Address Box 997

Farmington, New Mexico

Original Signed D. C. Johnston

By

Title Petroleum Engineer

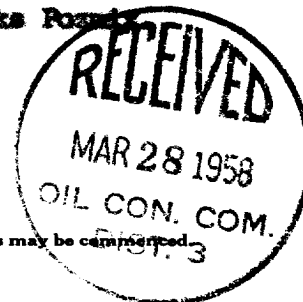

OK
LA

NEW MEXICO OIL CONSERVATION COMMISSION

Well Location and Acreage Dedication Plat

Section A.

Date **MARCH 21, 1958**

Operator **EL PASO NATURAL GAS COMPANY** Lease **CANYON LARGO** SF **078874**
 Well No. **2** Unit Letter **F** Section **4** Township **24-N** Range **6-W** NMPM
 Located **1672** Feet From **NORTH** Line, **1750** Feet From **WEST** Line
 County **RIO ARRIBA** G. L. Elevation **6660** Dedicated Acreage **160** Acres
 Name of Producing Formation **PICTURED CLIFF** Pool **LARGO CANYON P.C. EXTENSION**

1. Is the Operator the only owner in the dedicated acreage outlined on the plat below?

Yes **XX** No

2. If the answer to question one is "no", have the interests of all the owners been consolidated by communitization agreement or otherwise? Yes No . If answer is "yes", Type of Consolidation.

3. If the answer to question two is "no", list all the owners and their respective interests below:

Owner

Land Description

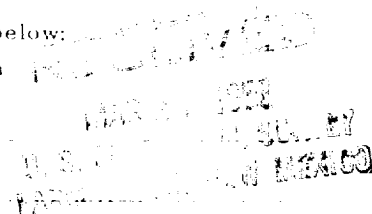

Section B.

This is to certify that the information
 in Section A above is true and complete
 to the best of my knowledge and belief.

El Paso Natural Gas Company

(Operator)

Original Signed D. C. Johnston

(Representative)

Box 997

(Address)

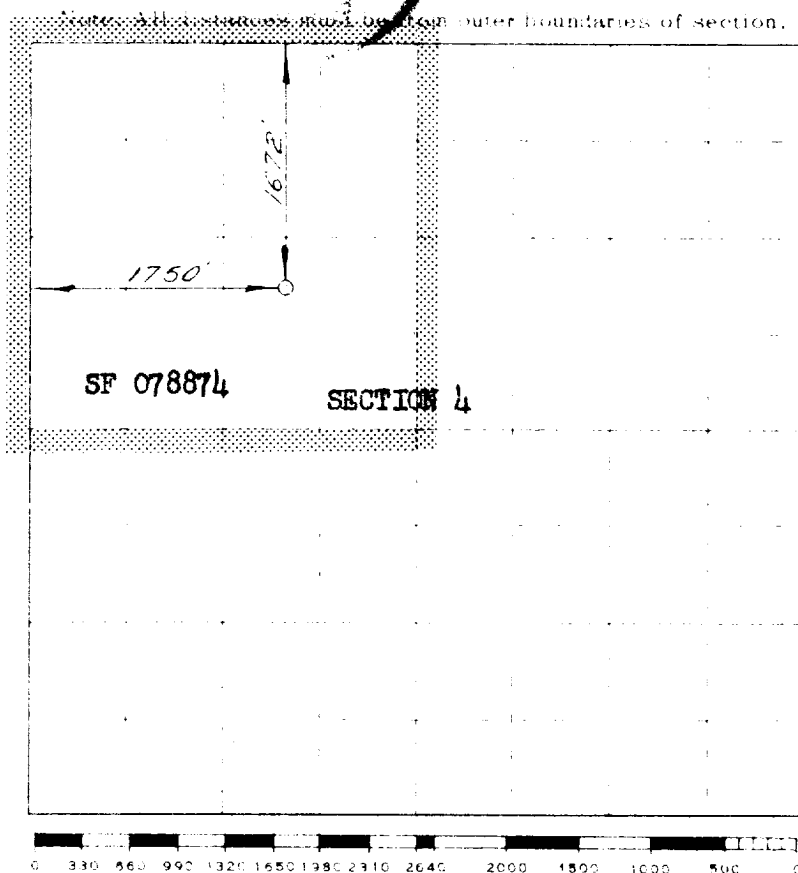
Farmington, New Mexico

Scale 1 inches equal 1 mile

This is to certify that the above plat was prepared from field notes of actual surveys
 made by me or under my supervision and that the same are true and correct to the best
 of my knowledge and belief.

(Seal)

Date Surveyed **MARCH 6, 1958**

Farmington, New Mexico

Registered Professional Engineer and/or Land Surveyor