

(SUBMIT IN TRIPLICATE)

Indian Agency **Jicarilla**

UNITED STATES
DEPARTMENT OF THE INTERIOR
GEOLOGICAL SURVEY

Allottee **Jicarilla Tribal**

Lease No. **Contract 111**

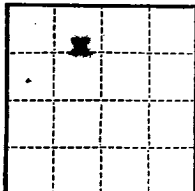

SUNDRY NOTICES AND REPORTS ON WELLS

NOTICE OF INTENTION TO DRILL	<input checked="" type="checkbox"/>	SUBSEQUENT REPORT OF WATER SHUT-OFF	
NOTICE OF INTENTION TO CHANGE PLANS		SUBSEQUENT REPORT OF SHOOTING OR ACIDIZING	
NOTICE OF INTENTION TO TEST WATER SHUT-OFF		SUBSEQUENT REPORT OF ALTERING CASING	
NOTICE OF INTENTION TO REDRILL OR REPAIR WELL		SUBSEQUENT REPORT OF REDRILLING OR REPAIR	
NOTICE OF INTENTION TO SHOOT OR ACIDIZE		SUBSEQUENT REPORT OF ABANDONMENT	
NOTICE OF INTENTION TO PULL OR ALTER CASING		SUPPLEMENTARY WELL HISTORY	
NOTICE OF INTENTION TO ABANDON WELL			

(INDICATE ABOVE BY CHECK MARK NATURE OF REPORT, NOTICE, OR OTHER DATA)

March 27th, 19 **57**

Well No. **2-N** is located **990** ft. from **N** line and **1600** ft. from **W** line of sec. **5**

NE/4 NW/4 Sec. 5
(1/4 Sec. and Sec. No.)

24N
(Twp.)

4W
(Range)

N.M.P.M.
(Meridian)

Wildcat
(Field)

Rio Arriba
(County or Subdivision)

New Mexico
(State or Territory)

The elevation of the derrick floor above sea level is **6783** ft.

DETAILS OF WORK

(State names of and expected depths to objective sands; show sizes, weights, and lengths of proposed casings; indicate mudding jobs, cementing points, and all other important proposed work)

Pictured Cliffs Sand test. Estimated total depth 3100'.

Surface Casing: 90' of 8-5/8" OD 24# J-55 cemented to surface.
Production " : Approximately 3100' of 5-1/2" OD 15.5# J-55 cemented with 150 sacks.

If commercial production is indicated, 5-1/2" casing will be perforated and the producing section sandfrased.

I understand that this plan of work must receive approval in writing by the Geological Survey before operations may be commenced.

Company **EL PASO NATURAL GAS COMPANY**

Address **Box 997**

Farmington, New Mexico

By

Title **Senior Petroleum Engineer**

NEW MEXICO
OIL CONSERVATION COMMISSION

Form C-128

WELL LOCATION AND/OR GAS PRORATION PLAT

DATE 3-27-57

OPERATOR EL PASO NATURAL GAS COMPANY LEASE EL PASO JICARILLA

WELL NO. 2 - H SECTION 5 TOWNSHIP 24 NORTH RANGE 4 WEST NMPM

LOCATED 990 FEET FROM the NORTH LINE 1600 FEET FROM the WEST LINE

RIO ARriba COUNTY, NEW MEXICO G.L. ELEVATION 6775.4 UNCORRECTED

NAME OF PRODUCING FORMATION Fishbed POOL Wildcat DEDICATED ACREAGE 160

Note: All distances must be from outer boundaries of section.

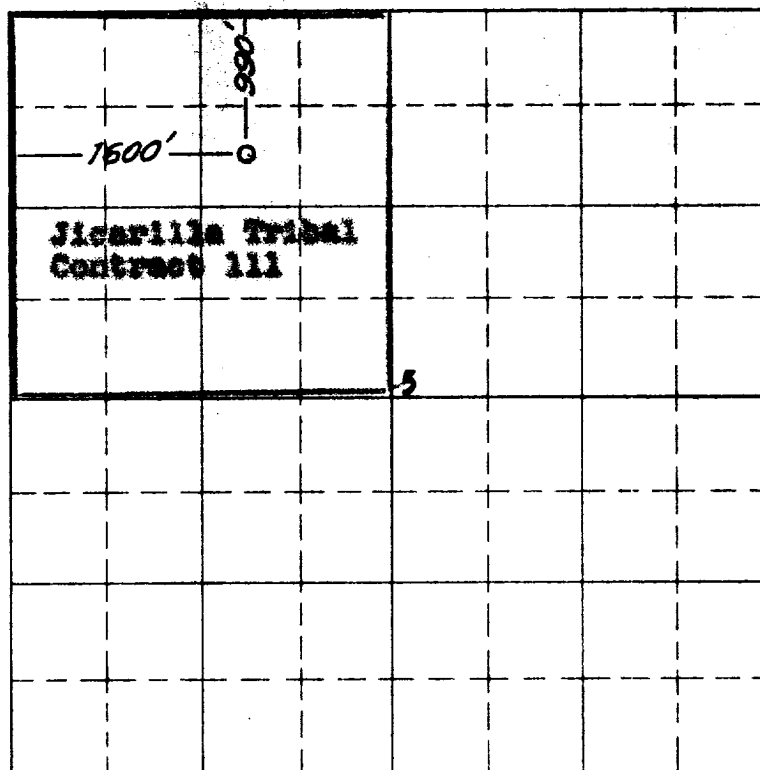

Scale 4 inches equal 1 mile

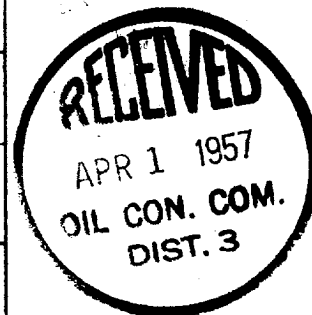

NOTE

This section of form is to be used for gas wells only

This is to certify that the above plat was prepared from field notes of actual surveys made by me or under my supervision and that the same are true and correct to the best of my knowledge and belief.

Date Surveyed 26 MARCH 1957

James P. Leese
Registered Professional Engineer and or Land Surveyor
JAMES P. LEESE
N. MEX. REG. No. 1463

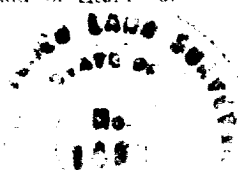

1. Is this well a Dual Comp. Yes _____ No X

2. If the answer to Question 1 is yes, are there any other dually completed wells within the dedicated acreage.

Yes _____ No _____

Name E. J. Paul
Position Senior Petroleum Engineer

El Paso Natural Gas Company
Box 997,
Farmington, New Mexico