

(SUBMIT IN TRIPLICATE)

UNITED STATES
DEPARTMENT OF THE INTERIOR
GEOLOGICAL SURVEY

Land Office Santa Fe
Lease No. SM 04835
Unit Mexico Fed "N"

SUNDRY NOTICES AND REPORTS ON WELLS

NOTICE OF INTENTION TO DRILL	<input checked="" type="checkbox"/>	SUBSEQUENT REPORT OF WATER SHUT-OFF	
NOTICE OF INTENTION TO CHANGE PLANS		SUBSEQUENT REPORT OF SHOOTING OR ACIDIZING	
NOTICE OF INTENTION TO TEST WATER SHUT-OFF		SUBSEQUENT REPORT OF ALTERING CASING	
NOTICE OF INTENTION TO RE-DRILL OR REPAIR WELL		SUBSEQUENT REPORT OF RE-DRILLING OR REPAIR	
NOTICE OF INTENTION TO SHOOT OR ACIDIZE		SUBSEQUENT REPORT OF ABANDONMENT	
NOTICE OF INTENTION TO PULL OR ALTER CASING		SUPPLEMENTARY WELL HISTORY	
NOTICE OF INTENTION TO ABANDON WELL			

(INDICATE ABOVE BY CHECK MARK NATURE OF REPORT, NOTICE, OR OTHER DATA)

June 25, 1960

Mexico Fed "N"

Well No. 1 is located 790 ft. from N line and 790 ft. from W line of sec. 34
N 1/4 Section 34 29N 3E 107W
(1/4 Sec. and Sec. No.) (Twp.) (Range) (Meridian)
South Blanco - Ext. P.C. Rio Arriba County New Mexico
(Field) (County or Subdivision) (State or Territory)

The elevation of the derrick floor above sea level is _____ ft.

DETAILS OF WORK

(State names of and expected depths to objective sands; show sizes, weights, and lengths of proposed casings; indicate mudding jobs, cementing points, and all other important proposed work)

It is our intention to drill well No. 1 to around 3650' to test the Pictured Cliffs formation. Our casing program is as follows:

120' of 9-5/8" OD casing, cemented with 120 sacks regular cement. Cement to be circulated to surface.

3650' of 2-7/8" OD tubing 6.5#, EUE, J-55, cemented with 150 sacks cement.

The designated drilling unit is the N 1/4 of Section 34-29N-3E, Rio Arriba County, New Mexico.

I understand that this plan of work must receive approval in writing by the Geological Survey before operations may be commenced.

Company Shelly Oil Company

Address Drawer 510

Farmington, New Mexico

By (Signed) P. E. Cosper

Title District Superintendent.

FORM C-128
Revised 5/1/57

SECTION A

Ref: GLO plat dated 18 December 1917

1. Is the Operator the only owner in the dedicated acreage outlined on the plat below? YES ☒ NO ☐. ("Owner" means the person who has the right to drill into and to produce from any pool and to appropriate the production either for himself or for himself and another. (65-3-29 (e) NMSA 1935 Comp.)

2. If the answer to question one is "no," have the interests of all the owners been consolidated by communication agreement or otherwise? YES ☐ NO ☐. If answer is "yes," Type of Consolidation _____

3. If the answer to question two is "no," list all the owners and their respective interests below:

RECEIVED

Owner	Land Description
	<div data-bbox="1086 759 1385 778"> RECEIVED JUN 29 1960 FBI - OMAHA </div>

CERTIFICATION

I hereby certify that the information in SECTION A above is true and complete to the best of my knowledge and belief.

Name
(Signed) P. E. Cosper

Position	District Supt.
----------	----------------

Company
Skelly Oil Company

Date **25 June 1960**

I hereby certify that the well location shown on the plat in SECTION B was plotted from field notes of actual surveys made by me or under my supervision, and that the same is true and correct to the best of my knowledge and belief.

Date Surveyed
24 June 1960
Registered Professional Engineer
and/or Land Surveyor

James P. Leese

Certificate No. 1463

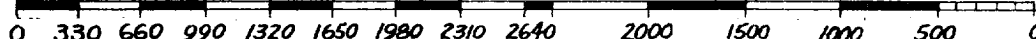
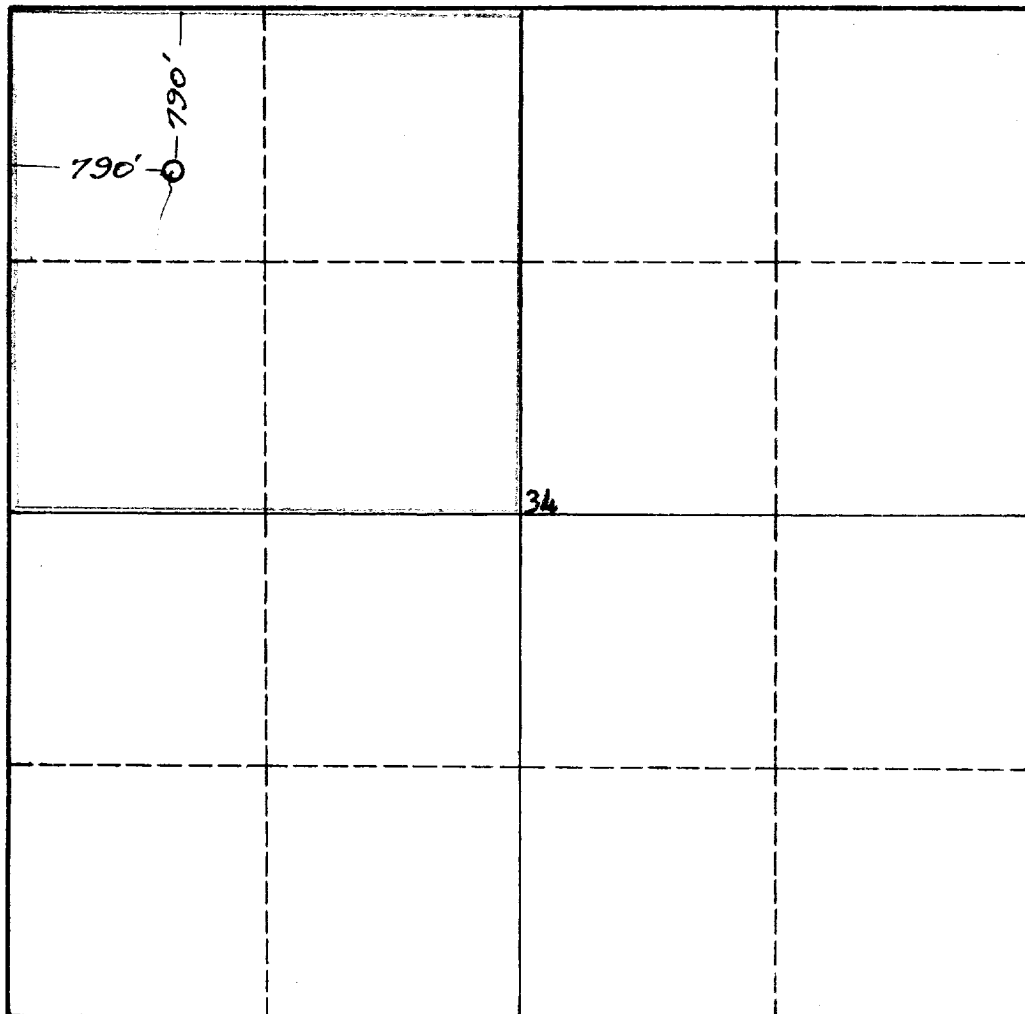

INSTRUCTIONS FOR COMPLETION OF FORM C-128

1. Operator shall furnish and certify to the information called for in Section A.
2. Operator shall outline the dedicated acreage for *both* oil and gas wells on the plat in Section B.
3. A registered professional engineer or land surveyor registered in the State of New Mexico or approved by the Commission shall show on the plat the location of the well and certify this information in the space provided.
4. All distances shown on the plat must be from the outer boundaries of the Section.
5. If additional space is needed for listing owners and their respective interests as required in question 3 of Section A, please use space below.