

Form 9-331b
(April 1962)

(SUBMIT IN TRIPLICATE)

UNITED STATES
DEPARTMENT OF THE INTERIOR
GEOLOGICAL SURVEY

Indian Agency _____
Navajo Indian
Allottee **Navajo**
Lease No. **Contract 734**
Tract 779

SUNDRY NOTICES AND REPORTS ON WELLS

NOTICE OF INTENTION TO DRILL	<input checked="" type="checkbox"/>	SUBSEQUENT REPORT OF WATER SHUT-OFF	
NOTICE OF INTENTION TO CHANGE PLANS		SUBSEQUENT REPORT OF SHOOTING OR ACIDIZING	
NOTICE OF INTENTION TO TEST WATER SHUT-OFF		SUBSEQUENT REPORT OF ALTERING CASING	
NOTICE OF INTENTION TO REDRILL OR REPAIR WELL		SUBSEQUENT REPORT OF REDRILLING OR REPAIR	
NOTICE OF INTENTION TO SHOOT OR ACIDIZE		SUBSEQUENT REPORT OF ABANDONMENT	
NOTICE OF INTENTION TO PULL OR ALTER CASING		SUPPLEMENTARY WELL HISTORY	
NOTICE OF INTENTION TO ABANDON WELL			

(INDICATE ABOVE BY CHECK MARK NATURE OF REPORT, NOTICE, OR OTHER DATA)

May 28, 1957

Well No. **14** is located **890** ft. from **N** line and **990** ft. from **W** line of sec. **24**
NE 1/4 Section 24 (1/4 Sec. and Sec. No.) **35E** (Twp.) **36** (Range) **N.M.P.M.** (Meridian)
Undesignated (Dakota) (Field) **Rio Arriba** (County or Subdivision) **New Mexico** (State or Territory)

The elevation of the derrick floor above sea level is _____ ft.

DETAILS OF WORK

(State names of and expected depths to objective sands; show sizes, weights, and lengths of proposed casings; indicate mud and cementing points, and all other important proposed work)

It is our intention to drill well No. 14 to approximately 7300' to test the Dakota formation. Our casing program is as follows:

350' of 10-3/4" OD 32.75# 28 E-40 casing - cemented with 200 lbs. reg. cement - circulated.

7300' of 5-1/2" OD 13.5# 28 J-55 casing - cemented with 400 lbs. reg. cement.

The designated drilling unit is the NE 1/4 of Section 24, 35E-36, Rio Arriba County, New Mexico.

I understand that this plan of work must receive approval in writing by the Geological Survey before operations may be commenced.

Company **SKELLY OIL COMPANY**

Box 426

Address **Farmington, New Mexico**

By (Signed) **P. E. Cosper**

Title **District Superintendent**

NEW MEXICO OIL CONSERVATION COMMISSION
Well Location and Acreage Dedication Plat

Section A.

Date May 22, 1957

Operator SKELLY OIL COMPANY Lease JICARILLA "C"
Well No. 16 Unit Letter Section 34 Township 25 NORTH Range 5 WEST NMPN
Located 890 Feet From the NORTH Line, 990 Feet From the WEST Line
County PIO JUAN G. L. Elevation Dedicated Acreage 300 Acres
Name of Producing Formation Del Norte Pool Undesignated

1. Is the Operator the only owner* in the dedicated acreage outlined on the plat below?
Yes X No .
2. If the answer to question one is "no," have the interests of all the owners been consolidated by communitization agreement or otherwise? Yes No . If answer is "yes," Type of Consolidation
3. If the answer to question two is "no," list all the owners and their respective interests below:

<u>Owner</u>	<u>Land Description</u>

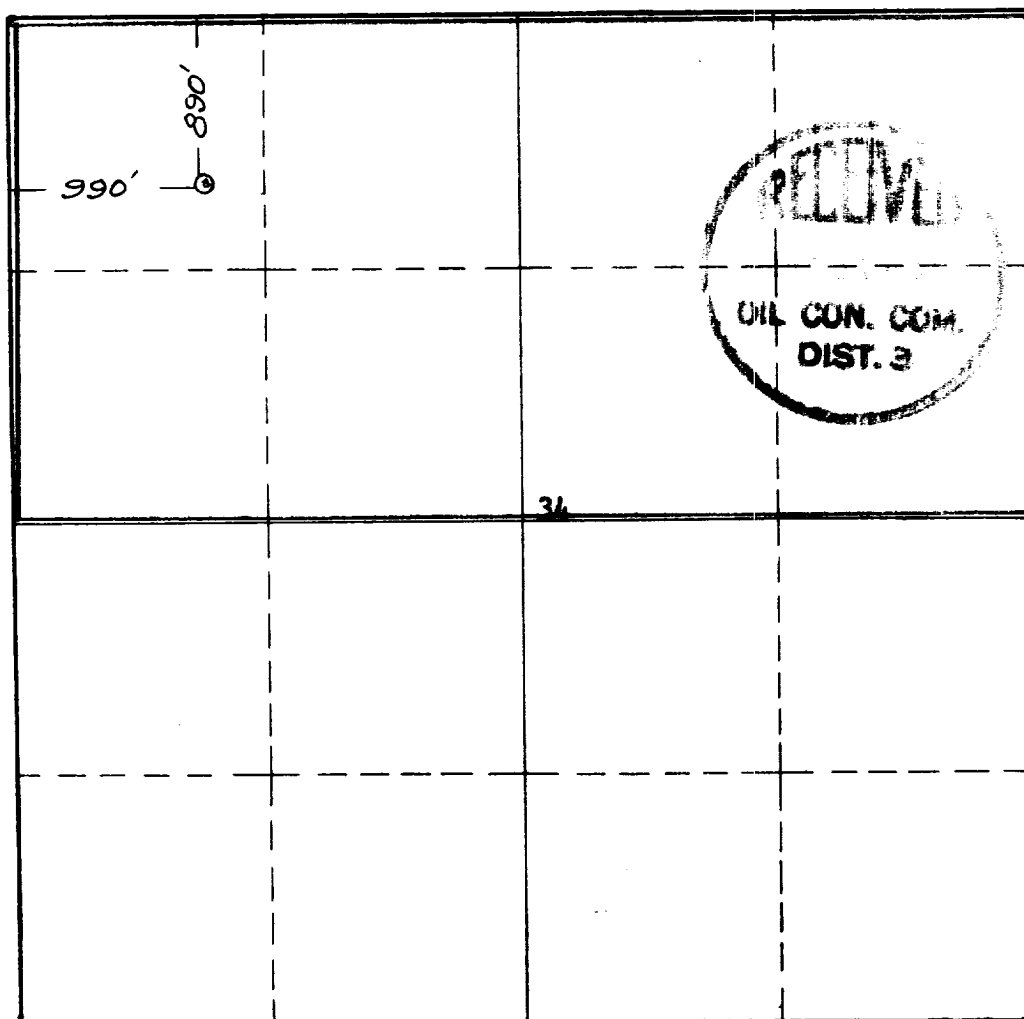

This is to certify that the information in Section A above is true and complete to the best of my knowledge and belief.

Skelly Oil Company
(Operator)

(Signed) P. E. Cosper
(Representative)

Box 424, Farmington, New Mexico
Address

This is to certify that the well location shown on the plat in Section B was plotted from field notes of actual surveys made by me or under my supervision and that the same is true and correct to the best of my knowledge and belief.

Date Surveyed 25 May 1957

James F. Leese
Registered Professional
Engineer and/or Land Surveyor.

James F. Leese
Certificate No. 1463

INSTRUCTIONS FOR COMPLETION:

1. Operator shall furnish and certify to the information called for in Section A.
2. Operator shall outline the dedicated acreage for both oil and gas wells on the plat in Section B.
3. A registered professional engineer or land surveyor registered in the State of New Mexico or approved by the Commission shall show on the plat the location of the well and certify this information in the space provided.
4. All distances shown on the plat must be from the outer boundaries of Section.
5. If additional space is needed for listing owners and their respective interests as required in question 3, Section A, please use space below

* "Owner" means the person who has the right to drill into and to produce from any pool and to appropriate the production either for himself or for himself and another. (65-3-29 (e) NMSA 1953 Comp.)