

15K-131EX

Denny E. Faust
DEPUTY OIL & GAS INSPECTOR
FEB 08 1998

JICARILLA APACHE TRIBE
ENVIRONMENTAL PROTECTION OFFICE
P.O. BOX 507
DULCE, NEW MEXICO 87528

SUBMIT 1 COPY TO
NATURAL
RESOURCE DEPT
AND OIL-GAS
ADMINISTRATION

Approved

PIT REMEDIATION AND CLOSURE REPORT

Operator: PNM Gas Services (<u>Conoco</u>)		Telephone: <u>324-3764</u>	
Address: <u>603 W. Elm Street Farmington, NM 87401</u>			
Facility or Well Name: <u>Axi Apache J-12</u>			
Location:	Unit: <u>K</u>	Sec. <u>5</u>	T. <u>25N</u> R. <u>5 W</u> County <u>Rio Arriba</u>
Pit Type:	Separator <input checked="" type="checkbox"/>	Dehydrator <input type="checkbox"/>	Other <input type="checkbox"/>
Land Type:	<u>Jicarilla Apache</u>		

Pit Location:	Pit dimensions:	length <u>20'</u>	width <u>20'</u>	depth <u>1'</u>
(Attach diagram)	Reference:	wellhead <input checked="" type="checkbox"/>	other <input type="checkbox"/>	
	Footage from reference:	<u>81'</u>		
	Direction from reference:	<u>45</u> Degrees <input checked="" type="checkbox"/> East	North <input checked="" type="checkbox"/>	
		West	of South	

Depth to Ground Water: <small>(Vertical distance from contaminants to seasonal high water elevation of ground water)</small>	Less than 50 feet	(20 points)	<u>0</u>
	50 feet to 99 feet	(10 points)	
	Greater than 100 feet	(0 points)	
Wellhead Protection Area: <small>(Less than 200 feet from a private domestic water source, or; less than 1,000 feet from all other water sources)</small>	Yes	(20 points)	<u>0</u>
	No	(0 points)	
Distance to Surface Water: <small>(Horizontal distance to perennial lakes, ponds, rivers, streams, creeks, irrigation canals and ditches)</small>	Less than 200 feet	(20 points)	<u>0</u>
	200 feet to 1,000 feet	(10 points)	
	Greater than 1,000 feet	(0 points)	
Distance to Ephemeral Stream (dry wash): <small>(Horizontal distance to all downgradient streams having a width of at least 10 feet)</small>	Less than or equal to 100 feet	(10 points)	<u>0</u>
	Greater than 100 feet	(0 points)	
Distance to Nearest Lake, Playa, or Watering Pond: <small>(Horizontal distance to all downgradient lakes, playas, and livestock or wildlife water ponds)</small>	Less than or equal to 100 feet	(10 points)	<u>0</u>
	Greater than 100 feet	(0 points)	
RANKING SCORE (TOTAL POINTS):			<u>0</u>

RECEIVED
FEB - 1 1998
OIL CON. DIV.
DIST. 3

Date Remediation Started:

7/29/98

Date Completed:

9/9/98

Remediation Method:

Excavation

X

Approx. Cubic Yards

287(Check all
appropriate
sections)

Landfarmed

X

Amount Landfarmed (cubic yds):

287

Other _____

Remediation Location:

Onsite

X

Offsite _____

(i.e., landfarmed onsite, name
and location of offsite facility)

General Description of Remedial Action:

Removed contaminated soil from all four side walls
as to get a below 100 ppm headspace reading. Pit
bottom is sandstone rock 3 PT Composite of Pit bottom
EXCAVATION SIZE 3'X25'X10'

Ground Water Encountered:

No

X

Yes _____

Depth _____

Final Pit Closure
Sampling:

Sample Location

North, East, South, West Side
Walls and Pit bottom(if multiple samples, attach
sample result and diagram of
sample locations and
depths.)

Sample depth

9' (max) 10' RAD

Sample date

7/21/98

Sample time

1046

Sample Results

Soil: Benzene (ppm)

ND

Water: Benzene (ppb)

Total BTEX (ppm)

62.500

Toluene (ppb)

Field headspace (ppm)

1146

Ethylbenzene (ppb)

TPH 92 ppm

Method

8015

Total Xylenes (ppb)

Ground Water Sample:

Yes _____

No

X

(If yes, attach sample results)

I HEREBY CERTIFY THAT THE INFORMATION ABOVE IS TRUE AND COMPLETE TO THE BEST OF MY
KNOWLEDGE AND MY BELIEF

DATE

8/2/98

PRINTED NAME

Roy Burnham

SIGNATURE

Roy Burnham

AND TITLE

Environmental Technician IIAFTER REVIEW OF THE PIT CLOSURE INFORMATION, PIT CLOSURE IS APPROVED IN ACCORDANCE
TO JICARILLA APACHE TRIBE PIT CLOSURE ORDINANCE.

APPROVED: YES

X

NO _____

(REASON):

R.A. Attached

SIGNED:

K. C. Man

DATE:

8-18-98

H41 HPACHE J-12
Sec-5 T-25N R-5W unit K
Conoco

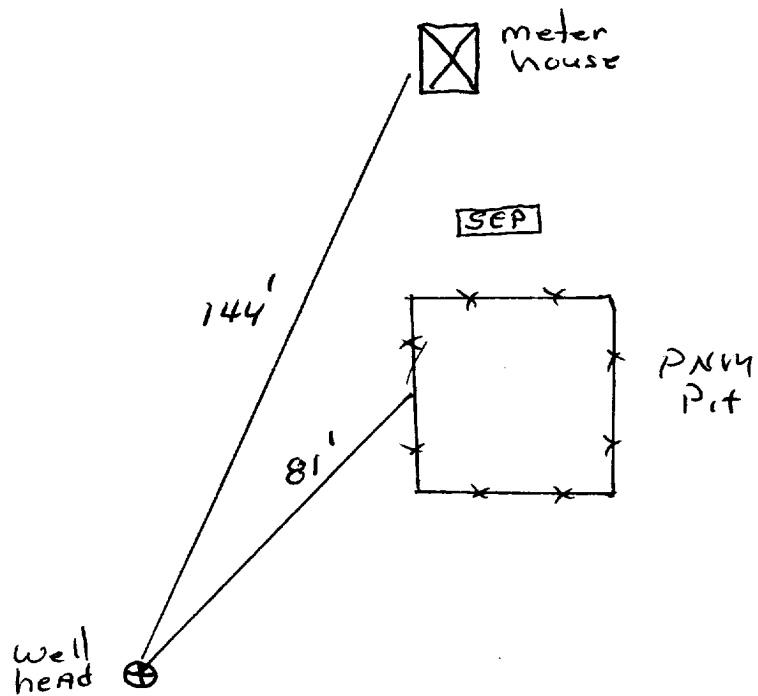

Ax1 Hpatche J-12
Sec-5 T-25N R-5W unit K
Conoco

EXCAVATION DRAWING

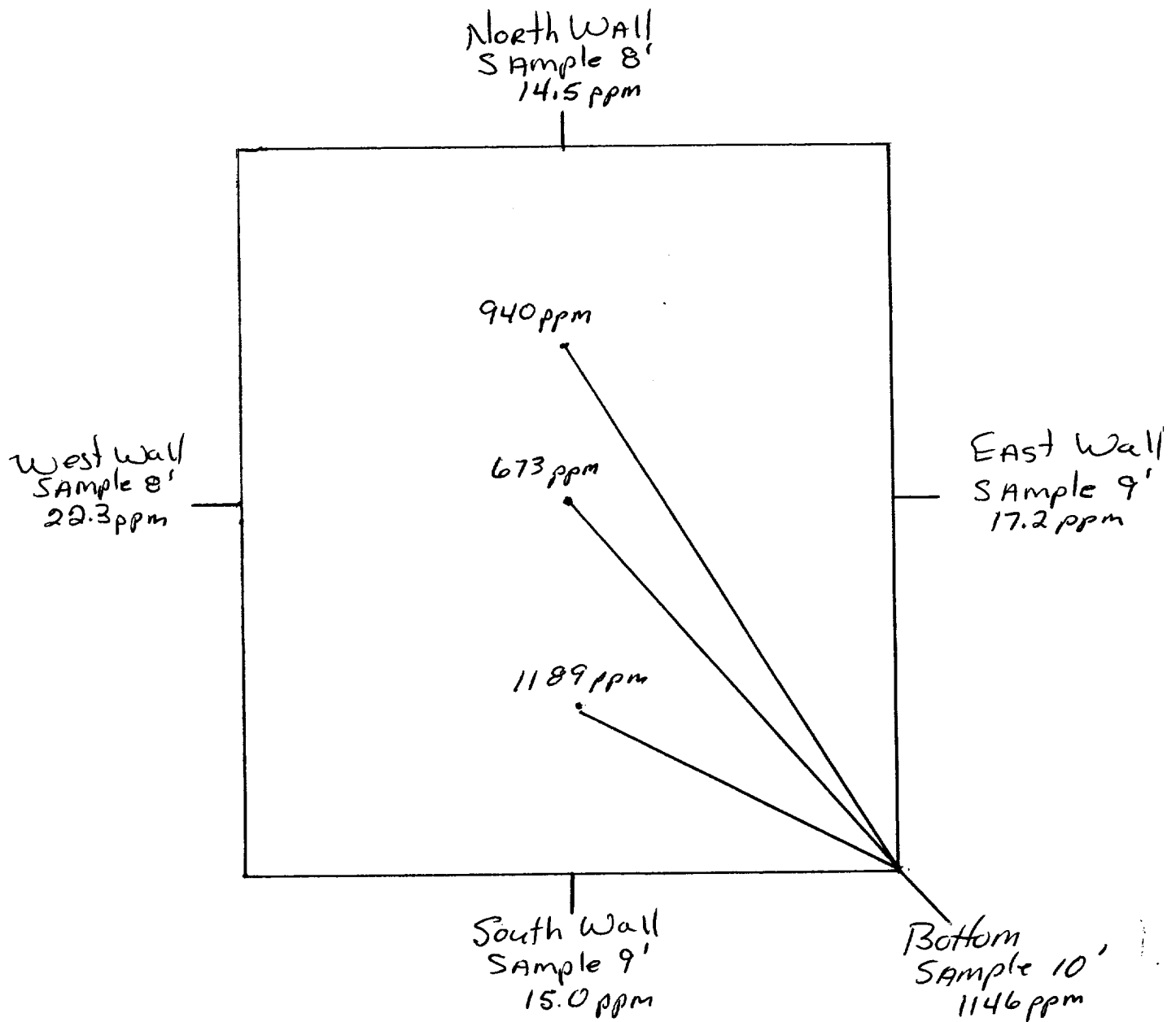

OFF: (505) 325-5667



LAB: (505) 325-1556

On Site Technologies, LTD.

Date: 30-Jul-98

CLIENT: PNM - Public Service Company of NM
Project: PNM Pit Remediation
Lab Order: 9807066

CASE NARRATIVE

Samples were analyzed using the methods outlined in the following references:

Test Methods for Evaluating Solid Waste, Physical/Chemical Methods, SW846, 3rd Edition

All method blanks, laboratory spikes, and/or matrix spikes met quality assurance objectives.

OFF: (505) 325-5667



LAB: (505) 325-1556

ANALYTICAL REPORT

Date: 30-Jul-98

Client:	PNM - Public Service Company of NM	Client Sample Info:	Axi Apache J-12
Work Order:	9807066	Client Sample ID:	9807211046; 3pt. Comp. Bottom
Lab ID:	9807066-02A	Matrix:	SOIL
Project:	PNM Pit Remediation	Collection Date:	7/21/98 10:46:00 AM
		COC Record:	7068

Parameter	Result	PQL	Qual	Units	DF	Date Analyzed
DIESEL RANGE ORGANICS		SW8015				Analyst: HR
T/R Hydrocarbons: C10-C28	92	25		mg/Kg	1	7/29/98
BTEX		SW8020A				Analyst: DC
Benzene	ND	250		µg/Kg	250	7/27/98
Toluene	6500	500		µg/Kg	250	7/27/98
Ethylbenzene	7800	250		µg/Kg	250	7/27/98
m,p-Xylene	39000	500		µg/Kg	250	7/27/98
o-Xylene	9200	250		µg/Kg	250	7/27/98

62500
62,500 ppm

Qualifiers:	PQL - Practical Quantitation Limit	S - Spike Recovery outside accepted recovery limits
	ND - Not Detected at Practical Quantitation Limit	R - RPD outside accepted recovery limits
	J - Analyte detected below Practical Quantitation Limit	E - Value above quantitation range
	B - Analyte detected in the associated Method Blank	Surr: - Surrogate

P.O. BOX 2606 • FARMINGTON, NM 87499

1 of 1

OFF: (505) 325-5667



LAB: (505) 325-1556

ANALYTICAL REPORT

Date: 30-Jul-98

Client:	PNM - Public Service Company of NM	Client Sample Info:	Axi Apache J-12
Work Order:	9807066	Client Sample ID:	9807211045; 4pt. Comp. Walls
Lab ID:	9807066-01A	Matrix:	SOIL
Project:	PNM Pit Remediation	Collection Date:	7/21/98 10:45:00 AM
		COC Record:	7068

Parameter	Result	PQL	Qual	Units	DF	Date Analyzed
DIESEL RANGE ORGANICS		SW8015				Analyst: HR
T/R Hydrocarbons: C10-C28	ND	25		mg/Kg	1	7/28/98

Qualifiers:

PQL - Practical Quantitation Limit

ND - Not Detected at Practical Quantitation Limit

J - Analyte detected below Practical Quantitation Limit

B - Analyte detected in the associated Method Blank

S - Spike Recovery outside accepted recovery limits

R - RPD outside accepted recovery limits

E - Value above quantitation range

Surr: - Surrogate

1 of 1

P.O. BOX 2606 • FARMINGTON, NM 87499



Environmental Services

Well Name:	Axi Apache J #12
Well Legals:	Unit K, Sec 5, T25N, R5W
Pit Type:	Separator
Horizontal Distance to Surface Water:	Greater than 1,000 feet
Groundwater Depth:	Greater than 100 feet

RISK ANALYSIS

PNM requests closure of their former pit on the Axi Apache J #12 well site using a limited risk analysis based on the following conditions:

1. Groundwater is estimated to be at a depth of 183 feet based upon the elevation of the site and the elevation of the nearest "listed" or "named" wash (Gonzales Canyon). (Reference: Gonzales Mesa, NM series 7.5 minute topographic map.)
2. The site is located outside of the "vulnerable area" as defined under OCC Order No. R-7940-C.
3. PNM excavated 287 cubic yards of soil from the former pit. Subsurface lateral contamination has been remediated (see attached map and analytical results for the side wall profiles). Source removal minimizes the possibility of surface water contamination.
4. Sandstone was encountered at 10 feet below ground surface. Bedrock/sandstone provides a barrier between remaining contamination and groundwater. Vertical migration through bedrock or sandstone to groundwater is unlikely.
5. PNM excavated and performed remediation to the maximum depth and horizontal extent practicable.

PNM believes their former pit on the Axi Apache J #12 well site poses minimal threat to groundwater, human health and the environment based upon our past experience in excavating over 800 pits.

JICARILLA APACHE TRIBE
ENVIRONMENTAL
PROTECTION OFFICE
P.O. BOX 507
DULCE, NEW MEXICO 87528

SUBMIT 1 COPY TO
NATURAL
RESOURCE DEPT
AND OIL GAS
ADMINISTRATION

ON-SITE SOIL REMEDIATION REPORT

Operator: PNM Gas Services (Conoco) Telephone: 324-3764
Address: 603 W. Elm Street Farmington, NM 87401
Facility or Well Name: Axi Apache J-12
Location: Unit: K Sec. 5 T. 25 N R. 5 W County Rio Arriba
Land Type: Jicarilla Apache

Date Remediation Started: 7/26/98 Date Completed: 8/24/98
Remediation Method: Landfarmed X Approx. cubic yards 287
Composted —
Other —

Depth to Ground Water: (pts.) Ø
Distance to an Ephemeral Stream: (pts.) Ø
Distance to Nearest Lake, Playa,
or Watering Pond: (pts.) Ø
Wellhead Protection Area: (pts.) Ø
Distance to Surface Water: (pts.) Ø
Ranking Score (Total Points): Ø

Final Closure Sampling:

Sampling Date: 8/18/98 Time 0815
Sampling Results:
Field Headspace (ppm) 3.4
TPH (ppm) N/D Method 8015
Other —

I HEREBY CERTIFY THAT THE INFORMATION ABOVE IS TRUE AND COMPLETE TO THE BEST OF MY KNOWLEDGE AND BELIEF

DATE 8/29/98 PRINTED NAME Roy Burnham
SIGNATURE Roy Burnham AND TITLE Environmental Technician II

AFTER REVIEW OF THE SOIL REMEDIATION INFORMATION, ON-SITE REMEDIATION APPROVED IN ACCORDANCE TO THE
JICARILLA APACHE TRIBE PIT CLOSURE ORDINANCE

APPROVED: YES X NO — (REASON) use as Backfill
SIGNED: Karl M... DATE: 9-9-98

Aki Apache J12
CONOCO
() 5-25N-5W

N

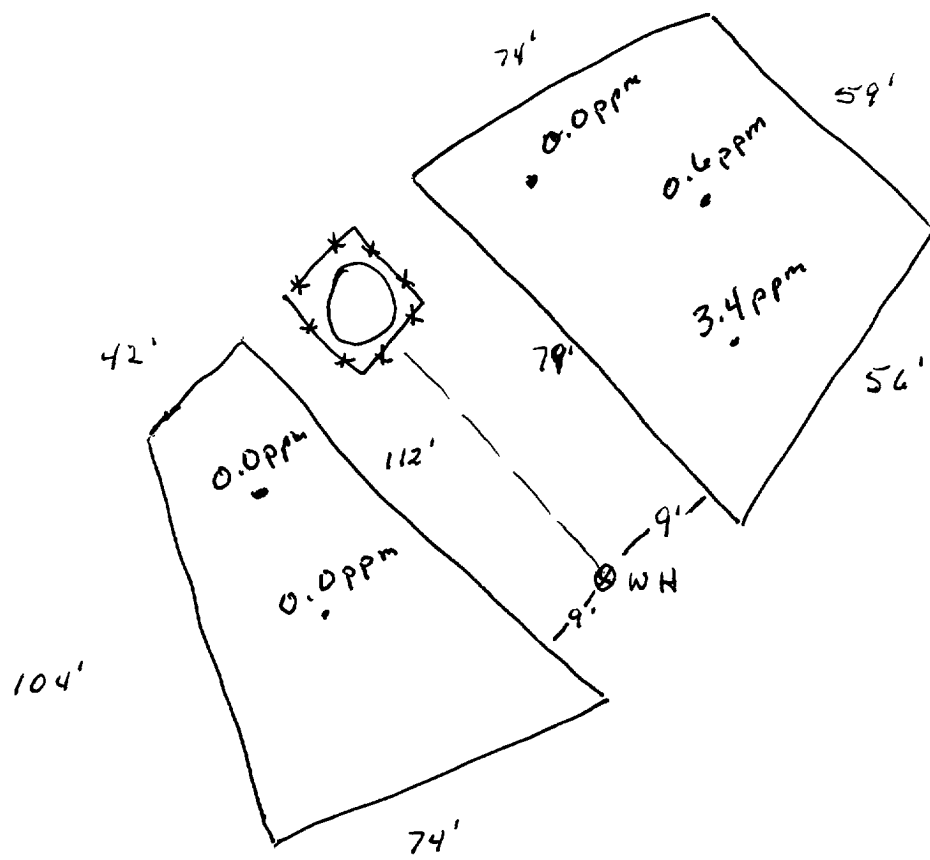

not to scale

OFF: (505) 325-5667



LAB: (505) 325-1556

On Site Technologies, LTD.

Date: 26-Aug-98

CLIENT: PNM - Public Service Company of NM

Project: PNM Pit Remediation

Lab Order: 9808037

CASE NARRATIVE

Samples were analyzed using the methods outlined in the following references:

Test Methods for Evaluating Solid Waste, Physical/Chemical Methods, SW846, 3rd Edition

All method blanks, laboratory spikes, and/or matrix spikes met quality assurance objectives.

OFF: (505) 325-5667



LAB: (505) 325-1556

ANALYTICAL REPORT

Date: 26-Aug-98

Client:	PNM - Public Service Company of NM	Client Sample Info:	Axi Apache J-12 LF
Work Order:	9808037	Client Sample ID:	9808180815; 5pt. Comp
Lab ID:	9808037-05A	Matrix:	SOIL
Project:	PNM Pit Remediation	Collection Date:	8/18/98 8:15:00 AM
		COC Record:	7336

Parameter	Result	PQL	Qual	Units	DF	Date Analyzed
DIESEL RANGE ORGANICS		SW8015				Analyst: HR
T/R Hydrocarbons: C10-C28	ND	25		mg/Kg	1	8/24/98

Qualifiers:

- PQL - Practical Quantitation Limit
- ND - Not Detected at Practical Quantitation Limit
- J - Analyte detected below Practical Quantitation Limit
- B - Analyte detected in the associated Method Blank

- S - Spike Recovery outside accepted recovery limits
- R - RPD outside accepted recovery limits
- E - Value above quantitation range
- Surr: - Surrogate

1 of 1

P.O. BOX 2606 • FARMINGTON, NM 87499

- TECHNOLOGY BLENDING INDUSTRY WITH THE ENVIRONMENT -