

UNITED STATES
DEPARTMENT OF THE INTERIOR
GEOLOGICAL SURVEY

30-039-20920

5. LEASE DESIGNATION AND SERIAL NO.
SF 078909
6. IF INDIAN, ALLOTTEE OR TRIBE NAME
7. UNIT AGREEMENT NAME
Lindrith Unit
8. FARM OR LEASE NAME
Lindrith Unit
9. WELL NO.
58
10. FIELD AND POOL, OR WILDCAT
So. Blanco Pictured Cliffs
11. SEC., T., R., M., OR BLK. AND SURVEY OR AREA
Sec. 20, T-24-N, R-2-W NMPM
12. COUNTY OR PARISH
Rio Arriba
13. STATE
NM

APPLICATION FOR PERMIT TO DRILL, DEEPEN, OR PLUG BACK

1a. TYPE OF WORK
DRILL ☒ DEEPEN ☐ PLUG BACK ☐
b. TYPE OF WELL
OIL WELL ☐ GAS WELL ☒ OTHER ☐ SINGLE ZONE ☒ MULTIPLE ZONE ☐

2. NAME OF OPERATOR
El Paso Natural Gas Company

3. ADDRESS OF OPERATOR
PO Box 990, Farmington, NM 87401

4. LOCATION OF WELL (Report location clearly and in accordance with any State requirements.)*
At surface 1150'S, 990'W
At proposed prod. zone

14. DISTANCE IN MILES AND DIRECTION FROM NEAREST TOWN OR POST OFFICE*

15. DISTANCE FROM PROPOSED* LOCATION TO NEAREST PROPERTY OR LEASE LINE, FT. (Also to nearest drlg. unit line, if any)
16. NO. OF ACRES IN LEASE
17. NO. OF ACRES ASSIGNED TO THIS WELL
18. DISTANCE FROM PROPOSED LOCATION* TO NEAREST WELL, DRILLING, COMPLETED, OR APPLIED FOR, ON THIS LEASE, FT.
19. PROPOSED DEPTH
3160'
20. ROTARY OR CABLE TOOLS
Rotary
21. ELEVATIONS (Show whether DF, RT, GR, etc.)
7095'GL
22. APPROX. DATE WORK WILL START*

23. PROPOSED CASING AND CEMENTING PROGRAM

SIZE OF HOLE	SIZE OF CASING	WEIGHT PER FOOT	SETTING DEPTH	QUANTITY OF CEMENT
12 1/4"	8 5/8"	24.0#	120	106 cu. ft. to circulate
6 3/4"	2 7/8"	6.4#	3160'	150 cu. ft. to cover Ojo Alamo

Selectively perforate and sandwater fracture the Pictured Cliffs formation.

The SW/4 of Section 20 is dedicated to this well.



IN ABOVE SPACE DESCRIBE PROPOSED PROGRAM: If proposal is to deepen or plug back, give data on present productive zone and proposed new productive zone. If proposal is to drill or deepen directionally, give pertinent data on subsurface locations and measured and true vertical depths. Give blowout preventer program, if any.

24. SIGNED A. G. Bridges TITLE Drilling Clerk DATE May 31, 1974

(This space for Federal or State office use)

PERMIT NO. _____ APPROVAL DATE _____

APPROVED BY _____ TITLE _____ DATE JUL 8 1974

CONDITIONS OF APPROVAL, IF ANY:
Clay

**NEW MEXICO OIL CONSERVATION COMMISSION
WELL LOCATION AND ACREAGE DEDICATION PLAT**

Form C-102
Supersedes C-128
Effective 1-1-65

All distances must be from the outer boundaries of the Section.

Operator EL PASO NATURAL GAS COMPANY			Lease LINDRITH UNIT (SF-078909)		Well No. 58
Unit Letter M	Section 20	Township 24-N	Range 2-W	County RIO ARriba	
Actual Spotage Location of Well: 1150' feet from the SOUTH line and 990 feet from the WEST line					
Ground Level Elev. 7095	Producing Formation PICTURED CLIFFS	Pool SO. BLANCO PICTURED CLIFFS		Dedicated Acreage: 160.00 Acres	

1. Outline the acreage dedicated to the subject well by colored pencil or hachure marks on the plat below.
2. If more than one lease is dedicated to the well, outline each and identify the ownership thereof (both as to working interest and royalty).
3. If more than one lease of different ownership is dedicated to the well, have the interests of all owners been consolidated by communitization, unitization, force-pooling, etc?

☐ Yes ☐ No If answer is "yes," type of consolidation Unitization

If answer is "no," list the owners and tract descriptions which have actually been consolidated. (Use reverse side of this form if necessary.) _____

No allowable will be assigned to the well until all interests have been consolidated (by communitization, unitization, forced-pooling, or otherwise) or until a non-standard unit, eliminating such interests, has been approved by the Commission.

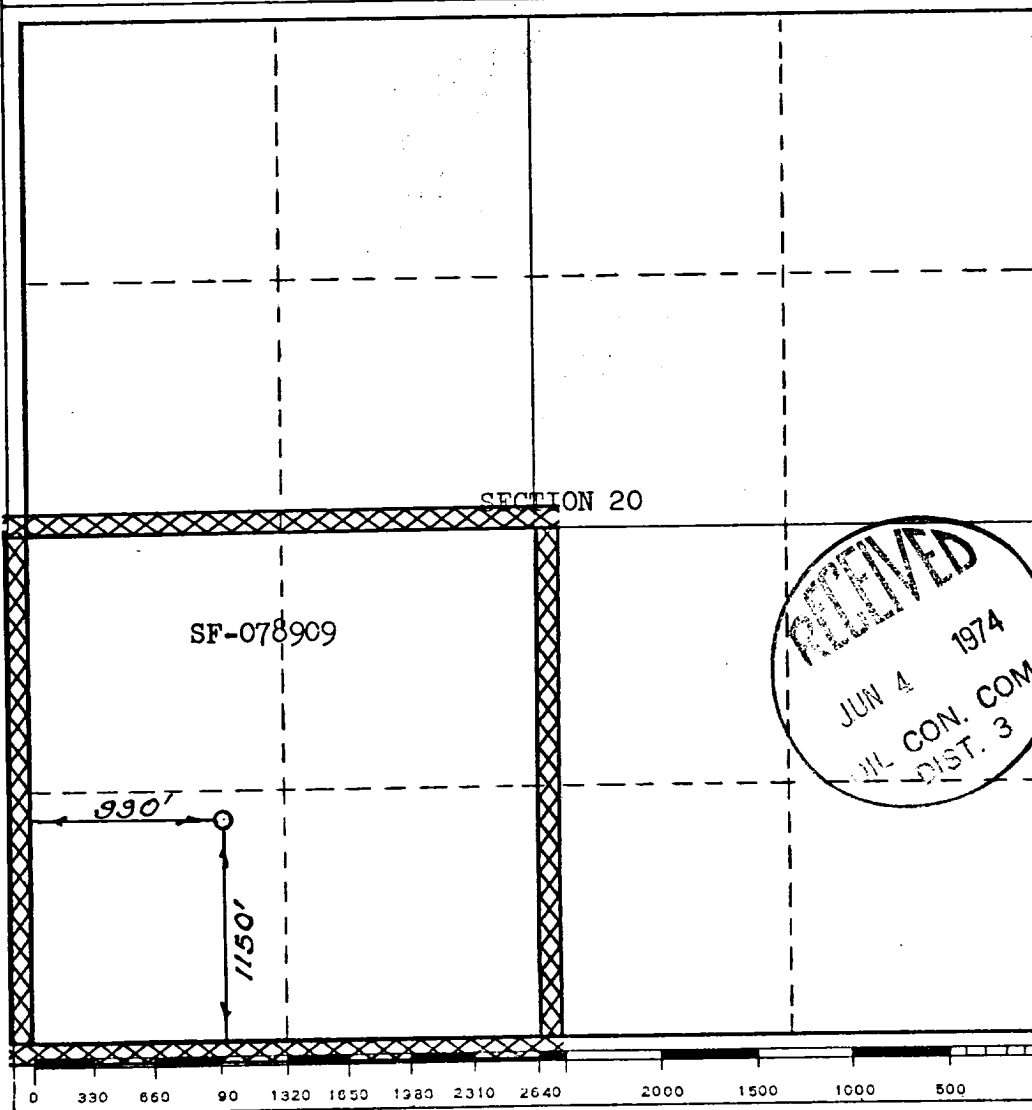

CERTIFICATION

I hereby certify that the information contained herein is true and complete to the best of my knowledge and belief.

Original Signed by

Name **D. G. Brisco**
Position **El Paso Natural Gas Co.**
Company **May 31, 1974**
Date

I hereby certify that the well location shown on this plat was plotted from field notes of actual surveys made by me or under my supervision, and that the same is true and correct to the best of my knowledge and belief.

Date Surveyed
MARCH 31, 1965
Registered Professional Engineer
and/or Land Surveyor

[Signature]
Certificate No. **1760**



Kinditt Unit #58
SWSM/L Sec. 11, T-24-N, R-3-W

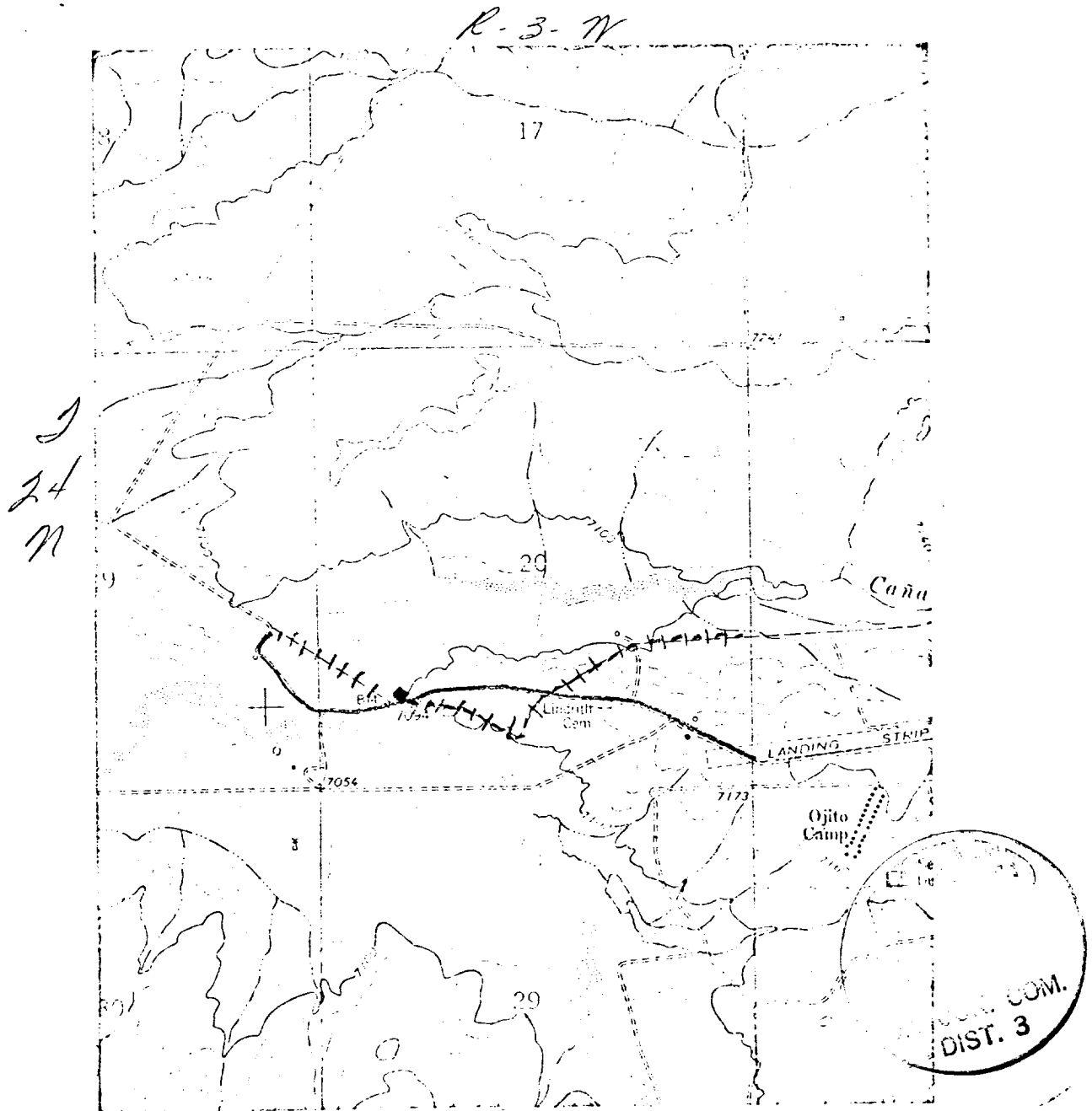

LEGEND OF RIGHT-OF-WAYS

EXISTING ROADS	---
EXISTING PIPELINES	++ ++
EXISTING ROAD & PIPELINE	++ ++
PROPOSED ROADS	---
PROPOSED PIPELINES	++ ++
PROPOSED ROAD & PIPELINE	++ ++