

Robert L. Bayless

PETROLEUM CLUB PLAZA BUILDING

P. O. BOX 1541

FARMINGTON, NEW MEXICO 87401



April 21, 1975

New Mexico Oil Conservation Commission
P.O. Box 2088
Santa Fe, New Mexico 87501

Re: Unorthodox location of our
Canada Mesa #5.

Gentlemen:

Enclosed please find a survey plat showing our proposed location for the above referred to Gallup test well. Along with the plat is a topographic map showing the problems involved in drilling this on our desired site of 990 feet from the north and west lines. However, you will note we have moved the location as described in the survey plat. This is because of the extremely steep rock bluff outcrop on a line to the north and west of the location and in addition there is a rock adobe ranch house ruin which exists next to the 990 location. The archaeologist, on examining the site, estimated that the house was over 50 years old and thus comes under the antiquities act and must not be disturbed.

We are sending a copy of this letter to the other operator who lies within a mile of the location. The acreage holder immediately south of this location is J. Gregory Merrion, et al; we are the operators of the acreage to the north, northwest and west of the location. We would like to commence this well at the earliest possible date; therefore, please advise if we can do anything to expedite your approval of this location.

Yours truly,

MERRION & BAYLESS

By

ROBERT L. BAYLESS

RLB/su

Enclosures

cc NMOCC - Aztec

M & M Production

Lindrith, New Mexico

**NEW MEXICO OIL CONSERVATION COMMISSION
WELL LOCATION AND ACREAGE DEDICATION PLAT**

Form C-102
Supersedes C-128
Effective 1-1-65

All distances must be from the outer boundaries of the Section.

Operator Merrion & Bayless		Lease Canada Mesa		Well No. 5
Unit Letter D	Section 10	Township 24N	Range 6W	County Rio Arriba
Actual Footage Location of Well:				
1070	feet from the North	Line and 950	feet from the West	Line
Ground Level Elev. 6191	Producing Formation Gallup	Pool Devil's Fork	Dedicated Acreage: 80	Acres

1. Outline the acreage dedicated to the subject well by colored pencil or hachure marks on the plat below.
2. If more than one lease is dedicated to the well, outline each and identify the ownership thereof (both as to working interest and royalty).
3. If more than one lease of different ownership is dedicated to the well, have the interest of all owners been consolidated by communitization, unitization, force-pooling, etc?

☐ Yes ☐ No If answer is "yes," type of consolidation _____

If answer is "no," list the owners and tract descriptions which have actually been consolidated. (Use reverse side of this form if necessary.) _____

No allowable will be assigned to the well until all interests have been consolidated (by communitization, unitization, forced-pooling, or otherwise) or until a non-standard unit, eliminating such interests, has been approved by the Commission.

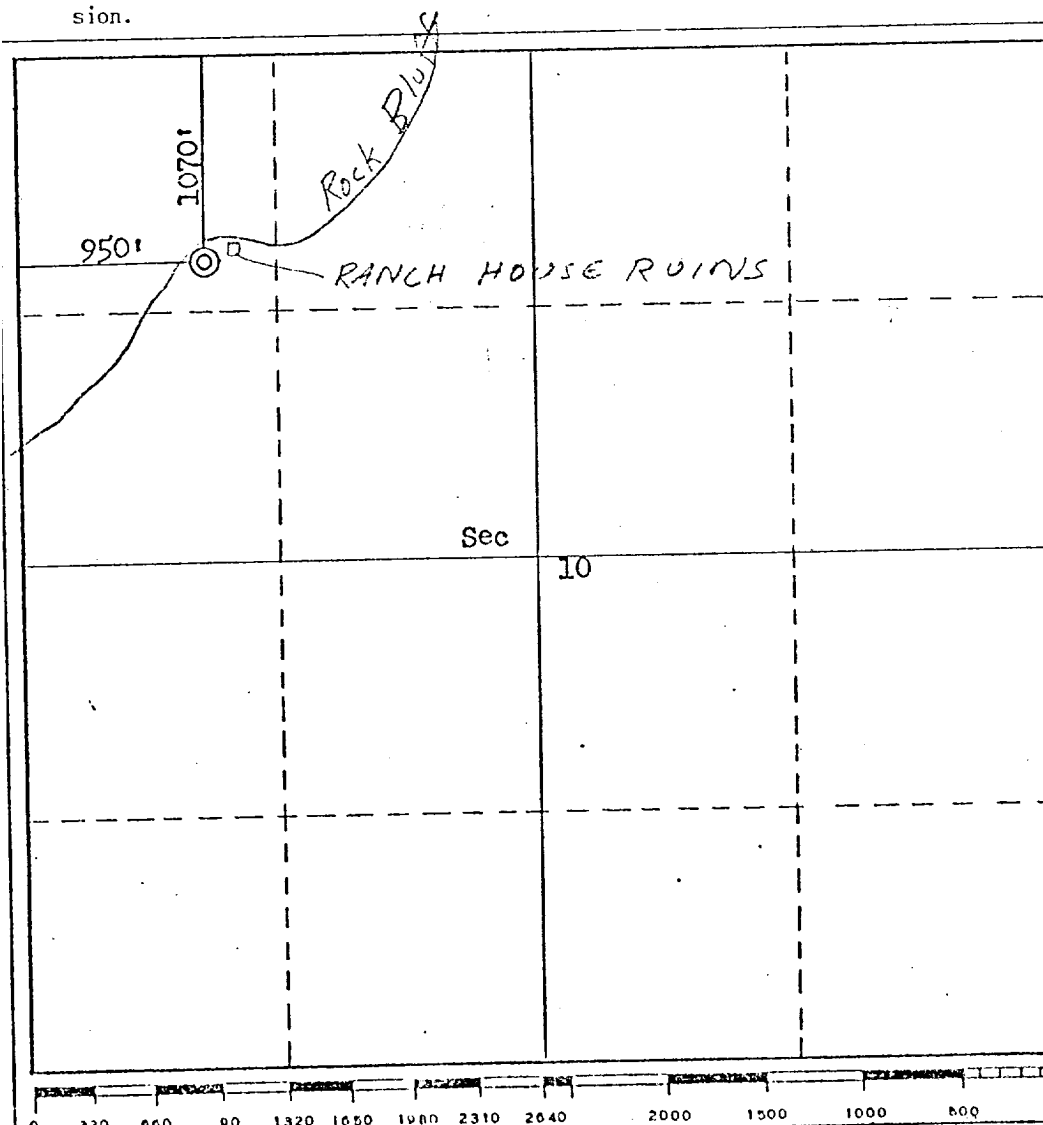
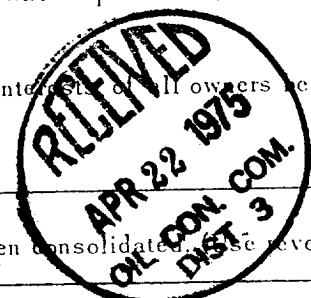

CERTIFICATION	
I hereby certify that the information contained herein is true and complete to the best of my knowledge and belief.	
Name	<i>P. L. Bayless</i>
Position	
Company	Merrion & Bayless
Date	April 21, 1975
I hereby certify that the well location shown on this plat was plotted from field notes of actual surveys made by me or under my supervision, and that the same is true and correct to the best of my knowledge and belief.	
Date Surveyed	April 16, 1975
Registered Professional Engineer and/or Land Surveyor <i>Fred B. Kerr Jr.</i> Fred B. Kerr Jr.	
Certificate No.	3950

