

Robert L. Bayless

PETROLEUM CLUB PLAZA BUILDING

P. O. BOX 1541

FARMINGTON, NEW MEXICO 87401

June 10, 1975

New Mexico Oil Conservation Commission
P.O. Box 2088
Santa Fe, New Mexico 87501

ATTENTION: Mr. James Kapteina

Re: Canada Mesa #5

Gentlemen:

We previously asked and received a non-standard location for this well under your order NSL-712. This was applied for after the archaeologist had approved the location. Now the Bureau of Land Management feels it is too close to the abandoned ranch house ruins so we request the attached location which moves the well approximately 100 feet further away from the ruins.

We hope you will be able to approve this administratively to expedite our drilling program.

Yours truly,

MERRION & BAYLESS

By

ROBERT L. BAYLESS

RLB/su

cc New Mexico Oil Conservation Commission
Aztec, New Mexico



**NEW MEXICO OIL CONSERVATION COMMISSION
WELL LOCATION AND ACREAGE DEDICATION PLAT**

Form C-102
Supersedes C-128
Effective 1-1-65

All distances must be from the outer boundaries of the Section.

Operator Merrion & Bayless			Lease Canada Mesa		Well No. 5
Unit Letter D	Section 10	Township 24N	Range 6W	County Rio Arriba	
Actual Footage Location of Well:					
1185 feet from the North line and		970 feet from the West line			
Ground Level Elev. 6486	Producing Formation Gallup	Pool Devils Fork		Dedicated Acreage: 80	Acres

1. Outline the acreage dedicated to the subject well by colored pencil or hachure marks on the plat below.
2. If more than one lease is dedicated to the well, outline each and identify the ownership thereof (both as to working interest and royalty).
3. If more than one lease of different ownership is dedicated to the well, have the interests of all owners been consolidated by communitization, unitization, force-pooling, etc?

☐ Yes ☐ No If answer is "yes," type of consolidation _____

If answer is "no," list the owners and tract descriptions which have actually been consolidated. (Use reverse side of this form if necessary.) _____

No allowable will be assigned to the well until all interests have been consolidated (by communitization, unitization, forced-pooling, or otherwise) or until a non-standard unit, eliminating such interests, has been approved by the Commission.

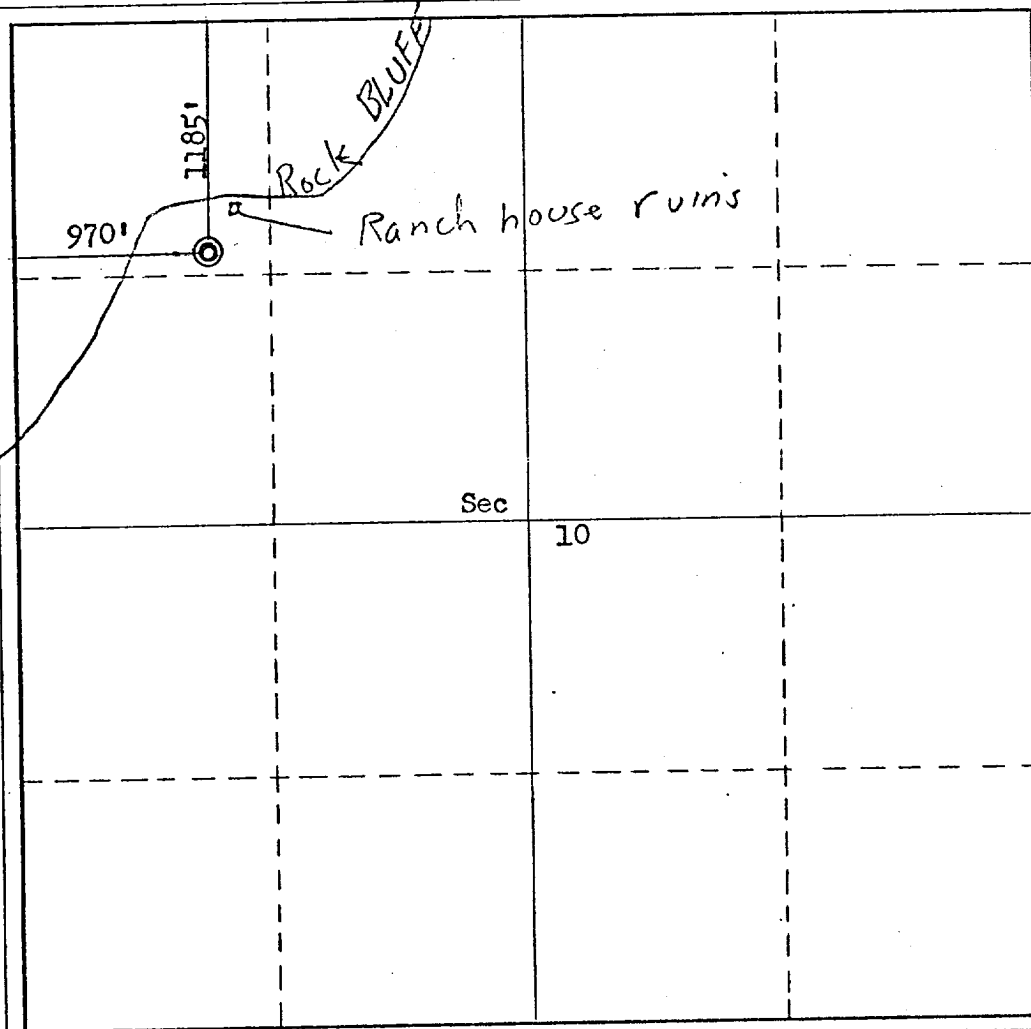
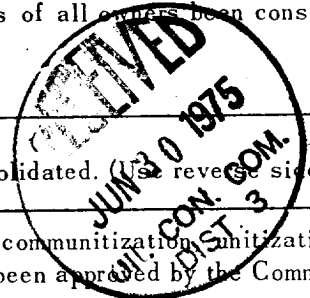

CERTIFICATION

I hereby certify that the information contained herein is true and complete to the best of my knowledge and belief.

Name _____

Position _____

Company
Merrion & Bayless

Date
June 10, 1975

I hereby certify that the well location shown on this plat was plotted from field notes of actual surveys made by me or under my supervision, and that the same is true and correct to the best of my knowledge and belief.

Date Surveyed
April 16, 1975

Registered Professional Engineer and/or Land Surveyor
Fred B. Kerr Jr.
Fred B. Kerr Jr.

Certificate No.
3950

April 21, 1975



New Mexico Oil Conservation Commission
P.O. Box 2088
Santa Fe, New Mexico 87501

Re: Unorthodox location of our
Cañada Mesa #5.

Gentlemen:

Enclosed please find a survey plat showing our proposed location for the above referred to Gallup test well. Along with the plat is a topographic map showing the problems involved in drilling this on our desired site of 990 feet from the north and west lines. However, you will note we have moved the location as described in the survey plat. This is because of the extremely steep rock bluff outcrop on a line to the north and west of the location and in addition there is a rock adobe ranch house ruin which exists next to the 990 location. The archaeologist, on examining the site, estimated that the house was over 50 years old and thus comes under the antiquities act and must not be disturbed.

We are sending a copy of this letter to the other operator who lies within a mile of the location. The acreage holder immediately south of this location is J. Gregory Merrion, et al; we are the operators of the acreage to the north, northwest and west of the location. We would like to commence this well at the earliest possible date; therefore, please advise if we can do anything to expedite your approval of this location.

Yours truly,

MERRION & BAYLESS

By ROBERT L. BAYLESS

RLB/su
Enclosures
cc NMOCC - Aztec
M & M Production
Lindrith, New Mexico