

UNITED STATES
DEPARTMENT OF THE INTERIOR
GEOLOGICAL SURVEY

30-039-21049

APPLICATION FOR PERMIT TO DRILL, DEEPEN, OR PLUG BACK

1a. TYPE OF WORK

DRILL ☒DEEPEN ☐PLUG BACK ☐

b. TYPE OF WELL

OIL
WELL ☒GAS
WELL ☐

OTHER

SINGLE
ZONE ☒MULTIPLE
ZONE ☐

2. NAME OF OPERATOR

Manning Gas & Oil Company

3. ADDRESS OF OPERATOR

1660 Lincoln Street, Suite 2502

Denver, Colorado 80203

4. LOCATION OF WELL (Report location clearly and in accordance with any State requirements.)*

At surface

500' FNL, 774' FEL

At proposed prod. zone

Same

14. DISTANCE IN MILES AND DIRECTION FROM NEAREST TOWN OR POST OFFICE*

15. DISTANCE FROM PROPOSED*

LOCATION TO NEAREST
PROPERTY OR LEASE LINE, FT.
(Also to nearest drlg. unit line, if any)

500'

16. NO. OF ACRES IN LEASE

17. NO. OF ACRES ASSIGNED
TO THIS WELL

222 1/4

18. DISTANCE FROM PROPOSED LOCATION*
TO NEAREST WELL, DRILLING, COMPLETED,
OR APPLIED FOR, ON THIS LEASE, FT.

19. PROPOSED DEPTH

8100

20. ROTARY OR CABLE TOOLS

Rotary

21. ELEVATIONS (Show whether DF, RT, GR, etc.)

7213' GR

22. APPROX. DATE WORK WILL START*

1-1-75

23.

PROPOSED CASING AND CEMENTING PROGRAM

SIZE OF HOLE	SIZE OF CASING	WEIGHT PER FOOT	SETTING DEPTH	QUANTITY OF CEMENT
12 1/2	8 5/8	24.0	350	250 SXS
7 7/8	4 1/2	9.5, 10.5, 11.6	8100	1050 SXS

It is proposed to drill this well with rotary tools using mud as circulating medium through the Dakota Formation. Possible productive zones in the Gallup and Dakota Formations will be completed. Production casing will be cemented in such a manner as to protect the pictured cliffs formation.

The NE/4 Section 2 is dedicated to this well.

IN ABOVE SPACE DESCRIBE PROPOSED PROGRAM: If proposal is to deepen or plug back, give data on present productive zone and proposed new productive zone. If proposal is to drill or deepen directionally, give pertinent data on subsurface locations and measured and true vertical depths. Give blowout preventer program, if any.

24. For: Manning Gas & Oil Co.
SIGNED [Signature] TITLE President, Walsh Engineering & Prod. Corp. DATE 12-23-74
(This space for Federal or State office use)

PERMIT NO. _____ APPROVAL DATE _____

APPROVED BY _____ TITLE _____ DATE _____
CONDITIONS OF APPROVAL, IF ANY:

Okal

Hold C-100 for NWU

*See Instructions On Reverse Side

NEW MEXICO OIL CONSERVATION COMMISSION
WELL LOCATION AND ACREAGE DEDICATION PLAT

Form C-128
Supersedes C-128
Effective 1-1-65

All distances must be from the outer boundaries of the Section

Operator MANNING GAS & OIL COMPANY			Lease APACHE		Well No. 101
Unit Letter A	Section 2	Township 24 NORTH	Range 4 WEST	County RIO ARriba	
Actual Footage Location of Well: 500 feet from the NORTH line and 774 feet from the EAST line					
Ground Level Elev. 7213.0	Producing Formation Gallup - Dakota		Well Lindrith Gallup - Dakota West		Dedicated Acreage 222±

1. Outline the acreage dedicated to the subject well by colored pencil or hatchure marks on the plat below. *cc*
2. If more than one lease is dedicated to the well, outline each and identify the ownership thereof (both as to working interest and royalty).
3. If more than one lease of different ownership is dedicated to the well, have the interests of all owners been consolidated by communitization, unitization, force-pooling, etc?

☐ Yes ☐ No If answer is "yes," type of consolidation _____

If answer is "no," list the owners and tract descriptions which have actually been consolidated. (Use reverse side of this form if necessary.) _____

No allowable will be assigned to the well until all interests have been consolidated (by communitization, unitization, forced-pooling, or otherwise) or until a non-standard unit, eliminating such interests, has been approved by the Commission.

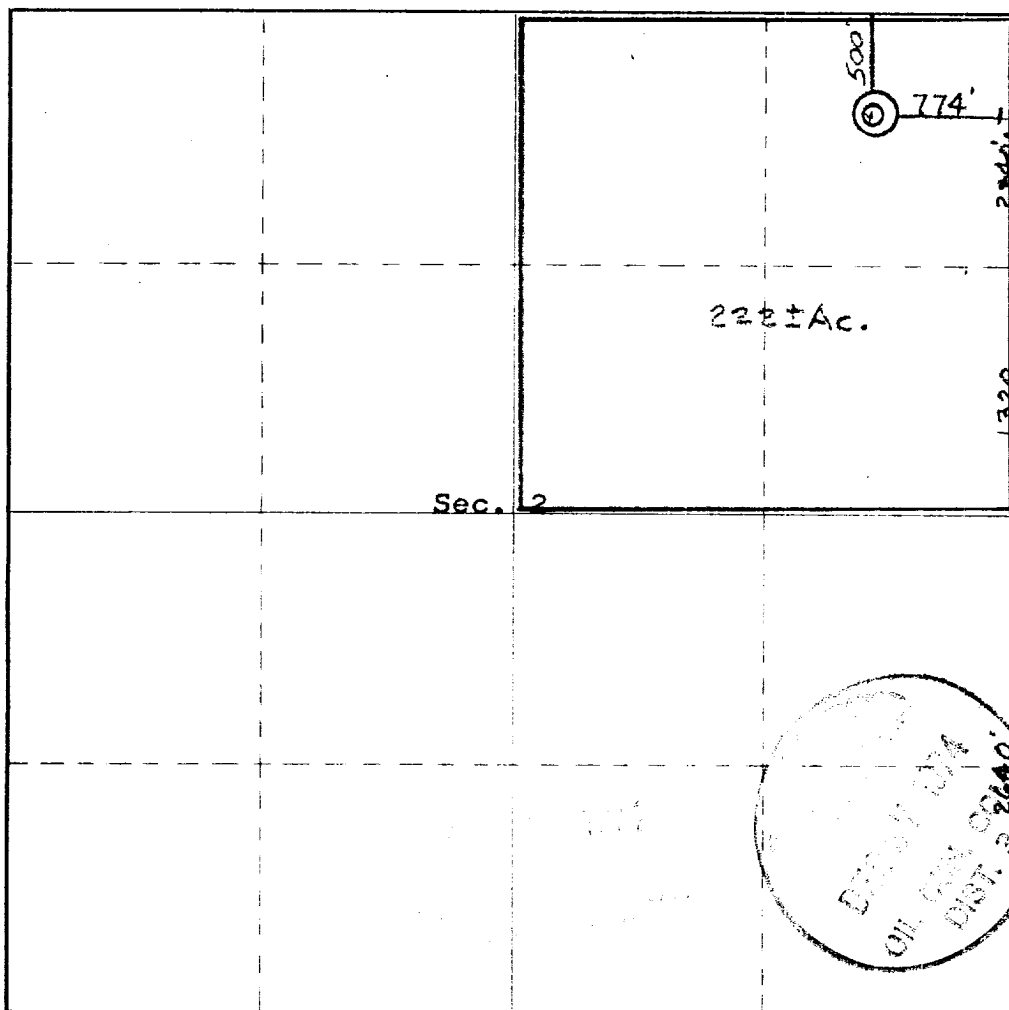

Found	CERTIFICATION
I hereby certify that the information contained herein is true and complete to the best of my knowledge and belief.	
<i>Ewell N. Walsh</i>	
Name	Ewell N. Walsh, Pres.
Position	Walsh Engineering & Production Corp.
Company	For: Manning Gas & Oil Co.
Date	12-23-74
I hereby certify that the well location shown on this plat was plotted from field notes of actual surveys made by me or under my supervision, and that the same is true and correct to the best of my knowledge and belief.	
19 December, 1974	
JAMES P. LEESSE	
<i>James P. Leesse</i>	
1463	
Certification	

0 330 660 990 1320 1650 1980 2310 2640 2970 3300 3630 3960 4290 4620 4950 5280 5610 5940 6270 6600