

NO. OF COPIES RECEIVED	6
DISTRIBUTION	
SANTA FE	1
FILE	1
U.S.G.S.	2
LAND OFFICE	1
OPERATOR	1

# NEW MEXICO OIL CONSERVATION COMMISSION

30-039-21095

Form C-101  
Revised 1-1-65

5A. Indicate Type of Lease	STATE <input type="checkbox"/>	FEE <input checked="" type="checkbox"/>
5. State Oil & Gas Lease No.		

## APPLICATION FOR PERMIT TO DRILL, DEEPEN, OR PLUG BACK

1a. Type of Work		7. Unit Agreement Name	
b. Type of Well OIL WELL <input type="checkbox"/> GAS WELL <input checked="" type="checkbox"/> OTHER <input type="checkbox"/>		8. Farm or Lease Name <b>REGINA</b>	
2. Name of Operator <b>LYNCO OIL CORPORATION</b>		9. Well No. <b>#6</b>	
3. Address of Operator <b>7890 E. Prentice Ave. Englewood, Colorado 80110</b>		10. Field and Pool, or Wildcat <b>South Blanco, PC</b>	
4. Location of Well UNIT LETTER <b>B</b> LOCATED <b>790'</b> FEET FROM THE <b>North</b> LINE <b>1850'</b> <b>East</b> <b>34</b> <b>24N</b> <b>1W</b> AND FEET FROM THE LINE OF SEC. TWP. RGE. NMPM		12. County <b>Rio Arriba</b>	
19. Proposed Depth <b>3400</b>		19A. Formation <b>Pictured Cliffs</b>	20. Rotary or C.T. <b>Rotary</b>
21. Elevations (Show whether DF, RT, etc.) <b>7337 GR</b>	21A. Kind & Status Plug. Bond <b>State Wide</b>	21B. Drilling Contractor <b>Signal Drilling</b>	22. Approx. Date Work will start <b>May 15, 1975</b>

## 23. PROPOSED CASING AND CEMENT PROGRAM

SIZE OF HOLE	SIZE OF CASING	WEIGHT PER FOOT	SETTING DEPTH	SACKS OF CEMENT	EST. TOP
12 1/4"	8 5/8"	24#	100'	100 sxs.	Circulate
6 3/4"	2 7/8"	6.4#	3400'	200 sxs.	2400

Drill 12 1/4" hole to 100 feet. Set 8 5/8" surface casing at 100 feet and circulate cement to surface using 100 sacks. Mud drill 6 3/4" hole to 3400 feet. Run 2 7/8" casing to 3300 feet and cement with 200 sacks. Perforate and sand water frac Pictured Cliffs sand. Test and complete well.

APPROVAL VALID  
FOR 90 DAYS UNLESS  
DRILLING COMMENCED,

EXPIRES 8-7-75

IN ABOVE SPACE DESCRIBE PROPOSED PROGRAM: IF PROPOSAL IS TO DEEPEN OR PLUG BACK, GIVE DATA ON PRESENT PRODUCTIVE ZONE AND PROPOSED NEW PRODUCTIVE ZONE. GIVE BLOWOUT PREVENTER PROGRAM, IF ANY.

I hereby certify that the information above is true and complete to the best of my knowledge and belief.

Signed E. L. FORDINGSLAND, JR. Title Vice President Date 4-29-75

(This space for State Use)

APPROVED BY *Emily C. Carter* TITLE SUPERVISOR DIST. #3 DATE MAY 9 1975

CONDITIONS OF APPROVAL, IF ANY:

**NEW MEXICO OIL CONSERVATION COMMISSION  
WELL LOCATION AND ACREAGE DEDICATION PLAT**

Form C-102  
Supersedes C-128  
Effective 1-1-65

All distances must be from the outer boundaries of the Section.

Operator <b>Lynco Oil Corporation</b>			Lease		Well No. <b>Regina #6</b>
Unit Letter <b>B</b>	Section <b>34</b>	Township <b>24 North</b>	Range <b>1 West</b>	County <b>Rio Arriba</b>	
Actual Footage Location of Well: <div style="display: flex; justify-content: space-between;"> <span><b>790</b> feet from the <b>North</b> line and</span> <span><b>1850</b> feet from the <b>East</b> line</span> </div>					
Ground Level Elev. <b>7337</b>	Producing Formation <b>PICTURED CLIFFS</b>	Pool <b>SOUTH BLANCO PC</b>	Dedicated Acreage: <b>160</b> Acres		

1. Outline the acreage dedicated to the subject well by colored pencil or hachure marks on the plat below.
2. If more than one lease is dedicated to the well, outline each and identify the ownership thereof (both as to working interest and royalty).
3. If more than one lease of different ownership is dedicated to the well, have the interests of all owners been consolidated by communitization, unitization, force-pooling, etc?

☐ Yes    ☐ No    If answer is "yes," type of consolidation \_\_\_\_\_

If answer is "no," list the owners and tract descriptions which have actually been consolidated. (Use reverse side of this form if necessary.) \_\_\_\_\_

No allowable will be assigned to the well until all interests have been consolidated (by communitization, unitization, forced-pooling, or otherwise) or until a non-standard unit, eliminating such interests, has been approved by the Commission.

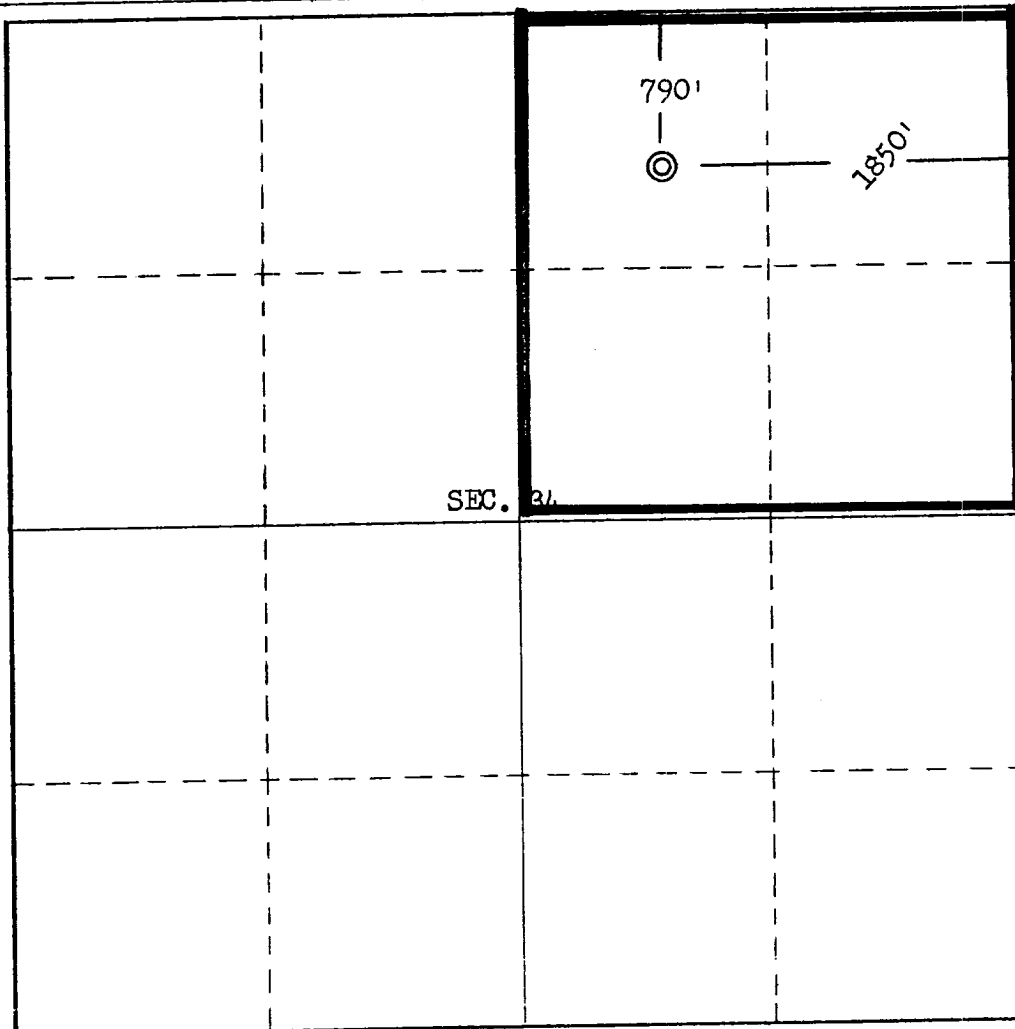
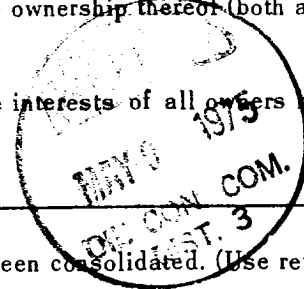

**CERTIFICATION**

I hereby certify that the information contained herein is true and complete to the best of my knowledge and belief.

Name  
**E. L. FUNDINGSLAND, JR.**  
Position  
**VICE PRESIDENT**  
Company  
**LYNCO OIL CORPORATION**  
Date  
**APRIL 28, 1975**

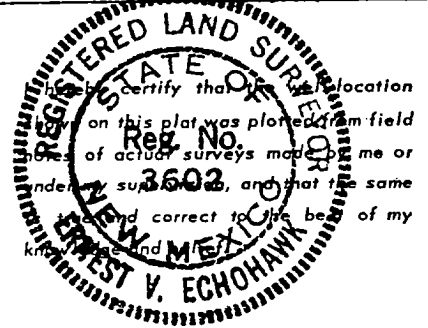

Date Surveyed  
**April 22, 1975**  
Registered Professional Engineer and/or Land Surveyor

*E. V. Echohawk*  
Certificate No. **3602**  
**E. V. Echohawk LS**

