

UNITED STATES  
DEPARTMENT OF THE INTERIOR  
GEOLOGICAL SURVEY

30-039-21116

5. LEASE DESIGNATION AND SERIAL NO.

CONTRACT No. 122

6. IF INDIAN, ALLOTTEE OR TRIBE NAME

JICARILLA APACHE

7. UNIT AGREEMENT NAME

8. FARM OR LEASE NAME

AXI APACHE "O"

9. WELL NO.

7

10. FIELD AND POOL, OR WILLACAT

AXI APACHE "S. BLANCO  
PICTURED CLIFFS11. SEC., T., R., M., OR BLK.  
AND SURVEY OR AREA

SEC. 3, T. 25N, R. 4W

12. COUNTY OR PARISH

13. STATE

RIO ARRIBA N.M.

## APPLICATION FOR PERMIT TO DRILL, DEEPEN, OR PLUG BACK

1a. TYPE OF WORK

DRILL ☒DEEPEN ☐PLUG BACK ☐

b. TYPE OF WELL

OIL  
WELL ☐GAS  
WELL ☒

OTHER

SINGLE  
ZONE ☒MULTIPLE  
ZONE ☐

2. NAME OF OPERATOR

CONTINENTAL OIL COMPANY

3. ADDRESS OF OPERATOR

Box 460, HOBBS, N.M. 88240

4. LOCATION OF WELL (Report location clearly and in accordance with any State requirements.)\*

At surface

1450' FNL &amp; 1105' FEL OF SEC. 3

At proposed prod. zone

14. DISTANCE IN MILES AND DIRECTION FROM NEAREST TOWN OR POST OFFICE\*

15. DISTANCE FROM PROPOSED\*

LOCATION TO NEAREST

PROPERTY OR LEASE LINE, FT.

(Also to nearest drlg. unit line, if any)

16. NO. OF ACRES IN LEASE

17. NO. OF ACRES ASSIGNED  
TO THIS WELL

161.28

18. DISTANCE FROM PROPOSED LOCATION\*

TO NEAREST WELL, DRILLING, COMPLETED,  
OR APPLIED FOR, ON THIS LEASE, FT.

19. PROPOSED DEPTH

3720'

20. ROTARY OR CABLE TOOLS

ROTARY

21. ELEVATIONS (Show whether DF, RT, GR, etc.)

6988' GR.

22. APPROX. DATE WORK WILL START\*

9-10-75

23.

## PROPOSED CASING AND CEMENTING PROGRAM

SIZE OF HOLE	SIZE OF CASING	WEIGHT PER FOOT	SETTING DEPTH	QUANTITY OF CEMENT
12 1/4"	8 5/8"	24# K-55	225'	175 SKS. Circ to Str.
6 3/4"	2 7/8"	6.5# J-55	3720'	210 SKS.

It is proposed to drill a straight hole to a TD of 3720' and complete as a S. Blanco Pictured Cliffs gas well.

Mud Program: 0'-225' Fresh Wtr; 225'-3720' 8.5# 9.0# gel.

See Attached for Blowout Preventer Program.

JUL 28 1975

IN ABOVE SPACE DESCRIBE PROPOSED PROGRAM: If proposal is to deepen or plug back, give data on present productive zone and proposed new productive zone. If proposal is to drill or deepen directionally, give pertinent data on subsurface locations and measured and true vertical depths. Give blowout preventer program, if any.

24.

SIGNED

TITLE

DATE

(This space for Federal or State office use)

PERMIT NO.

APPROVAL DATE

APPROVED BY

TITLE

DATE

CONDITIONS OF APPROVAL, IF ANY:

\*See Instructions On Reverse Side

4565-6 (Durango), El Paso, Exxon, File

NEW MEXICO OIL CONSERVATION COMMISSION  
WELL LOCATION AND ACREAGE DEDICATION PLAT

Form 7-1  
Supersedes 0-120  
Effective 1-1-67

All distances must be from the outer boundaries of the Section

Operator <b>CONTINENTAL OIL COMPANY</b>			Lease <b>AXI APACHE</b>		Well No. <b>6-7</b>
Section <b>H</b>	Range <b>3</b>	Township <b>25 NORTH</b>	Range <b>4 WEST</b>	County <b>RIO ARriba</b>	
Aerial Footage Location of Well:					
1450 feet from the NORTH line and		1105 feet from the EAST line			
Ground Level Elev. <b>6988.0</b>	Picture No. <b>PICTURED CLIFF</b>	Lease No. <b>AXI APACHE - S. BLAND</b>		Section <b>161.28</b> <b>160</b>	

1. Outline the acreage dedicated to the subject well by colored pencil or hachure marks on the plat below.
2. If more than one lease is dedicated to the well, outline each and identify the ownership thereof (both as to working interest and royalty).
3. If more than one lease of different ownership is dedicated to the well, have the interests of all owners been consolidated by communitization, unitization, force-pooling, etc?

☐ Yes ☐ No If answer is "yes," type of consolidation \_\_\_\_\_

If answer is "no," list the owners and tract descriptions which have actually been consolidated. (Use reverse side of this form if necessary.) \_\_\_\_\_

No allowable will be assigned to the well until all interests have been consolidated (by communitization, unitization, forced-pooling, or otherwise) or until a non-standard unit, eliminating such interests, has been approved by the Commission.

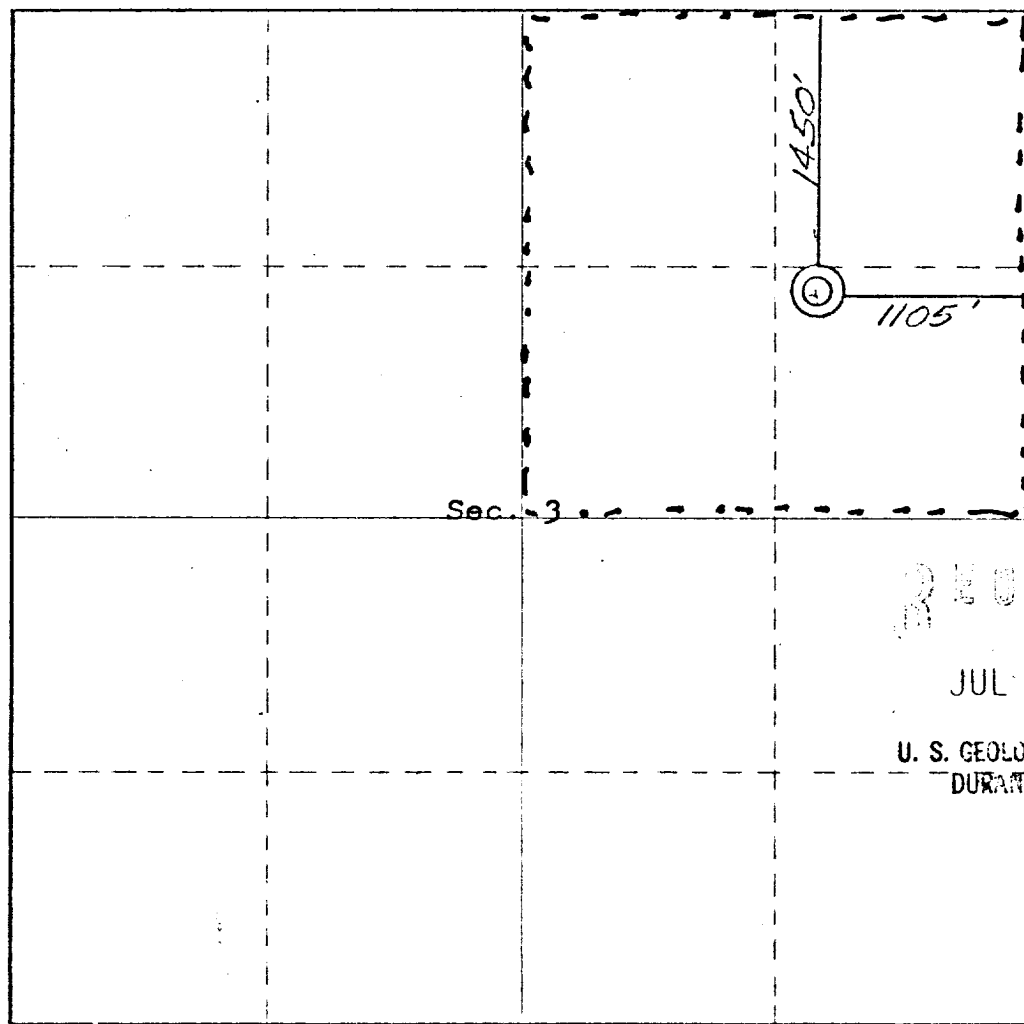
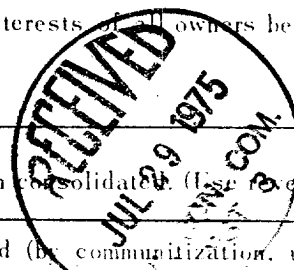

CERTIFICATION

I hereby certify that the information contained herein is true and complete to the best of my knowledge and belief.

Name *Thug Snare*  
Title **SR. ANALYST**  
Company **CONTINENTAL Oil Co.**  
Date **7-25-75**

I hereby certify that the well location shown on this plat was plotted from field notes of actual surveys made by me or my supervision, and that the same is true and correct to the best of my knowledge and belief.

U. S. GEOLOGICAL SURVEY  
DURANGO, COLO.

Date received **20 July, 1975**  
Received for certification of  
James P. Reese  
**James P. Reese**

1463

0 430 860 95 1320 1650 1980 2310 2640 2970 3300 3630 3960 4290 4620 4950 5280 5610 5940 6270 6600