

NEW MEXICO OIL CONSERVATION COMMISSION
WELL LOCATION AND ACREAGE DEDICATION PLAT

Form C-102
Supersedes C-128
Effective 1-1-65

All distances must be from the outer boundaries of the Section.

| | | | | | |
|------------------------------------------------------------------------------------------------------------------------------|-----------------------------------------------|-------------------------|------------------------------|-----------------------------|----------------------------------------|
| Operator Continental Oil Company | | | Lease AXI Apache M | | Well No. 5 |
| Unit Letter A | Section 14 | Township 25 N | Range 4 W | County Rio Arriba | |
| Actual Footage Location of Well: 820 feet from the North line and 940 feet from the East line | | | | | |
| Ground Level Elev. 7197 | Producing Formation Pictured Cliffs | | Pool So. Blanco | | Dedicated Acreage: 160 Acres |

1. Outline the acreage dedicated to the subject well by colored pencil or hachure marks on the plat below.

2. If more than one lease is dedicated to the well, outline each and identify the ownership thereof (both as to working interest and royalty).

3. If more than one lease of different ownership is dedicated to the well, have the interests of all owners been consolidated by communitization, unitization, force-pooling, etc?

☐ Yes ☐ No If answer is "yes," type of consolidation _____

If answer is "no," list the owners and tract descriptions which have actually been consolidated. (Use reverse side of this form if necessary.) _____

No allowable will be assigned to the well until all interests have been consolidated (by communitization, unitization, forced-pooling, or otherwise) or until a non-standard unit, eliminating such interests, has been approved by the Commission.

DEC 22 1975

Oil Co. Co.

CERTIFICATION

I hereby certify that the information contained herein is true and complete to the best of my knowledge and belief.

Name **Stephen A Johnson**
Position **Adm. Supervisor**
Company **Continental Oil Co.**
Date **12-19-75**

I hereby certify that the well location shown on this plat was plotted from field notes of actual surveys made by me or under my supervision, and that the same is true and correct to the best of my knowledge and belief.

Date Surveyed _____

Registered Professional Engineer and/or Land Surveyor _____

Certificate No. _____

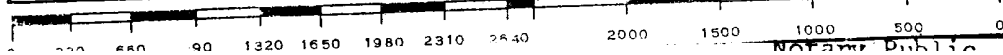
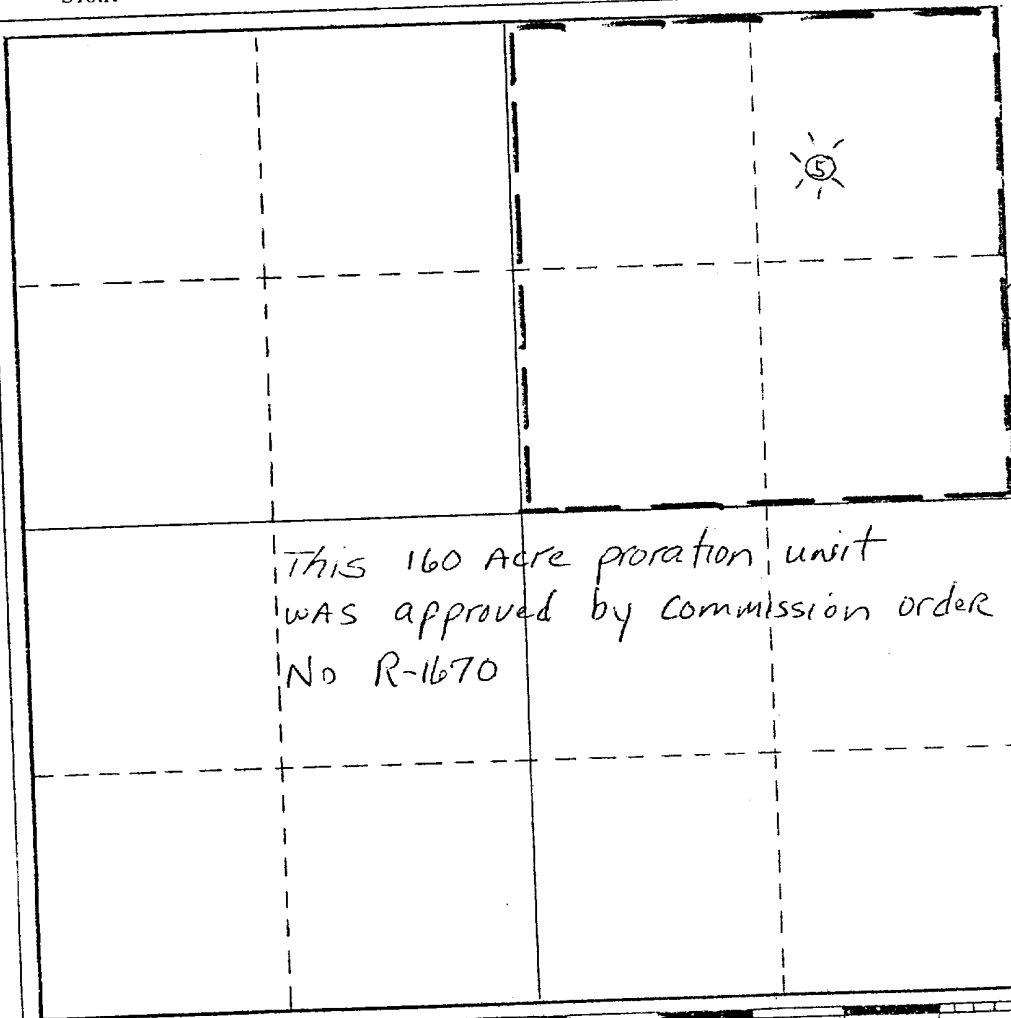

MEXICO OIL CONSERVATION COMMISSION
MULTIPOINT AND ONE POINT BACK PRESSURE TEST FOR GAS WELL

FILET
 Form C-122
 Revised 9-1-65

| | | | | | | | |
|---------------------------------------------------------------------------------------------------------------------------|------------|----------------------------------|-------------------|------------------------------------|--------------------|---------------------------------------|-------------------|
| Type Test <input checked="" type="checkbox"/> Initial <input type="checkbox"/> Annual <input type="checkbox"/> Special | | | | Test Date 11-25-75 | | | |
| Company CONTINENTAL OIL CO. | | | | Connection UNCONNECTED | | | |
| Pool SOUTH BLANCO | | | | Formation FRACTURED CLIFFS | | | |
| Completion Date | | Total Depth 3920 | | Plug Back TD 3225 | | Elevation 7208 | |
| Form or Lease Name HXI APACHE "m" | | | | Well No. 5 | | | |
| Csg. Size 2 7/8" | Wt. 6.5 | d 2.5 | Set At 3920 | Perforations: From 3677 To 3226 | | Unit Sec. Twp. Rge. 14 25N 4W | |
| Tbg. Size | Wt. | d | Set At | Perforations: From To | | | |
| Type Well - Single - Bradenhead - G.G. or G.O. Multiple SINGLE | | | | Packer Set At NONE | | County RIO ARriba | |
| Producing Thru CASING | | Reservoir Temp. °F 108 @ 3213 | | Mean Annual Temp. °F 50 | | Baro. Press. - P _a 12.2 | |
| L 3225 | H | Gg 695 | % CO ₂ | % N ₂ | % H ₂ S | Prover 3/4" CHAMBER | Notes Run NONE |

| FLOW DATA | | | | | | | TUBING DATA | | CASING DATA | | Duration of Flow |
|-----------|------------------|---|--------------|-----------------|----------|----------|-----------------|----------|-----------------|----------|------------------|
| NO. | Prover Line Size | X | Orifice Size | Press. p.s.i.g. | Diff. hw | Temp. °F | Press. p.s.i.g. | Temp. °F | Press. p.s.i.g. | Temp. °F | |
| 1 | 7 DAYS S-I | | | | | | | | 900 | 50° | 7 DAYS S-I |
| 2 | 3/4" CHAMBER | | | 75 | | 25 | | | | | 3 1/2 Hrs |
| 3 | | | | | | | | | | | |
| 4 | | | | | | | | | | | |
| 5 | | | | | | | | | | | |

| RATE OF FLOW CALCULATIONS | | | | | | | |
|---------------------------|-----------------------|------------------|-------------------------|-----------------------|-------------------------------|-----------------------------------------|----------------------|
| NO. | Coefficient (24 Hour) | $\sqrt{h_w P_m}$ | Pressure P _m | Flow Temp. Factor Ft. | Gravity Factor F _g | Super Compress. Factor, F _{pv} | Rate of Flow Q, Mcfd |
| 1 | 9.604 | | 87.2 | 1.035 | 1.200 | 1.000 | 1040 |
| 2 | | | | | | | |
| 3 | | | | | | | |
| 4 | | | | | | | |
| 5 | | | | | | | |

| NO. | P _t | Temp. °F | Z | Gas Liquid Hydrocarbon Ratio | A.P.I. Gravity of Liquid Hydrocarbons | Specific Gravity Separator Gas | Specific Gravity Flowing Fluid | Critical Pressure P.S.I.A. | Critical Temperature °F |
|-----|----------------|----------|---|------------------------------|---------------------------------------|--------------------------------|--------------------------------|----------------------------|-------------------------|
| 1 | | | | | | | | | |
| 2 | | | | | | | | | |
| 3 | | | | | | | | | |
| 4 | | | | | | | | | |
| 5 | | | | | | | | | |

| NO. | P _t ² | P _w | P _w ² | P _t ² - P _w ² |
|-----|-----------------------------|----------------|-----------------------------|-----------------------------------------------------------|
| 1 | 7604 | 87.24 | 7610 | 82499 |
| 2 | | | | |
| 3 | | | | |
| 4 | | | | |
| 5 | | | | |

(1) $\frac{P_t^2}{P_t^2 - P_w^2} = 1.0091$

AOF = Q $\left[\frac{P_t^2}{P_t^2 - P_w^2} \right]^n = 1040$

(2) $\left[\frac{P_t^2}{P_t^2 - P_w^2} \right]^n = 1.00$

| | | | | | |
|--------------------|------|---------------|------------------|----------|-----|
| Absolute Open Flow | 1040 | Mcfd @ 15.025 | Angle of Slope @ | Slope, n | .85 |
|--------------------|------|---------------|------------------|----------|-----|

Remarks: TUBING LESS COMPLETION

| | | | |
|-------------------------|----------------------------|-----------------------------|-------------|
| Approved By Commission: | Conducted By: PDT DEFOL | Calculated By: PDT DEFOL | Checked By: |
|-------------------------|----------------------------|-----------------------------|-------------|

| | |
|------------------------|-----|
| NO. OF COPIES RECEIVED | 5 |
| DISTRIBUTION | |
| SANTA FE | 1 |
| FILE | 1 |
| U.S.G.S. | |
| LAND OFFICE | |
| TRANSPORTER | OIL |
| | GAS |
| OPERATOR | 2 |
| PRORATION OFFICE | |

NEW MEXICO OIL CONSERVATION COMMISSION
REQUEST FOR ALLOWABLE
AND
AUTHORIZATION TO TRANSPORT OIL AND NATURAL GAS

Form C-104
Supersedes Old C-104 and C-110
Effective 1-1-65

| | |
|----------------------------------------------|---------------------------------------------|
| Operator Continental Oil Company | |
| Address P.O. Box 460, Hobbs New Mexico | |
| Reason(s) for filing (Check proper box) | |
| New Well <input checked="" type="checkbox"/> | Change in Transporter of: |
| Recompletion <input type="checkbox"/> | Oil <input type="checkbox"/> |
| Change in Ownership <input type="checkbox"/> | Casinghead Gas <input type="checkbox"/> |
| | Dry Gas <input checked="" type="checkbox"/> |
| | Condensate <input type="checkbox"/> |

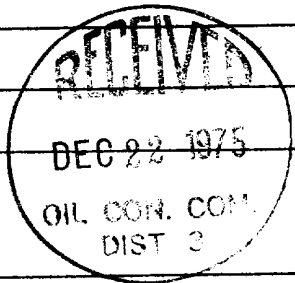

If change of ownership give name
and address of previous owner _____

II. DESCRIPTION OF WELL AND LEASE

| | | | | |
|----------------------------|------------------|--------------------------------------------------------------|-----------------------------------------------|--------------------|
| Lease Name AXI Apache M | Well No. 5 | Pool Name, Including Formation So. Blanco Pictured Cliffs | Kind of Lease State, Federal or Fee Indian | Lease No. |
| Location | | | | |
| Unit Letter A | 820 | Feet From The North | Line and 940 | Feet From The EAST |
| Line of Section 14 | Township 25 N | Range 4 W | NMPM, Rio Arriba | County |

III. DESIGNATION OF TRANSPORTER OF OIL AND NATURAL GAS

| | | |
|--------------------------------------------------------------------------------------------------------------------------|--------------------------------------------------------------------------|----------|
| Name of Authorized Transporter of Oil <input type="checkbox"/> or Condensate <input checked="" type="checkbox"/> | Address (Give address to which approved copy of this form is to be sent) | |
| Name of Authorized Transporter of Casinghead Gas <input type="checkbox"/> or Dry Gas <input checked="" type="checkbox"/> | Address (Give address to which approved copy of this form is to be sent) | |
| Southern Union Gas Co | Fidelity Union Tower, Dallas Tx 75201 | |
| If well produces oil or liquids, give location of tanks. | Unit | Sec. |
| | Twp. | Rge. |
| | Is gas actually connected? | When |
| | YES | 12-19-75 |

If this production is commingled with that from any other lease or pool, give commingling order number: _____

IV. COMPLETION DATA

| | | | | | | | | |
|-----------------------------------------------|------------------------------------------------|-------------------------|----------------------|----------|--------|-----------|--------------|---------------|
| Designate Type of Completion - (X) | Oil Well | Gas Well | New Well | Workover | Deepen | Plug Back | Same Rest'v. | Diff. Rest'v. |
| | | X | X | | | | | |
| Date Spudded 10-7-75 | Date Compl. Ready to Prod. 11-3-75 | Total Depth 3914 | P.B.T.D. 3914 | | | | | |
| Elevations (DF, RKB, RT, GR, etc.) 7197 GR | Name of Producing Formation Pictured Cliffs | Top Oil/Gas Pay 3677 | Tubing Depth 3914 | | | | | |
| Perforations 3672'-3680', 3716'-3726 | | | Depth Casing Shoe | | | | | |
| TUBING, CASING, AND CEMENTING RECORD | | | | | | | | |
| HOLE SIZE | CASING & TUBING SIZE | DEPTH SET | SACKS CEMENT | | | | | |
| 12 1/4 | 8 7/8 | 225 | 230 SKS | | | | | |
| 6 3/4 | 2 7/8 | 3914 | 175 SKS | | | | | |

V. TEST DATA AND REQUEST FOR ALLOWABLE OIL WELL (Test must be after recovery of total volume of load oil and must be equal to or exceed top allowable for this depth or be for full 24 hours)

| | | | |
|---------------------------------|-----------------|-----------------------------------------------|------------|
| Date First New Oil Run To Tanks | Date of Test | Producing Method (Flow, pump, gas lift, etc.) | |
| Length of Test | Tubing Pressure | Casing Pressure | Choke Size |
| Actual Prod. During Test | Oil-Bbls. | Water-Bbls. | Gas-MCF |

GAS WELL

| | | | |
|---------------------------------------------------|---------------------------|----------------------------------|----------------------------|
| Actual Prod. Test-MCF/D 1040 AOF | Length of Test 3 hrs | Bbls. Condensate/MMCF 0 | Gravity of Condensate 0 |
| Testing Method (pitot, back pr.) back pressure | Tubing Pressure (Shut-in) | Casing Pressure (Shut-in) 900 | Choke Size 3/4 |

VI. CERTIFICATE OF COMPLIANCE

I hereby certify that the rules and regulations of the Oil Conservation Commission have been complied with and that the information given above is true and complete to the best of my knowledge and belief.

Ralph J. Jolley

(Signature)

Administrative Supervisor

(Title)

12-19-75

(Date)

OIL CONSERVATION COMMISSION

APPROVED DEC 22 1975, 19

BY ORIGINAL SIGNED BY N. E. MAXWELL, JR.

TITLE PETROLEUM ENGINEER DIST. NO. 3

This form is to be filed in compliance with RULE 1104.

If this is a request for allowable for a newly drilled or deepened well, this form must be accompanied by a tabulation of the deviation tests taken on the well in accordance with RULE 111.

All sections of this form must be filled out completely for allowable on new and recompleted wells.

Fill out only Sections I, II, III, and VI for changes of owner, well name or number, or transporter, or other such change of condition.

Separate Forms C-104 must be filed for each pool in multiply completed wells.