

District III  
1000 Rio Brazos Rd  
Albuquerque, NM 87410

Energy, Minerals and Natural Resources Department

OIL CONSERVATION DIVISION  
2040 S. PACHECO  
Santa Fe, New Mexico 87505

Submit 1 copy to  
Appropriate District  
and 1 copy to  
Santa Fe Office

FEB 08 1996

## PIT REMEDIATION AND CLOSURE REPORT

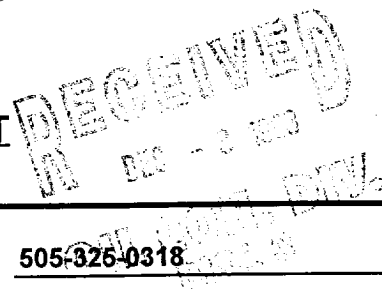

Operator: <u>Apache Corporation \ MW Petroleum</u>		Telephone: <u>505-326-0318</u>	
Address: <u>2855 Southside River Road, Suite A, Farmington, NM 87401</u>			
Facility or Well Name: <u>Jic Apache Tribal 124 #8</u>			
Location: Unit or Qtr/Qtr Sec <u>NW/SE Sec 14 T 25 N R 4W</u>		County <u>Rio Arriba</u>	
Pit Type: Separator: _____ Dehydrator: _____ Other: <u>Blow Pit</u>			
Land Type: <u>Jicarilla Tribal</u>			
Beginning Pit Dimensions:		Length <u>25'</u> Width <u>15'</u> Depth <u>4'</u>	
Ending Pit Dimensions:		Length <u>27'</u> Width <u>18'</u> Depth <u>8'</u>	
(Attach diagram)			
Reference:		Wellhead <u>XXX</u> Other: _____	
Footage from reference:		<u>80'</u>	
Direction from reference:		<u>70</u> Degrees <u>XX</u> East North <u>X</u> West of South	
<b>Depth To Groundwater:</b> (vertical distance from contaminants to seasonal high water elevation of groundwater)		Less than 50 feet (20 points) _____ 50 feet to 99 feet (10 points) _____ Greater than 100 feet (0 points) <u>0</u>	
<b>Wellhead Protection Area:</b> (Less than 200 feet from a private domestic water source, or; less than 1000 feet from all other water sources)		Yes (20 points) _____ No (0 points) <u>0</u>	
<b>Distance To Surface Water:</b> (Horizontal distance to perennial lakes, ponds, rivers, streams, creeks, irrigation canals and ditches)		Less than 200 feet (20 points) _____ 200 feet to 1000 feet (10 points) _____ Greater than 1000 feet (0 points) <u>0</u>	
		RANKING SCORE (TOTAL POINTS) <u>0</u>	

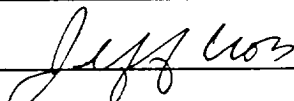
<b>Date Remediation Started:</b>		<u>7/24/97</u>	<b>Date Completed:</b>		<u>7/24/97</u>
<b>Remediation Method:</b> (Check all appropriate sections)		Excavation	<u>XXX</u>	Approx. cubic yards	<u>120</u>
		Landfarmed	<u>XX</u>	Insitu Bioremediation	
		Other _____			
<b>Remediation Location:</b> (i.e. landfarmed onsite, name and location of offsite facility)		Onsite	<u>XX</u>	Offsite	_____
<b>General Description of Remedial Action:</b>		<u>Excavate pit to 8' , took PID readings. Spread soil on</u>			
		<u>location for remediation. Took soil samples.</u>			
		_____			
		_____			
		_____			
<b>Groundwater Encountered:</b>		No	<u>XX</u>	Yes	_____ Depth _____
<b>Final Pit:</b>	Sample location <u>4 point composite sample taken from pit sidewalls. Grab sample</u>				
<b>Closure Sampling:</b> (in multiple samples, attach sample results and diagram of sample locations and depths)	taken from pit bottom center.				
	Sample depth	<u>8'</u>	<u>8 to 10" into pit sidewalls 10" into pit bottom</u>		
	Sample Date	<u>7/24/97</u>	Sample Time	<u>4:40 PM</u>	
	Sample results				
	Benzene	(ppm)	<u>ND</u>		
	Total BTEX	(ppm)	<u>ND</u>		
	Field Headspace	(ppm)	<u>18.88</u>		
	TPH		<u>Side/ND</u>		
			<u>Btm/1700</u>		
<b>Groundwater Sample:</b>	Yes	_____	No	<u>XX</u>	(If yes attach sample results)
<b>I HEREBY CERTIFY THAT THE INFORMATION ABOVE IS TRUE AND COMPLETE TO THE BEST OF MY KNOWLEDGE AND BELIEF.</b>					
<b>DATE</b>	<u>December 1, 1998</u>		<b>PRINTED NAME</b>	<u>Jeff Cross</u>	
<b>SIGNATURE</b>	<u></u>		<b>AND TITLE</b>	<u>Project Manager</u>	

**Submit 1 copy to  
Natural Resource Dept.  
and Oil & Gas Administration**

Operator: <u>M W PETROLEUM</u>		Telephone <u>505-325-0318</u>	
Address: <u>2855 Southside River Road, Suite A, Farmington, NM 87401</u>			
Facility or Well Name: <u>JAT 124 # 8</u>			
Location:	Unit or Qtr/Qtr Sec	<u>NWSE SEC 14 T 25 N R 4 W</u>	County <u>Rio Arriba</u>
Pit Type:	Separator: <u>          </u>	Dehydrator <u>          </u>	Other <u>BLOW PIT</u>
Land Type: <u>Jicarilla Tribal</u>			
Pit Location: (Attach diagram)		Pit Dimensions:	Length <u>27'</u> Width <u>18'</u> Depth <u>8'</u>
		Reference:	Wellhead <u>XX</u> Other <u>          </u>
		Footage from reference:	<u>80'</u>
		Direction from reference:	<u>70</u> Degrees <u>XX</u> East of North <u>X</u> <u>          </u> West of South <u>          </u>
<b>Depth To Groundwater:</b> (vertical distance from contaminants to seasonal high water elevation of groundwater)		Less than 50 feet 50 feet to 99 feet Greater than 100 feet	(20 points) <u>          </u> (10 points) <u>          </u> ( 0 points) <u>0</u>
<b>Distance to an Ephemeral Stream:</b> (Downgradient dry wash greater than ten feet in width)		Less than 100 feet Greater than 100 feet	(10 points) <u>          </u> ( 0 points) <u>0</u>
<b>Distance to Nearest Lake, Playa, or Watering Pond:</b> (Downgradient lakes, playas and livestock or wildlife watering ponds)		Less than 100 feet Greater than 100 feet	(10 points) <u>          </u> ( 0 points) <u>0</u>
<b>Wellhead Protection Area:</b> (Less than 200 feet from a private domestic water source, or less than 1000 feet from all other water sources)		Yes No	(20 points) <u>          </u> ( 0 points) <u>0</u>
<b>Distance To Surface Water:</b> (Horizontal distance to perennial lakes, ponds, rivers, streams, creeks, irrigation canals and ditches)		Less than 100 feet 100 feet to 1000 feet Greater than 1000 feet	(20 points) <u>          </u> (10 points) <u>          </u> ( 0 points) <u>0</u>
		RANKING SCORE (TOTAL POINTS) <u>0</u>	

Date Remediation Started: 7/24/97 Date Completed: 7/24/97

Remediation Method: Excavation XXX Approx. cubic yards 120  
(Check all appropriate sections) Landfarmed XX Insitu Bioremediation \_\_\_\_\_  
Other \_\_\_\_\_

Remediation Location: Onsite XX Offsite \_\_\_\_\_  
(i.e. landfarmed onsite, name and location of offsite facility)

General Description of Remedial Action: EXCAVATE PIT TO 8', TOOK PID READINGS.  
SPREAD SOIL ON LOCATION FOR REMEDIATION. TOOK SOIL SAMPLES.

Groundwater Encountered: No X Yes \_\_\_\_\_ Depth \_\_\_\_\_

Final Pit: Sample location 4 point composite taken from pit sidewalls  
Closure Sampling: 1 point grab sample taken from pit bottom center.  
(in multiple samples, attach sample results and diagram of sample locations and depths) Sample depth 8'

Sample Date 7/24/97 Sample Time 4:40PM  
Sample results

Soil:	Benzene	(ppm)	<u>ND</u>	Water:	Benzene	(ppb)	<u>NA</u>
	Total BTEX	(ppm)	<u>ND</u>		Toluene	(ppb)	<u>NA</u>
	Field Headspace	(ppm)	<u>18.88</u>		Ethylbenzene	(ppb)	<u>NA</u>
	TPH	(ppm)	<u>ND\SIDE</u>		Total Xylenes	(ppb)	<u>NA</u>
			<u>1700\BTM</u>				

Groundwater Sample: Yes \_\_\_\_\_ No X (If yes attach sample results)

I HEREBY CERTIFY THAT THE INFORMATION ABOVE IS TRUE AND COMPLETE TO THE BEST OF MY KNOWLEDGE AND BELIEF.

DATE 9/14/98 PRINTED NAME JEFF CROSS  
SIGNATURE Jeff Cross AND TITLE Project Manager

AFTER REVIEW OF THE PIT CLOSURE INFORMATION, PIT CLOSURE IS APPROVED IN ACCORDANCE TO THE JICARILLA APACHE TRIBE PIT CLOSURE ORDINANCE.

APPROVED: YES X NO \_\_\_\_\_ (REASON) \_\_\_\_\_

SIGNED: Ken C Mammall DATE: 11-13-98

# APACHE CORPORATION/FARMINGTON DISTRICT PIT EXCAVATION AND CLOSURE REPORT

LOCATION JAT 124 # 8

PIT COUNT 1

Jicarilla Apache Tribal EPO/OCD/BLM  
Review and Approval  
OCD-BLM  
EPO Representative \_\_\_\_\_  
Date of Review \_\_\_\_\_

START		7/24/97			FINISH		7/24/97		
DIMENSIONS		L	W	D		L	W	D	CU YDS
Pit 1	25'	15'	4'	Pit 1	27'	18'	8'	120	
Pit 2				Pit 2					
Pit 3				Pit 3					
DATE: 7/24/97		Pit 1 @ 8'	Pit 2 @	Pit 3 @	Date: 7/24/97	Pit 1 @ 8'	Pit 2 @	Pit 3 @	
P I D	Center	65.5			P I D	Center	65.5		
	NW Corner	5.6				NW Corner	5.6		
	NE Corner	8.7				NE Corner	8.7		
	SW Corner	8.1				SW Corner	8.1		
	SE Corner	6.5				SE Corner	6.5		

NOTES:  
7/24/97 START AND FINISH EXCAVATION ON PIT.  
NO STAINING OR ODOR SAMPLE PIT AND SENT TO ASSAIGAI LABS.

DATE		SOIL SAMPLING			ANALYSIS RESULTS			PER LAB	
7/24/97		Pit 1 @ 8'	Pit 2 @	Pit 3 @	PIT NO	TPH	BETEX	WITNESS	DATE
P I D	Center	65.5			1	SIDE\BTM	SIDE\BTM	J.C.	7/24/97
	NW Corner	5.6				ND\1700	ND\ND		
	NE Corner	8.7							
	SW Corner	8.1							
	SE Corner	6.5							

DATE:		Pit 1 @	Pit 2 @	Pit 3 @	ANALYSIS RESULTS			PER LAB	
					PIT NO	TPH	BETEX	WITNESS	DATE
P I D	Center				1	SIDE\BTM	SIDE\BTM		
	NW Corner								
	NE Corner								
	SW Corner								
	SE Corner								

DATE:		Pit 1 @	Pit 2 @	Pit 3 @	ANALYSIS RESULTS			PER LAB	
					PIT NO	TPH	BETEX	WITNESS	DATE
P I D	Center				1	SIDE\BTM	SIDE\BTM		
	NW Corner								
	NE Corner								
	SW Corner								
	SE Corner								

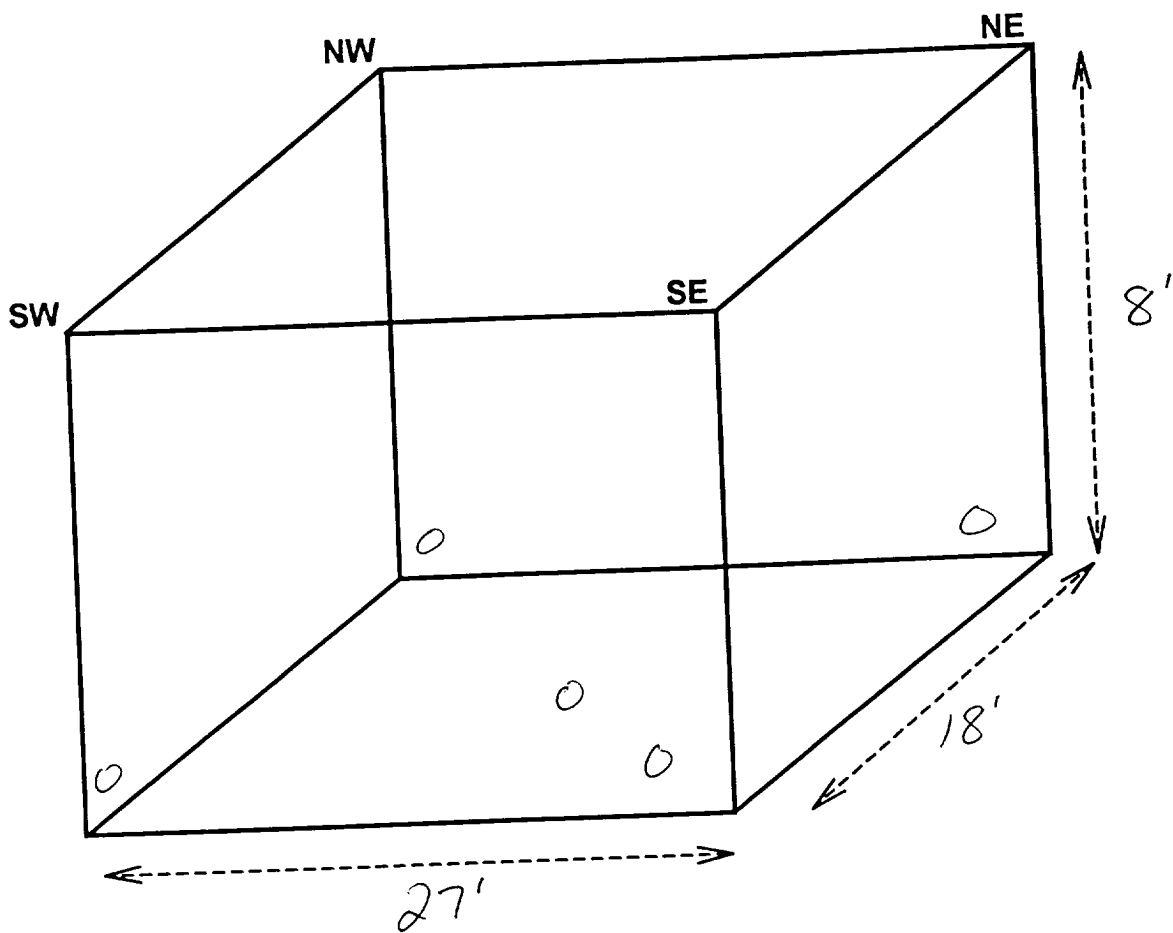

○ = SAMPLE AREA

WELL NAME JAT 124 # 8

SAMPLE DATE 7/24/97

NOTES 4 POINT COMPOSITE SAMPLE TAKEN 8" TO 10" INTO PIT  
SIDEWALL  
1 POINT GRAB SAMPLE TAKEN 10" TO 12" INTO BOTTOM CENTER  
 \_\_\_\_\_  
 \_\_\_\_\_  
 \_\_\_\_\_  
 \_\_\_\_\_  
 \_\_\_\_\_  
 \_\_\_\_\_  
 \_\_\_\_\_

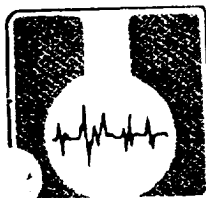

# ASSAIGAI ANALYTICAL LABORATORIES, INC.

7300 Jefferson, N.E. • Albuquerque, New Mexico 87109 • (505) 345-8964 • FAX (505) 345-7259  
3332 Wedgewood, E-5 • El Paso, Texas 79925 • (915) 593-6000 • FAX (915) 593-7820

Report Generated:  
August 4, 1997 11:15

## CERTIFICATE OF ANALYSIS RESULTS BY SAMPLE

SENT APACHE CORPORATION  
TO: 304 N. BEHREND  
FARMINGTON, NM 87401

WORKORDER # : 9707239  
WORK ID : JICARILLA PIT CLOSURES  
CLIENT CODE : APA01  
DATE RECEIVED : 07/25/97

ATTN: JEFF CROSS

Page: 1

Lab ID: 9707239-01A  
Sample ID: JAT 124 #8 PIT #1 SIDES

Collected: 07/24/97 16:40:00  
Matrix: SOIL

TEST / METHOD	RESULT	UNITS	LIMIT	D_F	DATE ANAL	BATCH_ID
BTEX/SW846 8020A						
Benzene	ND	mg/kg	0.0050	100	07/29/97	SBTXME180
Toluene	ND	mg/kg	0.0050	100	07/29/97	SBTXME180
Ethylbenzene	ND	mg/kg	0.0050	100	07/29/97	SBTXME180
P-&m-Xylene	ND	mg/kg	0.010	100	07/29/97	SBTXME180
O-Xylene	ND	mg/kg	0.0050	100	07/29/97	SBTXME180

Lab ID: 9707239-01B  
Sample ID: JAT 124 #8 PIT #1 SIDES

Collected: 07/24/97 16:40:00  
Matrix: SOIL

TEST / METHOD	RESULT	UNITS	LIMIT	D_F	DATE ANAL	BATCH_ID
Diesel Range OG Soil/M8015						
Diesel Range OG in Soil	ND	mg/Kg	25	25	07/30/97	SDRO44

Lab ID: 9707239-02A  
Sample ID: JAT 124 #8 PIT #1 BOTTOM

Collected: 07/24/97 16:45:00  
Matrix: SOIL

TEST / METHOD	RESULT	UNITS	LIMIT	D_F	DATE ANAL	BATCH_ID
BTEX/SW846 8020A						
Benzene	ND	mg/kg	0.0050	500	07/29/97	SBTXME180
Toluene	ND	mg/kg	0.0050	500	07/29/97	SBTXME180
Ethylbenzene	ND	mg/kg	0.0050	500	07/29/97	SBTXME180
P-&m-Xylene	ND	mg/kg	0.010	500	07/29/97	SBTXME180
O-Xylene	ND	mg/kg	0.0050	500	07/29/97	SBTXME180



ID: 9707239-02B

Collected: 07/24/97 16:45:00

Sample ID: JAT 124 #8 PIT #1 BOTTOM

Matrix: SOIL

TEST / METHOD	RESULT	UNITS	LIMIT	D_F	DATE ANAL	BATCH_ID
Diesel Range OG Soil/M8015 Diesel Range OG in Soil	1700	mg/Kg	25	25	07/31/97	SDRO44

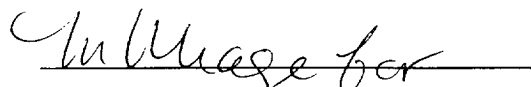
  
William P. Biava  
President



## **WORKORDER COMMENTS**

DATE : 08/04/97  
WORKORDER:

### **DEFINITIONS/DATA QUALIFIERS**

The following are definitions, abbreviations, and data qualifiers which may have been utilized in your report:

- ND = Analyte "not detected" in analysis at the sample specific detection limit.
- D\_F = Sample "dilution factor"
- NT = Analyte "not tested" per client request.
- B = Analyte was also detected in laboratory method QC blank.
- E = Analyte concentration (result) is an estimated value or exceeds analysis calibration range.
- LIMIT = The minimum amount of the analyte that AAL can detect utilizing the specified analysis.

Please Note: Multiply the "Limit" value (AAL's Detection Limit) by Dilution Factor (D\_F) to obtain the sample specific Detection Limit.

---

### **REPORT COMMENTS**

---

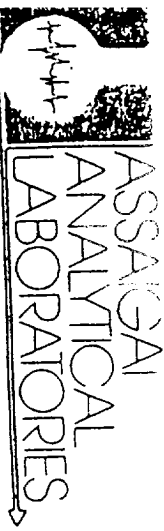

# Chain of Custody Record

Lab job no: 7237 Date 7/25/97

Page 1 of 1

JUV. JEFFERSON, N.C.  
ALBUQUERQUE, NEW MEXICO 87109  
(505) 345-8964  
3332 WEDGEWOOD  
EL PASO, TEXAS 79925  
(915) 593-6000  
1910 N. BIG SPRING  
MIDLAND, TEXAS 79705  
(915) 570-1116

MELQUIADES ALANIS  
6411 LOCAL UNO  
CIUDAD JUAREZ, CHIHUAHUA MEXICO 32320

Client Apache Corporation  
Project Manager / Contact Jeff Cross  
Address 304 N. Behrend  
Telephone No. (505) 774-6643  
City / State / Zip Farmington, NM 87401  
Fax No. (505) 774-6624  
Project Name / Number JICARILLA PIT CLOSURES  
Contract / Purchase Order / Quote \_\_\_\_\_  
Samplers: (Signature) [Signature]

ANALYST FRACTION NUMBER	Field Sample Number / Location	Date	Time	Sample Type	Type / Size of Container	Preservation		No. of Containers	Remarks
						Temp.	Chemical		
14	JAT124 PIT #3 sides	7-24-97	4:40	Soil	4oz glass	4°C	ICE	1 X	BTEX DRD (mod. BALS)
13	JAT124 PIT #3 Bottom	7-24-97	4:45					1 X	
2A								1 X	
2B									
2C									
2D									
2E									
2F									
2G									
2H									
2I									
2J									
2K									
2L									
2M									
2N									
2O									
2P									
2Q									
2R									
2S									
2T									
2U									
2V									
2W									
2X									
2Y									
2Z									

Relinquished by: Signature <u>[Signature]</u> Printed <u>ELIA O. ALANIS</u> Company <u>ATA</u> Reason _____	Date <u>7-25-97</u> Time <u>9:00</u>	Received by: Signature <u>[Signature]</u> Printed <u>ELIA O. ALANIS</u> Company <u>ATA</u> Reason _____	Date <u>7/25/97</u> Time <u>5:05 PM</u>	Received by: Signature <u>[Signature]</u> Printed <u>Carla Rubio</u> Company <u>AA2</u> Reason _____
---	---	---	--	--

Method of Shipment: \_\_\_\_\_  
Shipment No.: \_\_\_\_\_  
Special Instructions: \_\_\_\_\_

Comments: \_\_\_\_\_

After analysis, samples are to be:

☐ Disposed of (additional fee)

☐ Stored (30 days max)

☐ Stored over 30 days (additional fee)

☐ Returned to customer

LABORATORY

NORTH

DRAINAGE

JICARILLA APACHE 124 WELL #3

NW/4 SE/4

SECTION 14. T25N-R4W.

RIO ARriba COUNTY, NM.

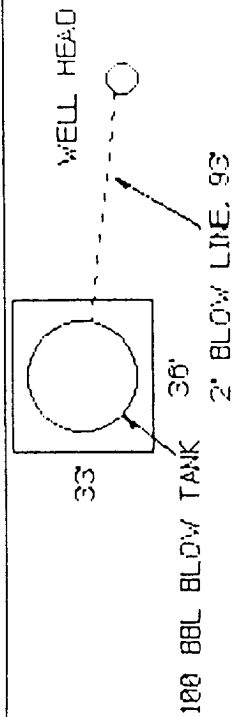

PIT

LINE HEATER

LAND FARM  
60' X 54' X 12"

JICARILLA APACHE TRIBE  
ENVIRONMENTAL PROTECTION OFFICE  
P. O. BOX 507  
DULCE, NEW MEXICO 87528

Submit 1 copy to  
Natural Resource Dept.  
and Oil & Gas Administration

**ON-SITE SOIL REMEDIATION REPORT**

Operator: <u>M W PETROLUEM</u>		Telephone <u>505-325-0318</u>
Address: <u>2855 SOUTHSIDE RIVER ROAD /SUITE A/FARMINGTON, N.M. 87401-7947</u>		
Facility or Well Name: <u>JAT 124 # 8</u>		
Location:	Unit or Qtr/Qtr Sec <u>NWSE SEC 14 T 25 N R 4 W</u>	County <u>RIO ARRIBA</u>
Land Type <u>JIC. TRIBAL</u>		
Date Remediation Started: <u>7/24/97</u>		Date Completed: <u>6/14/98</u>
Remediation Method: Landfarmed <u>XXX</u>		Approx. cubic yards <u>120</u>
Composted _____		
Other _____		<u>SOIL TO BE SPREAD ON LOCATION.</u>
Depth to Groundwater: (pts) <u>0</u>		<b>Final Closure Sampling</b> Sampling Date: <u>6/14/98</u> Time: <u>10:30AM</u> Sample Results: Field Headspace (ppm) <u>0</u> TPH (ppm) <u>1100</u> Method <u>M8015</u> Other <u>BTEX \ SW846 , 8020A (ND)</u>
Distance to an Ephemeral Stream: (pts) <u>0</u>		
Distance to Nearest Lake, Playa, or Watering Pond: (pts) <u>0</u>		
Wellhead Protection Area: (pts) <u>0</u>		
Distance To Surface Water: (pts) <u>0</u>		
<b>RANKING SCORE (TOTAL POINTS)</b> <u>0</u>		
I HEREBY CERTIFY THAT THE INFORMATION ABOVE IS TRUE AND COMPLETE TO THE BEST OF MY KNOWLEDGE AND BELIEF		
DATE: <u>9/14/98</u>		PRINTED NAME <u>JEFF CROSS</u>
SIGNATURE <u>Jeff Cross</u>		TITLE <u>PROJECT MANAGER</u>
AFTER REVIEW OF THE SOIL REMEDIATION INFORMATION. ON-SITE REMEDIATION IS APPROVED IN ACCORDANCE TO THE JICARILLA APACHE TRIBE PIT CLOSURE ORDINANCE.		
APPROVED: YES <u>X</u> NO _____ (REASON) _____		
SIGNED: <u>Ken C M...ll</u>		DATE: <u>11-13-98</u>

# M W PETROLEUM/FARMINGTON DISTRICT SOIL REMEDIATIONS STATUS REPORT

REMEDIATION SITE JAT 124 # 8

\* AMOUNT OF SOIL UNDERGOING REMEDIATION 120 Yds.

CELL No. <u>1</u>	SampDATE	TPH	BTEX
	4/28/98	2400	ND
	6/14/98	1100	ND
DIMENSIONS(LxWxH) <u>60' X 54' X 12"</u>			
CELL LOCATION (dir. from well head) <u>WEST</u>			
* DATE BEGAN: <u>7/24/97</u>			
DATE TERMINATED (TPH <5,000 ppm/BTEX< 50 ppm/Benzene < 10 ppm) <u>6/14/98</u>			
CELL No. <u>2</u>	SampDATE	TPH	BTEX
DIMENSIONS(LxWxH) _____			
CELL LOCATION (dir. from well head) _____			
* DATE BEGAN: _____			
DATE TERMINATED (TPH <5,000 ppm/BTEX< 50 ppm/Benzene < 10 ppm) _____			
CELL No. <u>3</u>	SampDATE	TPH	BTEX
DIMENSIONS(LxWxH) _____			
CELL LOCATION (dir. from well head) _____			
* DATE BEGAN: _____			
DATE TERMINATED (TPH <5,000 ppm/BTEX< 50 ppm/Benzene < 10 ppm) _____			
REMEDATION RECORD: (Date, Treatment, Tilling)			
7/27/97 TREAT SOIL WITH 46-0-0 FERTILIZER, WATER, PLOW AND TILL SOIL.			
8/8/97 PLOW AND TILL SOIL.			
4/21/98 PLOW AND TILL SOIL CELL.			
5/29/98 WATER, PLOW AND TILL SOIL CELL.			
6/11/98 PLOW AND TILL SOIL CELL.			

From excavation reports.

WELL NAME: JAT 124 # 8

SAMPLE DATE: 6/14/98

DIMENSIONS: 60' X 54' X 12'

○ = SAMPLE AREA

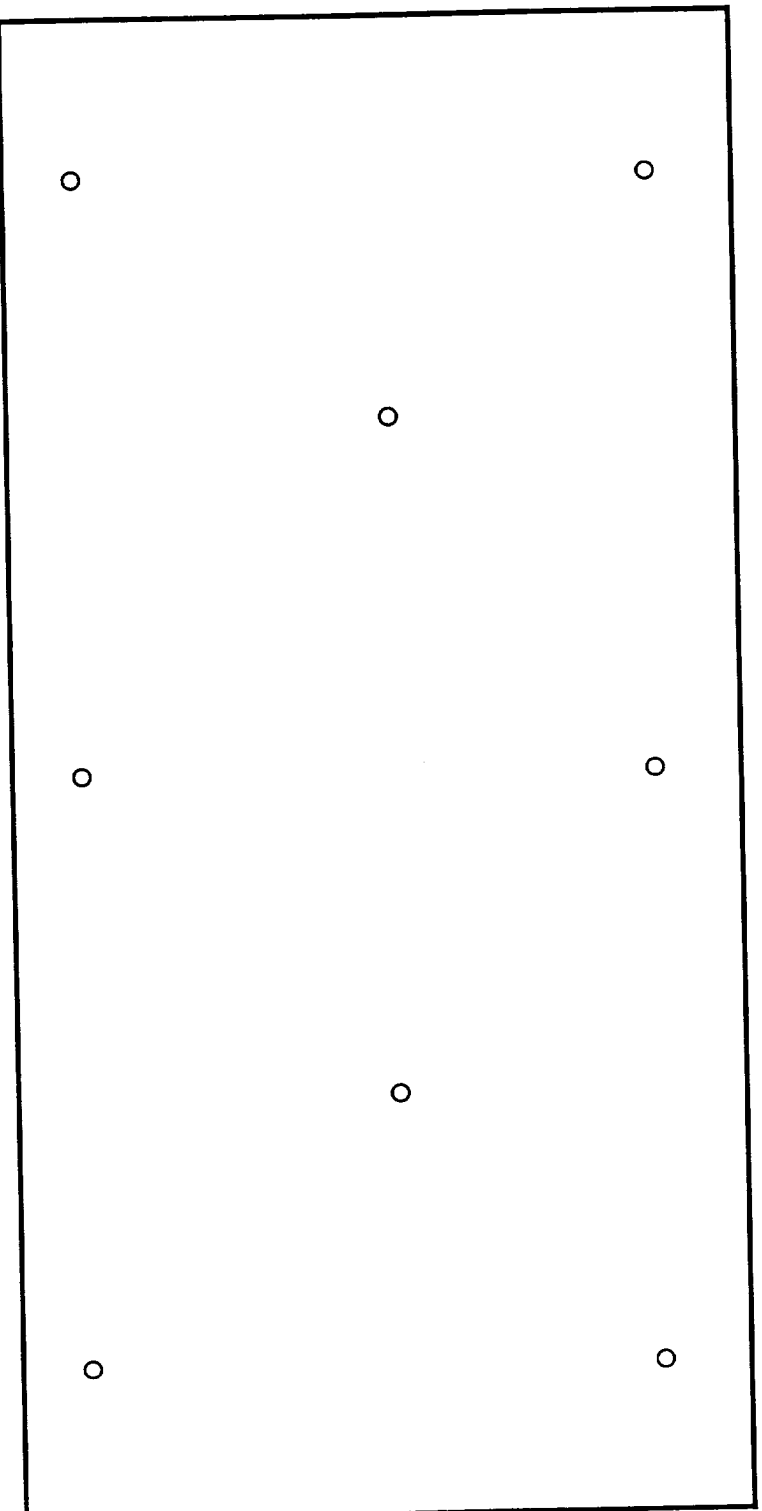

NOTES: ALL SAMPLES TAKEN 10" TO 12" INTO CELL.

8 POINT COMPOSITE SAMPLE

---

---

---

---

---

---

---

---

---

---

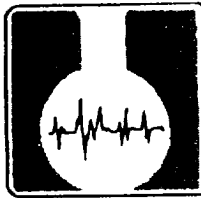

**ASSAIGAI  
ANALYTICAL  
LABORATORIES, INC.**

**JUN 26 1998**

7300 Jefferson, N.E. • Albuquerque, New Mexico 87109 • (505) 345-8964 • FAX (505) 345-7259  
3332 Wedgewood, E-5 • El Paso, Texas 79925 • (915) 593-6000 • FAX (915) 593-7820

**APACHE CORPORATION**  
attn: **JEFF CROSS**  
**2855 SOUTHSIDE RIVER RD STE A**  
**FARMINGTON, NM 87401-7947**

**\* explanation of codes**

B	analyte detected in Method Blank
E	result is estimated
H	analyzed out of hold time
N	tentatively identified compound
S	subcontracted
1-9	see footnote

*Assaigai Analytical Laboratories, Inc.*

**Certificate of Analysis**

Client: **APACHE CORPORATION**  
Project: **9806213 JICARILLA**

*Karen Talster for*  
William P. Biava: President of Assaigai Analytical Laboratories, Inc.

Client Sample ID: **JAT 124 #8**      Sample Matrix: **SOIL**      Sample Collected: **06/14/98 10:30:00**

Fraction	QC Group	CAS #	Result	Units	Dilution Factor	Detection Limit	* Sequence	Run Date
<b>SW846-8010/8020 Volatiles</b>								
9806213-01A	X98329	71-43-2	Benzene	ND	mg / Kg	50	0.005	XG.1998.550-13 06/17/98
	X98329	100-41-4	Ethylbenzene	ND	mg / Kg	50	0.005	XG.1998.550-13
	X98329	95-47-6	o-Xylene	ND	mg / Kg	50	0.005	XG.1998.550-13
	X98329		P/M-Xylenes	ND	mg / Kg	50	0.01	XG.1998.550-13
	X98329	108-88-3	Toluene	ND	mg / Kg	50	0.005	XG.1998.550-13
<b>SW846-8015 Modified TPH</b>								
9806213-01B	X98332		Diesel Range Organics	1100	mg / Kg	25	25	XG.1998.561-10 06/23/98

\*\*\* Sample specific analytical Detection Limit is determined by multiplying the sample Dilution Factor by the listed method Detection Limit. \*\*\*



