

UNITED STATES  
DEPARTMENT OF THE INTERIOR  
GEOLOGICAL SURVEY

30 - 039 - 21125

## APPLICATION FOR PERMIT TO DRILL, DEEPEN, OR PLUG BACK

1a. TYPE OF WORK DRILL <input checked="" type="checkbox"/> DEEPEN <input type="checkbox"/> PLUG BACK <input type="checkbox"/>			5. LEASE DESIGNATION AND SERIAL NO. Jicarilla Contract #12		
b. TYPE OF WELL OIL WELL <input type="checkbox"/> GAS WELL <input checked="" type="checkbox"/> OTHER <input type="checkbox"/>			6. IF INDIAN, ALLOTTEE OR TRIBE NAME Jicarilla Contract #12		
2. NAME OF OPERATOR Mobil Oil Corporation			7. UNIT AGREEMENT NAME		
3. ADDRESS OF OPERATOR P. O. Box 633, Midland, Texas 79701			8. FARM OR LEASE NAME Jicarilla Otero		
4. LOCATION OF WELL (Report location clearly and in accordance with any State requirements.)* At surface 790' FNL & 890' FWL, Sec. 27, T-24-N, R-5-W At proposed prod. zone Same as surface			9. WELL NO. 4		
14. DISTANCE IN MILES AND DIRECTION FROM NEAREST TOWN OR POST OFFICE* 50 miles SSW of Dulce, New Mexico			10. FIELD AND POOL, OR WILDCAT Basin Dakota		
15. DISTANCE FROM PROPOSED* LOCATION TO NEAREST PROPERTY OR LEASE LINE, FT. (Also to nearest drlg. unit line, if any) 1754'			11. SEC., T., R., M., OR BLK. AND SURVEY OR AREA Sec. 27, T-24-N, R-5-W		
16. NO. OF ACRES IN LEASE 1920			12. COUNTY OR PARISH Rio Arriba		
17. NO. OF ACRES ASSIGNED TO THIS WELL 320			13. STATE New Mexico		
18. DISTANCE FROM PROPOSED LOCATION* TO NEAREST WELL, DRILLING COMPLETED, OR APPLIED FOR, ON THIS LEASE, FT. 2656'			20. ROTARY OR CABLE TOOLS Rotary		
21. ELEVATIONS (Show whether DF, RT, GR, etc.) 6634' GR			22. APPROX. DATE WORK WILL START* As soon as possible		

## PROPOSED CASING AND CEMENTING PROGRAM

SIZE OF HOLE	SIZE OF CASING	WEIGHT PER FOOT	SETTING DEPTH	QUANTITY OF CEMENT
12-1/4"	8-5/8"	20# - H-40	300'	(1) Circulate to surface
7-7/8"	5-1/2"	14# - K-55	0-5850'	(2) Circulate to surface
		15.5#- K-55	5850-7000'	

## CEMENTING PROGRAM

- (1) Class A cement with 2% CaCl<sub>2</sub>
- (2) Lightweight and Class C Cement

## BLOWOUT PREVENTER &amp; MUD PROGRAM ATTACHED

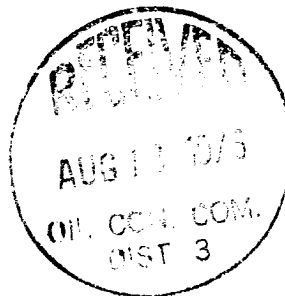
RECEIVED  
AUG 11 1975  
U. S. GEOLOGICAL SURVEY

IN ABOVE SPACE DESCRIBE PROPOSED PROGRAM: If proposal is to deepen or plug back, give data on present productive zone and proposed new productive zone. If proposal is to drill or deepen directionally, give pertinent data on subsurface locations and measured and true vertical depths. Give blowout preventer program, if any.

24. W.B. Simmons, Jr. Associate Engineer DATE August 7, 1975

(This space for Federal or State office use)

PERMIT NO. \_\_\_\_\_ APPROVAL DATE \_\_\_\_\_

APPROVED BY \_\_\_\_\_ TITLE \_\_\_\_\_ DATE \_\_\_\_\_

CONDITIONS OF APPROVAL, IF ANY:

\*See Instructions On Reverse Side

**NEW MEXICO OIL CONSERVATION COMMISSION  
WELL LOCATION AND ACREAGE DEDICATION PLAT**

Form C-102  
Supersedes C-128  
Effective 1-1-65

All distances must be from the outer boundaries of the Section.

Operator <b>Mobil Oil Corporation</b>			Lease <b>Jicarilla Otero</b>		Well No. <b>4</b>
Unit Letter <b>D</b>	Section <b>27</b>	Township <b>24-N</b>	Range <b>5-W</b>	County <b>Rio Arriba</b>	
Actual Footage Location of Well: <b>790</b> feet from the <b>North</b> line and <b>890</b> feet from the <b>West</b> line					
Ground Level Elev. <b>6634'</b>	Producing Formation <b>Dakota</b>		Pool <b>Basin Dakota</b>		Dedicated Acreage: <b>320</b> Acres

1. Outline the acreage dedicated to the subject well by colored pencil or hachure marks on the plat below.
2. If more than one lease is dedicated to the well, outline each and identify the ownership thereof (both as to working interest and royalty).
3. If more than one lease of different ownership is dedicated to the well, have the interests of all owners been consolidated by communitization, unitization, force-pooling, etc?

☐ Yes ☐ No If answer is "yes," type of consolidation \_\_\_\_\_

If answer is "no," list the owners and tract descriptions which have actually been consolidated. (Use reverse side of this form if necessary.) \_\_\_\_\_

No allowable will be assigned to the well until all interests have been consolidated (by communitization, unitization, forced-pooling, or otherwise) or until a non-standard unit, eliminating such interests, has been approved by the Commission.

Call East

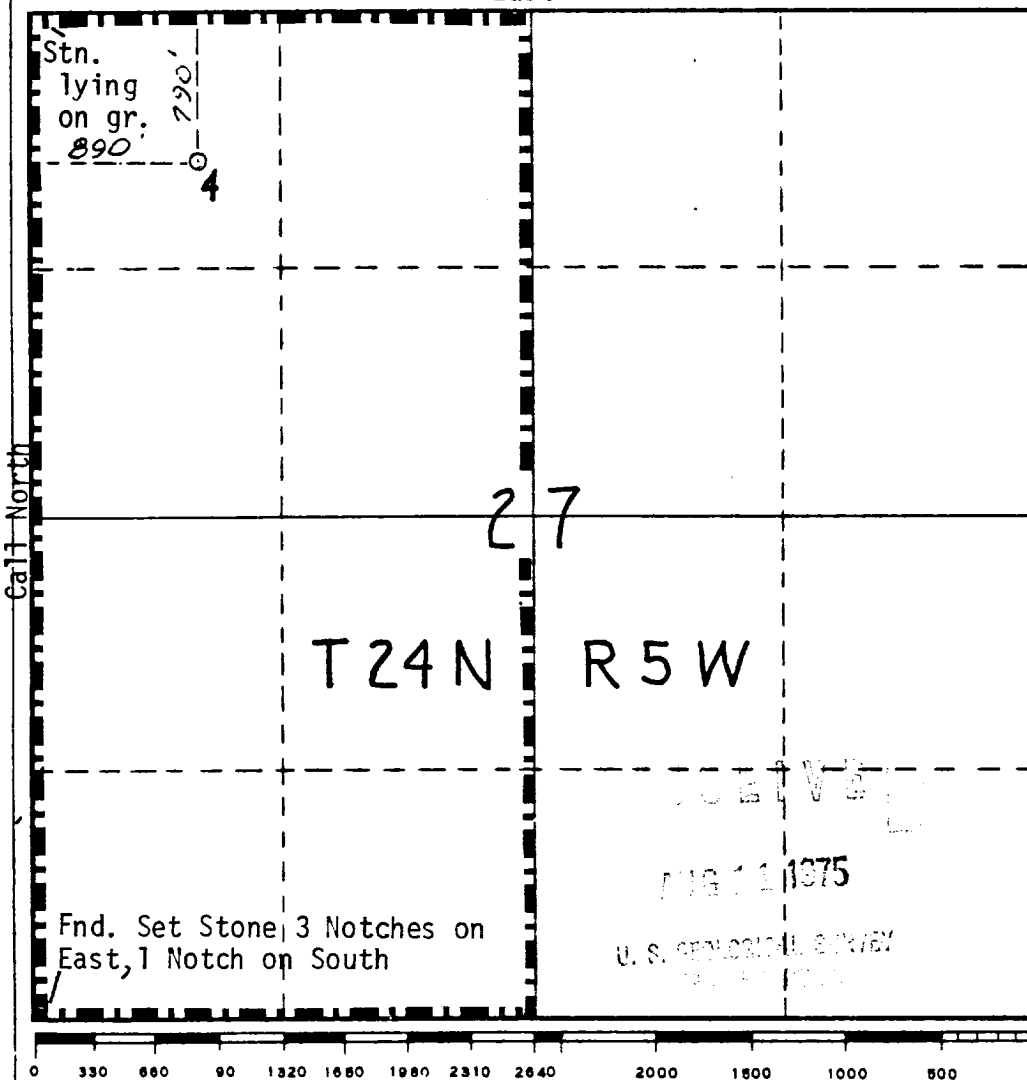

**CERTIFICATION**

I hereby certify that the information contained herein is true and complete to the best of my knowledge and belief.

*W.B. Simmons, Jr.*

Name

**W. B. Simmons, Jr.**

Position

**Associate Engineer**

Company

**Mobil Oil Corporation**

Date

**August 7, 1975**

I hereby certify that the well location shown on this plat was plotted from field notes of actual surveys made by me or under my supervision, and that the same is true and correct to the best of my knowledge and belief.

**August 4, 1975**

Date Surveyed

**H. A. Carson, Jr.**

Registered Professional Engineer and/or Land Surveyor

Certificate No.

**5063**

PROPOSED BOP STACK

8 5/8 " CASING

Bell Nipple

Flowline

BOP w/ Blank Rams

2,000 psi WP

BOP w/ Pipe Rams

2,000 psi WP

All Valves

2,000 psi WP

Kill Line 5 " 2,000psi WP

8 " 2,000 psi WP  
Flange

MOBIL OIL CORPORATION

WELL NAME & NO. Jicarilla Otero #4

COUNTY & STATE: Rio Arriba, New Mexico

AUG 11 1975

U. S. GEOLOGICAL SURVEY

OK

PROPOSED CHOKE MANIFOLD  
(MINIMUM REQUIREMENTS)  
8 5/8 " CASING STRING

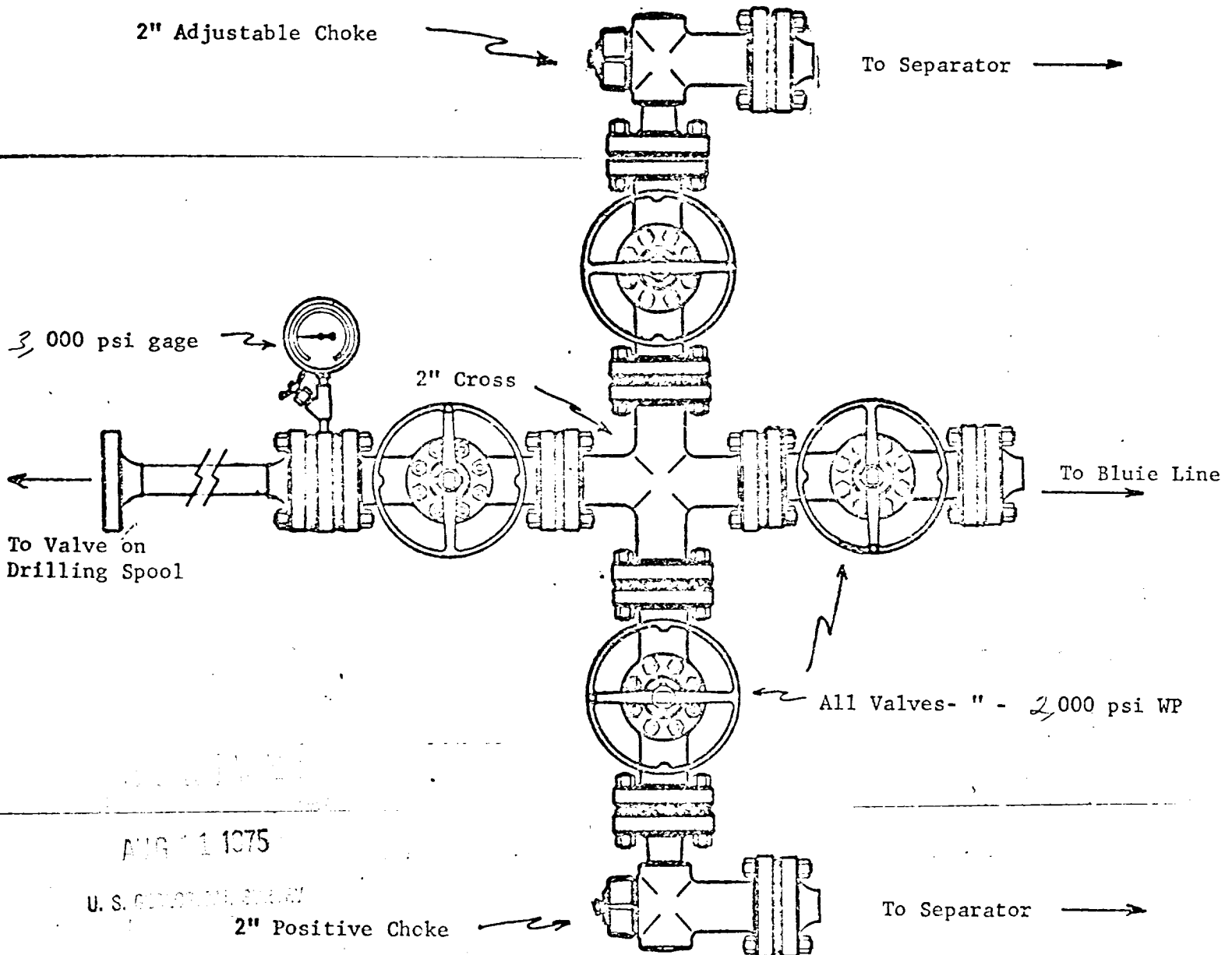

AUG 1 1975

U. S. GEOLOGICAL SURVEY

MOBIL OIL CORPORATION  
WELL NAME & NO. Jicarilla Otero #4  
COUNTY & STATE: Rio Arriba, New Mexico

PROPOSED MUD PROGRAM  
FOR  
MOBIL OIL CORPORATION'S  
JICARILLA OTERO WELL NO. 4  
BASIN DAKOTA GAS POOL  
RIO ARriba COUNTY, NEW MEXICO

---

<u>DEPTH, FT.</u>		<u>TYPE MUD</u>	<u>WEIGHT</u>	<u>VISCOSITY</u>	<u>PH</u>	<u>WATER LOSS</u>
<u>FROM</u>	<u>TO</u>					
0	300	Spud Mud	- No Control -			
300	T.D.	Fresh water with low solids gel as necessary	- No Control -			

COPIES  
AUG 1 1975  
U. S. GEOLOGICAL SURVEY