

well file
PETROLEUM ENGINEERING
RESERVOIR STUDIES
EVALUATIONS
GEOLOGICAL STUDIES

EWELL N. WALSH, P.E.
President

WALSH
ENGINEERING & PRODUCTION
CORPORATION
EXECUTIVE BLDG. - 413 W. MAIN
P. O. BOX 254
FARMINGTON, NEW MEXICO
87401

LEASE MANAGEMENT
CONTRACT PUMPING
DRILLING SUPERVISION
WORKOVER SUPERVISION

TELEPHONE 325-8203

September 16, 1975

Mr. Joe D. Ramey, Secretary-Director
New Mexico Oil Conservation Commission
P. O. Box 2088
Santa Fe, New Mexico 87501



Ref: Non-Standard Proration Unit
Manning Gas and Oil Company
Apache No. 102
Unit D-Sec. 2-T24N-R4W, NMPM
West Lindrith Gallup-Dakota Oil Pool
Rio Arriba County, New Mexico

Dear Mr. Ramey:

This request for administrative approval of a non-standard proration unit for the above-referred-to well is being presented on behalf of the operator, Manning Gas and Oil Company. This request is being presented in accordance with the procedure set forth in Order R-4314.

The subject well is located 845' feet from the North Line, 1190' from the West line of Section 2-T24N-R4W, Rio Arriba County, New Mexico. See attached Well Location and Acreage Dedication Plat.

Due to the configuration of Section 2 and the location of the subject well it would be impossible to establish a 160-acre proration unit without having to exclude a portion of the North-east Quarter of the section which is a legal subdivision.

Therefore, it is requested that the 212 $\frac{1}{2}$ included in the Northeast Quarter of Section 2-T24N-R4W be approved as a Non-Standard Proration Unit for the above-referred-to well.

Copies of this request are being sent to the offset operators, as indicated on attached map, by Certified Mail.

Mr. Joe D. Ramey
September 16, 1975

Thank you for your cooperation and consideration in this matter.

Very truly yours,

A handwritten signature in dark ink, appearing to read "Ewell N. Walsh", with a long horizontal stroke extending to the left.

Ewell N. Walsh, P. E.
President

ENW:lt

Enclosure

NEW MEXICO OIL CONSERVATION COMMISSION
WELL LOCATION AND ACREAGE DEDICATION PLAT

Form O-102
Supersedes O-128
Effective 1-1-65

All distances must be from the outer boundaries of the Section.

MANNING GAS AND OIL CO.,			Lease APACHE,		Well No. 102
Section D	Section 2	Township 24 NORTH	Range 4 WEST	County RIO ARRIBA	
Actual Postage Location of Well: 845 feet from the NORTH line and 1190 feet from the WEST line					
Ground Level Elev. 6914	Producing Formation Gallup - Dakota		Pool Lindrith Gallup-Dakota West		Dedicated Acreage: 212± Acres

1. Outline the acreage dedicated to the subject well by colored pencil or hatchure marks on the plat below.
2. If more than one lease is dedicated to the well, outline each and identify the ownership thereof (both as to working interest and royalty).
3. If more than one lease of different ownership is dedicated to the well, have the interests of all owners been consolidated by communitization, unitization, force-pooling, etc?

☐ Yes ☐ No If answer is "yes" type of consolidation _____

If answer is "no," list the owners and tract descriptions which have actually been consolidated. (Use reverse side of this form if necessary.) _____

No allowable will be assigned to the well until all interests have been consolidated (by communitization, unitization, forced-pooling, or otherwise) or until a non-standard unit, eliminating such interests, has been approved by the Commission.

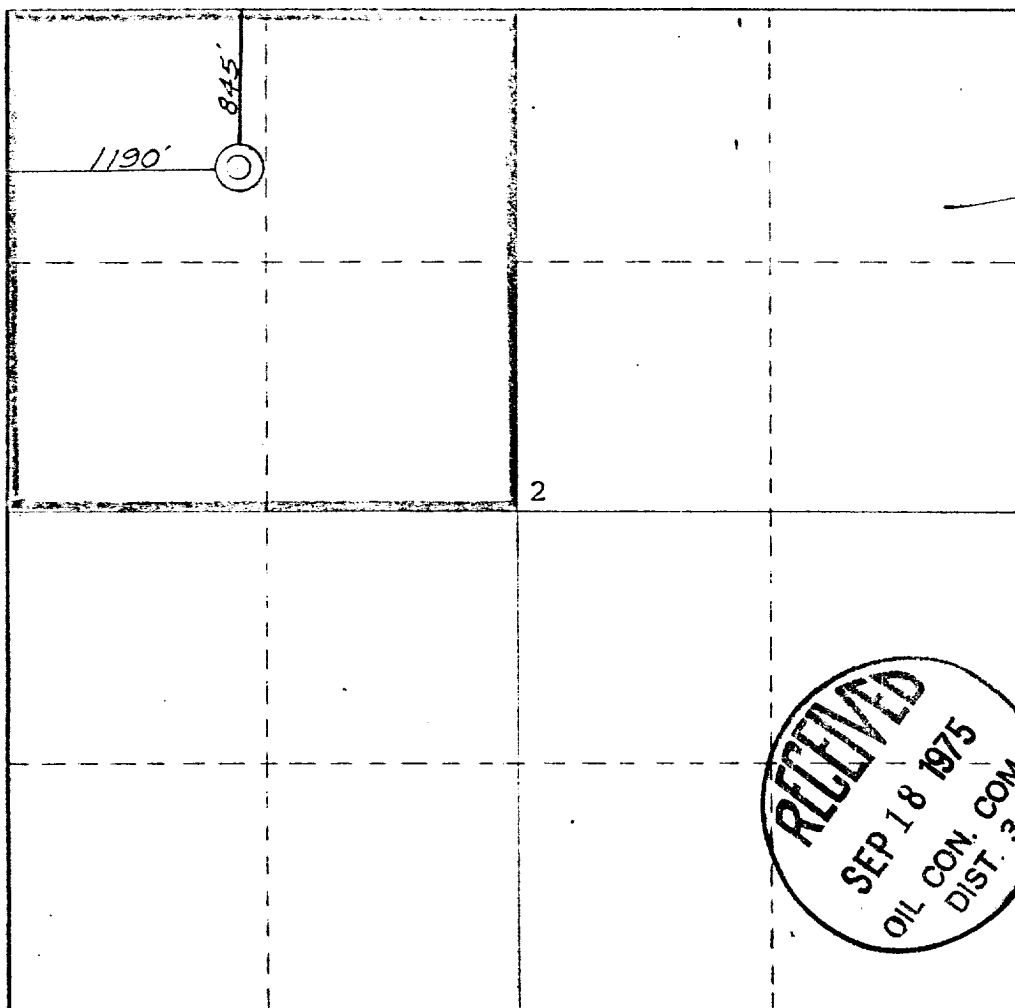

CERTIFICATION

I hereby certify that the information contained herein is true and complete to the best of my knowledge and belief.

Ewell N. Walsh
Ewell N. Walsh, P.E.,
President, Walsh Engr. &
Production Corporation

Company
For: Manning Gas & Oil Co.

Date
September 16, 1975

I hereby certify that the well location shown on this plat was plotted from field notes of actual surveys made by me or under my supervision, and that the same is true and correct to the best of my knowledge and belief.

Date
August 1975

Professional Engineer
James P. Reese
James P. Reese

Certificate No.
1463



Range 4 West			
Continental Oil Co. Sec. 34	AMOCO Production Company Sec. 35		Sec. 36
T-25-N			
T-24-N Manning Gas & Oil Co. Sec. 3	<p>• ← Well Location</p> <p>Manning Gas & Oil Company</p> <p>Sec. 2</p> <p>Northwest Production Corporation</p>		<p>Northwest Production Corp.</p> <p>Sec. 1</p>
Manning Gas & Oil Co. Sec. 10	Manning Gas & Oil Co.	Northwest Production Corp. Sec. 11	Manning Gas & Oil Co. Sec. 12

MANNING GAS & OIL COMPANY
 APACHE NO. 102
 845' FNL, 1190' FWL, Sec. 2-T24N-R4W, NMPM
 Rio Arriba County, New Mexico

Distribution:

Original	- Mr. Joe D. Ramey NMOCC, Santa Fe
1 copy	- NMOCC, Aztec
2 copies	- Mr. J. A. Nance Continental Oil Company 152 North Durbin Casper, Wyoming 82601
2 copies	- Mr. L. O. Speer Area Superintendent AMOCO Production Co. Petroleum Center Bldg. Farmington, New Mexico 87401
2 copies	- Northwest Production Corporation P. O. Box 1796 El Paso, Texas 79949
1 copy	- Manning Gas & Oil Co.
1 copy	- WEPC files