

El Paso Natural Gas Company

El Paso, Texas 79978

December 3, 1975

ADDRESS REPLY TO
POST OFFICE BOX 990
FARMINGTON, NEW MEXICO 87401

Mr. Jerry Long
U. S. Geological Survey
Post Office Box 1809
Durango, Colorado 81301

Re: Application for Permit to Drill
Jicarilla D #9
NENE/4 Section 32, T-25-N, R-4-W
South Blanco Pictured Cliffs

Dear Mr. Long:

Details regarding existing roads, pipelines, wells, etc. relative to the above well location are included on the previously submitted base maps, "Field Road Map" and "Composite Map No. 1".

The proposed new well location, new roads and new pipeline are shown on the attached plat along with connecting existing roads and pipelines in the vicinity of the proposed new well.

Water for drilling and completion operations will be obtained from a water hole located in SESE Section 5, T-24-N, R-4-W. Waste material will be disposed of by burial in the burn pit, latrine, or reserve pit as applicable. There will be no camp nor air strip associated with drilling this well. Upon completion or abandonment of this well, the location will be cleaned and leveled and a dry hole marker placed, if applicable.

Yours very truly,

D. G. Brisco

D. G. Brisco
Drilling Clerk

DGB:pb

att.

DEC 4 1975



JK

UNITED STATES
DEPARTMENT OF THE INTERIOR
GEOLOGICAL SURVEY

30-039-21164

APPLICATION FOR PERMIT TO DRILL, DEEPEN, OR PLUG BACK

1a. TYPE OF WORK

DRILL ☒

DEEPEN ☐

PLUG BACK ☐

b. TYPE OF WELL

OIL
WELL ☐

GAS
WELL ☒

OTHER

SINGLE
ZONE ☒

MULTIPLE
ZONE ☐

2. NAME OF OPERATOR

El Paso Natural Gas Company

3. ADDRESS OF OPERATOR

Post Office Box 990, Farmington, NM 87401

4. LOCATION OF WELL (Report location clearly and in accordance with any State requirements.*)

At surface

914'N, 825'E

At proposed prod. zone

A

14. DISTANCE IN MILES AND DIRECTION FROM NEAREST TOWN OR POST OFFICE*

15. DISTANCE FROM PROPOSED*

LOCATION TO NEAREST
PROPERTY OR LEASE LINE, FT.
(Also to nearest drlg. unit line, if any)

16. NO. OF ACRES IN LEASE

17. NO. OF ACRES ASSIGNED
TO THIS WELL

160

18. DISTANCE FROM PROPOSED LOCATION*
TO NEAREST WELL, DRILLING, COMPLETED,
OR APPLIED FOR, ON THIS LEASE, FT.

19. PROPOSED DEPTH

3150'

20. ROTARY OR CABLE TOOLS

Rotary

21. ELEVATIONS (Show whether DF, RT, GR, etc.)

6844'GL

22. APPROX. DATE WORK WILL START*

23.

PROPOSED CASING AND CEMENTING PROGRAM

SIZE OF HOLE	SIZE OF CASING	WEIGHT PER FOOT	SETTING DEPTH	QUANTITY OF CEMENT
12 1/4"	8 5/8"	24.0#	120'	106cu.ft. to circ. to surf.
6 3/4"	2 7/8"	6.4#	3150'	199cu.ft. to cover Ojo Alamo

Selectively perforate and sandwater fracture the Pictured Cliffs formation.

A 3000 psi WP and 6000 psi test double gate preventer equipped with blind and pipe rams will be used for blow out prevention on this well.

The NE/4 of Section 32 is dedicated to this well.

DEC

IN ABOVE SPACE DESCRIBE PROPOSED PROGRAM: If proposal is to deepen or plug back, give data on present productive zone and proposed new productive zone. If proposal is to drill or deepen directionally, give pertinent data on subsurface locations and measured and true vertical depths. Give blowout preventer program, if any.

24.

SIGNED

A. G. Dices

TITLE

Drilling Clerk

DATE 12-3-75

(This space for Federal or State office use)

PERMIT NO.

APPROVAL DATE

APPROVED BY

TITLE

CONDITIONS OF APPROVAL, IF ANY:

ok

*See Instructions On Reverse Side

SA

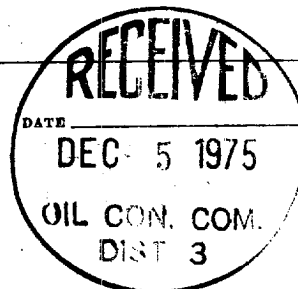

NEW MEXICO OIL CONSERVATION COMMISSION
WELL LOCATION AND ACREAGE DEDICATION PLAT

Form C-102
Supersedes C-128
Effective 1-1-65

All distances must be from the outer boundaries of the Section.

Operator EL PASO NATURAL GAS COMPANY			Lease JICARILLA APACHE TRIBAL JICARILLA D LEASE CONTRACT No. 41		Well No. 9
Unit Letter A	Section 32	Township 25-N	Range 4-W	County RIO ARriba	

Actual Footage Location of Well: 914 feet from the NORTH line and 825 feet from the EAST line					
Ground Level Elev. 6844	Producing Formation PICTURED CLIFFS	Pool SO. BLANCO PICTURED CLIFFS	Dedicated Acreage 160.00 Acres		

1. Outline the acreage dedicated to the subject well by colored pencil or hachure marks on the plat below.
2. If more than one lease is dedicated to the well, outline each and identify the ownership thereof (both as to working interest and royalty).
3. If more than one lease of different ownership is dedicated to the well, have the interests of all owners been consolidated by communitization, unitization, force-pooling, etc?

☐ Yes ☐ No If answer is "yes," type of consolidation _____

If answer is "no," list the owners and tract descriptions which have actually been consolidated. (Use reverse side of this form if necessary.) _____

No allowable will be assigned to the well until all interests have been consolidated (by communitization, unitization, forced-pooling, or otherwise) or until a non-standard unit, eliminating such interests, has been approved by the Commission.

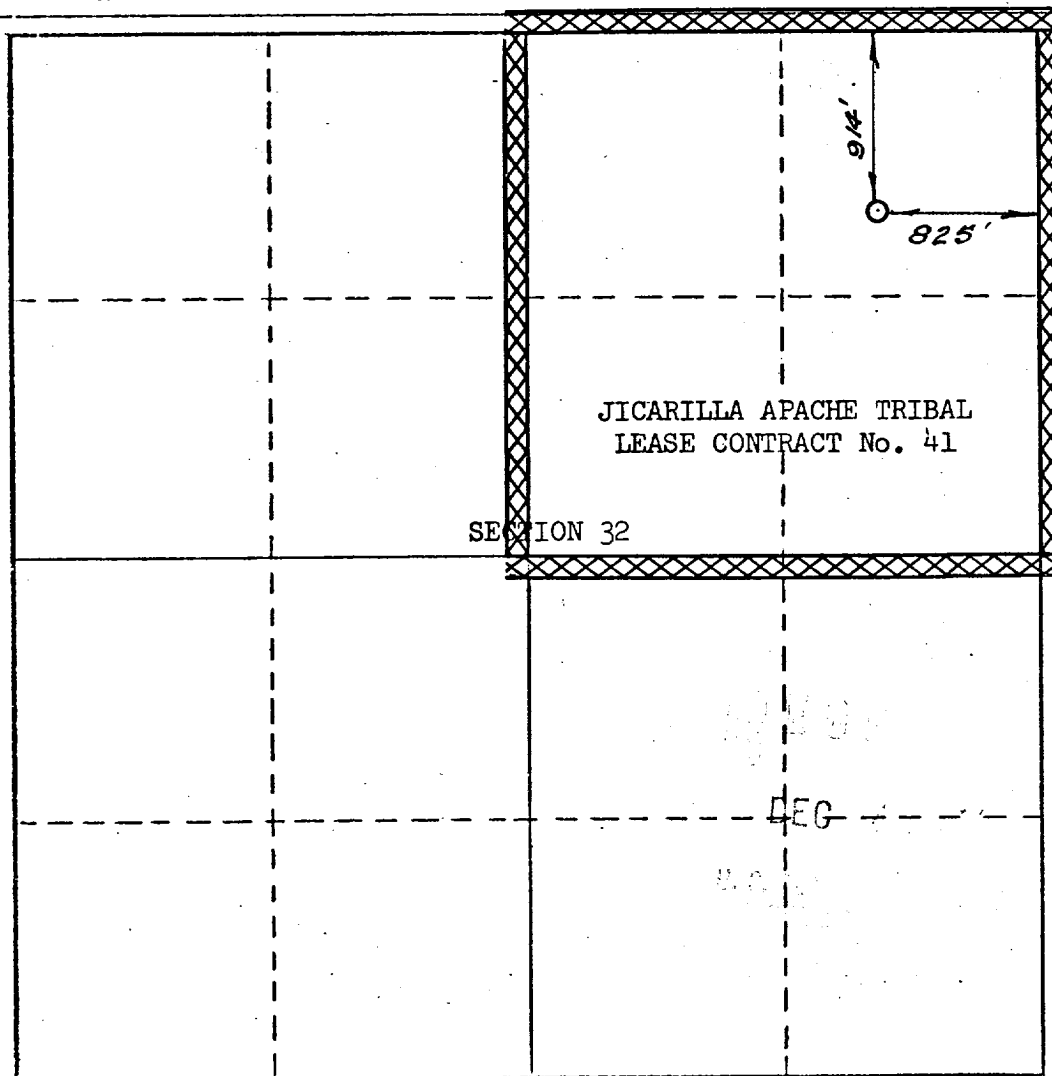

CERTIFICATION

I hereby certify that the information contained herein is true and complete to the best of my knowledge and belief.

Original Signed by
D. G. Drisco

Name

Drilling Clerk

Position

El Paso Natural Gas Co.
Company

December 3, 1975
Date

Date

RECEIVED
DEC 5 1975
I hereby certify that the well location shown on this plat was derived from field notes of actual surveys made by me or under my supervision, and that the same is true and correct to the best of my knowledge and belief.

Date Surveyed

NOVEMBER 21, 1975

Registered Professional Engineer
and/or Land Surveyor

Certificate No. **1760**

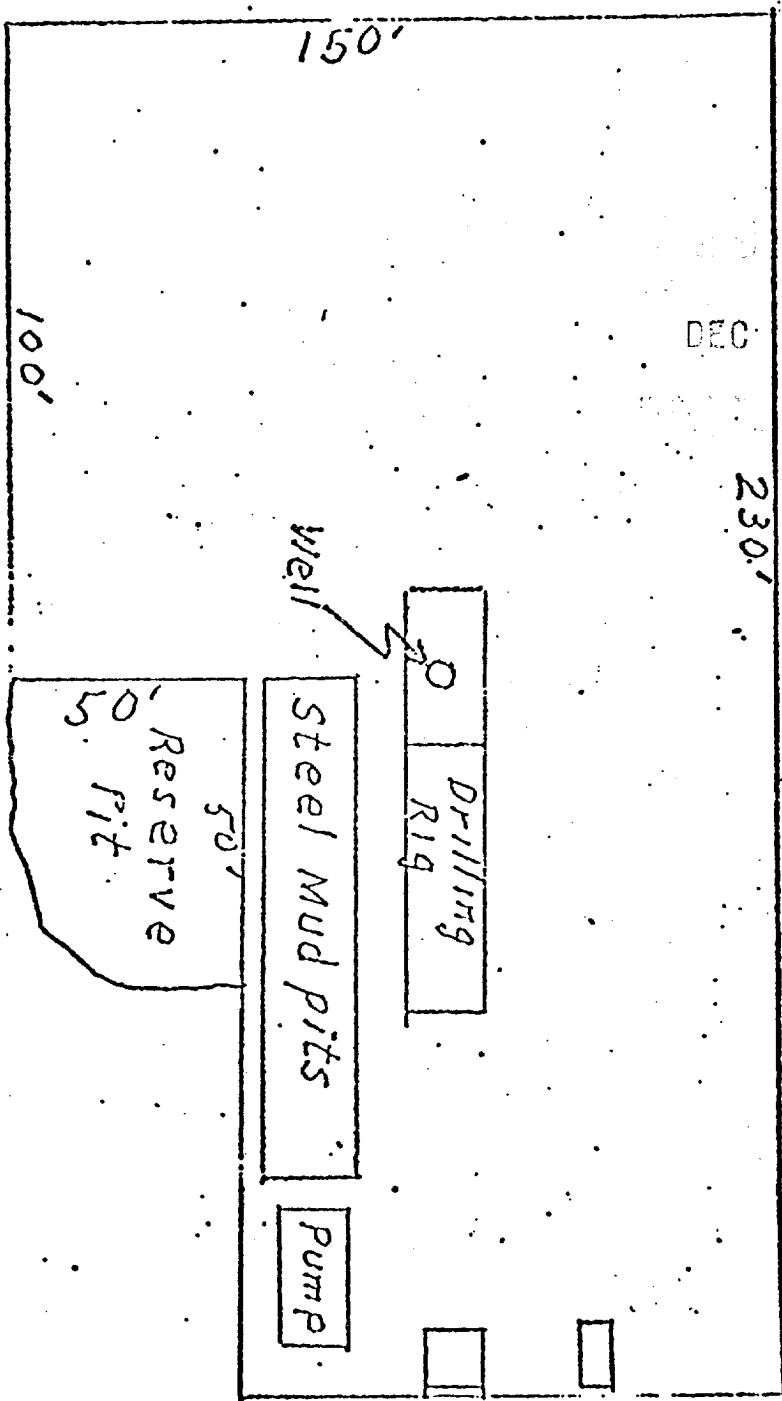

↑ N
 Tiarilla D^H 9
 NE NE 1/4 Sec 32 T-2 S-N R-4-

RECEIVED
 DEC 5 1975
 OIL CON. COM.
 DIST. 3

Juanilla P # 9
 NE 1/4 Sec. 32, T.25-N, R.4-W

R. 4-W

T
 25
 N

T
 24
 N

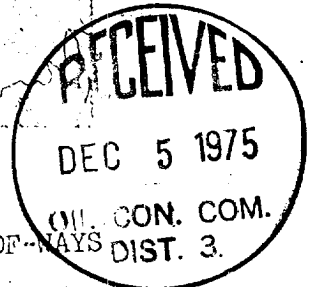
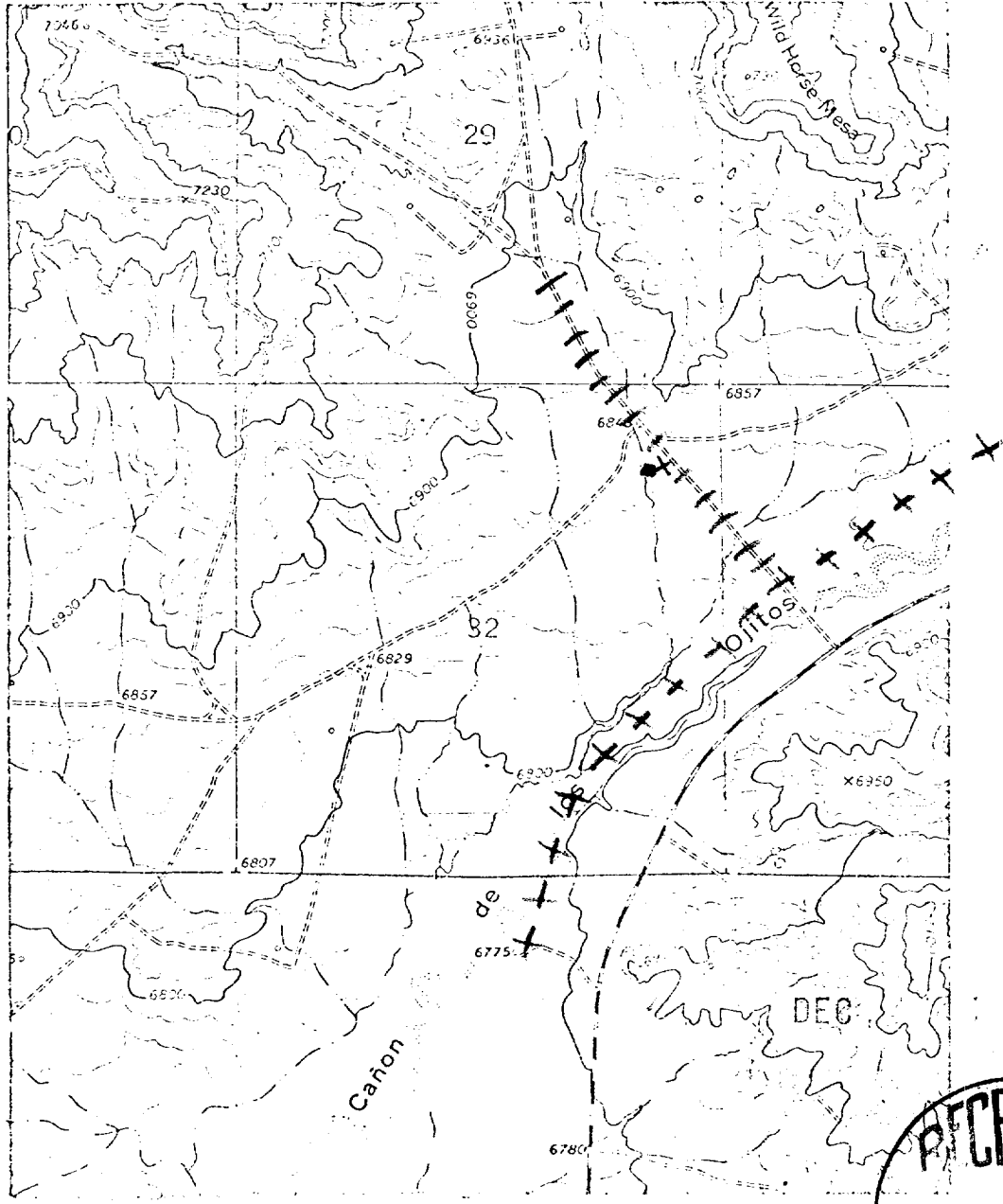

LEGEND OF RIGHT-OF-WAYS

- EXISTING ROADS ————
- EXISTING PIPELINES - - - - -
- EXISTING ROAD & PIPELINE — + + + +
- PROPOSED ROADS ————
- PROPOSED PIPELINES + + + + +
- PROPOSED ROAD & PIPELINE — + + + +