

UNITED STATES
DEPARTMENT OF THE INTERIOR
GEOLOGICAL SURVEY

API - 30-039-21186

APPLICATION FOR PERMIT TO DRILL, DEEPEN, OR PLUG BACK

1. TYPE OF WORK

DRILL ☒

DEEPEN ☐

PLUG BACK ☐

2. TYPE OF WELL

OIL WELL ☐

GAS WELL ☒

OTHER ☐

SINGLE ZONE ☒

MULTIPLE ZONE ☐

3. NAME OF OPERATOR

Manning Gas & Oil Company

4. ADDRESS OF OPERATOR

1660 Lincoln Street, Suite 2322,
Denver, Colorado 80203

5. LOCATION OF WELL (Report location clearly and in accordance with any State requirements.)

At surface

990' FNL, 990' FWL

At proposed prod. zone

Same

6. DISTANCE IN MILES AND DIRECTION FROM NEAREST TOWN OR POST OFFICE*

7. NAME OF LEASE NAME

Apache

8. WELL NO.

16

9. FIELD AND TOWN, OR NEAREST

So. Blanco Pictured

10. SEC. T. R. M. OR BLM. CLIFFS
AND SURVEY OR AREA

Sec. 9-T24N-R4W

NMPM

11. COUNTY OR PARISH

Rio Arriba

12. STATE

N.M.

13. DISTANCE FROM PROPOSED*

LOCATION TO NEAREST

PROPERTY OR LEASE LINE, FT.

(Also to nearest drg. unit line, if any)

990'

14. NO. OF ACRES IN LEASE

2665

15. NO. OF ACRES ASSIGNED

TO THIS WELL

160

16. DISTANCE FROM PROPOSED LOCATION*

TO NEAREST WELL, DRILLING, COMPLETED,
OR APPLIED FOR, ON THIS LEASE, FT.

17. PROPOSED DEPTH

2900

18. RIGARY OR CABLE TOOLS

19. OPERATIONS (Show whether DE, RT, GR, etc.)

6702' GR

20. APPROX. DATE WORK WILL START*

March 5, 1976

21.

PROPOSED CASING AND CEMENTING PROGRAM

SIZE OF HOLE	SIZE OF CASING	WEIGHT PER FOOT	SETTING DEPTH	QUANTITY OF CEMENT
12-1/4	8-5/8	24.0	100	75 sxs
7-7/8	4-1/2	9.50	2900	100 sxs

It is proposed to drill this well with rotary tools using drilling mud for circulation through the Pictured Cliffs Formation. All possible production intervals in the Pictured Cliffs will be completed.

The NW/4 of Section 9 is dedicated to this well.

IN ABOVE SPACE DESCRIBE PROPOSED PROGRAM: If proposal is to deepen or plug back, give data on present productive zone and proposed new productive zone. If proposal is to drill or deepen directionally, give pertinent data on subsurface locations and measured and true vertical depths. Give blowout preventer program, if any.

22. For Manning Gas and Oil Company

President, Walsh Engineering

SIGNED

Ewell N. Walsh, P. E.

TITLE

& Production Corp.

DATE

Feb. 17, 1976

(This space for Federal or State office use)

PERMIT NO.

APPROVAL DATE

APPROVED BY

TITLE

DATE

CONDITIONS OF APPROVAL, IF ANY:

Okal

*See Instructions On Reverse Side

**NEW MEXICO OIL CONSERVATION COMMISSION
WELL LOCATION AND ACREAGE DEDICATION PLAT**

Form C-102
Supersedes C-128
Effective 1-1-65

All distances must be from the outer boundaries of the Section.

Operator MANNING GAS AND OIL COMPANY			Lease APACHE		Well No. 16
Unit Letter D	Section 9	Township 24 NORTH	Range 4 WEST	County RIO ARriba	
Actual Footage Location of Well:					
990 feet from the NORTH line and		990 feet from the WEST line			
Ground Level Elev. 6702	Producing Formation PICTURED CLIFFS	Pool So. Blanco Pictured Cliffs		Dedicated Acreage 160 Acres	

1. Outline the acreage dedicated to the subject well by colored pencil or hachure marks on the plat below.
2. If more than one lease is dedicated to the well, outline each and identify the ownership thereof (both as to working interest and royalty).
3. If more than one lease of different ownership is dedicated to the well, have the interests of all owners been consolidated by communitization, unitization, force-pooling, etc?

☐ Yes ☐ No If answer is "yes," type of consolidation _____

If answer is "no," list the owners and tract descriptions which have actually been consolidated. (Use reverse side of this form if necessary.) _____

No allowable will be assigned to the well until all interests have been consolidated (by communitization, unitization, forced-pooling, or otherwise) or until a non-standard unit, eliminating such interests, has been approved by the Commission.

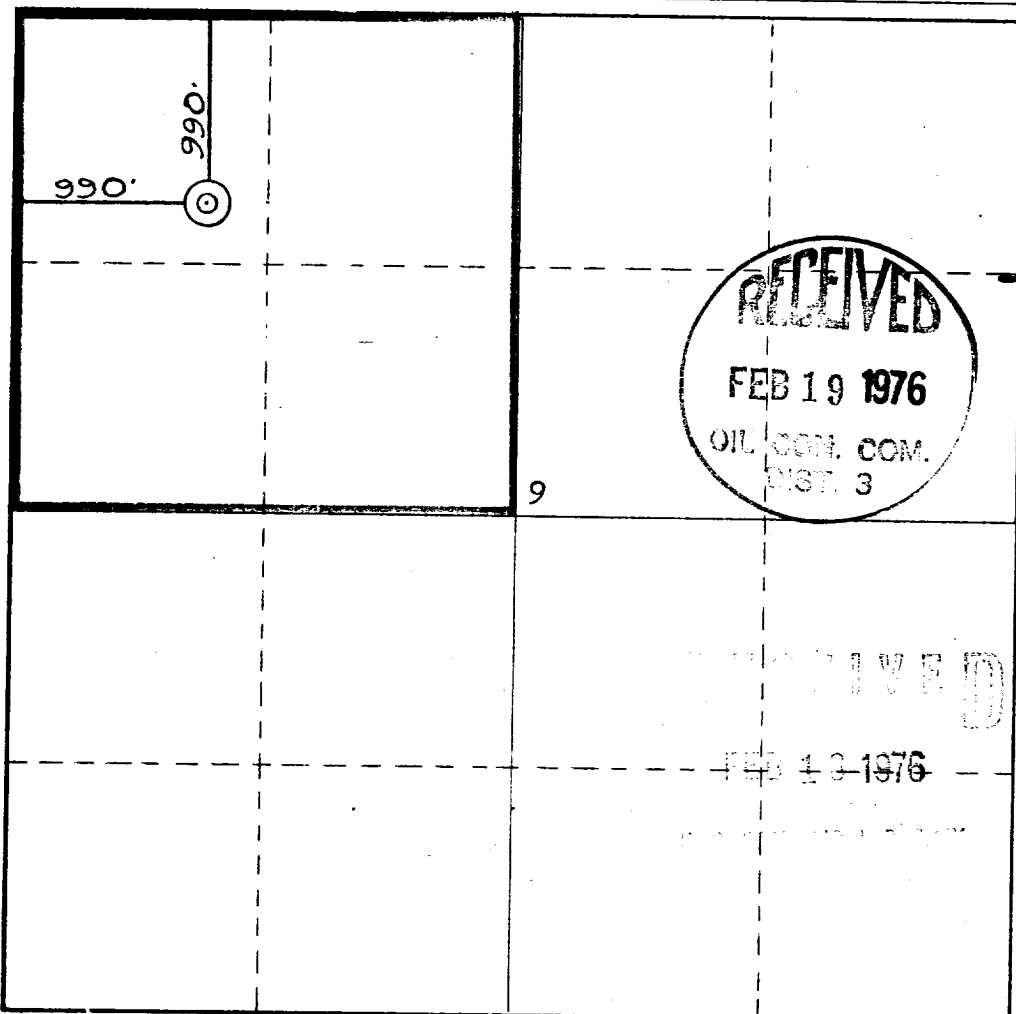

CERTIFICATION

I hereby certify that the information contained herein is true and complete to the best of my knowledge and belief.

For: Manning Gas and Oil Co.

Name Ewell N. Walsh
Position **Ewell N. Walsh, P.E.**

Company **President, Walsh Engr. & Prod. Corp.**

Date **Feb. 17, 1976**

I hereby certify that the well location shown on this plat was plotted from field notes of actual survey made by _____ under my supervision, and that the same is true and correct to the best of my knowledge and belief.

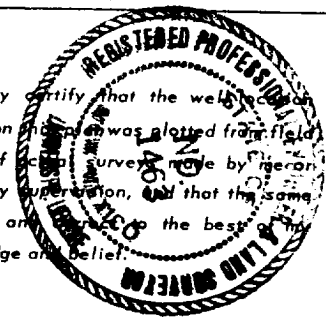

Date Surveyed **12 February 1976**

Registered Professional Engineer and/or Land Surveyor
James P. Leese
James P. Leese

Certificate No. **1463**

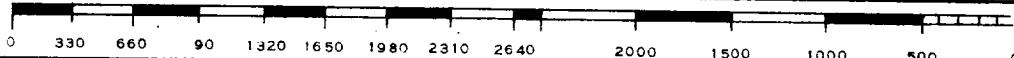

DEVELOPMENT PLAN

MANNING GAS AND OIL COMPANY

APACHE NO. 16

1. Existing roads shown on attached plat.
2. Planned access from existing road is approximately to new location.
3. Location - Apache No. 16
990' FNL, 990' FWL
Section 9-T24N-R4W
Rio Arriba County, New Mexico
4. No additional well is planned on this lease at this time.
5. Production equipment or storage facilities proposed for the well will be installed on location.
6. Water will be obtained from Water Hole in Largo Wash
SW/4 Sec. 9-T24N-R4W..
7. Waste materials will be buried on location or in reserve pit.
8. No permanent camp is planned. A trailer house will be used on location during drilling process.
9. No airstrip proposed.
10. See attached plat for layout.
11. Pits will be filled, location cleaned up, and area not in use for producing well will be reseeded using broadcast method of planting.



DEVELOPMENT PLAN

Manning Gas and Oil Company

Apache No. 16

990' FNL, 990' FWL Sec. 9-T24N-R4W

Rio Arriba County, N.M.

PROPOSED LOCATION LAYOUT

