

UNITED STATES
DEPARTMENT OF THE INTERIORGEOLOGICAL SURVEY **API 30-039-21235**

APPLICATION FOR PERMIT TO DRILL, DEEPEN, OR PLUG BACK

1a. TYPE OF WORK

DRILL ☒DEEPEN ☐PLUG BACK ☐

b. TYPE OF WELL

OIL
WELL ☐GAS
WELL ☒

OTHER

SINGLE
ZONE ☐MULTIPLE
ZONE ☒

2. NAME OF OPERATOR

Amerada Hess Corporation, Att: Drilling Services

3. ADDRESS OF OPERATOR

P.O. Box 2040, Tulsa, Oklahoma 74102

4. LOCATION OF WELL (Report location clearly and in accordance with any State requirements.*)

At surface ⁸⁹⁰₈₉₀~~1320~~⁸⁹⁰ FNL and ~~1320~~⁸⁹⁰ FNL

At proposed prod. zone

same

14. DISTANCE IN MILES AND DIRECTION FROM NEAREST TOWN OR POST OFFICE*

est. 18 miles NW of Lindrith, New Mexico

10. DISTANCE FROM PROPOSED*

LOCATION TO NEAREST
PROPERTY OR LEASE LINE, FT.
(Also to nearest drlg. unit line, if any)

1320'

18. DISTANCE FROM PROPOSED LOCATION*

TO NEAREST WELL, DRILLING, COMPLETED,
OR APPLIED FOR, ON THIS LEASE, FT.

4000'

16. NO. OF ACRES IN LEASE

2560

19. PROPOSED DEPTH

7600'

17. NO. OF ACRES ASSIGNED
TO THIS WELL

320 to Dakota & 160 to Chacra

20. ROTARY OR CABLE TOOLS

Rotary

21. ELEVATIONS (Show whether DF, RT, GR, etc.)

~~6860~~^{6877' 9"} Gr. Elev.

(Proration Unit N/2 of Sec. 36)

22. APPROX. DATE WORK WILL START*

June 15, 1976

23.

PROPOSED CASING AND CEMENTING PROGRAM

SIZE OF HOLE	SIZE OF CASING	WEIGHT PER FOOT	SETTING DEPTH	QUANTITY OF CEMENT
12-1/4"	9-5/8"OD	32.3#	350' +/-	250 sx. and circ.
7-7/8"	5-1/2"OD	15.5#	7600' +/-	850 sx. & est. top @ surface

Plan to drill a 12 1/4" hole from surface to 350', run, set and cement 9-5/8" at 350' with 250 sx. cement (circ. cnt.), WOC approx. 18 hrs., drill out under surface csg. with a 7-7/8" bit to a proposed TD of 7600' or a sufficient depth to test the Dakota gas zone, log well and if productive, complete as a dual gas well with 5 1/2"OD 15.5# csg (new) set and cemented at 7600' with 850 sx. with 2 stage cnt. collar in string.

No cores or drill stem tests are anticipated.

Mud program is to use low visc. and low water loss mud out from under surface csg. to TD with Visc. 60/70 for logging.

Blowout equipment program, 12 point surface usage plan, location maps, plats and drilling rig layout plan to follow under separate cover.

Gas not dedicated
IN ABOVE SPACE DESCRIBE PROPOSED PROGRAM: If proposal is to deepen or plug back, give data on present productive zone and proposed new productive zone. If proposal is to drill or deepen directionally, give pertinent data on subsurface locations and measured and true vertical depths. Give blowout preventer program, if any.

24.

SIGNED

E. L. Grippin

TITLE

Supervisor, Tech/Drlg. Adm. Serv.

DATE

May 4, 1976

(This space for Federal or State office use)

PERMIT NO.

APPROVAL DATE

JUN 3 1976

DATE

APPROVED BY

TITLE

CONDITIONS OF APPROVAL, IF ANY:

*OK*CON. COM.
DIST 3

MAY 7 1976

*See Instructions On Reverse Side

NEW MEXICO OIL CONSERVATION COMMISSION
WELL LOCATION AND ACREAGE DEDICATION PLAT

Form C-102
Supersedes C-128
Effective 1-1-65

All distances must be from the outer boundaries of the Section.

Operator Amerada Hess Corporation			Lease Jicarilla Apache		Well No. A-9
Unit Letter D	Section 36	Township 25N	Range 5W	County Rio Arriba	

Actual Footage Location of Well:

890 feet from the **North** line and **890** feet from the **West** line

Ground Level Elev. 6877	Producing Formation Basin Dakota-Pictured Cliffs	Pool Basin/Dakota-Pictured Cliffs	Dedicated Acreage: see below	Acres
-----------------------------------	--	---	--	-------

- Outline the acreage dedicated to the subject well by colored pencil or hachure marks on the plat below.
- If more than one lease is dedicated to the well, outline each and identify the ownership thereof (both as to working interest and royalty).
- If more than one lease of different ownership is dedicated to the well, have the interests of all owners been consolidated by communitization, unitization, force-pooling, etc?

☐ Yes ☐ No If answer is "yes," type of consolidation NA

If answer is "no," list the owners and tract descriptions which have actually been consolidated. (Use reverse side of this form if necessary.) NA

No allowable will be assigned to the well until all interests have been consolidated (by communitization, unitization, forced-pooling, or otherwise) or until a non-standard unit, eliminating such interests, has been approved by the Commission.

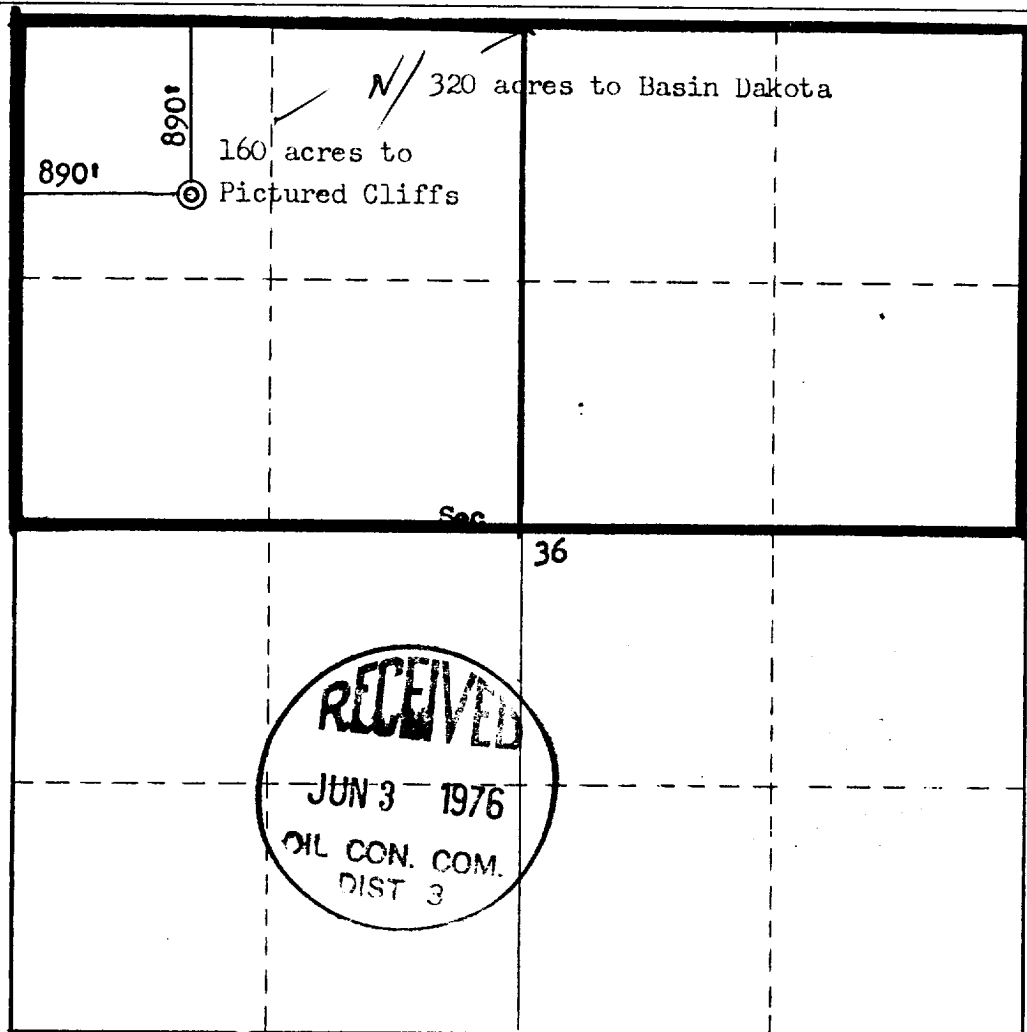

CERTIFICATION

I hereby certify that the information contained herein is true and complete to the best of my knowledge and belief.

E. Griffin

Name **E. Griffin**
Supervisor, Drlg. Adm. Serv.

Position
Amerada Hess Corporation

Company
May 18, 1976

Date

I hereby certify that the well location shown on this plat was plotted from field notes of actual surveys made by me or under my supervision, and that the same is true and correct to the best of my knowledge and belief.

Date Surveyed

May 12, 1976

Registered Professional Engineer and/or Land Surveyor

Fred B. Kern Jr.
Fred B. Kern Jr.

Certificate No.

3950

