

UNITED STATES  
DEPARTMENT OF THE INTERIOR  
GEOLOGICAL SURVEY

## APPLICATION FOR PERMIT TO DRILL, DEEPEN, OR PLUG BACK

## 1a. TYPE OF WORK

DRILL ☒DEEPEN ☐PLUG BACK ☐

## b. TYPE OF WELL

OIL  
WELL ☐GAS  
WELL ☒

OTHER

SINGLE  
ZONE ☐MULTIPLE  
ZONE ☒

## 2. NAME OF OPERATOR

CONTINENTAL OIL COMPANY

## 3. ADDRESS OF OPERATOR

Box 460, HOBBS, N.M. 88240

## 4. LOCATION OF WELL (Report location clearly and in accordance with any State requirements.)\*

At surface

790' FSL &amp; 990' FEL OF SEC. 12

At proposed prod. zone

SAME

## 14. DISTANCE IN MILES AND DIRECTION FROM NEAREST TOWN OR POST OFFICE\*

## 15. DISTANCE FROM PROPOSED\*

LOCATION TO NEAREST

PROPERTY OR LEASE LINE, FT.

(Also to nearest drlg. unit line, if any)

## 18. DISTANCE FROM PROPOSED LOCATION\*

TO NEAREST WELL, DRILLING, COMPLETED,  
OR APPLIED FOR, ON THIS LEASE, FT.

## 21. ELEVATIONS (Show whether DF, RT, GR, etc.)

7289' GR

## 23.

## PROPOSED CASING AND CEMENTING PROGRAM

SIZE OF HOLE	SIZE OF CASING	WEIGHT PER FOOT	SETTING DEPTH	QUANTITY OF CEMENT
12 1/2"	8 5/8"	24 #	500'	310 SX CIRC.
7 7/8"	5 1/2"	14 # 15.5 #	6250'	525 SX

IT IS Proposed to Drill a straight hole to A  
TD OF 6250' and complete as a dual Gas  
Well IN THE MESA VERDE f' S. Blanco-PC.  
Mud Program 1 0-500', Fresh Water; 500-6250'  
Fresh Water Gal 8.5-9.0 #.  
See Attached For B.O.P. Program.  
Acreage is Dedicated to A Gas Purchase.

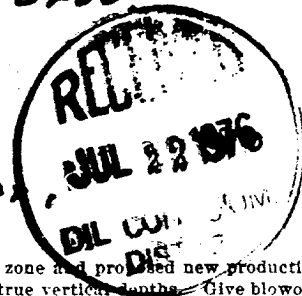

IN ABOVE SPACE DESCRIBE PROPOSED PROGRAM: If proposal is to deepen or plug back, give data on present productive zone and proposed new productive zone. If proposal is to drill or deepen directionally, give pertinent data on subsurface locations and measured and true vertical depths. Give blowout preventer program, if any.

## 24.

SIGNED

TITLE

ADMIN. SUPERVISOR

DATE

7-16-76

(This space for Federal or State office use)

PERMIT NO.

APPROVAL DATE

APPROVED BY

TITLE

DATE

CONDITIONS OF APPROVAL, IF ANY:

**NEW MEXICO OIL CONSERVATION COMMISSION  
WELL LOCATION AND ACERAGE DEDICATION PLAT**

JUL 19 1976

All distances must be from the outer boundaries of the Section

Operator <b>CONTINENTAL OIL COMPANY</b>			Lease <b>AXI APACHE</b>		Well No. <b>N - 11</b>
Unit Letter <b>P</b>	Section <b>12</b>	Township <b>25 NORTH</b>	Range <b>4 WEST</b>	County <b>RIO ARriba</b>	
Actual Footage Location of Well: <div style="display: flex; justify-content: space-between;"> <span><b>790</b> feet from the <b>SOUTH</b> line and</span> <span><b>990</b> feet from the <b>EAST</b> line</span> </div>					
Ground Level Elev. <b>7289</b>	Producing Formation <b>Undesignated Mesa Verde</b>			Pool <b>AXI APACHE</b>	Dedicated Acreage: <b>160</b> Acres

1. Outline the acreage dedicated to the subject well by colored pencil or hachure marks on the plat below.
2. If more than one lease is dedicated to the well, outline each and identify the ownership thereof (both as to working interest and royalty).
3. If more than one lease of different ownership is dedicated to the well, have the interests of all owners been consolidated by communitization, unitization, force-pooling, etc?

( ) Yes ( ) No If answer is "yes," type of consolidation .....

If answer is "no," list the owners and tract descriptions which have actually consolidated. (Use reverse side of this Form if necessary.) .....

No allowable will be assigned to the well until all interests have been consolidated (by communitization, unitization, forced-pooling, or otherwise) or until a non standard unit, eliminating such interests, has been approved by the Commission.

**CERTIFICATION**

I hereby certify that the information contained herein is true and complete to the best of my knowledge and belief.

*Wm. A. Butler*  
Name

Position  
**ADMIN. SUPV.**  
Company  
**CONTINENTAL OIL CO.**

Date  
**7-16-76**

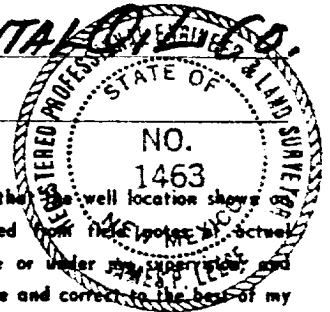

I hereby certify that the well location shown on this plat was plotted from the spot or actual surveys made by me or under my supervision and that the same is true and correct to the best of my knowledge and belief.

**7 July 1976**

Date Surveyed  
*James P. Leese*  
Registered Professional Engineer  
and/or Land Surveyor **James P. Leese**

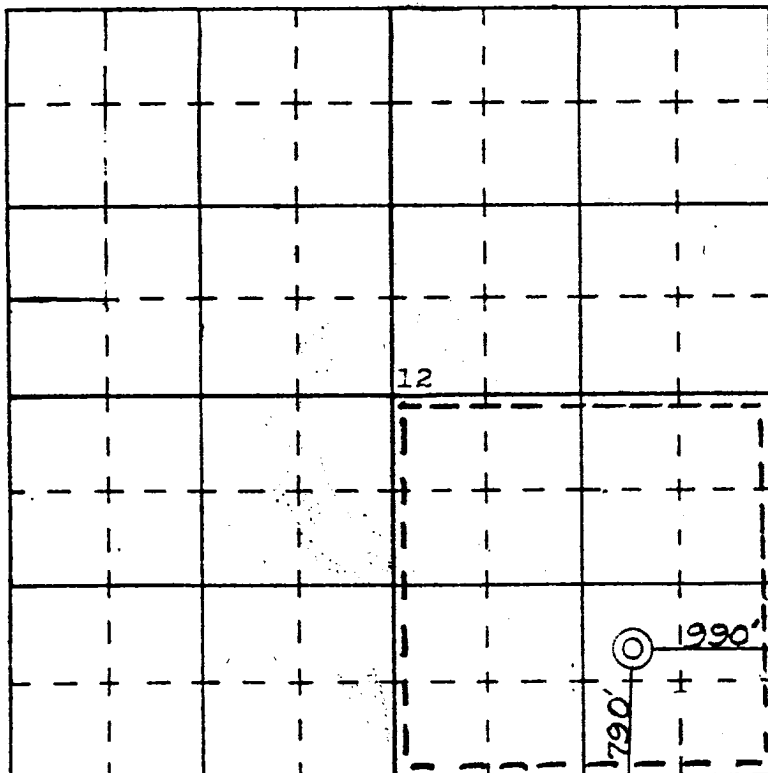

N

**1463**  
Certificate No.