



STATE OF NEW MEXICO
ENERGY, MINERALS AND NATURAL RESOURCES DEPARTMENT
OIL CONSERVATION DIVISION

GARREY CARRUTHERS
GOVERNOR

November 28, 1990

POST OFFICE BOX 2088
STATE LAND OFFICE BUILDING
SANTA FE, NEW MEXICO 87504
(505) 827-5800

Meridian Oil, Inc.
P.O. Box 4289
Farmington, NM 87499-4289

Attention: Peggy Bradfield

RECEIVED
DEC 3 1990
OIL CON. DIV.]
DIST. 3

Administrative Order NSL-2952

Dear Ms. Bradfield:

Reference is made to your application dated October 22, 1990 for a non-standard Basin-Fruitland coal gas well location for your existing Jicarilla "123" C Well No. 26 which was drilled in 1977 and completed in the South Blanco Pictured Cliffs Pool at a standard gas well location 1500 feet from the South line and 1812 feet from the East line (Unit J) of Section 8, Township 25 North, Range 4 West, NMPM, Rio Arriba County, New Mexico.

It is my understanding that the Pictured Cliffs zone will be properly plugged back and said well will be recompleted to the Basin-Fruitland Coal Gas Pool, which pursuant to the Special Rules and Regulations for the Basin-Fruitland Coal Gas Pool as promulgated by Division Order No. R-8768, is unorthodox. Further, the E/2 of said Section 8 shall be dedicated to the well forming a standard 320-acre gas spacing and proration unit for said pool.

By the authority granted me under the provisions of Rule 8 of said Division Order No. R-8768, the above-described unorthodox coal gas well location is hereby approved.

Sincerely,

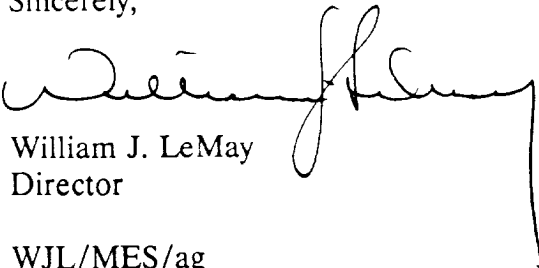
William J. LeMay
Director

WJL/MES/ag

cc: Oil Conservation Division - Aztec
US Bureau of Land Management - Farmington



STATE OF NEW MEXICO
ENERGY AND MINERALS DEPARTMENT
OIL CONSERVATION DIVISION
AZTEC DISTRICT OFFICE

1000 RIO ABASCO ROAD
AZTEC, NEW MEXICO 87410
(505) 334-6178

ARREY CAPROTHERS
GOVERNOR

Date: 11-26-90

Oil Conservation Division
P.O. Box 2088
Santa Fe, NM 87504-2088

ATTN: M. Stogner

Re: Proposed HC _____
Proposed DHC _____
Proposed NSL X _____
Proposed SWD _____
Proposed WFX _____
Proposed PMX _____

Gentlemen:

I have examined the application dated 10-25-90
for the Mendon Pipeline, Tlacuilla 123 C #26
Operator Lease & Well No.

J-8-25N-4W and my recommendations are as follows:
Unit, S-T-R

Approved

Yours truly,

Eric Basel

MERIDIAN OIL

October 22, 1990

Federal Express

Mr. William LeMay
New Mexico Oil Conservation Division
310 Old Santa Fe Trail
Santa Fe, New Mexico 87503

RECEIVED

OCT 25 1990

OIL CON. DIV.
DIST. 3

RE: Jicarilla 123 C #26
1500'FSL, 1812'FEL
Section 08, T-25-N, R-04-W
Rio Arriba County, New Mexico

Dear Mr. LeMay:

This is a request for administrative approval for a non-standard gas well location in the Basin Fruitland Pool.

Meridian Oil intends to plugback and recomplete the Jicarilla 123 C #26 well from the Pictured Cliffs pool to the Basin Fruitland Coal Pool. The current location of this well is 1500'FSL, 1812'FEL, Section 08, T-25-N, R-04-W, Rio Arriba County, New Mexico. The well is considered non-standard due to the NE-SW dedicated pattern established for the Basin Fruitland Coal Pool. To comply with the New Mexico Oil Conservation Division rules, Meridian is submitting the following for your approval of this non-standard location:

1. C-102 plat showing location of the well;
2. Plat showing offset owners/operators;
3. Affidavit of notification of offset owners/operators;
4. Copy of Well Completion Log for original completion.

A copy of this application is being submitted to all offset owners/operators by certified mail with a request that they furnish your Santa Fe office with a Waiver of Objection, and return one copy to this office.

Sincerely yours,

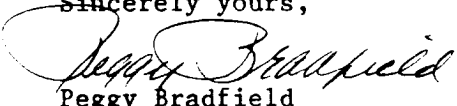
Peggy Bradfield
encl.

WAIVER

_____ hereby waives objection to Meridian Oil Inc.'s application for a non-standard location for their Jicarilla 123 C #26 as proposed above.

By: _____ Date: _____

xc: Conoco Inc.

Jicarilla 123 C #26
1500'FSL, 1812'FEL
Section 08, T-25-N, R-04-W
Rio Arriba County, New Mexico

I hereby certify that the following offset owners/operators have been notified by certified mail of our application for administrative approval for non-standard gas well location for the plugback and recompletion of the above well.

Conoco Inc.
P.O. Box 2197
Houston, TX 77252

A handwritten signature in cursive script, reading "Peggy A. Bradfield".

Peggy Bradfield
October 22, 1990

San Juan County
State of New Mexico

My commission expires August 17, 1992

MERIDIAN OIL INC

Well Name Jicarilla 123 C #26

Footage 1500' FSL; 1812' FEL

APPLICATION FOR NON-STANDARD LOCATION

County Rio Arriba State New Mexico Section 8 Township 25 N Range 4 W

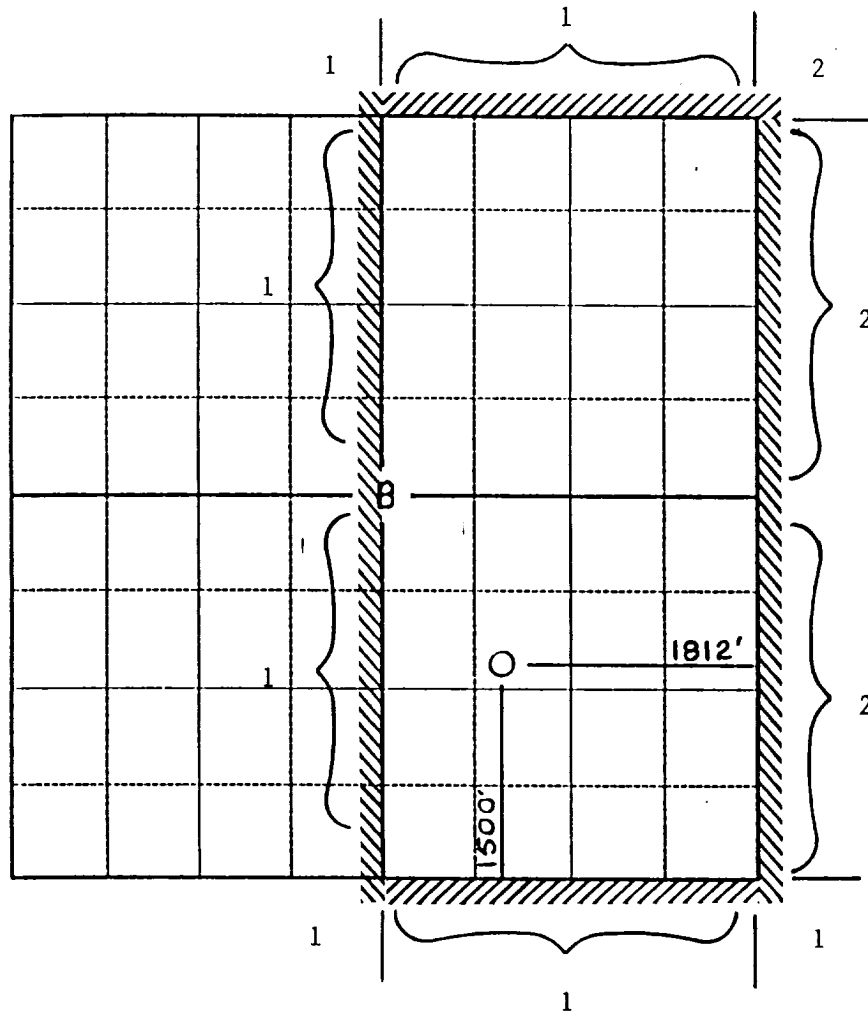

Remarks 1) Meridian Oil Inc.

2) Conoco Inc.

Submit to Appropriate
District Office
State Leases - 4 copies
Fee Leases - 3 copies

State of New Mexico
Energy, Minerals and Natural Resources Department

Form C-102
Revised 1-1-89

OIL CONSERVATION DIVISION

P.O. Box 2088

Santa Fe, New Mexico 87504-2088

DISTRICT I

P.O. Box 1980, Hobbs, NM 88240

DISTRICT II

P.O. Drawer DD, Artesia, NM 88210

DISTRICT III

1000 Rio Brizos Rd., Aztec, NM 87410

WELL LOCATION AND ACREAGE DEDICATION PLAT

All Distances must be from the outer boundaries of the section

Operator Meridian Oil inc.		Lease Jicarilla 123 C (Jic.ConT123)		Well No. 26
Unit Letter J	Section 8	Township 25 North	Range 4 West	County Rio Arriba
Actual Footage Location of Well: 1500 feet from the South line and 1812 feet from the East line				
Ground level Elev. 7297'	Producing Formation Fruitland Coal		Pool Basin	Dedicated Acreage: 320 Acres

1. Outline the acreage dedicated to the subject well by colored pencil or hectline marks on the plat below.

2. If more than one lease is dedicated to the well, outline each and identify the ownership thereof (both as to working interest and royalty).

3. If more than one lease of different ownership is dedicated to the well, have the interest of all owners been consolidated by communitization, unitization, force-pooling, etc.?

☐ Yes ☐ No If answer is "yes" type of consolidation

If answer is "no" list the owners and tract descriptions which have actually been consolidated. (Use reverse side of this form if necessary).

No allowable will be assigned to the well until all interests have been consolidated (by communitization, unitization, forced-pooling, or otherwise) or until a non-standard unit, encompassing such interest, has been approved by the Division.

Not resurveyed
Prepared from plat
By: David O. Vilven
Dated: Oct. 13, 1976

OPERATOR CERTIFICATION

I hereby certify that the information contained herein is true and complete to the best of my knowledge and belief.

Signature

Peggy Bradfield

Printed Name

Regulatory Affairs

Position

Meridian Oil Inc.

Company

Date

SURVEYOR CERTIFICATION

I hereby certify that the well location shown on this plat was plotted from field notes of actual surveys made by me or under my supervision, and that the same is true and correct to the best of my knowledge and belief.

10-20-90

Date Surveyed

Signature

Professional Surveyor

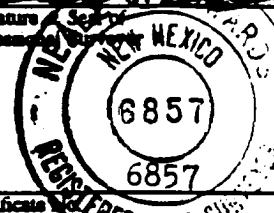

Certificate

Neale & Edwards

0 330 660 990 1320 1650 1980 2310 2640 2000 1500 1000 500 0

UNITED STATES
DEPARTMENT OF THE INTERIOR
GEOLOGICAL SURVEY

SUBMIT IN DUPLICATE*

(See other in-
structions on
reverse side)Form approved.
Budget Bureau No. 42-R355.6.

WELL COMPLETION OR RECOMPLETION REPORT AND LOG *

1. TYPE OF WELL: OIL WELL <input type="checkbox"/> GAS WELL <input checked="" type="checkbox"/> DRY <input type="checkbox"/> Other _____				5. LEASE DESIGNATION AND SERIAL NO. Jicarilla Apache Tribal Cont. #123																															
2. NAME OF OPERATOR Northwest Production Corp.				6. IF INDIAN, ALLOTTEE OR TRIBE NAME Jicarilla Apache																															
3. ADDRESS OF OPERATOR P. O. Box 990, Farmington, New Mexico 87401				7. UNIT AGREEMENT NAME																															
4. LOCATION OF WELL (Report location clearly and in accordance with any State requirements)* At surface 1500' S, 1812' E At top prod. interval reported below At total depth				8. FARM OR LEASE NAME Jicarilla 123 C																															
14. PERMIT NO. _____ DATE ISSUED _____				9. WELL NO. 26																															
15. DATE SPUDDED 04-27-77 16. DATE T.D. REACHED 05-03-77 17. DATE COMPL. (Ready to prod.) 06-30-77 18. ELEVATIONS (OF. R&B, RT. GR, ETC.)* 7297' GL 19. ELEV. CASINGHEAD				10. FIELD AND POOL, OR WILDCAT So. Blanco P.C.																															
20. TOTAL DEPTH, MD & TVD 3850' 21. PLUG. BACK T.D., MD & TVD 3839' 22. IF MULTIPLE COMPL., HOW MANY* 23. INTERVALS DRILLED BY 0-3850' 24. PRODUCING INTERVAL(S), OF THIS COMPLETION—TOP, BOTTOM, NAME (MD AND TVD)* 3720-76 (PC) 25. WAS DIRECTIONAL SURVEY MADE No				11. SEC., T., R., M., OR BLOCK AND SURVEY OR AREA Sec. 8, T-25-N, R-4-W NMPM																															
26. TYPE ELECTRIC AND OTHER LOGS RUN IEL; CDL-GR; Temperature Survey				12. COUNTY OR PARISH Rio Arriba																															
27. WAS WELL CORED No				13. STATE New Mexico																															
28. CASING RECORD (Report all strings set in well)																																			
<table border="1" style="width:100%"><thead><tr><th>CASING SIZE</th><th>WEIGHT, LB./FT.</th><th>DEPTH SET (MD)</th><th>HOLE SIZE</th><th>CEMENTING RECORD</th><th>AMOUNT PULLED</th></tr></thead><tbody><tr><td>8 5/8"</td><td>24#</td><td>140'</td><td>12 1/4"</td><td>106 cf</td><td></td></tr><tr><td>2 7/8"</td><td>6.4#</td><td>3850'</td><td>6 3/4"</td><td>203 cf</td><td></td></tr><tr><td> </td><td> </td><td> </td><td> </td><td> </td><td> </td></tr><tr><td> </td><td> </td><td> </td><td> </td><td> </td><td> </td></tr></tbody></table>						CASING SIZE	WEIGHT, LB./FT.	DEPTH SET (MD)	HOLE SIZE	CEMENTING RECORD	AMOUNT PULLED	8 5/8"	24#	140'	12 1/4"	106 cf		2 7/8"	6.4#	3850'	6 3/4"	203 cf													
CASING SIZE	WEIGHT, LB./FT.	DEPTH SET (MD)	HOLE SIZE	CEMENTING RECORD	AMOUNT PULLED																														
8 5/8"	24#	140'	12 1/4"	106 cf																															
2 7/8"	6.4#	3850'	6 3/4"	203 cf																															
29. LINER RECORD																																			
<table border="1" style="width:100%"><thead><tr><th>SIZE</th><th>TOP (MD)</th><th>BOTTOM (MD)</th><th>SACKS CEMENT*</th><th>SCREEN (MD)</th></tr></thead><tbody><tr><td> </td><td> </td><td> </td><td> </td><td> </td></tr><tr><td> </td><td> </td><td> </td><td> </td><td> </td></tr></tbody></table>						SIZE	TOP (MD)	BOTTOM (MD)	SACKS CEMENT*	SCREEN (MD)																									
SIZE	TOP (MD)	BOTTOM (MD)	SACKS CEMENT*	SCREEN (MD)																															
30. TUBING RECORD																																			
<table border="1" style="width:100%"><thead><tr><th>SIZE</th><th>DEPTH SET (MD)</th><th>PACKER SET (MD)</th></tr></thead><tbody><tr><td>tubingless</td><td> </td><td> </td></tr></tbody></table>						SIZE	DEPTH SET (MD)	PACKER SET (MD)	tubingless																										
SIZE	DEPTH SET (MD)	PACKER SET (MD)																																	
tubingless																																			
31. PERFORATION RECORD (Interval, size and number) 3702', 3706', 3753', 3758', 3766', 3771', 3776' with 1 shot per zone																																			
32. ACID, SHOT, FRACTURE, CEMENT SQUEEZE, ETC.																																			
<table border="1" style="width:100%"><thead><tr><th>DEPTH INTERVAL (MD)</th><th>AMOUNT AND KIND OF MATERIAL USED</th></tr></thead><tbody><tr><td>3702 - 3776'</td><td>32,000# sd; 32,000 gallons wtr.</td></tr><tr><td> </td><td> </td></tr><tr><td> </td><td> </td></tr></tbody></table>						DEPTH INTERVAL (MD)	AMOUNT AND KIND OF MATERIAL USED	3702 - 3776'	32,000# sd; 32,000 gallons wtr.																										
DEPTH INTERVAL (MD)	AMOUNT AND KIND OF MATERIAL USED																																		
3702 - 3776'	32,000# sd; 32,000 gallons wtr.																																		
33. PRODUCTION																																			
DATE FIRST PRODUCTION _____ PRODUCTION METHOD (Flowing, gas lift, pumping—size and type of pump) _____ WELL STATUS (Producing or shut-in) Shut-in																																			
DATE OF TEST 06-30-77 HOURS TESTED 3 CHOKE SIZE 3/4" PROD'N. FOR TEST PERIOD _____ OIL—BBL. _____ GAS—MCF. _____ WATER—BBL. _____ GAS-OIL RATIO _____																																			
FLOW. TUBING PRESS. _____ CASING PRESSURE SI 1011 CALCULATED 24-HOUR RATE _____ OIL—BBL. _____ GAS—MCF. 249 MCF/D ADF WATER—BBL. _____ OIL GRAVITY-API (CORR.) _____																																			
34. DISPOSITION OF GAS (Sold, used for fuel, vented, etc.) _____ TEST WITNESSED BY David Howell																																			
35. LIST OF ATTACHMENTS _____																																			
36. I hereby certify that the foregoing and attached information is complete and correct as determined from all available records																																			
SIGNED <u>A. G. Bueso</u> TITLE Drilling Clerk DATE July 8, 1977																																			

*(See Instructions and Spaces for Additional Data on Reverse Side)