

UNITED STATES
DEPARTMENT OF THE INTERIOR
GEOLOGICAL SURVEY

30-039-21302

5. LEASE DESIGNATION AND SERIAL NO.

Jicarilla

6. IF INDIAN, ALLOTTEE OR TRIBE NAME

Tribal

7. UNIT AGREEMENT NAME

8. FARM OR LEASE NAME

Jicarilla 35

9. WELL NO.

5

10. FIELD AND POOL, OR WILDCAT
Blanco Pictured Cliffs
South Otero Chacra11. SEC., T., R., M., OR BLK.
AND SURVEY OR AREA

Sec. 36-T25N-R5W

12. COUNTY OR PARISH 13. STATE

Rio Arriba N. Mexico

APPLICATION FOR PERMIT TO DRILL, DEEPEN OR PLUG BACK

1a. TYPE OF WORK

DRILL ☒DEEPEN ☐PLUG BACK ☐

b. TYPE OF WELL

OIL
WELL ☐GAS
WELL ☒

OTHER

NOV 20 1976
SINGLE
ZONE ☐MULTIPLE
ZONE ☐

2. NAME OF OPERATOR

Energy Reserves Group, Inc.

3. ADDRESS OF OPERATOR

P. O. Box 3280, Casper, WY 82602

4. LOCATION OF WELL (Report location clearly and in accordance with any State requirements.)

At surface

1600' FSL, 1650' FEL (NW SE)

At proposed prod. zone

14. DISTANCE IN MILES AND DIRECTION FROM NEAREST TOWN OR POST OFFICE*

32 miles from Cuba, New Mexico

10. DISTANCE FROM PROPOSED*

LOCATION TO NEAREST
PROPERTY OR LEASE LINE, FT.
(Also to nearest drlg. unit line, if any)

1090'

16. NO. OF ACRES IN LEASE

2515.80

17. NO. OF ACRES ASSIGNED
TO THIS WELL

160

18. DISTANCE FROM PROPOSED LOCATION*
TO NEAREST WELL, DRILLING, COMPLETED,
OR APPLIED FOR, ON THIS LEASE, FT.

2700'

19. PROPOSED DEPTH

3900'

20. ROTARY OR CABLE TOOLS

Rotary

21. ELEVATIONS (Show whether DF, RT, GR, etc.)

6871' GRD

22. APPROX. DATE WORK WILL START*

December 1976

23.

PROPOSED CASING AND CEMENTING PROGRAM

SIZE OF HOLE	SIZE OF CASING	WEIGHT PER FOOT	SETTING DEPTH	QUANTITY OF CEMENT
12-1/4	8-5/8	24#	200	150 sks
7-7/8	5-1/2	14#	3900	300 sks

Energy Reserves Group, Inc. proposes to drill above described well with rotary tools from surface to TD. It is anticipated that the Pictured Cliffs and Chacra formations will be gas productive. No cores or DST's are planned. Copies of all logs run will be furnished upon completion of the well. The estimated tops are as follows:

OJA - Alamo - 2430'
Kirtland - 2600'
Fruitland - 2850'

Pictured Cliffs - 2940'
Lewis - 2990'
Chacra - 3810'
T.D. - 3900'

A series 600 or 900 BOP will be used while drilling this well. The Picture Cliffs gas is dedicated and the Chacra gas is not. It is planned to produce the Chacra through tubing and under a packer. It is planned to produce the Pictured Cliffs up the annulus.

IN ABOVE SPACE DESCRIBE PROPOSED PROGRAM: If proposal is to deepen or plug back, give data on present productive zone and proposed new productive zone. If proposal is to drill or deepen directionally, give pertinent data on subsurface locations and measured and true vertical depths. Give blowout preventer program, if any.

24.

SIGNED

Heary B. Bame

TITLE Dist. Prod. Engr.- RMD DATE 11-23-76

(This space for Federal or State office use)

PERMIT NO.

APPROVAL DATE

APPROVED BY

CONDITIONS OF APPROVAL, IF ANY:

TITLE

*See Instructions On Reverse Side

State

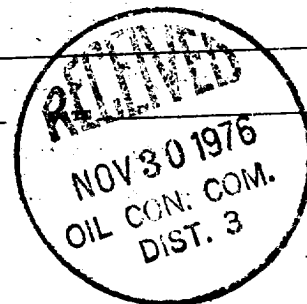

**NEW MEXICO OIL CONSERVATION COMMISSION
WELL LOCATION AND ACREAGE DEDICATION PLAT**

Form C-102
Supersedes C-128
Effective 1-1-65

All distances must be from the outer boundaries of the Section.

Operator Energy Reserves Group, Inc.			Lease Jicarilla 35		Well No. 5
Unit Letter J	Section 36	Township 25 North	Range 5 West	County Rio Arriba	
Actual Footage Location of Well: <div style="display: flex; justify-content: space-between;"> 1600 feet from the South line and 1650 feet from the East line </div>					
Ground Level Elev. 6871	Producing Formation Blanco Pic. Cliffs		Pool South-Otero Chacra		Dedicated Acreage: 160 Acres

1. Outline the acreage dedicated to the subject well by colored pencil or hachure marks on the plat below.
2. If more than one lease is dedicated to the well, outline each and identify the ownership thereof (both as to working interest and royalty).
3. If more than one lease of different ownership is dedicated to the well, have the interests of all owners been consolidated by communitization, unitization, force-pooling, etc?

☐ Yes ☐ No If answer is "yes," type of consolidation _____

If answer is "no," list the owners and tract descriptions which have actually been consolidated. (Use reverse side of this form if necessary.) _____

No allowable will be assigned to the well until all interests have been consolidated (by communitization, unitization, forced-pooling, or otherwise) or until a non-standard unit, eliminating such interests, has been approved by the Commission.

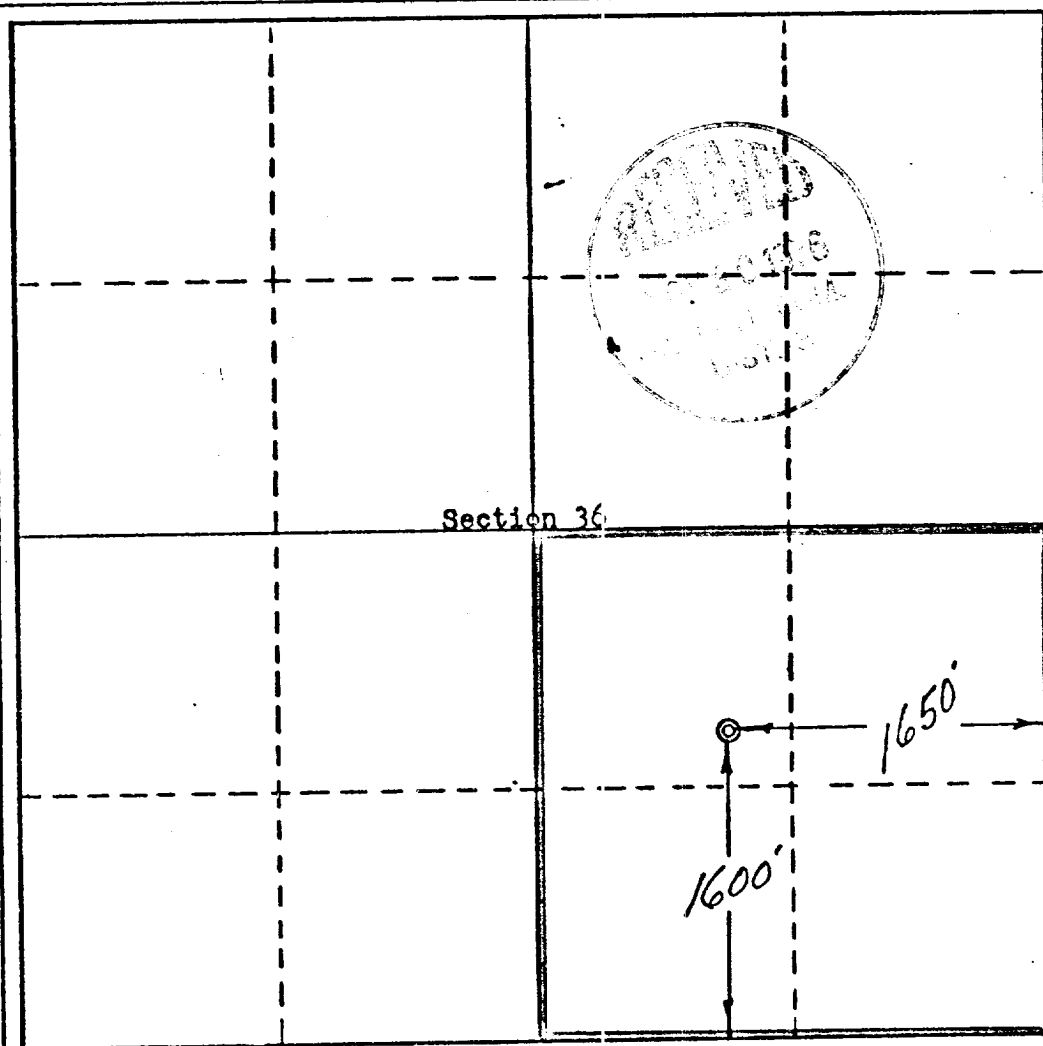

CERTIFICATION

I hereby certify that the information contained herein is true and complete to the best of my knowledge and belief.

Name *Hean B. Barner*
 Position Dist. Prod. Engr.- RMD
 Company Energy Reserves Group, Inc
 Date 11-23-76

I hereby certify that the well location shown on this plat was plotted from field notes of actual surveys made by me or under my supervision, and that the same is true and correct to the best of my knowledge and belief.

Date Surveyed October 7, 1976
 Registered Professional Engineer and Land Surveyor *[Signature]*
 Certificate No. 3084

