

UNITED STATES  
DEPARTMENT OF THE INTERIOR  
GEOLOGICAL SURVEY

## APPLICATION FOR PERMIT TO DRILL, DEEPEN, OR PLUG BACK

## 1a. TYPE OF WORK

DRILL ☒DEEPEN ☐PLUG BACK ☐

## b. TYPE OF WELL

OIL  
WELL ☐GAS  
WELL ☒

OTHER

SINGLE  
ZONE ☒MULTIPLE  
ZONE ☐

## 2. NAME OF OPERATOR

Amerada Hess Corporation

## 3. ADDRESS OF OPERATOR

Box 2040 - Tulsa, Oklahoma 74102 Att'm Drlg. Svcs.

## 4. LOCATION OF WELL (Report location clearly and in accordance with any State requirements.)

At surface

890' FNL, 1750' FEL

At proposed prod. zone

Same

## 14. DISTANCE IN MILES AND DIRECTION FROM NEAREST TOWN OR POST OFFICE\*

Est. 18 miles NW of Lindrith NM

## 15. DISTANCE FROM PROPOSED\*

LOCATION TO NEAREST  
PROPERTY OR LEASE LINE, FT.  
(Also to nearest drlg. unit line, if any)

## 16. NO. OF ACRES IN LEASE

2560'

17. NO. OF ACRES ASSIGNED  
TO THIS WELL

320 to Dakota 14076 P.C.

## 18. DISTANCE FROM PROPOSED LOCATION\*

TO NEAREST WELL, DRILLING, COMPLETED,  
OR APPLIED FOR, ON THIS LEASE, FT.

## 19. PROPOSED DEPTH

7600'

## 20. ROTARY OR CABLE TOOLS

Rotary

## 21. ELEVATIONS (Show whether DF, RT, GR, etc.)

Est. 6935' GR

## 22. APPROX. DATE WORK WILL START\*

May 30, 1977

## 23. PROPOSED CASING AND CEMENTING PROGRAM

SIZE OF HOLE	SIZE OF CASING	WEIGHT PER FOOT	SETTING DEPTH	QUANTITY OF CEMENT
12 $\frac{1}{4}$ "	9-5/8"	32.3#	350'	250 sx.
7-7/8"	5-1/2"	15.5# & 17#	7600'	850 Sx.

Plan to drill a 12 $\frac{1}{4}$ " hole from surface to 350', run, set and cement 9-5/8" csg. at 350' with 250 sx. cement. (Circ. cmt.) WOC, drill out under surface csg. with a 7-7/8" bit to a proposed TD of 7600' +/- or a sufficient depth to test the Dakota gas zone. Log well and if productive, complete as a gas well with 5 $\frac{1}{2}$ " csg. (New) set and cemented at 7600' with 850 sx. cmt. w/ 2 stage cmt. collar in string.

No cores or drill stem tests are anticipated.

Mud program is to us low vis. and low water loss mud out from under surface csg. to TD, ;with visc. 60/70 for logging.

Blowout equipment program, NTL-6 Surface usage plan, location maps, plats and drilling rig layout plan are attached.

IN ABOVE SPACE DESCRIBE PROPOSED PROGRAM: If proposal is to deepen or plug back, give data on present productive zone and proposed new productive zone. If proposal is to drill or deepen directionally, give pertinent data on subsurface locations and measured and true vertical depths. Give blowout preventer program, if any.

## 24.

SIGNED

*H.O. Porter*

TITLE Admin. Assist. Drlg. Svcs.

DATE March 29, 1977

(This space for Federal or State office use)

PERMIT NO.

APPROVAL DATE

APPROVED BY

TITLE

DATE

CONDITIONS OF APPROVAL, IF ANY:

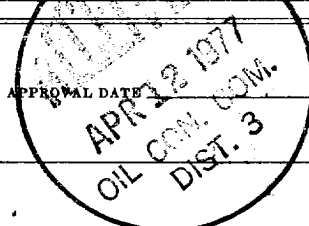

NEW MEXICO OIL CONSERVATION COMMISSION  
WELL LOCATION AND ACREAGE DEDICATION PLAT

Form C-102  
Supersedes C-128  
Effective 1-1-65

All distances must be from the outer boundaries of the Section.

Operator <b>Amerada Hess Corporation</b>			Lease <b>Jicarilla Apache A</b>		Well No. <b><del>10</del></b>
Unit Letter <b>B</b>	Section <b>35</b>	Township <b>25N</b>	Range <b>5W</b>	County <b>Rio Arriba</b>	
Actual Footage Location of Well: <b>890</b> feet from the <b>North</b> line and <b>1750</b> feet from the <b>East</b> line					
Ground Level Elev. <b>6930</b>	Producing Formation <b>Basin Dakota Picture Cliff</b>		Pool <b>Basin Dakota Picture Cliff</b>		Dedicated Acreage: <b>see below</b> Acres

1. Outline the acreage dedicated to the subject well by colored pencil or hachure marks on the plat below.
2. If more than one lease is dedicated to the well, outline each and identify the ownership thereof (both as to working interest and royalty).
3. If more than one lease of different ownership is dedicated to the well, have the interests of all owners been consolidated by communitization, unitization, force-pooling, etc?

☐ Yes ☐ No If answer is "yes," type of consolidation N/A

If answer is "no," list the owners and tract descriptions which have actually been consolidated. (Use reverse side of this form if necessary.) N/A

No allowable will be assigned to the well until all interests have been consolidated (by communitization, unitization, forced-pooling, or otherwise) or until a non-standard unit, eliminating such interests, has been approved by the Commission.

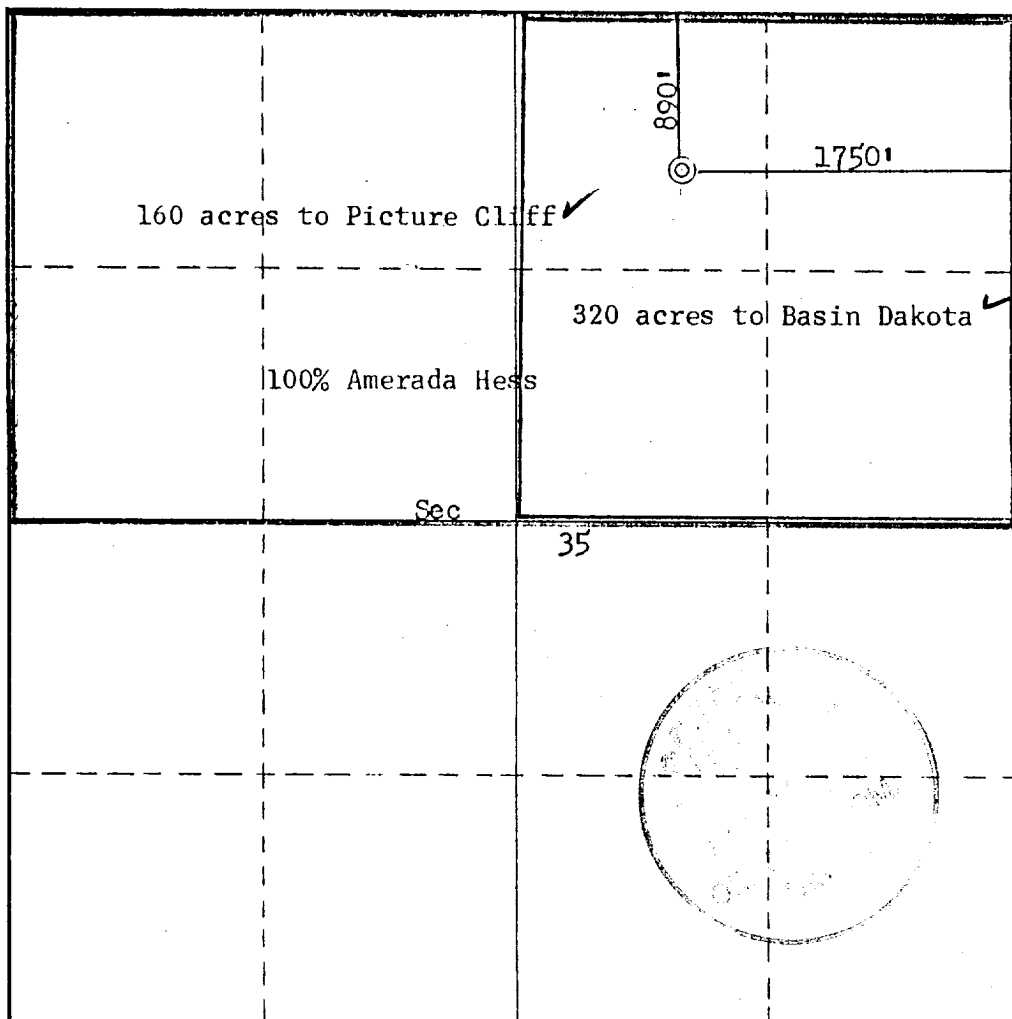

CERTIFICATION

I hereby certify that the information contained herein is true and complete to the best of my knowledge and belief.

*H. O. Porter*

Name

**H. O. Porter**

Position

**Admin. Assist. Drlg. Svcs.**

Company

**Amerada Hess Corp.**

Date

**February 9, 1977**

I hereby certify that the well location shown on this plat was plotted from field notes of actual surveys made by me or under my supervision, and that the same is true and correct to the best of my knowledge and belief.

Date Surveyed

**February 3, 1977**

Registered Professional Engineer  
and/or Land Surveyor

*Fred B. Kerr Jr.*  
**Fred B. Kerr Jr.**

Certificate No.

**3950**

