

OIL CONSERVATION COMMISSION
Albuquerque DISTRICT

OIL CONSERVATION COMMISSION
BOX 2088
SANTA FE, NEW MEXICO

DATE 4-13-77

RE: Proposed MC
Proposed DHC _____
Proposed NSL _____
Proposed SWD _____
Proposed WFX _____
Proposed PMX _____

Gentlemen:

I have examined the application dated 4-11-77
for the El Paso Natural Gas Co. Kimball Lease #1 C-23-25N-6W
Operator Lease and Well No. Unit, S-T-R

and my recommendations are as follows:

Approve

Yours very truly,

AR Kendrick

NEW MEXICO OIL CONSERVATION COMMISSION
 SANTA FE, NEW MEXICO
 APPLICATION FOR MULTIPLE COMPLETION

Form O-107
 5-1-61

Operator <u>El Paso Natural Gas Company</u>		County <u>Rio Arriba</u>	Date <u>April 11, 1977</u>
Address <u>P.O. Box 990, Farmington, N.M. 87401</u>		Lease <u>Kimbell Com</u>	Well No. <u>1</u>
Location of Well	Unit <u>C</u>	Section <u>23</u>	Township <u>25 North</u>
			Range <u>6 West</u>

1. Has the New Mexico Oil Conservation Commission heretofore authorized the multiple completion of a well in these same pools or in the same zones within one mile of the subject well? YES * NO
2. If answer is yes, identify one such instance: Order No. * ; Operator Lease, and Well No.:

*Re: NMOCC Memo #18-58

3. The following facts are submitted:	Upper Zone	Intermediate Zone	Lower Zone
a. Name of Pool and Formation	<u>Pictured Cliffs</u>		<u>Chacra</u>
b. Top and Bottom of Pay Section (Perforations)	<u>2510-2660</u>		<u>3385-3590</u>
c. Type of production (Oil or Gas)	<u>Gas</u>		<u>Gas</u>
d. Method of Production (Flowing or Artificial Lift)	<u>Flow</u>		<u>Flow</u>

4. The following are attached. (Please check YES or NO)

Yes	No	
<input checked="" type="checkbox"/>	<input type="checkbox"/>	a. Diagrammatic Sketch of the Multiple Completion, showing all casing strings, including diameters and setting depths, centralizers and/or turbolizers and location thereof, quantities used and top of cement, perforated intervals, tubing strings, including diameters and setting depth, location and type of packers and side door chokes, and such other information as may be pertinent.
<input checked="" type="checkbox"/>	<input type="checkbox"/>	b. Plat showing the location of all wells on applicant's lease, all offset wells on offset leases, and the names and addresses of operators of all leases offsetting applicant's lease.
<input type="checkbox"/>	<input checked="" type="checkbox"/>	c. Waivers consenting to such multiple completion from each offset operator, or in lieu thereof, evidence that said offset operators have been furnished copies of the application.*
<input type="checkbox"/>	<input checked="" type="checkbox"/>	d. Electrical log of the well or other acceptable log with tops and bottoms of producing zones and intervals of perforation indicated thereon. (If such log is not available at the time application is filed it shall be submitted as provided by Rule 112-A.)

5. List all offset operators to the lease on which this well is located together with their correct mailing address.

Kimbell, Inc. , 3000 Fort Worth National Bank Building, Fort Worth, Texas 76102

6. Were all operators listed in Item 5 above notified and furnished a copy of this application? YES X NO . If answer is yes, give date of such notification April 11, 1977.

CERTIFICATE: I, the undersigned, state that I am the Division Drilling Engineer of the El Paso Natural Gas Company (company), and that I am authorized by said company to make this report; and that this report was prepared under my supervision and direction and that the facts stated therein are true, correct and complete to the best of my knowledge.

Don Reed
 Signature

*Should waivers from all offset operators not accompany an application for administrative approval, the New Mexico Oil Conservation Commission will hold the application for a period of twenty (20) days from date of receipt by the Commission's Santa Fe office. If, after said twenty-day period, no protest nor request for hearing is received by the Santa Fe office, the application will then be processed.

NOTE: If the proposed multiple completion will result in an unorthodox well location and/or a non-standard proration unit in one or more of these applications for approval of the same should be filed simultaneously with this application.

Plat Showing Location of Intended Dual Completion (Tubingless)
 El Paso Natural Gas Company Kimbell Com #1 (PC-Ch) Well and Offset Acreage

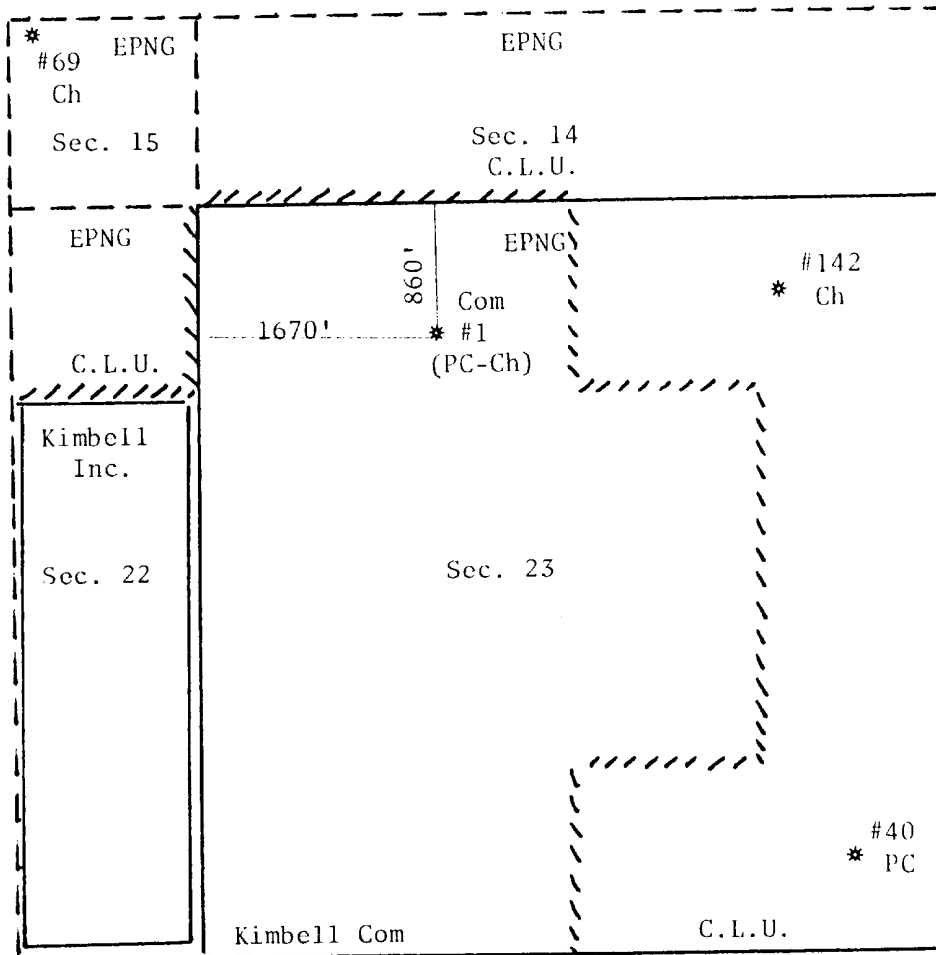

T
25
N

R 6 W

EL PASO NATURAL GAS COMPANY

NAME	DATE	DR.
DRAWN BY	CHECKED BY	

SCHEMATIC DIAGRAM OF INTENDED DUAL COMPLETION (Tubingless)
El Paso Natural Gas Company Kimbell Com #1 (PC-Ch)
NW/4 Section 23, T25N, R6W

