

# Mobil Producing Texas & New Mexico Inc.

A-31-24-3

April 26, 1983

NINE GREENWAY PLAZA-SUITE 2700  
HOUSTON, TEXAS 77046

State of New Mexico  
Energy and Minerals Department  
Oil Conservation Division  
P.O. Box 2088  
Santa Fe, NM 87501

Attention Mr. Joe D. Ramey, Director

RECEIVED  
APR 29 1983  
OIL CON. DIV.  
DIST. 3

7.01  
ACREAGE DEDICATION FOR GAS WELL  
SUBSTANDARD ACREAGE  
FEDERAL ~~2814~~, WELL #1  
CHACON-DAKOTA ASSOCIATED POOL  
RIO ARriba COUNTY, NEW MEXICO

Gentlemen:

Mobil Producing TX. & N.M. Inc. (MPTM) is submitting a revised C-102 and requesting approval of a nonstandard acreage dedication of 192.36 acres for the subject well.

Well #1 was drilled and completed as an oil well on an acreage dedication of 192.36 acres. The well has since been reclassified as a gas well due to a high gas-oil ratio. The standard acreage dedication for a gas well is 320 acres. This nonstandard unit of 192.36 acres is necessitated by a variation in the legal subdivision.

Each offset operator on the attached list is being furnished a copy of this letter and attachment by certified mail as notice of this application and request for waiver.

MPTM is requesting that this application be approved administratively under Rule 104 D.II. If administrative approval is not granted, MPTM requests that this application be set for hearing at the earliest date possible.

Yours truly,

*J. A. Morris*  
for J. A. Morris  
Regulatory Engineering Supervisor

LSHall/ec  
Attachments

cc: NM Oil Conservation Division, Aztec  
US Bureau of Land Management, Farmington  
Offset Operators (Certified, Return Receipt Requested)

**NEW MEXICO OIL CONSERVATION COMMISSION  
WELL LOCATION AND ACREAGE DEDICATION PLAT**

Form C-102  
Supersedes C-128  
Effective 1-1-65

All distances must be from the outer boundaries of the Section.

Operator <b>Mobil Producing TX. &amp; N.M. Inc.</b>			Lease <b>Federal <del>28714</del></b>		Well No. <b>1</b>
Unit Letter <b>A</b>	Section <b>31</b>	Township <b>24N</b>	Range <b>3W</b>	County <b>Rio Arriba</b>	
Actual Footage Location of Well: <div style="display: flex; justify-content: space-between;"> <span>790 feet from the North line and</span> <span>790 feet from the East line</span> </div>					
Ground Level Elev. <b>7269'</b>	Producing Formation <b>Dakota</b>	Pool <b>Chacon-Dakota Associated</b>		Dedicated Acreage: <b>192.36</b> Acres	

1. Outline the acreage dedicated to the subject well by colored pencil or hatchure marks on the plat below.
2. If more than one lease is dedicated to the well, outline each and identify the ownership thereof (both as to working interest and royalty).
3. If more than one lease of different ownership is dedicated to the well, have the interests of all owners been consolidated by communitization, unitization, force-pooling, etc?

☐ Yes    ☐ No    If answer is "yes," type of consolidation \_\_\_\_\_

If answer is "no," list the owners and tract descriptions which have actually been consolidated. (Use reverse side of this form if necessary.) \_\_\_\_\_

No allowable will be assigned to the well until all interests have been consolidated (by communitization, unitization, forced-pooling, or otherwise) or until a non-standard unit, eliminating such interests, has been approved by the Commission.

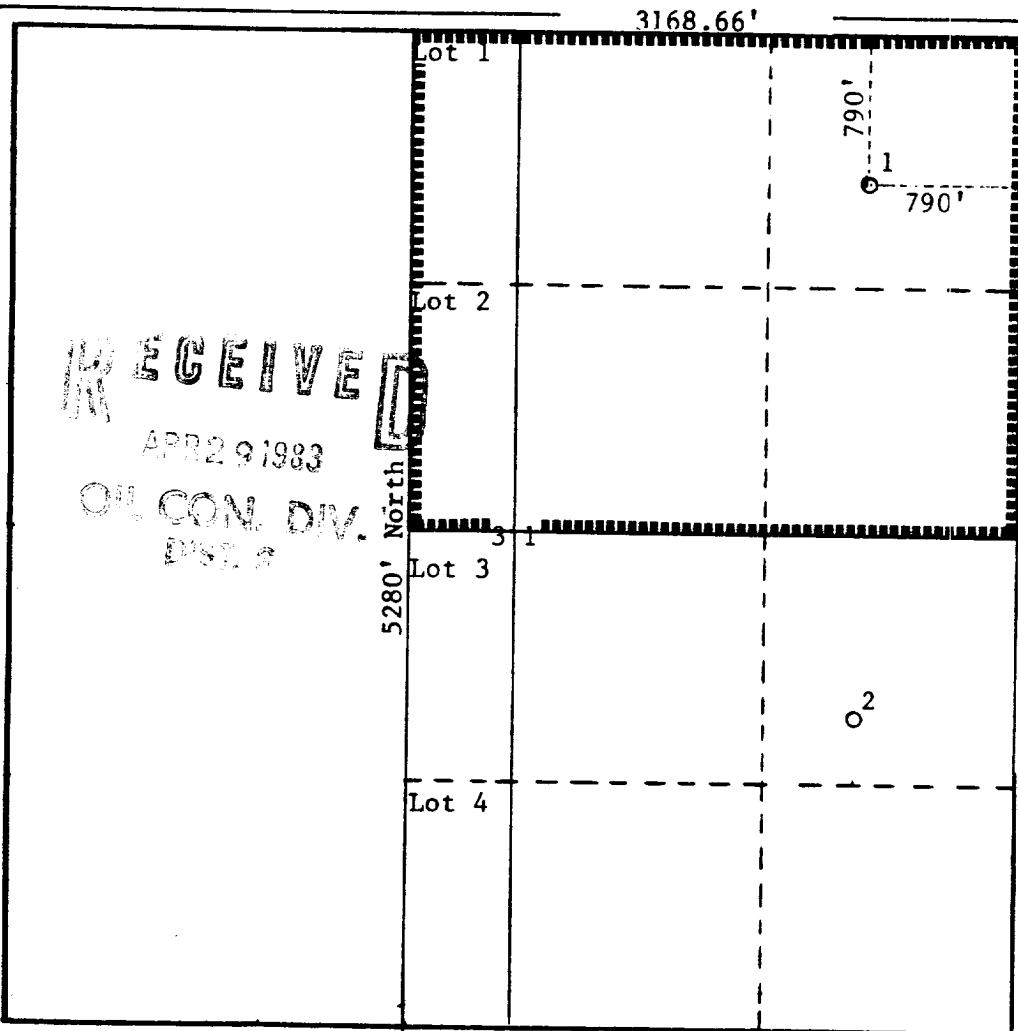

**CERTIFICATION**

I hereby certify that the information contained herein is true and complete to the best of my knowledge and belief.

Name  
**A. D. Bond**  
Position **Regulatory Engineering Coordinator II**  
Company  
**Mobil Producing TX. & NM. Inc.**

Date  
**April 26, 1983**

I hereby certify that the well location shown on this plat was plotted from field notes of actual surveys made by me or under my supervision, and that the same is true and correct to the best of my knowledge and belief.

Date Surveyed \_\_\_\_\_

Registered Professional Engineer  
and/or Land Surveyor \_\_\_\_\_

Certificate No. \_\_\_\_\_



Federal 28714 Lease  
Chacon-Dakota Associated Pool  
Offset Operators

Amoco Production Company  
501 Airport Drive  
Farmington, NM 87401

Arco Oil & Gas Company  
Box 5540  
Denver, CO 80217

El Paso Exploration Company  
Box 289  
Farmington, NM 87401

Southland Royalty Company  
Drawer 570  
Farmington, NM 87401