

## WELL LOCATION AND ACERAGE DEDICATION PLAT

All distances must be from the outer boundaries of the Section

Operator <b>THE ATLANTIC RICHFIELD COMPANY</b>		Lease <b>CHACON FEDERAL</b>		Well No <b>2</b>
Unit Letter <b>E</b>	Section <b>33</b>	Township <b>24 NORTH</b>	Range <b>3 WEST</b>	County <b>RIO ARriba</b>
Actual Footage Location of Well:				
<b>1650</b>	feet from the	<b>NORTH</b>	line and	<b>800</b>
				feet from the
				<b>WEST</b>
				line
Ground Level Elev. <b>7050</b>	Producing Formation <b>DAKOTA</b>		Foot <b>CHACON DAKOTA</b>	Dedicated Acreage: <b>NW/4 160 Acres</b>

- Outline the acreage dedicated to the subject well by colored pencil or hatchure marks on the plat below.
- If more than one lease is dedicated to the well, outline each and identify the ownership thereof (both as to working interest and royalty), **Atlantic Richfield Company is owner of NW/4 of Section 33.**
- If more than one lease of different ownership is dedicated to the well, have the interests of all owners been consolidated by communitization, unitization, force-pooling, etc? ~~Operating Agreement is being prepared and~~  
~~Communitization Agreement will be prepared.~~  
(X) Yes ( ) No If answer is "yes," type of consolidation \_\_\_\_\_

If answer is "no," list the owners and tract descriptions which have actually consolidated. (Use reverse side of this form if necessary.) ~~Will be Odessa Natural (SW/4) and Atlantic Richfield (NW/4)~~

No allowable will be assigned to the well until all interests have been consolidated (by communitization, unitization, forced-pooling, or otherwise) or until a non standard unit, eliminating such interests, has been approved by the Commission.

## CERTIFICATION

I hereby certify that the information contained herein is true and complete to the best of my knowledge and belief.

W. A. Walther, Jr.  
Name **W. A. Walther, Jr.**  
Operations Manager  
Position  
**Atlantic Richfield Company**  
Company  
**September 17, 1978**  
Date

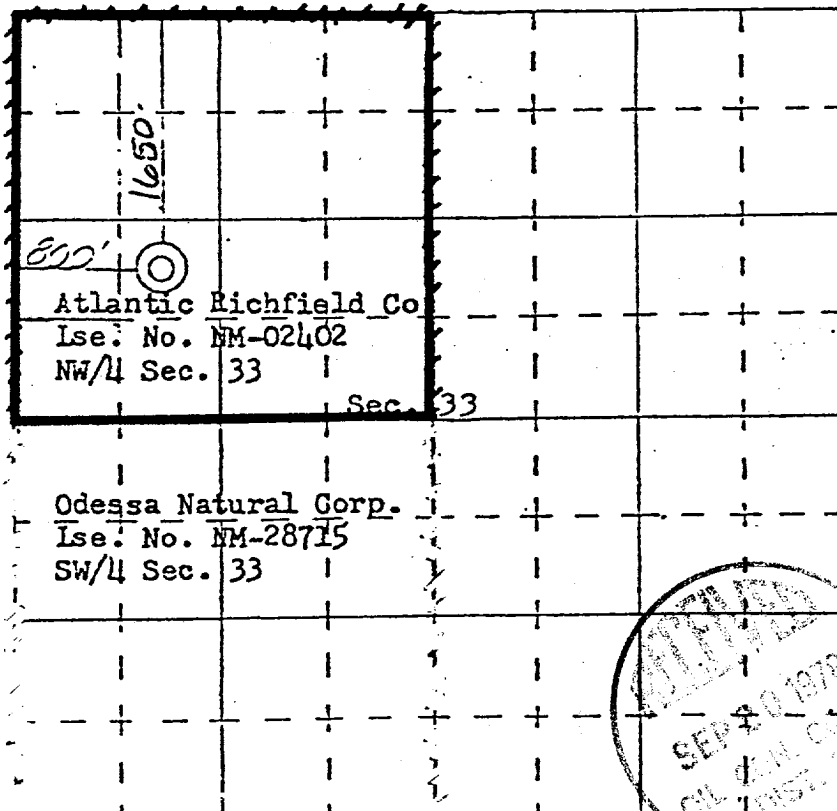

SCALE—4 INCHES EQUALS 1 MILE

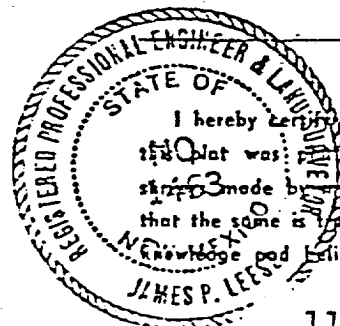

I hereby certify that the well location shown on this plat was derived from field notes of actual survey made by me or under my supervision, or that the same is true and correct to the best of my knowledge and belief.

**11 November 1977**  
Date Surveyed  
James P. Lees  
Registered Professional Engineer  
and/or Land Surveyor **James P. Lees**