

UNITED STATES
DEPARTMENT OF THE INTERIOR
GEOLOGICAL SURVEY

APPLICATION FOR PERMIT TO DRILL, DEEPEN, OR PLUG BACK

1a. TYPE OF WORK

DRILL ☒DEEPEN ☐PLUG BACK ☐

b. TYPE OF WELL

OIL
WELL ☒GAS
WELL ☐

OTHER

SINGLE
ZONE ☐MULTIPLE
ZONE ☐

2. NAME OF OPERATOR

Continental Oil Company

3. ADDRESS OF OPERATOR

Box 460, Hobbs, N.M. 88240

4. LOCATION OF WELL (Report location clearly and in accordance with any State requirements.)

At surface

H 1650' FNL + 660' FEL

At proposed prod. zone

Same

14. DISTANCE IN MILES AND DIRECTION FROM NEAREST TOWN OR POST OFFICE*

15. DISTANCE FROM PROPOSED*

LOCATION TO NEAREST
PROPERTY OR LEASE LINE, FT.
(Also to nearest drlg. unit line, if any)18. DISTANCE FROM PROPOSED LOCATION*
TO NEAREST WELL, DRILLING, COMPLETED,
OR APPLIED FOR, ON THIS LEASE, FT.

21. ELEVATIONS (Show whether DF, RT, GR, etc.)

6951' GR

16. NO. OF ACRES IN LEASE

19. PROPOSED DEPTH

7800'

17. NO. OF ACRES ASSIGNED
TO THIS WELL

160

20. ROTARY OR CABLE TOOLS

Rotary

22. APPROX. DATE WORK WILL START*

4-10-78

23. PROPOSED CASING AND CEMENTING PROGRAM

SIZE OF HOLE	SIZE OF CASING	WEIGHT PER FOOT	SETTING DEPTH	QUANTITY OF CEMENT
12 1/2"	New 8 7/8"	24#	1000'	600 SX CIRC
7 7/8"	New 5 1/2"	15.5# + 17#	7800'	1320 SX

IT IS Proposed To Drill A Straight Hole To A
T.D. OF 7800' and Complete As A West Lindrith
Gallup Dakota Oil Well,

See Attached For B.O.P. Program.

See Attached Proposed Well Plan For Formation Tops, Log, etc.

IN ABOVE SPACE DESCRIBE PROPOSED PROGRAM: If proposal is to deepen or plug back, give data on present productive zone and proposed new productive zone. If proposal is to drill or deepen directionally, give pertinent data on subsurface locations and measured and true vertical depths. Give blowout preventer program, if any.

24.

SIGNED

TITLE

Admin. Supv.

DATE

1-4-78

(This space for Federal or State office use)

PERMIT NO.

APPROVAL DATE

APPROVED BY

TITLE

CONDITIONS OF APPROVAL, IF ANY:

JAN 10 1978

*See Instructions On Reverse Side

USGS-Durango(6), El Paso, MTL, BEA, File (2).

U. S. GEOLOGICAL SURVEY
DURANGO, COLO.

NEW MEXICO OIL CONSERVATION COMMISSION
WELL LOCATION AND ACREAGE DEDICATION PLAT

Form C-102
Supersedes C-128
Effective 1-1-65

All distances must be from the outer boundaries of the Section.

Operator Continental Oil Company		Lease Jicarilla 30		Well No. 9
Unit Letter H	Section 29	Township 25N	Range 4W	County Rio Arriba
Actual Footage Location of Well: 1650 feet from the North line and 660 feet from the East line				
Ground Level Elev. 6951	Producing Formation Gallup Dakota	Pool West Lindsith ✓	Dedicated Acreage: 160 ✓ Acres	

1. Outline the acreage dedicated to the subject well by colored pencil or hatchure marks on the plat below.

2. If more than one lease is dedicated to the well, outline each and identify the ownership thereof (both as to working interest and royalty).

3. If more than one lease of different ownership is dedicated to the well, have the interests of all owners been consolidated by communitization, unitization, force-pooling, etc?

☐ Yes ☐ No If answer is "yes," type of consolidation _____

If answer is "no," list the owners and tract descriptions which have actually been consolidated. (Use reverse side of this form if necessary.) _____

No allowable will be assigned to the well until all interests have been consolidated (by communitization, unitization, forced-pooling, or otherwise) or until a non-standard unit, eliminating such interests, has been approved by the Commission.

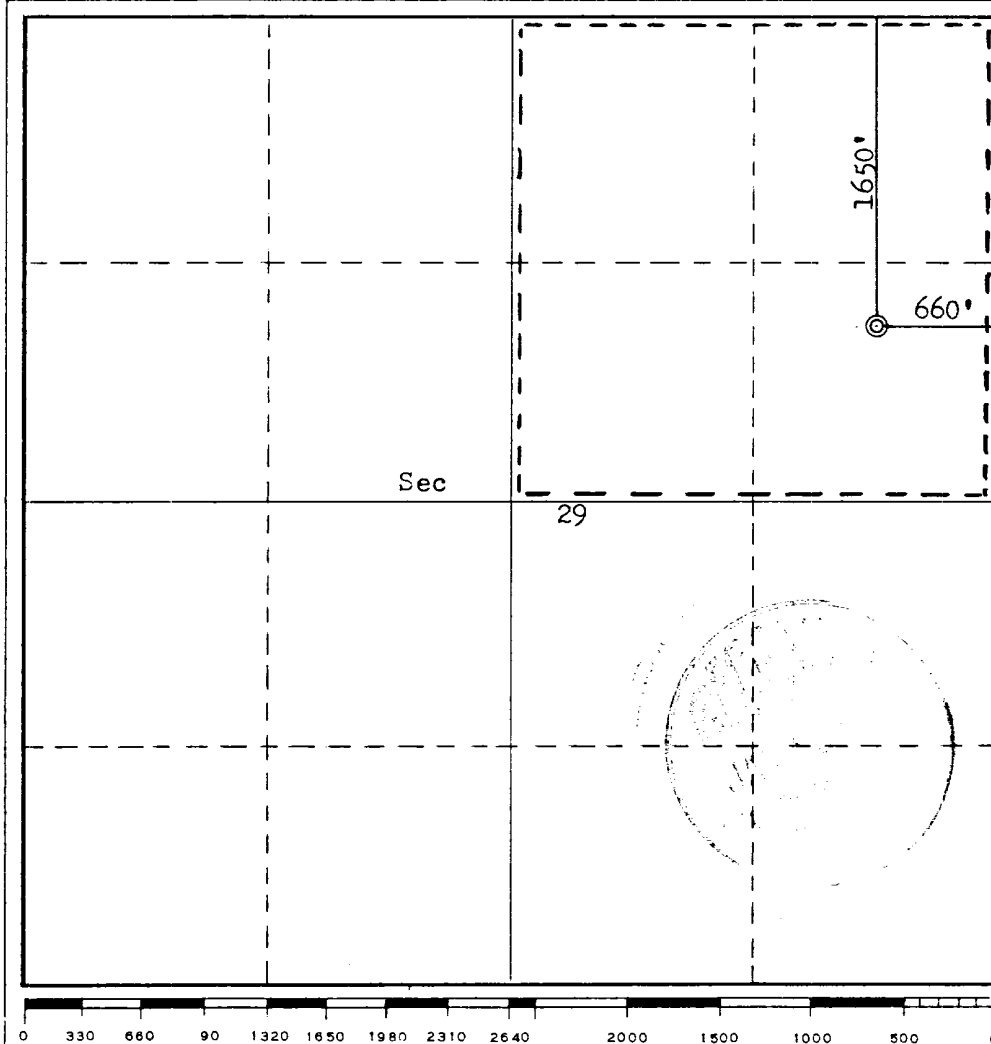

CERTIFICATION

I hereby certify that the information contained herein is true and complete to the best of my knowledge and belief.

Name **Wm. A. Butterfield**
Position **Adm. Supv.**
Company **Continental Oil Co.**
Date **1-4-78**

I hereby certify that the well location shown on this plat was plotted from field notes of actual surveys made by me or under my supervision, and that the same is true and correct to the best of my knowledge and belief.

Date Surveyed **November 16, 1977**
Registered Professional Engineer and/or Land Surveyor
Fred B. Kerr Jr.
Certificate No. **3950**

ATTACHMENT TO FORM 9-331 C
APPLICATION FOR PERMIT TO DRILL

Continental Oil Company, Jicarilla 30 No. 9
1650' FNL and 660' FEL of Section 29, T-25N, R-4W,
Rio Arriba County, New Mexico

1. The geologic name of the surface formation is Cretaceous Sand.
2. The estimated tops of important geologic markers are shown on the attached Proposed Well Plan.
3. The estimated depths at which anticipated water, oil, gas or other mineral-bearing formations to be encountered are shown on attached Proposed Well Plan.
4. The proposed casing program is as follows:

Surface - new 8 5/8" 24# K-55 set at 1000'
Production - new 5 1/2" 15.5# and 17# K-55 set at 7800'
5. A drawing of an API Series 900 Blowout Preventer Specification is attached. Pipe rams and blinds will be checked to 1,000 PSI for 30 minutes when BOP is installed. BOP will be checked when casing string is set and operated daily for checks.
6. The proposed mud program is as follows:

0-1000' Fresh Water Gel	8.5-9.0 pounds per gallon
1000-7800' KCL Poly Gel	8.5-9.0 pounds per gallon
7. The auxiliary equipment to be used is:
 - (1) Kelly cocks
 - (2) Floats at the bit
8. It is proposed to run SP-IES log from TD to 3000' and GR CAL CNL FDC PDC logs at selected intervals.
9. No abnormal pressures or temperatures are expected to be encountered in this well.
10. The anticipated starting date for this well is April 10, 1978, with a duration date of approximately 21 days.

CONTINENTAL OIL COMPANY
Blow-out Preventer Specifications

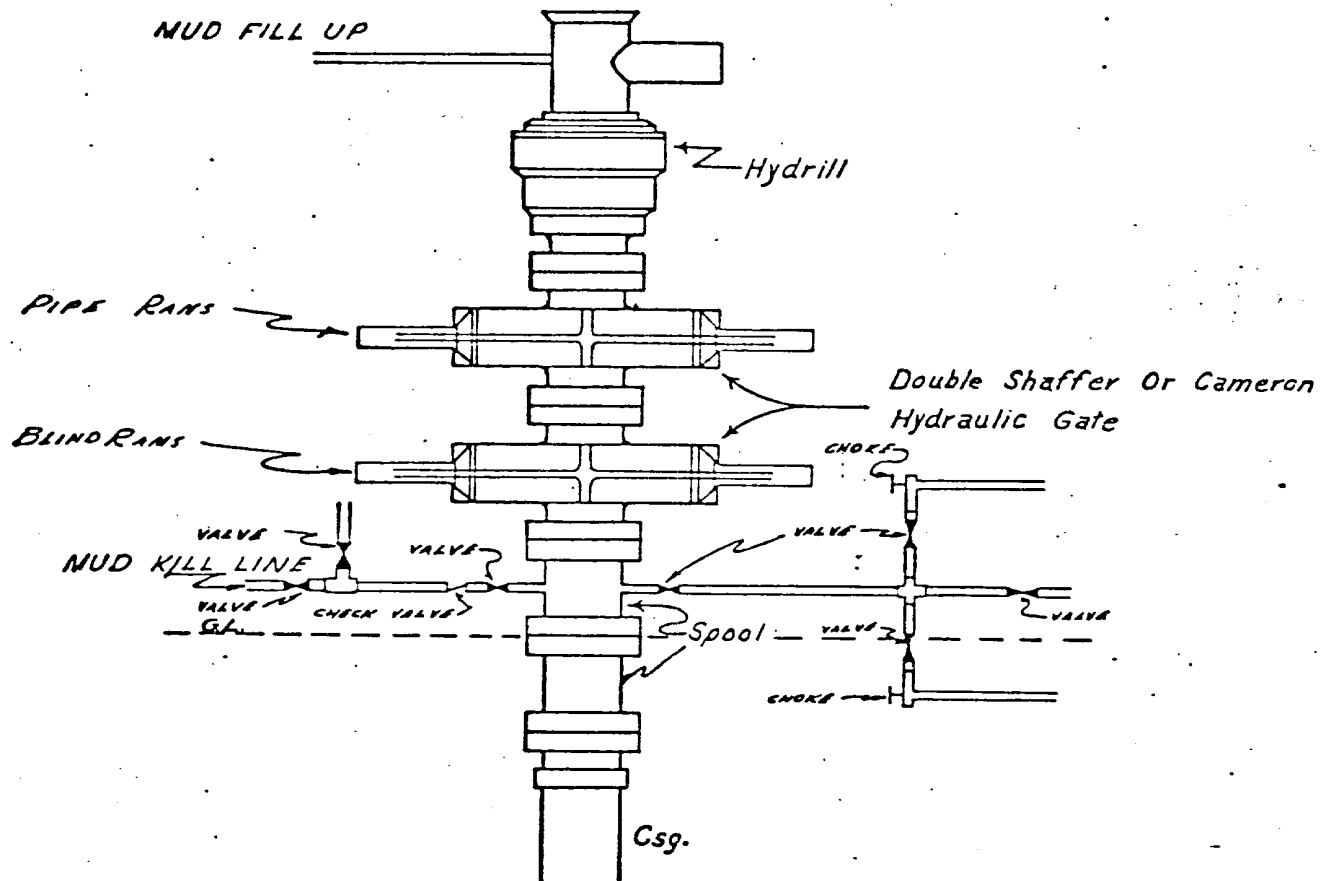

API Series 900

NOTE:

Manual and Hydraulic controls with closing unit no less than 75' from well head.
Remote controls on rig floor.

DUE TO SUBSTRUCTURE CLEARANCE,
HYDRILL MAY OR MAY NOT BE USED.

Jicarilla 30 #9

COUNTY: Yolo County

LOCATION: 1650 FNL & 660 FEL

STATE: NM

Sec. 29, T25N, R4W

Est. 6970 KB

Proposed wall Plan Est. 6955' GL

DEPTH	FORMATION TOP'S & TYPE	DRILLING PROBLEMS	TYPE OF FORMATION EVALUATION	HOLE SIZE (IN)	CASING		FRACTURE GRADIENT (PPG)	FORMATION PRESSURE GRADIENT (PPG)	MUD	
					SIZE (IN)	DEPTH (FT)			WEIGHT (PPG)	TYPE
	Cretaceous									
000			GEOLOGICAL O-TD	12 1/4	8 5/8	1000	-	-	8.5 70 9.0	FRESH WATER GEL
000	Ojo Alamo ss, 2500									
000	Kirtland sh, 2850									
000	Pic. Cliffs ss. 3200									
000	Chacra ss. 4070		Well Logs							
000	Mesa Verde ss. 4860		SP-IES TD-3000 2" & 5"							
000			GR-CAL- CNL-FDC Selected Intervals 2" & 5"							
000	Gallup ss. 6550 850		PDC Selected Intervals							
000	Dakota ss. 7400 Zone J 7550 Zone M 7650 TD 7800			7 7/8	5 1/2	7800	13.0 TO 12.0	LESS THAN 9.5	8.5 70 9.0	KCL POLY GEL

Prepared by: _____

proved

SURFACE USE PLAN
Continental Oil Company, Jicarilla 30 No. 9
1650' FNL and 660' FEL of Section 29, T-25N, R-4W
Lease Contract No. 41, Rio Arriba County, NM

The plan is to accompany "Application for Permit to Drill" the subject well. The following is a discussion of pertinent information concerning possible effect which the proposed drilling of the well may have on the environment of the well and road sites and surrounding acreage. A copy will be posted on the derrick floor so that all contractors and sub-contractors will be aware of all items of this plan.

1. Existing Roads

- A. The proposed well site is 1650' FNL and 660' FEL of Section 29, T-25N, R-4W, Rio Arriba County, New Mexico.
- B. Exhibit "A" is a portion of a Jicarilla 30 Lease map showing existing roads and proposed new road and location.
- C. The access roads are shown on Exhibits "A" and "B".

2. Planned Access Roads

The access road is approximately 1500' long approaching the well from the North. Roads may be altered at the discretion of the Jicarilla Apache Tribe and will be constructed and maintained according to their specification.

3. Location of Existing Wells

See Exhibit "A".

4. Location of Existing and/or Proposed Facilities

- A. Tank Batteries: One 400 Bbl. tank and a production unit will be located on well site.
- B. Rehabilitation: Pits will be backfilled and leveled as soon as practical to original condition. Commencement of rehabilitation operations will immediately follow removal of drilling and completion equipment from location and rehabilitation of the surface is planned to be completed within 45 days from commencement.

5. Water Supply

The supply of water will be hauled from Largo Wash (See Exhibit "C").

6. Source of Construction Materials

Not applicable. Drilling pad to be compacted.

7. Methods for Handling Waste Disposal

Waste Disposal: Well cuttings will be disposed in reserve pit. Trash pit is shown on "Rig Layout", Exhibit "D". All detrimental waste will be buried with a minimum cover of 24' of dirt. See Exhibit "D" for location of pits.

8. Ancillary Facilities

None

9. Well Site Layout

Exhibit "D" shows the relative location and dimensions of the well pad, mud pit, reserve pit, trash barrel, etc.

10. Plans for Restoration of Surface

Pits will be backfilled and leveled as soon as practical to original condition. Commencement of rehabilitation operations will immediately follow removal of drilling and completion equipment from location. Surface will be leveled and properly conditioned as required by USGS after consulting with proper surface managing agency.

11. Other Information

- A. Terrain: Rolling, the well is located at the mouth of a box canyon. The topography is flat and rolling, sloping to the south with some arroyos. See Exhibit "B", topographic map of area.
- B. Soil: Sandy loam with sandstone outcrops.
- C. Vegetation: Sagebrush, Blue Grama with a few pinon trees.
- D. Surface Use: Suitable for grazing.
- E. Ponds and Streams: None within one mile.
- F. Water Wells: None within one mile.
- G. Residences and Buildings: None within one mile.
- H. Arroyos, Canyons, Etc: See attached topographic map, Exhibit "B".
- I. Well Sign: Sign identifying and locating well will be maintained at drill site with the spudding of the well.
- J. Open Pits: All pits containing mud or other liquids will be fenced.
- K. Archaeological Resources: None observed.

12. Operator's Representative

Field personnel who can be contacted concerning compliance of this Surface Use Plan are as follows:

PRODUCTION AND DRILLING:

B. E. Anderson
Petroleum Center Building
Room 215
501 Airport Drive
Farmington, New Mexico
Phone: (505) 327-9557

L. P. Thompson
1001 North Turner
Hobbs, New Mexico 88240
Phone: (505) 393-4141

E. L. Oshlo
1001 N. Turner
Hobbs, New Mexico 88240
Phone: (505) 393-4141

13. Certification

I hereby certify that I, or persons under my direct supervision, have inspected the proposed drill site and access route; that I am familiar with the conditions which presently exist; that the statements made in this plan are, to the best of my knowledge, true and correct; and that the work associated with the operations proposed herein will be performed by Continental Oil Company and its contractors and sub-contractors in conformity with this plan and the terms and conditions under which it is approved.

Jan 4, 1978
Date

E. L. Oshlo
E. L. Oshlo
Assistant Division Manager

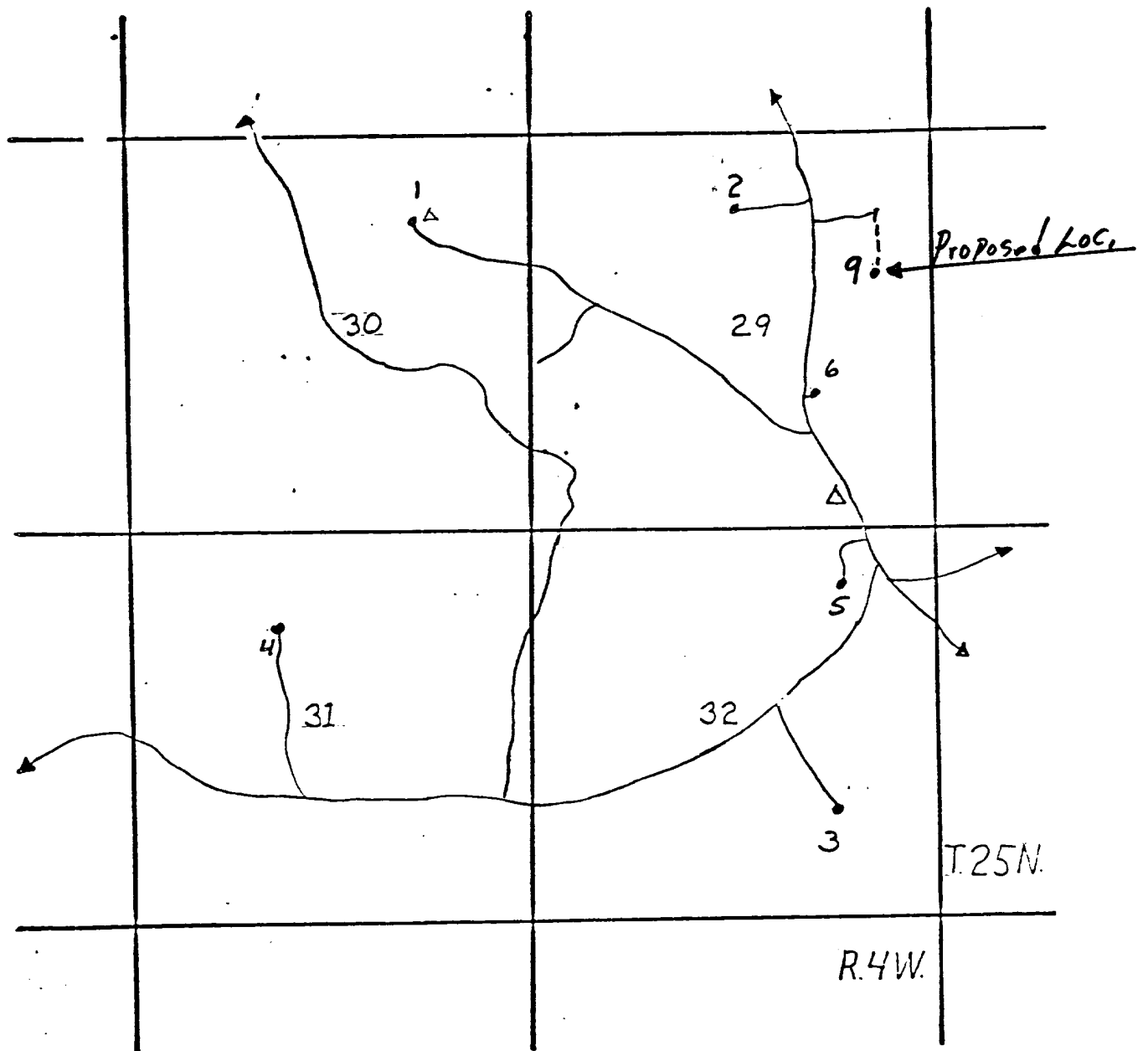

CONOCO

PRODUCTION DEPT. HOBBS DIV.
JICARILLA "30" LEASE
Well No. 9

LEGEND

- CONOCO WELL
- △ TANK BATTERY
- LEASE ROAD
- HWY.

EXHIBIT "A"

NTS
CHAVEZ

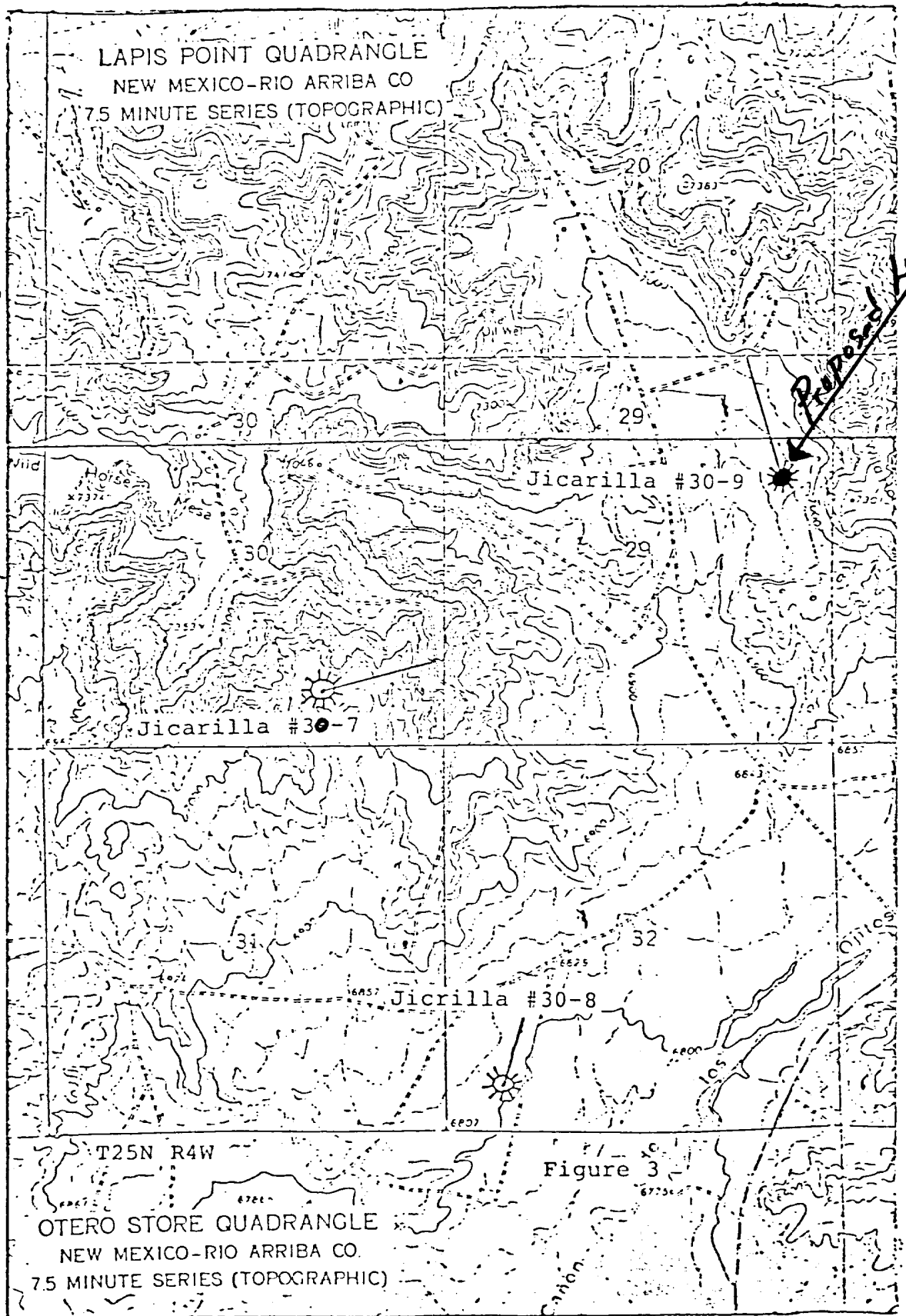

Continental Oil Co.
Jicarilla 30 # 9 EXHIBIT "B"

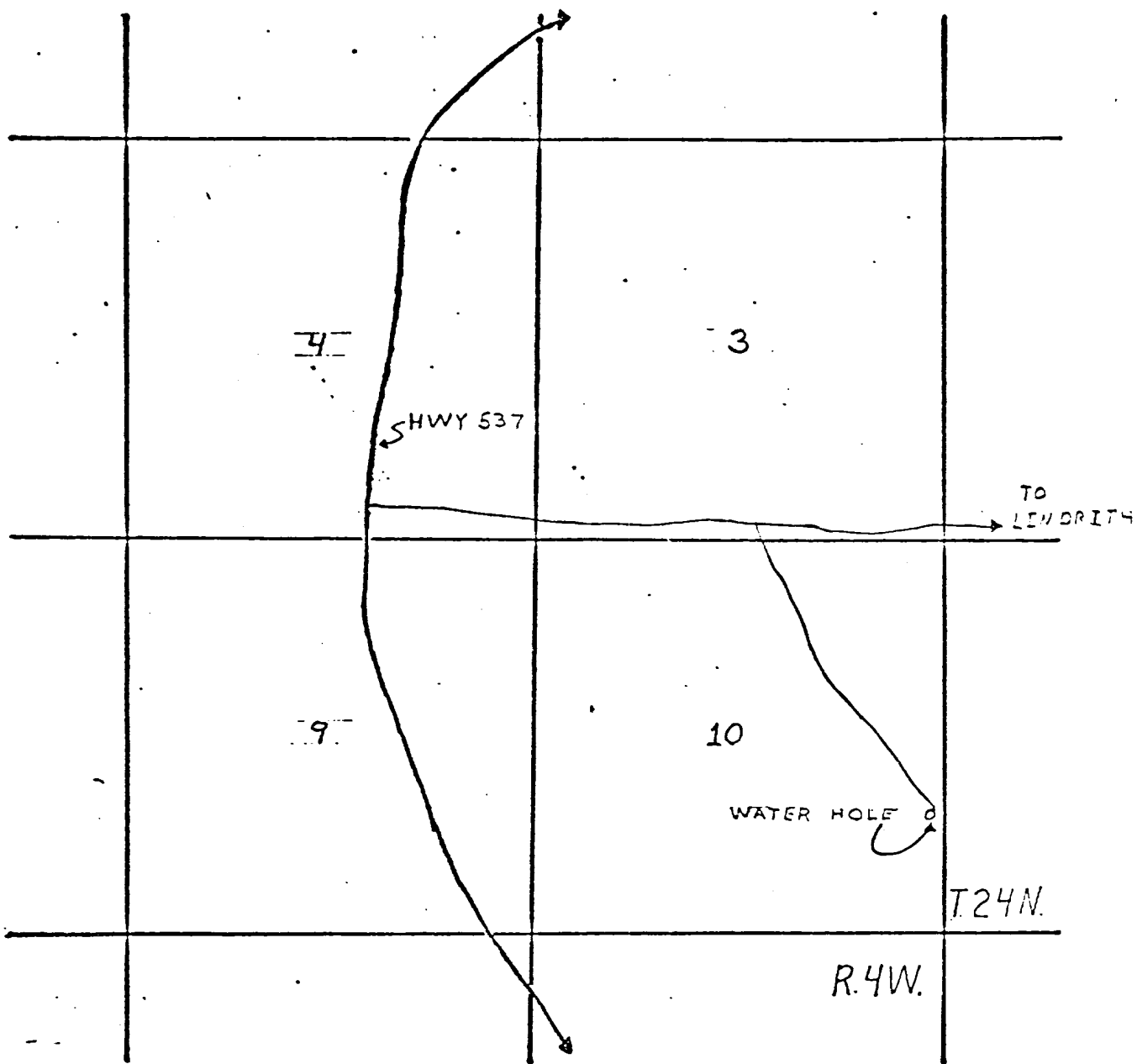

CONOCO

PRODUCTION DEPT. HOBBS DIV.

LARGO WATER HOLE

LEGEND

- CONOCO WELL
- ▲ TANK BATTERY
- LEASE ROAD
- HWY.

NTS
CHAVEZ

EXHIBIT "C"

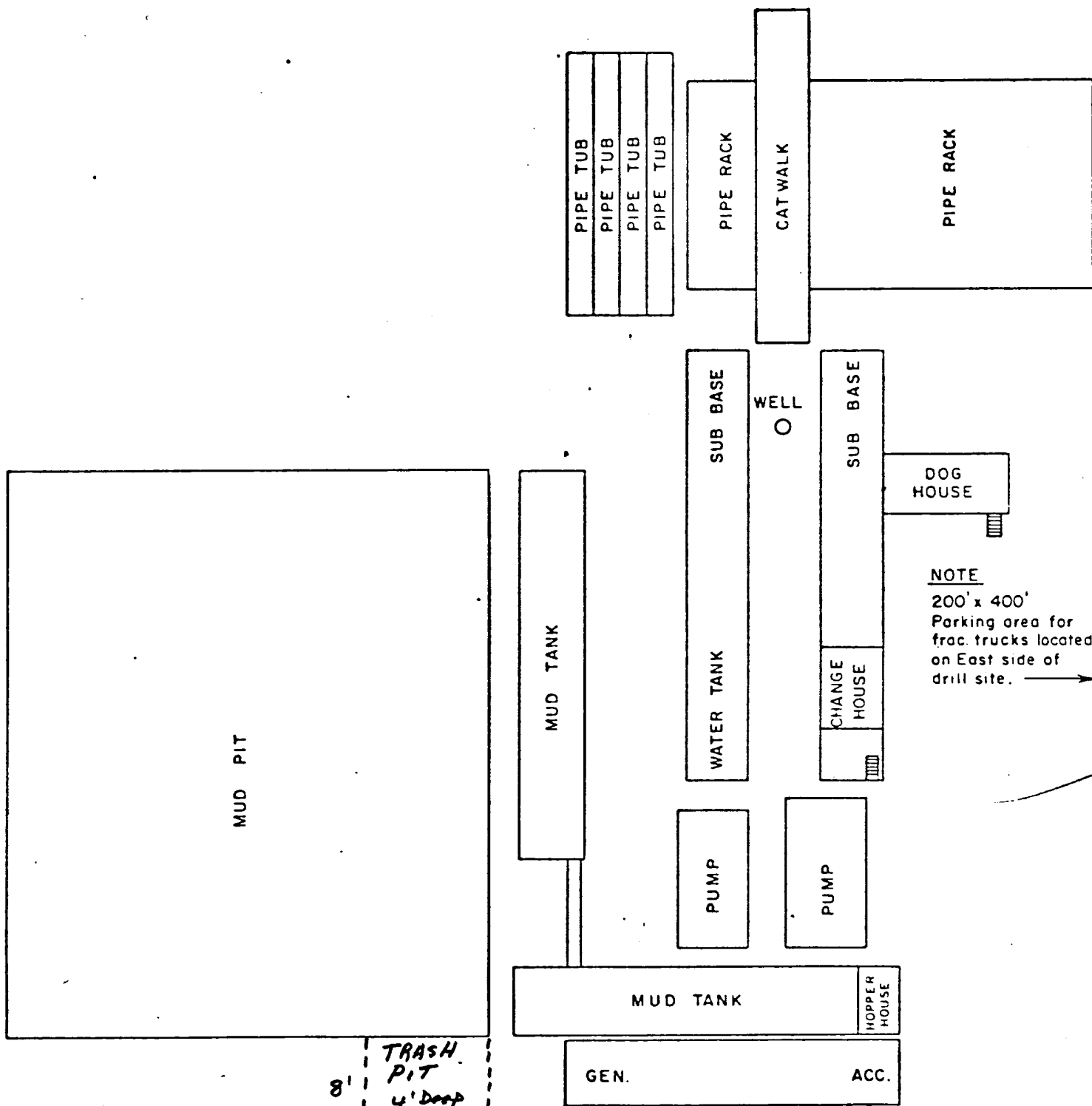

APPROX. RIG SITE DIMENSIONS
160' x 200'

CONTINENTAL OIL COMPANY PRODUCTION DEPARTMENT



RIG LAYOUT

Jicav. 112 30 # 9

EXHIBIT "D"

Engineer: ~~XXXXXXXXXX~~

Draftsman: ~~XXXXXX~~

Date: 1-4-73